

NOW ASKING! \$31.50/SF GROSS + ELECTRIC

750

EAST MAIN STREET

STAMFORD, CONN.

[CLICK HERE FOR VIRTUAL TOUR](#)



NEWMARK

HIGHLY VISIBLE MODERN BUILDING IN DOWNTOWN STAMFORD



PROPERTY HIGHLIGHTS

- Newly renovated & fully redesigned access, common areas and amenities
- Highly visible modern asset
- Offering high quality office space at competitive rents
- Ample on-site covered parking at a 3 per 1,000 RSF ratio
- CBD location with easy access to I-95, via exit 8
- Short distance to Stamford Transportation Center
- Expansive views of downtown Stamford & Long Island Sound



SPECIFICATIONS

AVAILABILITIES

5th Floor	2,813 SF
8th Floor	2,565 SF
9th Floor	17,258 SF*
10th Floor	13,073 SF*

* Divisible

RENTAL RATE

\$31.50 Gross + Electric

TERM

5 - 10 Years

POSSESSION

Immediate

RECENTLY RENOVATED AMENITIES

[CLICK HERE FOR VIRTUAL TOUR](#)

- Shuttle that provides service to the Stamford Transportation Center
- Fitness center and locker room
- Board room
- Full-service cafeteria
- Game room
- On-site security/concierge

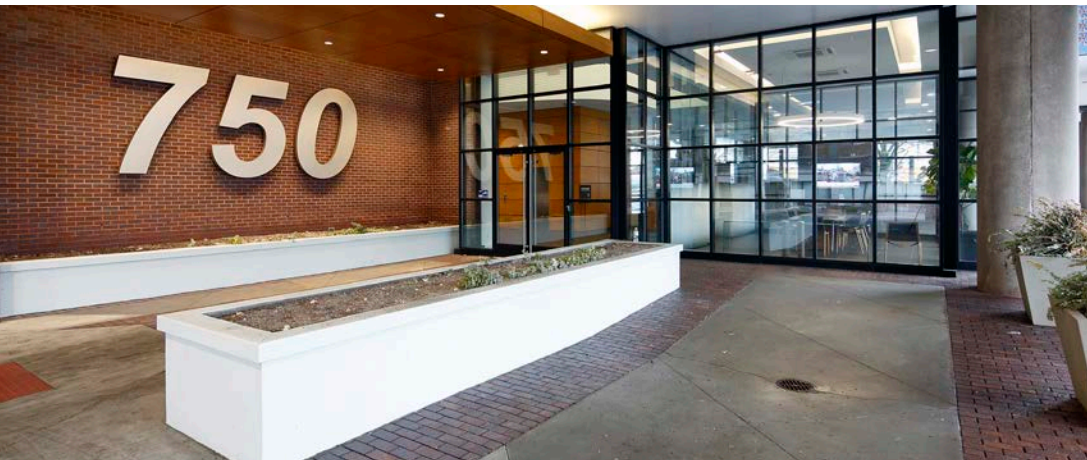

MODERN OFFICE SPACE

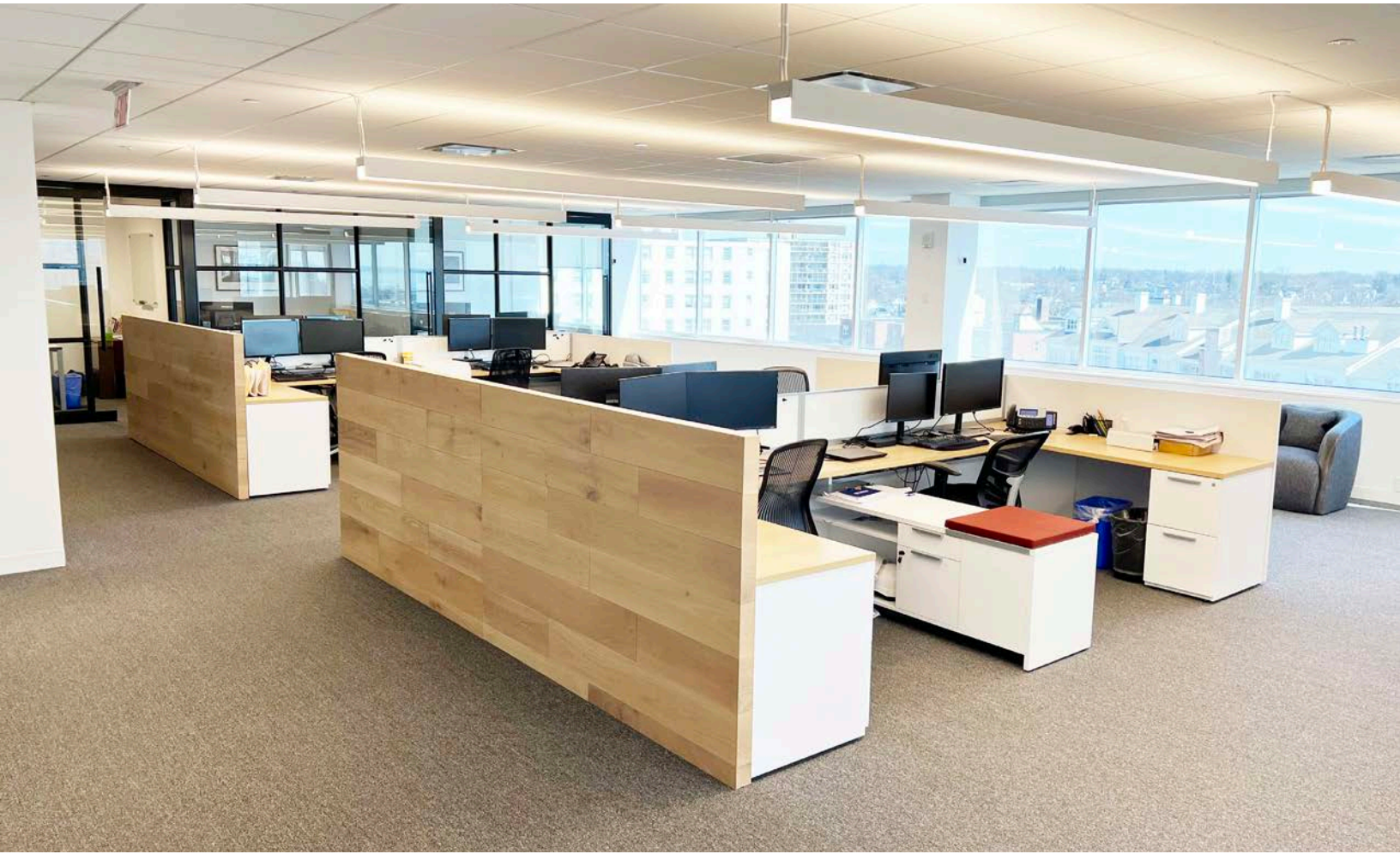

The information contained herein has been obtained from sources deemed reliable but has not been verified and no guarantee, warranty or representation, either express or implied, is made with respect to such information. Terms of sale or lease and availability are subject to change or withdrawal without notice.

NEWMARK

CONCEPTUAL SUBDIVIDE PLANS

ENTIRE 9TH FLOOR: 17,258 SF

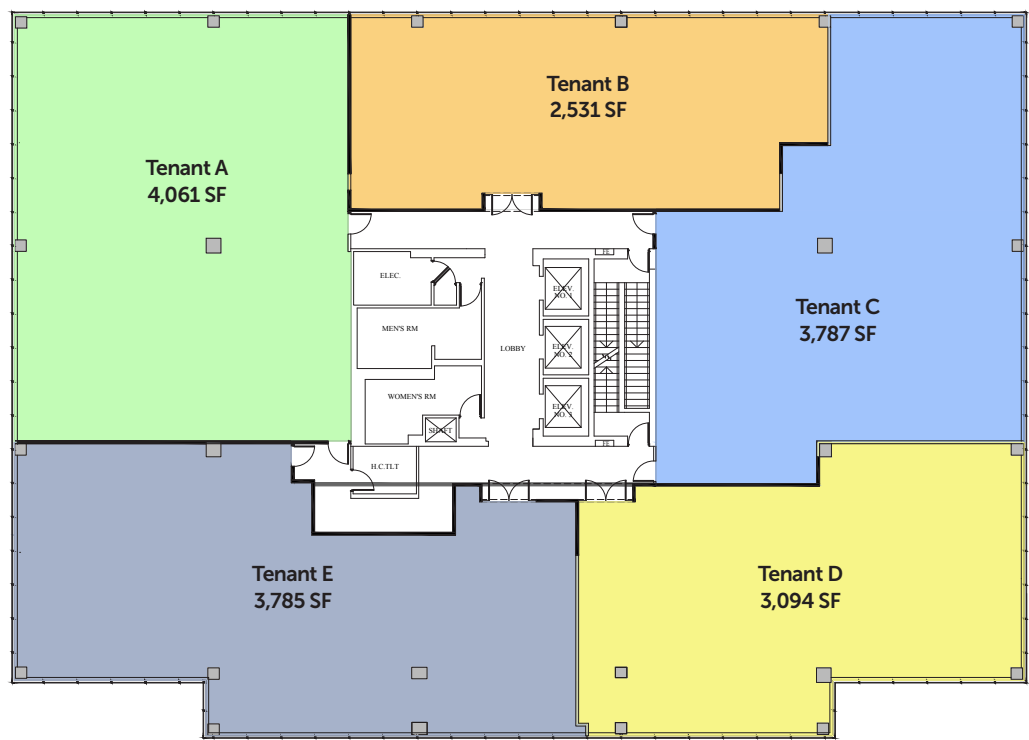

PARTIAL 10TH FLOOR: 13,073 SF

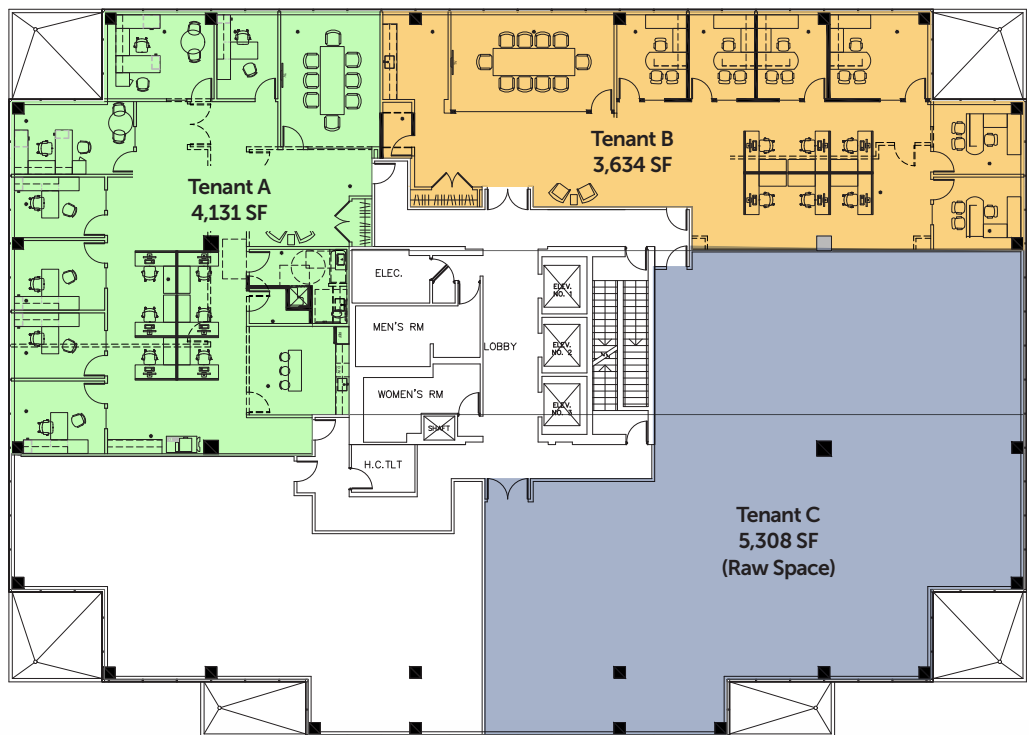

LOCATION OVERVIEW

GROWING CORPORATE HUB



3

Minute drive to
Interstate 95



5

Minute drive to
Stamford Train Station



52

Minutes to Grand
Central Terminal

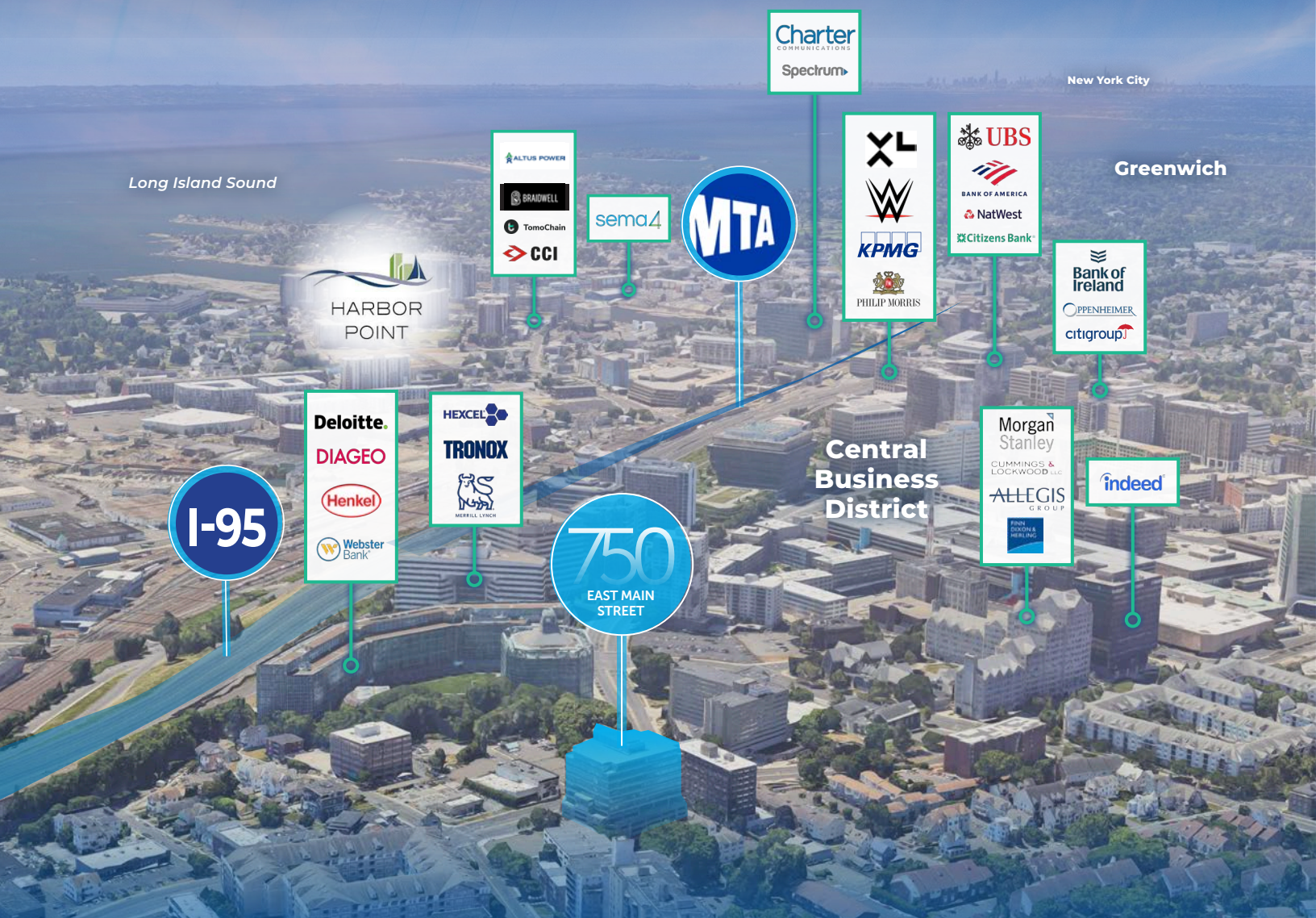

CHRISTIAN BANGERT
203-531-3639 | christian.bangert@nrmk.com

TIMOTHY R RORICK
Designated Broker | tim.rorick@nrmk.com

NEWMARK