

For Sale  
5 Acres Vacant Land  
Medina County



**SR-83 & White Rd.**  
Lodi, OH 44254

## Property Features

- Sale price: \$250,000
- Frontage: 436' on SR-83  
500' on White Rd.
- Zoning: B-1 General Business
- Topography: Level
- Located: in Harrisville Township just 2,500 ft. north of the I-71/SR-83 Interchange

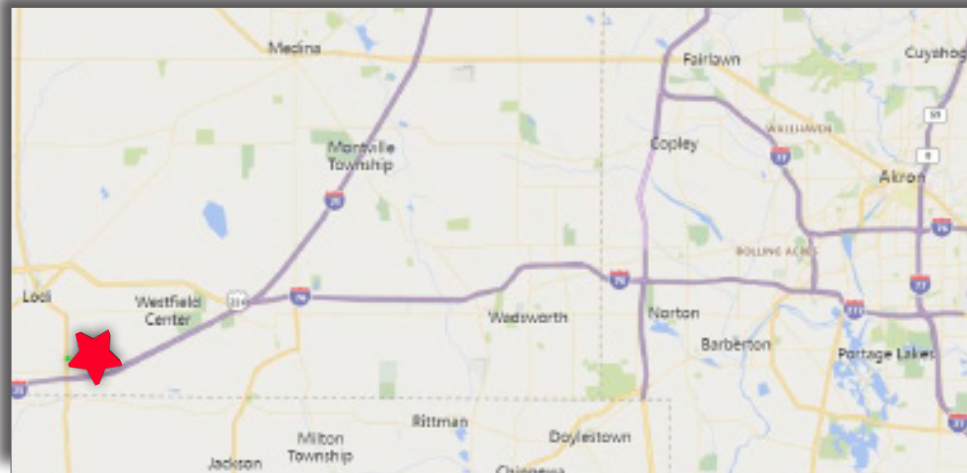

Demographics	1 Mile	3 Miles	5 Miles
<b>Population:</b>	177	5,139	10,287
<b>Households:</b>	64	2,111	4,104
<b>Median Age:</b>	49.6	44.9	46.2
<b>Average HH Income:</b>	\$83,014	\$55,158	\$78,804
<b>Traffic Count:</b>	5,565 cars daily: Avon Lake Rd. @ White Rd.		

For more information:

**Roger Sours, CCIM, MAI**

330 730 5400  
rsours@naipvc.com

NO WARRANTY OR REPRESENTATION, EXPRESS OR IMPLIED, IS MADE AS TO THE ACCURACY OF THE INFORMATION CONTAINED HEREIN, AND THE SAME IS SUBMITTED SUBJECT TO ERRORS, OMISSIONS, CHANGE OF PRICE, RENTAL OR OTHER CONDITIONS, PRIOR SALE, LEASE OR FINANCING, OR WITHDRAWAL WITHOUT NOTICE, AND OF ANY SPECIAL LISTING CONDITIONS IMPOSED BY OUR PRINCIPALS NO WARRANTIES OR REPRESENTATIONS ARE MADE AS TO THE CONDITION OF THE PROPERTY OR ANY HAZARDS CONTAINED THEREIN ARE ANY TO BE IMPLIED.

540 White Pond Dr., Suite A  
Akron, Ohio 44320  
330 535 2661  
[naipvc.com](http://naipvc.com)

SR-83 & White Rd. Lodi, OH 44254

Aerial



# SR-83 & White Rd.

Lodi, OH 44254

For Sale  
5 Acres Vacant Land  
Medina County

## Property Details

<b>ACRES:</b>	5.0 acres
<b>FRONTAGE:</b>	436' on SR-83, 500' on White Rd.
<b>TOPOGRAPHY:</b>	Level
<b>PARCEL #:</b>	013-14d-18-008
<b>HIGHEST &amp; BEST USE:</b>	Commercial Development
<b>ZONING:</b>	B-1 General Business
<b>UTILITIES:</b>	All public
<b>GAS:</b>	Columbia
<b>WATER:</b>	Medina County
<b>SEWER:</b>	Medina County
<b>ELECTRIC:</b>	First Energy

## Price Details

<b>SALE PRICE:</b>	\$250,000
<b>TAXES:</b>	\$116.32
<b>PRICE / FRONT FOOT:</b>	\$267.00
<b>PRICE / ACRE:</b>	\$50,000

## Location Details

<b>INTERCHANGE:</b>	1-71 / SR-83
<b>DISTANCE:</b>	2,500'
<b>DAILY TRAFFIC COUNT:</b>	5,565 cars per day
<b>SUB-MARKET:</b>	Lodi

## Notes

Excellent location for commercial development, just north of I-71. Located in Harrisville Township.



COMMERCIAL REAL ESTATE SERVICES, WORLDWIDE

Roger Sours, CCIM, MAI

330 730 5400  
rsours@naipvc.com

540 White Pond Dr., Suite A  
Akron, Ohio 44320  
330 535 2661

[naipvc.com](http://naipvc.com)

NO WARRANTY OR REPRESENTATION, EXPRESS OR IMPLIED, IS MADE AS TO THE ACCURACY OF THE INFORMATION CONTAINED HEREIN, AND THE SAME IS SUBMITTED SUBJECT TO ERRORS, OMISSIONS, CHANGE OF PRICE, RENTAL OR OTHER CONDITIONS, PRIOR SALE, LEASE OR FINANCING, OR WITHDRAWAL WITHOUT NOTICE, AND OF ANY SPECIAL LISTING CONDITIONS IMPOSED BY OUR PRINCIPALS NO WARRANTIES OR REPRESENTATIONS ARE MADE AS TO THE CONDITION OF THE PROPERTY OR ANY HAZARDS CONTAINED THEREIN ARE ANY TO BE IMPLIED.