

# 52ND AVENUE COMMERCIAL

4541 52nd Ave S | Fargo, ND 58104



COMMERCIAL SPACE FOR LEASE  
1,955 to 10,385 SF



Drew Likness  
drew@advantagefm.com  
701-261-3384  
eagleridgedevelopment.com  
3280 Veterans Boulevard, Suite 300  
Fargo, ND 58104

# 52ND AVENUE COMMERCIAL

4541 52nd Ave S | Fargo, ND 58104

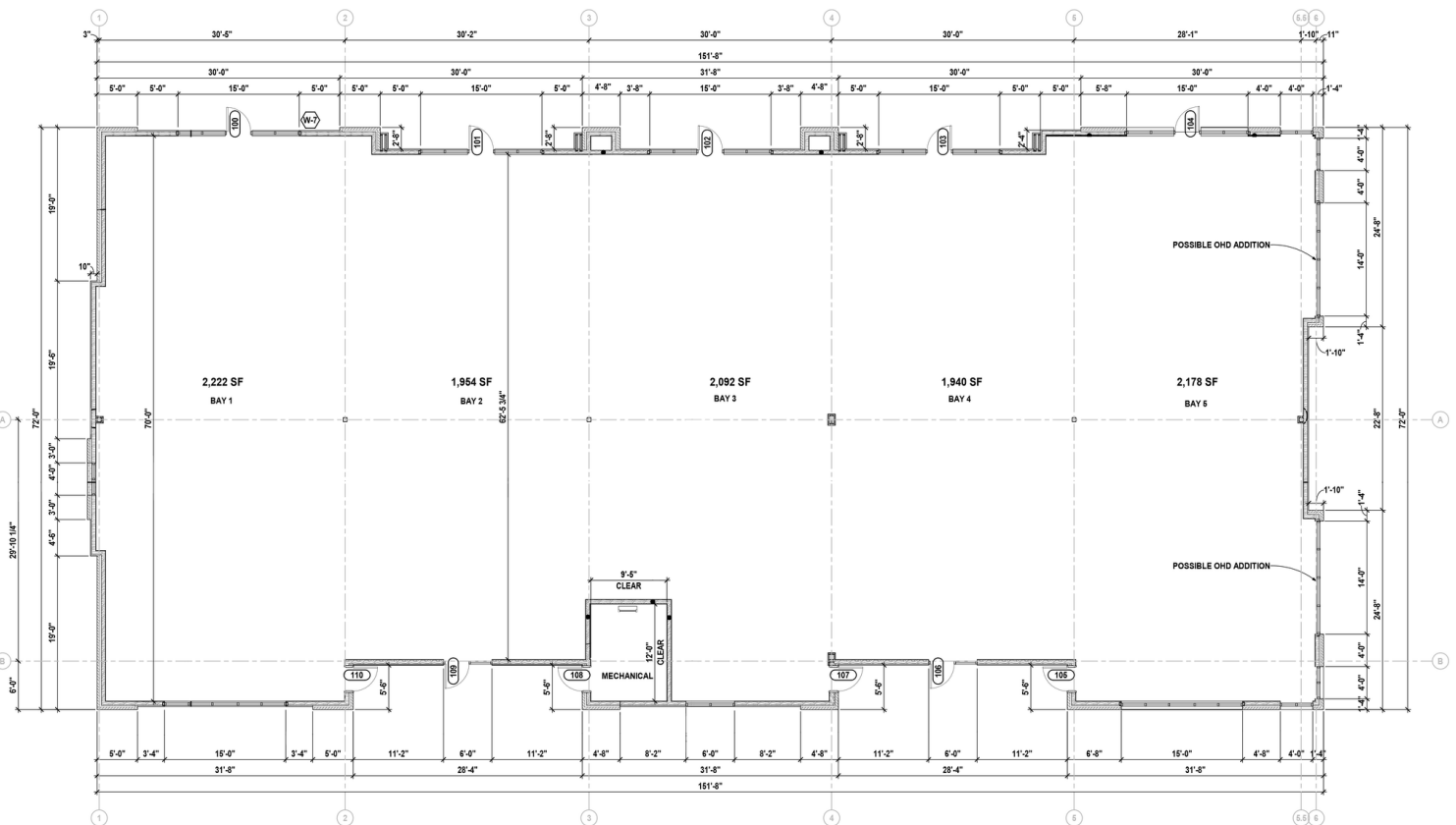

52nd Avenue Commercial is located near the bustling intersection of 52nd Avenue and 45th Street in south Fargo. The building is split into 5 bays, but there is an option to combine bays. Each bay has its own unique storefront and the westernmost bay features a drive through with convenient in and out access. Parking is available on the north, west, and east sides of the building.

## DETAILS

1,955 to 10,385 SF Available

## FEATURES

- 64 Parking Stalls
- Unique Storefronts
- Drive Through on West Side
- Convenient Location
- High Traffic Area

## LEASING INFO

- Rent
  - CAM
  - TI Allowance
  - Taxes
  - Snow Removal / Lawn Care
  - SWG
  - Heat
  - Electricity
  - Phone / Internet
  - Janitorial
- \$22-25/SF Rentable  
\$7/SF  
\$50/SF Usable  
Included in CAM  
Included in CAM  
Included in CAM  
Paid by Tenant  
Paid by Tenant  
Paid by Tenant  
Paid by Tenant

# 52ND AVENUE COMMERCIAL

4541 52nd Ave S | Fargo, ND 58104

## LOCATION

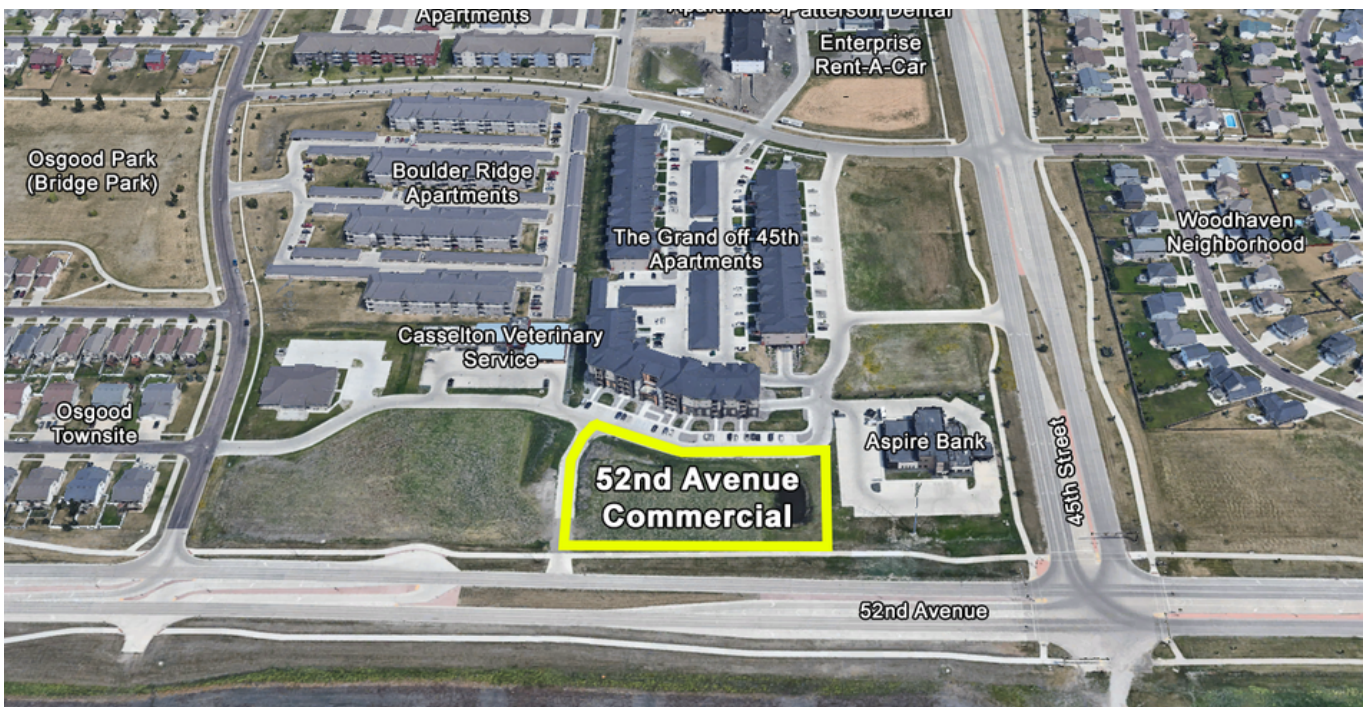
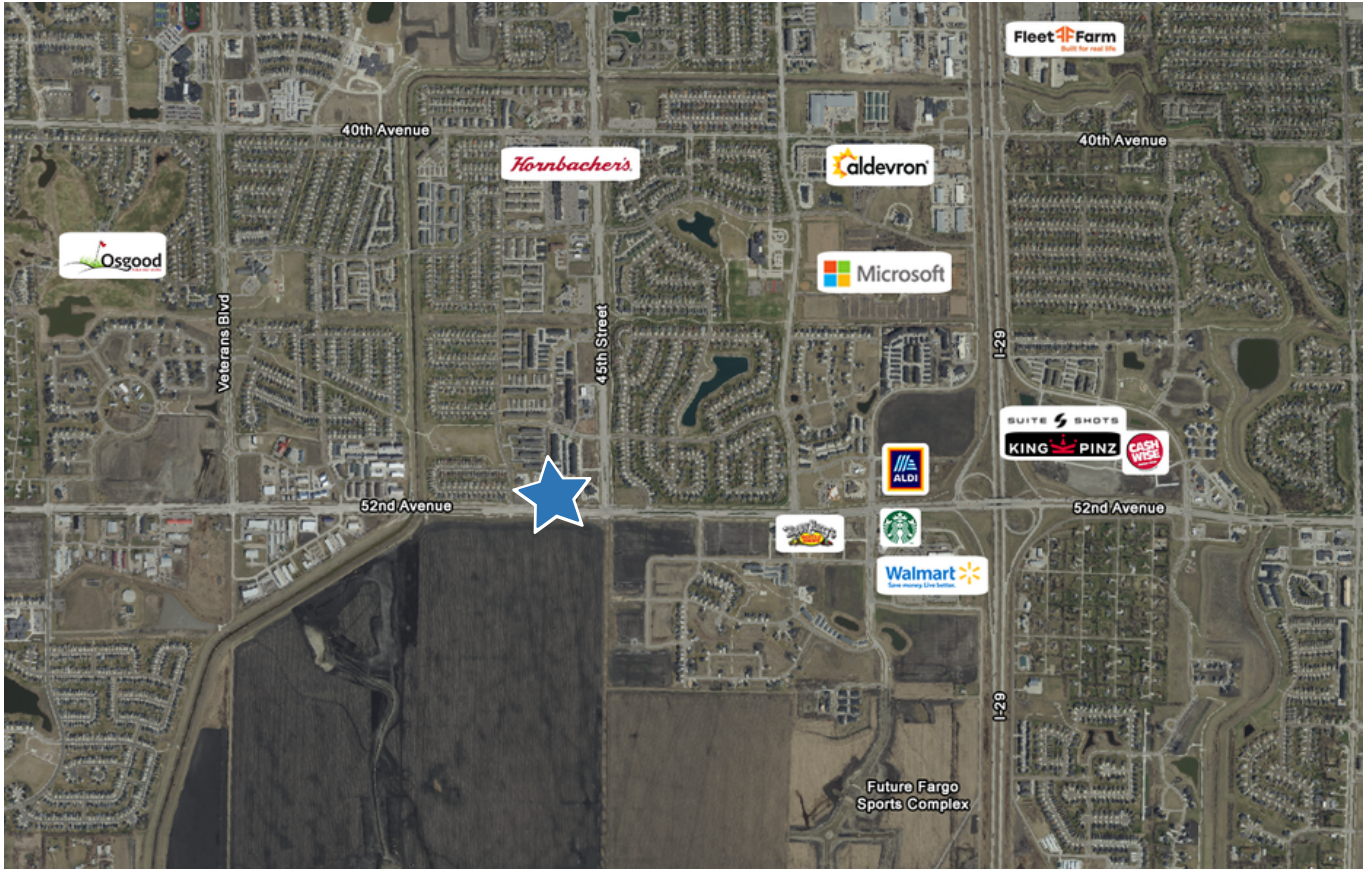

# 52ND AVENUE COMMERCIAL

4541 52nd Ave S | Fargo, ND 58104

## WHY FARGO?

### Demographics

In 2019, Fargo was ranked 11th in the Top 100 Best Places to Live and described as “bursting with opportunities” while offering affordable living options and a strong economy (Livability.com). Fargo is a flourishing community with a continual increase in both population and number of businesses. According to the U.S. Census Bureau, Fargo’s 2019 population was 124,662, which is an 18% increase from 2010. Fargo’s median household income (2019) was \$55,551 and the per capita income (2019) was \$35,205. The median age in Fargo is 31.

North Dakota is a growing state. According to the most recent census, the state’s population grew by 15.8% since 2010. The state ranked fifth in percentage growth across the country.

### Labor & Employers

In 2020, Fargo was ranked #1 in the Top 10 Hottest Job Markets by ZipRecruiter. The current unemployment rate in Fargo is 1.8%, according to the U.S. Bureau of Labor Statistics.

### Geography & Climate

Fargo spans 48.82 square miles in eastern North Dakota. The city shares a border with Moorhead, MN and the Red River divides the two. Fargo experiences all four seasons with temperatures averaging between 0°F and 18°F in January and between 60°F and 83°F in July. The average annual rainfall is 22.6 inches, and the average annual snowfall is 50 inches.



# 52ND AVENUE COMMERCIAL

4541 52nd Ave S | Fargo, ND 58104

## DEVELOPMENT TEAM

EagleRidge Development is a full service real estate firm that entitles, finances, constructs, manages and owns real estate. We are dedicated to building communities that not only meet the needs of tenants and investors, but that also stand the test of time. That is why we follow a process that guarantees success. Since 2009, EagleRidge has developed 2,300+ multifamily units, 2,000+ single family home sites, and over 200,000 square feet of commercial space across Fargo, West Fargo, Moorhead, Bismarck-Mandan, and Minot. Our trusted and experienced team has 100+ years of combined experience in the real estate industry.



### JIM BULLIS

Jim Bullis has been actively engaged in the planning and development of residential and mixed-use communities in the Fargo-Moorhead and surrounding areas for more than 25 years. Mr. Bullis is an attorney licensed to practice in both North Dakota and Minnesota. His legal practice concentrates in the areas of commercial law and real estate development.



### JEFF LALIBERTE

Jeff Laliberte has been the President of EagleRidge Partners, the construction division of EagleRidge, since 2009. Over the past 12 years, Mr. Laliberte has played an active role in the construction of more than 2,300 multifamily units across the states of North Dakota and Minnesota. In addition to this, Mr. Laliberte is the President and Chief Operating Officer of Hebron Brick Company, a role that he has had since 1998.



### JON YOUNESS, PE

Jon Youness joined the EagleRidge Development team in 2013 and has played an integral role in land acquisition, entitlements, and financial analysis for single family and multi-family properties. Mr. Youness also oversees and coordinates the design, permitting, and construction of multiple multi-family and commercial developments and is also actively involved in new product development for EagleRidge Development's construction affiliate.



### DREW LIKNESS

Drew Likness is the Director of Sales for EagleRidge Development and a broker for Advantage Inc., REALTORS®. He has been involved with several developments throughout Fargo, Moorhead, and West Fargo since 2007. Drew is responsible for both residential land sales and commercial sales and leasing.



# EAGLERIDGE

Drew Likness

[drew@advantagefm.com](mailto:drew@advantagefm.com)

701-261-3384

[EagleRidgeDevelopment.com](http://EagleRidgeDevelopment.com)

3280 Veterans Boulevard, Suite 300

Fargo, ND 58104