

WATER LOAD FIXTURE SCHEDULE				
NO.	FIXTURE	# of FIXTURES	W.S.F.U. OF EA. FIXT.	W.S.F.U. TOTAL
1	Water Closet	1	2	2
2	Lavatory	1	1	1
3	3 Compartment Sink	1	4	4
4	Vegetable Sink	1	3	3
5	Service Sink	1	2	2
6	Hand Sink	1	2	2
TOTAL				14

TOILET ROOM PLUMBING FIXTURE SCHEDULE				
TAG	FIXTURE TYPE	FIXTURE	ACCESSORIES	REMARKS
WC	Water Closet	Kohler Highline Model K-3427 or equal	Kohler Seat Model K-4652	Complete installation to be A.D.A. compliant
LAV	Lavatory	Kohler Hudson Model K-2861 or equal	K-7605-P Supply K-8998 P-Trap Delta 501 Single Lever w/ Aerator	Complete installation to be A.D.A. compliant
Note: for A.D.A. notes and accessories see A.1				

- PLUMBING NOTES**
- All work shall meet Chicago Building Code.
 - Contractor shall provide new sanitary, waste & vent piping for new toilet room and kitchen including plumbing fixtures, traps, floor drains, floor cleanouts, and wall cleanouts.
 - Provide new domestic water distribution system including water piping, pipe insulation, hangers, shut-off valves, wall plates, check valves, hot water and thermal insulation and final connections to plumbing fixtures from new toilet room, kitchen.
 - All sanitary waste piping shall be underground min. size 4" cast iron, above ground min. size 2", copper vent/waste pipe type "M", waste line above ground copper type "L" and type "K" below ground.
 - All domestic hot and cold water piping shall be type "L" hard copper with sweat joint fitting. All copper fitting to be foregred with no lead solder/flux.
 - Domestic hot and cold water piping within interior partition walls and interior floors need to be insulated. Piping shall be insulated with 1" thick 3-lb density fiberglass insulation with universal jacket. All shut-off valves in water piping shall be 1215 psi ball valve.
 - Provide complete gas piping system for the new furnace. Gas piping shall be run concealed with shut-off valve at each piece of equipment.
 - Gas piping shall be schedule 40 black steel pipe w/125 psi screw fittings.
 - Provide plumbing fixtures with traps and stops as required and indicated.
 - All work shall be guaranteed for a period of one year.
 - Floor drains for mechanical spaces shall be cast iron body, nickel, or bronze strainer, hose bibbs shall be non-freeze with vacuum breaker system.
 - Plumbing Contractor shall be responsible for providing gas piping system.
 - Owner shall supply all plumbing fixtures and appliances.
 - Contractor shall verify the conditions and grades including water piping, pipe insulation, hangers so that work can be installed properly.
 - Contractor shall provide all necessary clevis hangers for all piping support. Provide 1/2 sleeve 12" long galvanized steel under the pipe insulation at each hanger.
 - All cutting and patching for plumbing trade work shall be by Plumbing Contractor.
 - Provide shut-off valves at all fixtures.
 - Provide 24" air chambers on all main water risers and provide 12" long chambers at all fixtures.
 - Provide temperature control faucet at Toilet Room lavatory.
 - Provide an expansion tank and a relief valve at water heater.
 - Chlorination of domestic water system shall be required after completion of domestic water system and before use. After chlorination open all valves and flush with water until waste water indicates 0.5 ppm residual maximum. Furnish owner with certification of compliance.
 - Water and drainage system shall be tested in compliance to applicable codes. Furnish copy of test results to owner.
 - Provide polished chrome plated escutcheons where pipes pass thru walls at fixtures, where other exposed pipes pass thru walls, floors, ceilings and partitions, provide polished dull chrome plated cast brass set screw flanges.
 - Contractor shall examine all drawings (including civil engineer's site utility plans) and visit the site to determine the full extent of the work and facility locations. Contractor shall verify the requirements of the local governing bodies, the submission of a bid shall be construed as conclusive evidence that the bidder has complied with the above.
 - Verify water pressure with authorities, furnish and install pressure regulating valve(s) to limit interior domestic water system to 80 psi.
 - Contractor shall submit (5) five sets of manufacturer's catalog literature (re: equipment to be furnished on the project) to the architect for approval prior to the release for shipment. Substitution of specified equipment must be approved in writing by the architect prior to the final acceptance by Owner.
 - Contractor shall clean all fixture sand remove all labels.
 - All trenches, backfill, cutting and patching for plumbing trades work shall be done by Plumbing Contractor. All backfill for trenches and excavations shall be clean yellow sand or gravel, free from silt, clay or loam. Do not backfill with on site material. All backfill shall be compacted in 6" layers. Tamp and puddle as required to avoid future settlement. Remove all excess material from the site.
 - Contractor shall install all necessary supports, expansion pipe loops, unions, accessible durable expansion joints (where anchored piping crosses building expansion joints) clean outs, etc.. Isolate all water piping from structure to reduce noise.

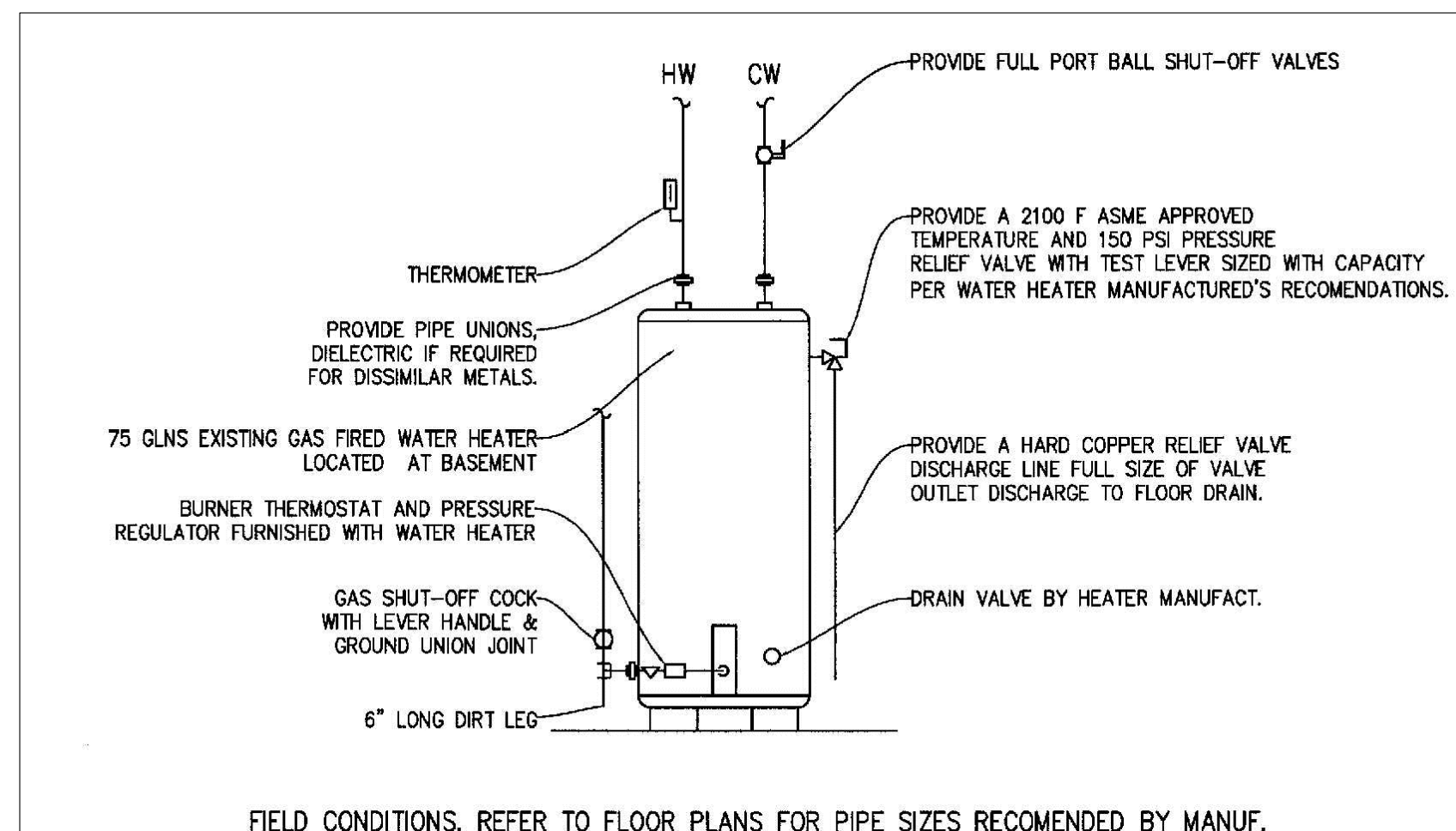
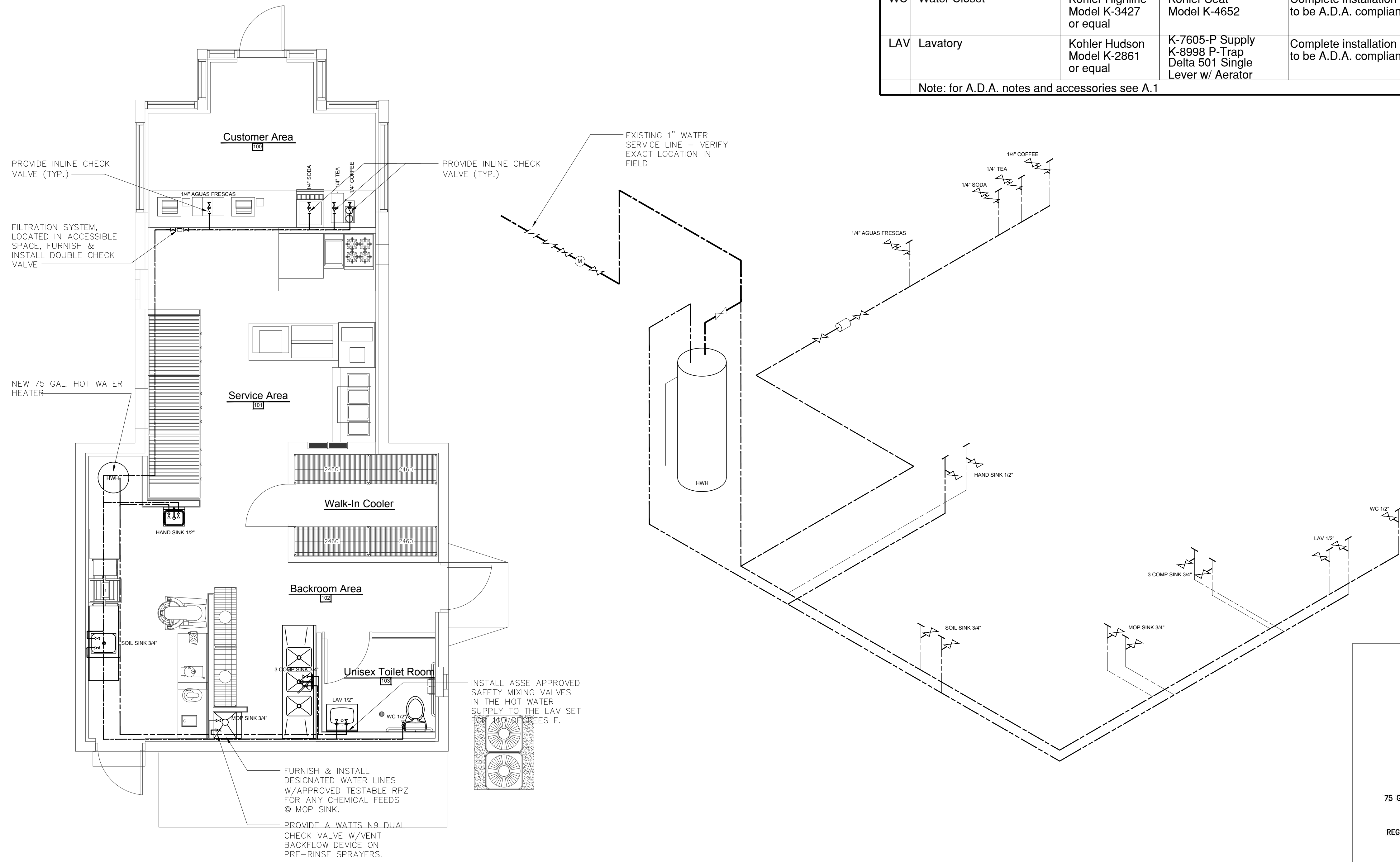

1 FLOOR PLAN - WATER
SCALE: 1/4"=1'-0"

2 WATER RISER DIAGRAM
SCALE: NOT TO SCALE

3 GAS WATER HEATER
SCALE: NOT TO SCALE

**NOT FOR CONSTRUCTION
IN PROGRESS DRAWINGS 4/05/16**

POLLO FELIZ

3958 W. 58th Place
Chicago, IL 60629

Scrafano
architects
Architecture Interiors
Planning

357 W Chicago Ave, Suite
301

Chicago, IL 60654
THESE DRAWINGS AND SPECIFICATIONS ARE THE PROPERTY OF SCRAFANO ARCHITECTS AND NO PART THEREOF SHALL BE COPIED, DISCLOSED TO OTHERS, OR USED IN CONNECTION WITH ANY WORK OR PROJECT OTHER THAN THE SPECIFIC PROJECT FOR WHICH THEY HAVE BEEN PREPARED AND DEVELOPED WITHOUT THE WRITTEN CONSENT OF SCRAFANO ARCHITECTS. VISUAL CONTACT WITH THESE DRAWINGS OR SPECIFICATIONS SHALL CONSTITUTE CONCLUSIVE EVIDENCE OF ACCEPTANCE OF THESE RESTRICTIONS.

COPYRIGHT 2003, SCRAFANO ARCHITECTS.

I hereby certify that these plans were prepared under my direction and to the best of my knowledge and belief conform to the City of Chicago Building codes and Ordinances

Elissa Scrafano
License No. 001-018218

NO.	ISSUE	DATE
1	OWNER REVIEW SET	02-__-16
2		
3		
4		
5		
6		
7		
8		

PLUMBING PLAN
WATER

—N P1.1