

16881 Conneaut Lake Road  
Meadville, PA 16325

**\$18/sf + NNN\***

\*\$2.75/sf NNN includes but not limited to Real Estate Taxes, Insurance, and CAM (such as parking lot maintenance, snow removal, lawn care, etc.)

RETAIL SPACE FOR LEASE

**Aerial – Site View**



**Demographic Data**

	1 mi radius	5 mi radius	10 mi radius
Estimated Population (2022)	1,254	25,793	41,460
Projected Population (2027)	1,170	24,692	40,154
Estimated Households (2022)	600	10,839	17,202
Projected Households (2027)	554	10,126	16,275
Estimated Average Household Income (2021)	\$78,444	\$73,888	\$77,178
Projected Average Household Income (2026)	\$92,237	\$106,257	\$111,563
Total Businesses	177	1,357	1,792
Total Employees	1,873	18,900	22,878

**Space Details**



Join TJ Maxx & Five Below in new center in front of Meadville Hospital

Up to 8,517 sf available – can subdivide per tenant needs Large parking lot with approx. 188 spaces

Located on Conneaut Lake Road with nearly 15,000 VPD

2,162 sf Chipotle with drive-thru coming soon in outparcel

**COCCA DEVELOPMENT, LTD**  
 100 DEBARTOLO PLACE SUITE 400 BOARDMAN, OHIO 44512  
 (330) 729-1010  
[WWW.COCCADEVELOPMENT.COM](http://WWW.COCCADEVELOPMENT.COM)



North Coast Flight School  
Corporate Dr



First National Bank



SALLY BEAUTY



CHEVROLET



Aaron's

SHOE DEPT.



Lew's Land Nature Preserve & Walking



CHRYSLER

PEARLE OOVISION

Jeep



RAM

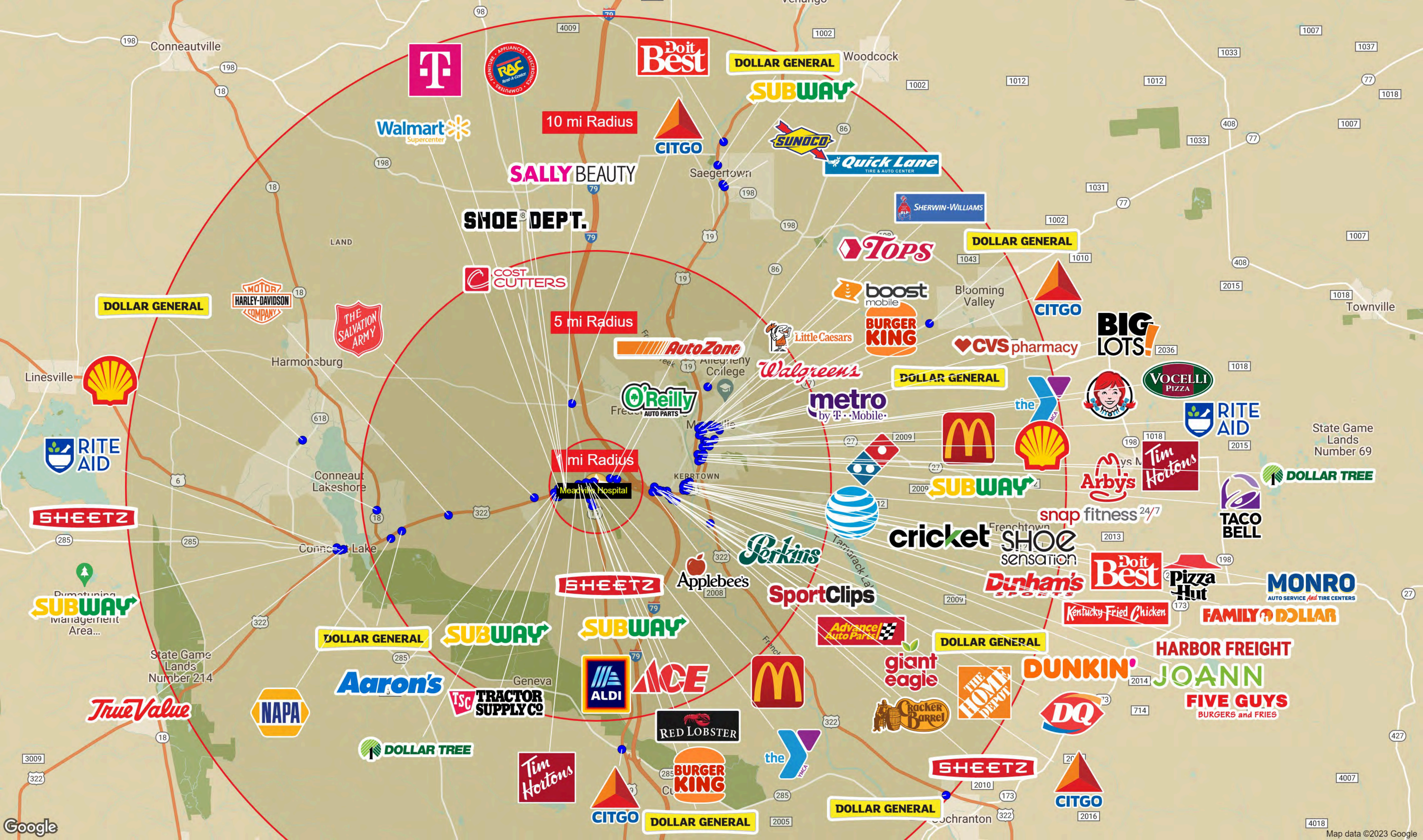

10 mi Radius

5 mi Radius

1 mi Radius

Meadville Hospital

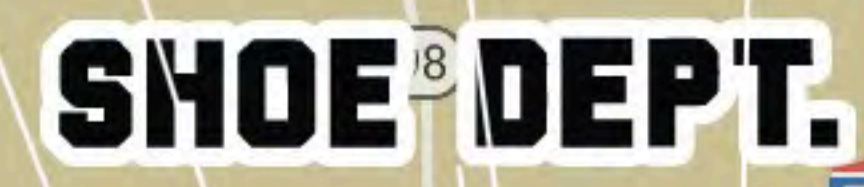

Harmonsburg



Conneaut Lakeshore



Conneaut Lake

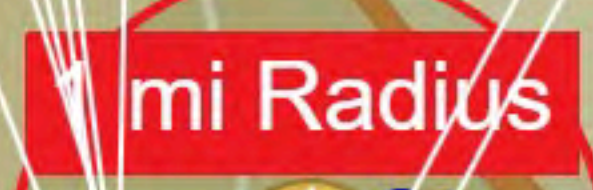

State Game Lands Number 214



Geneva



# SITE

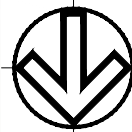
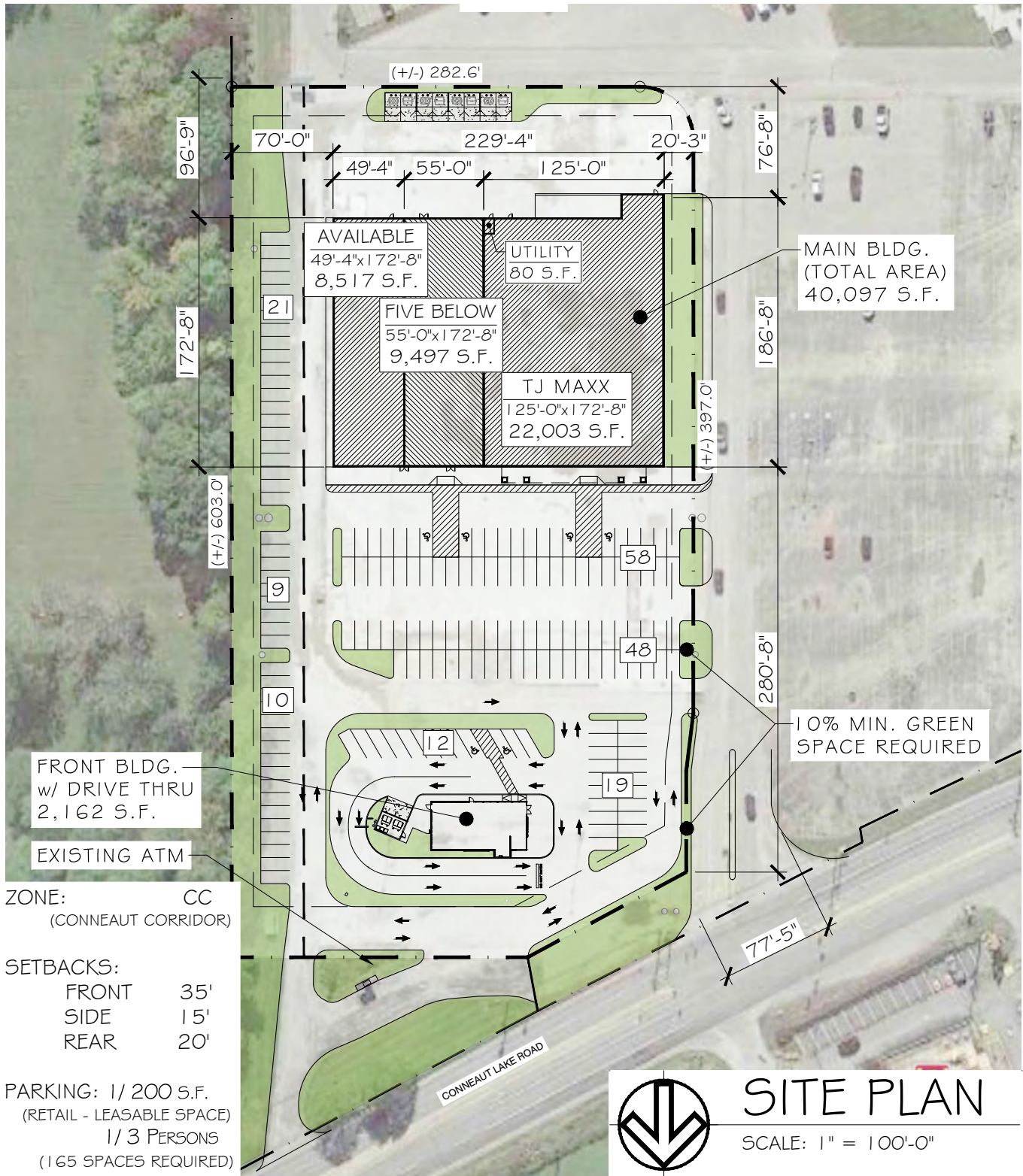

## SITE PLAN

SCALE: 1" = 100'-0"

<b>PRELIMINARY LAYOUT PLAN</b>		CITY, STATE - STREET: 16881 CONNEAUT LAKE ROAD * MEADVILLE, PA 16335 CRAWFORD COUNTY (* EXISTING ADDRESS)		DATE:
				10/16/23
TENANT: COMMERCIAL BUILDING		DEVELOPER	DESIGNER	10/19/23
PROJECT SIZE:		COMPANY: COCCA DEVELOPMENT	COMPANY: COCCA DEVELOPMENT	11/10/23
BLDG. SIZE:	40,097 S.F.	NAME: ANTHONY COCCA	NAME: BILL SCHROEDER	12/14/23
LOT SIZE:	4.33 ACRES	PHONE #: 330-729-1010	PHONE #: 330-729-1010	
PARKING:	177 SPACES			

# Graphic Profile

2010-2020 Census, 2022 Estimates with 2027 Projections  
 Calculated using Weighted Block Centroid from Block Groups

Lat/Lon: 41.6226/-80.1985

**16881 Conneaut Lake Rd**  
**Meadville, PA 16335**

	1 mi radius	5 mi radius	10 mi radius
<b>Population</b>			
Estimated Population (2022)	1,254	25,793	41,460
Projected Population (2027)	1,170	24,692	40,154
Census Population (2020)	1,223	26,328	42,175
Census Population (2010)	1,210	27,030	44,096
Projected Annual Growth (2022-2027)	-84 -1.3%	-1,101 -0.9%	-1,306 -0.6%
Historical Annual Growth (2020-2022)	31 1.3%	-535 -1.0%	-715 -0.9%
Historical Annual Growth (2010-2020)	12 0.1%	-702 -0.3%	-1,921 -0.4%
Estimated Population Density (2022)	399 <i>psm</i>	329 <i>psm</i>	132 <i>psm</i>
Trade Area Size	3.1 <i>sq mi</i>	78.5 <i>sq mi</i>	314.0 <i>sq mi</i>

<b>Race and Ethnicity (2022)</b>			
<b>Not Hispanic or Latino Population</b>			
White	1,157	94.5%	37,221 91.3%
Black or African American	20	1.6%	994 2.4%
American Indian or Alaska Native	-	-	27 -
Asian	17	1.4%	1,669 4.1%
Hawaiian or Pacific Islander	-	-	4 -
Other Race	14	1.1%	334 0.8%
Two or More Races	15	1.3%	520 1.3%
<b>Hispanic or Latino Population</b>			
White	23	77.6%	531 76.8%
Black or African American	-	-	11 1.6%
American Indian or Alaska Native	-	-	1 0.1%
Asian	-	-	8 1.2%
Hispanic Hawaiian or Pacific Islander	-	-	- -
Other Race	5	16.5%	79 11.4%
Two or More Races	1	4.2%	62 8.9%

94.2%

88.7%

91.1%

White

Black or African American

American Indian or Alaskan Native

Asian

Hawaiian or Pacific Islander

Other Race

2+ Races

# Graphic Profile

2010-2020 Census, 2022 Estimates with 2027 Projections  
 Calculated using Weighted Block Centroid from Block Groups

Lat/Lon: 41.6226/-80.1985

16881 Conneaut Lake Rd Meadville, PA 16335		1 mi radius		5 mi radius		10 mi radius	
<b>Age Distribution (2022)</b>							
Age Under 5 Years	69	5.5%	1,483	5.7%	2,226	5.4%	
Age 5 to 9 Years	74	5.9%	1,437	5.6%	2,312	5.6%	
Age 10 to 14 Years	71	5.7%	1,358	5.3%	2,367	5.7%	
Age 15 to 19 Years	62	5.0%	2,077	8.1%	3,059	7.4%	
Age 20 to 24 Years	42	3.3%	2,132	8.3%	2,779	6.7%	
Age 25 to 29 Years	56	4.5%	1,463	5.7%	2,250	5.4%	
Age 30 to 34 Years	64	5.1%	1,393	5.4%	2,157	5.2%	
Age 35 to 39 Years	57	4.5%	1,257	4.9%	2,138	5.2%	
Age 40 to 44 Years	55	4.3%	1,205	4.7%	2,152	5.2%	
Age 45 to 49 Years	61	4.8%	1,232	4.8%	2,166	5.2%	
Age 50 to 54 Years	80	6.4%	1,541	6.0%	2,630	6.3%	
Age 55 to 59 Years	87	7.0%	1,698	6.6%	2,857	6.9%	
Age 60 to 64 Years	102	8.1%	1,917	7.4%	3,215	7.8%	
Age 65 to 69 Years	124	9.9%	1,804	7.0%	3,036	7.3%	
Age 70 to 74 Years	91	7.2%	1,454	5.6%	2,483	6.0%	
Age 75 to 79 Years	72	5.8%	1,002	3.9%	1,610	3.9%	
Age 80 to 84 Years	52	4.2%	730	2.8%	1,113	2.7%	
Age 85 Years or Over	34	2.7%	611	2.4%	911	2.2%	
Median Age	50.0		41.7		43.0		
<b>Generation (2022)</b>							
iGeneration (Age Under 15 Years)	215	17.1%	4,277	16.6%	6,905	16.7%	
Generation 9/11 Millennials (Age 15 to 34 Years)	224	17.9%	7,063	27.4%	10,245	24.7%	
Gen Xers (Age 35 to 49 Years)	172	13.7%	3,694	14.3%	6,456	15.6%	
Baby Boomers (Age 50 to 74 Years)	484	38.6%	8,414	32.6%	14,220	34.3%	
Silent Generation (Age 75 to 84 Years)	125	10.0%	1,733	6.7%	2,723	6.6%	
G.I. Generation (Age 85 Years or Over)	34	2.7%	611	2.4%	911	2.2%	

# Graphic Profile

2010-2020 Census, 2022 Estimates with 2027 Projections  
 Calculated using Weighted Block Centroid from Block Groups

Lat/Lon: 41.6226/-80.1985

**16881 Conneaut Lake Rd**  
**Meadville, PA 16335**

	1 mi radius	5 mi radius	10 mi radius
<b>Household Type (2022)</b>			
Total Households	600	10,839	17,202
Family Households	362 60.4%	6,286 58.0%	10,603 61.6%
Family Households with Children	118 32.5%	1,002 15.9%	1,959 18.5%
Family Households No Children	245 67.5%	5,284 84.1%	8,645 81.5%
Non-Family Households	238 39.6%	4,553 42.0%	6,599 38.4%
Non-Family Households with Children	- -	2 -	4 -
Non-Family Households No Children	237 99.8%	4,551 100.0%	6,594 99.9%

	1 mi radius	5 mi radius	10 mi radius
<b>Education Attainment (2022)</b>			
Elementary or Some High School	78 8.4%	1,175 6.8%	1,991 6.9%
High School Graduate	446 47.7%	8,124 46.9%	13,606 47.4%
Some College or Associate Degree	195 20.9%	3,437 19.9%	6,003 20.9%
Bachelor or Graduate Degree	216 23.1%	4,571 26.4%	7,117 24.8%

	1 mi radius	5 mi radius	10 mi radius
<b>Household Income (2022)</b>			
Estimated Average Household Income	\$78,444	\$73,888	\$77,178
Estimated Median Household Income	\$66,861	\$56,418	\$58,985
HH Income Under \$10,000	11 1.8%	612 5.6%	835 4.9%
HH Income \$10,000 to \$34,999	111 18.4%	2,928 27.0%	4,191 24.4%
HH Income \$35,000 to \$49,999	51 8.5%	1,541 14.2%	2,425 14.1%
HH Income \$50,000 to \$74,999	188 31.3%	2,041 18.8%	3,538 20.6%
HH Income \$75,000 to \$99,999	94 15.6%	1,480 13.7%	2,638 15.3%
HH Income \$100,000 to \$149,999	76 12.7%	1,504 13.9%	2,423 14.1%
HH Income \$150,000 or More	69 11.6%	733 6.8%	1,153 6.7%

# Expanded Profile

2010-2020 Census, 2022 Estimates with 2027 Projections  
 Calculated using Weighted Block Centroid from Block Groups

Lat/Lon: 41.6226/-80.1985

<b>16881 Conneaut Lake Rd</b>		<b>1 mi radius</b>		<b>5 mi radius</b>		<b>10 mi radius</b>	
<b>Meadville, PA 16335</b>							
<b>Population</b>							
Estimated Population (2022)		1,254		25,793		41,460	
Projected Population (2027)		1,170		24,692		40,154	
Census Population (2020)		1,223		26,328		42,175	
Census Population (2010)		1,210		27,030		44,096	
Projected Annual Growth (2022 to 2027)		-84 -1.3%		-1,101 -0.9%		-1,306 -0.6%	
Historical Annual Growth (2020 to 2022)		31 1.3%		-535 -1.0%		-715 -0.8%	
Historical Annual Growth (2010 to 2020)		12 0.5%		-702 -1.3%		-1,921 -2.2%	
Estimated Population Density (2022)		399 psm		329 psm		132 psm	
Trade Area Size		3.1 sq mi		78.5 sq mi		314.0 sq mi	
<b>Households</b>							
Estimated Households (2022)		600		10,839		17,202	
Projected Households (2027)		554		10,126		16,275	
Census Households (2020)		588		11,171		17,665	
Census Households (2010)		571		11,343		18,116	
Estimated Households with Children (2022)		118 19.7%		1,004 9.3%		1,963 11.4%	
Estimated Average Household Size (2022)		2.09		2.20		2.27	
<b>Average Household Income</b>							
Estimated Average Household Income (2022)		\$78,444		\$73,888		\$77,178	
Projected Average Household Income (2027)		\$92,237		\$106,257		\$111,563	
Estimated Average Family Income (2022)		\$114,045		\$93,590		\$96,366	
<b>Median Household Income</b>							
Estimated Median Household Income (2022)		\$66,861		\$56,418		\$58,985	
Projected Median Household Income (2027)		\$80,945		\$68,014		\$71,418	
Estimated Median Family Income (2022)		\$85,274		\$74,065		\$74,180	
<b>Per Capita Income</b>							
Estimated Per Capita Income (2022)		\$37,553		\$31,558		\$32,468	
Projected Per Capita Income (2027)		\$43,639		\$44,108		\$45,678	
Estimated Per Capita Income 5 Year Growth		\$6,086 16.2%		\$12,550 39.8%		\$13,209 40.7%	
Estimated Average Household Net Worth (2022)		\$943,505		\$603,043		\$595,059	
<b>Daytime Demos (2022)</b>							
Total Businesses		177		1,357		1,792	
Total Employees		1,873		18,900		22,878	
Company Headquarter Businesses		8 4.8%		77 5.6%		98 5.5%	
Company Headquarter Employees		99 5.3%		2,946 15.6%		3,542 15.5%	
Employee Population per Business		10.6		13.9		12.8	
Residential Population per Business		7.1		19.0		23.1	



# Expanded Profile

2010-2020 Census, 2022 Estimates with 2027 Projections  
 Calculated using Weighted Block Centroid from Block Groups

Lat/Lon: 41.6226/-80.1985

16881 Conneaut Lake Rd Meadville, PA 16335		1 mi radius		5 mi radius		10 mi radius	
<b>Race &amp; Ethnicity</b>							
White (2022)		1,180	94.1%	22,877	88.7%	37,752	91.1%
Black or African American (2022)		20	1.6%	614	2.4%	1,005	2.4%
American Indian or Alaska Native (2022)		-	-	15	-	28	-
Asian (2022)		17	1.4%	1,610	6.2%	1,677	4.0%
Hawaiian or Pacific Islander (2022)		-	-	3	-	4	-
Other Race (2022)		19	1.5%	274	1.1%	413	1.0%
Two or More Races (2022)		17	1.3%	399	1.5%	582	1.4%
Not Hispanic or Latino Population (2022)		1,224	97.6%	25,308	98.1%	40,768	98.3%
Hispanic or Latino Population (2022)		30	2.4%	485	1.9%	692	1.7%
Not Hispanic or Latino Population (2027)		1,141	97.5%	24,226	98.1%	39,490	98.3%
Hispanic or Latino Population (2027)		30	2.5%	466	1.9%	663	1.7%
Not Hispanic or Latino Population (2020)		1,204	98.4%	25,743	97.8%	41,432	98.2%
Hispanic or Latino Population (2020)		19	1.6%	585	2.2%	743	1.8%
Not Hispanic or Latino Population (2010)		1,204	99.5%	26,691	98.7%	43,655	99.0%
Hispanic or Latino Population (2010)		7	0.5%	339	1.3%	441	1.0%
Projected Hispanic Annual Growth (2022 to 2027)		-	-0.3%	-20	-0.8%	-28	-0.8%
Historic Hispanic Annual Growth (2010 to 2022)		23	29.5%	147	3.6%	251	4.7%
<b>Age Distribution (2022)</b>							
Age Under 5		69	5.5%	1,483	5.7%	2,226	5.4%
Age 5 to 9 Years		74	5.9%	1,437	5.6%	2,312	5.6%
Age 10 to 14 Years		71	5.7%	1,358	5.3%	2,367	5.7%
Age 15 to 19 Years		62	5.0%	2,077	8.1%	3,059	7.4%
Age 20 to 24 Years		42	3.3%	2,132	8.3%	2,779	6.7%
Age 25 to 29 Years		56	4.5%	1,463	5.7%	2,250	5.4%
Age 30 to 34 Years		64	5.1%	1,393	5.4%	2,157	5.2%
Age 35 to 39 Years		57	4.5%	1,257	4.9%	2,138	5.2%
Age 40 to 44 Years		55	4.3%	1,205	4.7%	2,152	5.2%
Age 45 to 49 Years		61	4.8%	1,232	4.8%	2,166	5.2%
Age 50 to 54 Years		80	6.4%	1,541	6.0%	2,630	6.3%
Age 55 to 59 Years		87	7.0%	1,698	6.6%	2,857	6.9%
Age 60 to 64 Years		102	8.1%	1,917	7.4%	3,215	7.8%
Age 65 to 74 Years		215	17.1%	3,258	12.6%	5,518	13.3%
Age 75 to 84 Years		125	10.0%	1,733	6.7%	2,723	6.6%
Age 85 Years or Over		34	2.7%	611	2.4%	911	2.2%
Median Age		50.0		41.7		43.0	
<b>Gender Age Distribution (2022)</b>							
Female Population		641	51.1%	13,338	51.7%	20,991	50.6%
Age 0 to 19 Years		135	21.1%	3,148	23.6%	4,872	23.2%
Age 20 to 64 Years		303	47.3%	7,108	53.3%	11,241	53.6%
Age 65 Years or Over		203	31.6%	3,082	23.1%	4,878	23.2%
Female Median Age		51.7		43.1		44.2	
Male Population		613	48.9%	12,456	48.3%	20,469	49.4%
Age 0 to 19 Years		142	23.1%	3,206	25.7%	5,092	24.9%
Age 20 to 64 Years		301	49.1%	6,730	54.0%	11,102	54.2%
Age 65 Years or Over		171	27.8%	2,520	20.2%	4,275	20.9%
Male Median Age		48.2		40.2		41.7	

# Expanded Profile

2010-2020 Census, 2022 Estimates with 2027 Projections  
 Calculated using Weighted Block Centroid from Block Groups

Lat/Lon: 41.6226/-80.1985

16881 Conneaut Lake Rd Meadville, PA 16335		1 mi radius		5 mi radius		10 mi radius	
<b>Household Income Distribution (2022)</b>							
HH Income \$200,000 or More	53	8.9%	385	3.6%	555	3.2%	
HH Income \$150,000 to \$199,999	16	2.7%	348	3.2%	597	3.5%	
HH Income \$100,000 to \$149,999	76	12.7%	1,504	13.9%	2,423	14.1%	
HH Income \$75,000 to \$99,999	94	15.6%	1,480	13.7%	2,638	15.3%	
HH Income \$50,000 to \$74,999	188	31.3%	2,041	18.8%	3,538	20.6%	
HH Income \$35,000 to \$49,999	51	8.5%	1,541	14.2%	2,425	14.1%	
HH Income \$25,000 to \$34,999	60	10.0%	1,354	12.5%	1,981	11.5%	
HH Income \$15,000 to \$24,999	40	6.7%	1,088	10.0%	1,571	9.1%	
HH Income Under \$15,000	22	3.6%	1,097	10.1%	1,473	8.6%	
HH Income \$35,000 or More	479	79.7%	7,299	67.3%	12,177	70.8%	
HH Income \$75,000 or More	240	39.9%	3,717	34.3%	6,214	36.1%	
<b>Housing (2022)</b>							
Total Housing Units	659		12,493		20,379		
Housing Units Occupied	600	91.2%	10,839	86.8%	17,202	84.4%	
Housing Units Owner-Occupied	492	81.9%	6,638	61.2%	12,046	70.0%	
Housing Units, Renter-Occupied	109	18.1%	4,201	38.8%	5,157	30.0%	
Housing Units, Vacant	58	9.7%	1,654	15.3%	3,177	18.5%	
<b>Marital Status (2022)</b>							
Never Married	225	21.6%	7,485	34.8%	11,182	32.4%	
Currently Married	551	53.0%	8,749	40.7%	15,525	44.9%	
Separated	29	2.8%	536	2.5%	878	2.5%	
Widowed	138	13.3%	1,732	8.1%	2,530	7.3%	
Divorced	97	9.3%	3,013	14.0%	4,441	12.9%	
<b>Household Type (2022)</b>							
Population Family	986	78.6%	18,030	69.9%	30,775	74.2%	
Population Non-Family	268	21.4%	5,797	22.5%	8,330	20.1%	
Population Group Quarters	-	-	1,966	7.6%	2,355	5.7%	
Family Households	362	60.4%	6,286	58.0%	10,603	61.6%	
Non-Family Households	238	39.6%	4,553	42.0%	6,599	38.4%	
Married Couple with Children	84	15.2%	669	7.6%	1,367	8.8%	
Average Family Household Size	2.7		2.9		2.9		
<b>Household Size (2022)</b>							
1 Person Households	207	34.5%	3,806	35.1%	5,578	32.4%	
2 Person Households	244	40.6%	4,183	38.6%	6,785	39.4%	
3 Person Households	64	10.7%	1,357	12.5%	2,271	13.2%	
4 Person Households	58	9.6%	939	8.7%	1,585	9.2%	
5 Person Households	19	3.1%	370	3.4%	649	3.8%	
6 or More Person Households	9	1.5%	184	1.7%	334	1.9%	
<b>Household Vehicles (2022)</b>							
Households with 0 Vehicles Available	11	1.8%	1,270	11.7%	1,678	9.8%	
Households with 1 Vehicles Available	228	38.0%	4,099	37.8%	5,980	34.8%	
Households with 2 or More Vehicles Available	362	60.2%	5,470	50.5%	9,544	55.5%	
Total Vehicles Available	1,105		16,448		28,389		
Average Vehicles Per Household	1.8		1.5		1.7		

# Expanded Profile

2010-2020 Census, 2022 Estimates with 2027 Projections  
 Calculated using Weighted Block Centroid from Block Groups

Lat/Lon: 41.6226/-80.1985

<b>16881 Conneaut Lake Rd</b>		<b>1 mi radius</b>		<b>5 mi radius</b>		<b>10 mi radius</b>	
<b>Meadville, PA 16335</b>							
<b>Labor Force (2022)</b>							
Estimated Labor Population Age 16 Years or Over		1,025		21,218		34,014	
Estimated Civilian Employed		594	57.9%	11,020	51.9%	18,440	54.2%
Estimated Civilian Unemployed		24	2.3%	783	3.7%	972	2.9%
Estimated in Armed Forces		-	-	78	0.4%	100	0.3%
Estimated Not in Labor Force		408	39.8%	9,336	44.0%	14,501	42.6%
Unemployment Rate		2.3%		3.7%		2.9%	
<b>Occupation (2022)</b>							
Occupation: Population Age 16 Years or Over		594		11,020		18,440	
Management, Business, Financial Operations		86	14.5%	1,537	13.9%	2,585	14.0%
Professional, Related		72	12.2%	2,506	22.7%	4,053	22.0%
Service		179	30.1%	2,494	22.6%	3,805	20.6%
Sales, Office		105	17.7%	1,791	16.3%	2,970	16.1%
Farming, Fishing, Forestry		1	0.2%	45	0.4%	126	0.7%
Construct, Extraction, Maintenance		33	5.5%	817	7.4%	1,547	8.4%
Production, Transport Material Moving		118	19.8%	1,831	16.6%	3,354	18.2%
White Collar Workers		264	44.4%	5,833	52.9%	9,608	52.1%
Blue Collar Workers		330	55.6%	5,187	47.1%	8,832	47.9%
<b>Consumer Expenditure (2022)</b>							
Total Household Expenditure		\$35.92 M		\$610.04 M		\$1 B	
Total Non-Retail Expenditure		\$18.93 M	52.7%	\$322.06 M	52.8%	\$528.26 M	52.7%
Total Retail Expenditure		\$16.99 M	47.3%	\$287.98 M	47.2%	\$474.53 M	47.3%
Apparel		\$1.24 M	3.4%	\$21.08 M	3.5%	\$34.59 M	3.4%
Contributions		\$1.2 M	3.3%	\$19.55 M	3.2%	\$32.12 M	3.2%
Education		\$1 M	2.8%	\$16.83 M	2.8%	\$27.3 M	2.7%
Entertainment		\$2.03 M	5.6%	\$33.95 M	5.6%	\$55.98 M	5.6%
Food and Beverages		\$5.27 M	14.7%	\$90.38 M	14.8%	\$148.56 M	14.8%
Furnishings and Equipment		\$1.26 M	3.5%	\$21.15 M	3.5%	\$34.89 M	3.5%
Gifts		\$894.04 K	2.5%	\$14.53 M	2.4%	\$23.74 M	2.4%
Health Care		\$3.15 M	8.8%	\$53.24 M	8.7%	\$87.88 M	8.8%
Household Operations		\$1.42 M	4.0%	\$23.78 M	3.9%	\$39.09 M	3.9%
Miscellaneous Expenses		\$684.18 K	1.9%	\$11.55 M	1.9%	\$18.99 M	1.9%
Personal Care		\$481 K	1.3%	\$8.2 M	1.3%	\$13.47 M	1.3%
Personal Insurance		\$252.62 K	0.7%	\$4.14 M	0.7%	\$6.86 M	0.7%
Reading		\$80.33 K	0.2%	\$1.34 M	0.2%	\$2.21 M	0.2%
Shelter		\$7.48 M	20.8%	\$128.92 M	21.1%	\$210.82 M	21.0%
Tobacco		\$221.19 K	0.6%	\$3.99 M	0.7%	\$6.51 M	0.6%
Transportation		\$6.57 M	18.3%	\$110.92 M	18.2%	\$183.24 M	18.3%
Utilities		\$2.7 M	7.5%	\$46.51 M	7.6%	\$76.54 M	7.6%
<b>Educational Attainment (2022)</b>							
Adult Population Age 25 Years or Over		936		17,308		28,717	
Elementary (Grade Level 0 to 8)		5	0.5%	197	1.1%	515	1.8%
Some High School (Grade Level 9 to 11)		73	7.8%	978	5.7%	1,475	5.1%
High School Graduate		446	47.7%	8,124	46.9%	13,606	47.4%
Some College		100	10.7%	2,161	12.5%	3,812	13.3%
Associate Degree Only		95	10.1%	1,276	7.4%	2,191	7.6%
Bachelor Degree Only		111	11.8%	2,690	15.5%	4,290	14.9%
Graduate Degree		105	11.2%	1,881	10.9%	2,827	9.8%

# Expanded Profile

2010-2020 Census, 2022 Estimates with 2027 Projections  
 Calculated using Weighted Block Centroid from Block Groups

Lat/Lon: 41.6226/-80.1985

<b>16881 Conneaut Lake Rd</b>		<b>1 mi radius</b>		<b>5 mi radius</b>		<b>10 mi radius</b>	
<b>Meadville, PA 16335</b>							
<b>Units In Structure (2022)</b>							
1 Detached Unit		342	59.8%	7,360	64.9%	12,604	69.6%
1 Attached Unit		31	5.4%	284	2.5%	334	1.8%
2 to 4 Units		60	10.4%	1,104	9.7%	1,313	7.2%
5 to 9 Units		54	9.4%	744	6.6%	818	4.5%
10 to 19 Units		15	2.6%	251	2.2%	274	1.5%
20 to 49 Units		2	0.3%	158	1.4%	186	1.0%
50 or More Units		6	1.1%	279	2.5%	313	1.7%
Mobile Home or Trailer		91	16.0%	658	5.8%	1,358	7.5%
Other Structure	-	-		2	-	3	-
<b>Homes Built By Year (2022)</b>							
Homes Built 2010 or later		4	0.7%	183	1.6%	394	2.2%
Homes Built 2000 to 2009		48	8.3%	571	5.0%	1,194	6.6%
Homes Built 1990 to 1999		85	14.9%	781	6.9%	1,403	7.7%
Homes Built 1980 to 1989		44	7.8%	769	6.8%	1,503	8.3%
Homes Built 1970 to 1979		152	26.6%	1,863	16.4%	3,204	17.7%
Homes Built 1960 to 1969		113	19.8%	1,511	13.3%	1,919	10.6%
Homes Built 1950 to 1959		89	15.6%	1,352	11.9%	1,943	10.7%
Homes Built Before 1949		65	11.3%	3,809	33.6%	5,643	31.2%
<b>Home Values (2022)</b>							
Home Values \$1,000,000 or More	-	-		6	-	12	-
Home Values \$500,000 to \$999,999		16	3.3%	239	3.6%	384	3.2%
Home Values \$400,000 to \$499,999		9	1.8%	185	2.8%	264	2.2%
Home Values \$300,000 to \$399,999		26	5.3%	332	5.0%	750	6.2%
Home Values \$200,000 to \$299,999		108	22.0%	1,086	16.4%	2,094	17.4%
Home Values \$150,000 to \$199,999		102	20.8%	1,142	17.2%	2,195	18.2%
Home Values \$100,000 to \$149,999		59	11.9%	1,365	20.6%	2,468	20.5%
Home Values \$70,000 to \$99,999		56	11.4%	995	15.0%	1,709	14.2%
Home Values \$50,000 to \$69,999		21	4.3%	325	4.9%	615	5.1%
Home Values \$25,000 to \$49,999		24	4.8%	352	5.3%	518	4.3%
Home Values Under \$25,000		70	14.3%	612	9.2%	1,038	8.6%
Owner-Occupied Median Home Value		\$156,308		\$138,713		\$142,953	
Renter-Occupied Median Rent		\$919		\$613		\$601	
<b>Transportation To Work (2022)</b>							
Drive to Work Alone		562	94.5%	8,480	76.9%	14,363	77.9%
Drive to Work in Carpool		7	1.2%	749	6.8%	1,451	7.9%
Travel to Work by Public Transportation	-	-		46	0.4%	57	0.3%
Drive to Work on Motorcycle	-	-		9	-	37	0.2%
Walk or Bicycle to Work		8	1.3%	801	7.3%	933	5.1%
Other Means	-	-		58	0.5%	110	0.6%
Work at Home		16	2.7%	878	8.0%	1,489	8.1%
<b>Travel Time (2022)</b>							
Travel to Work in 14 Minutes or Less		300	50.5%	5,375	48.8%	7,570	41.1%
Travel to Work in 15 to 29 Minutes		202	34.1%	2,940	26.7%	5,667	30.7%
Travel to Work in 30 to 59 Minutes		52	8.7%	1,289	11.7%	2,710	14.7%
Travel to Work in 60 Minutes or More		23	4.0%	538	4.9%	1,005	5.4%
Average Minutes Travel to Work		13.7		13.6		15.9	