

±7,775 SF BUILDING ON ±0.36 ACRES



FOR SALE OR LEASE

155 GRIFFIN STREET

SALINAS, CA 93901





PROPERTY HIGHLIGHTS

SALES PRICE:

\$1,830,000

LEASE RATE:

**\$1.25 PSF GROSS AT
\$9,700 PER MONTH**

APN:

003-062-016

- Building 7,775 Sqft Lot: 15,736 Sqft
- 10' Interior Clearance
- 2 - New Roll Up doors 9'W x 10'H
- 2 - New ADA bathrooms
- New 6" thick concrete Floors with re-bar
- New roof with sky lights
- New Siding
- New Electrical -
120/240v 125 amps single phase
- New lighting interior and exterior
- New Windows
- New exterior fencing with 16'14" wide sliding gate
- New fully landscape with irrigation system
- New concrete all the way around the building with drainage

155 GRIFFIN STREET
SALINAS, CA 93901

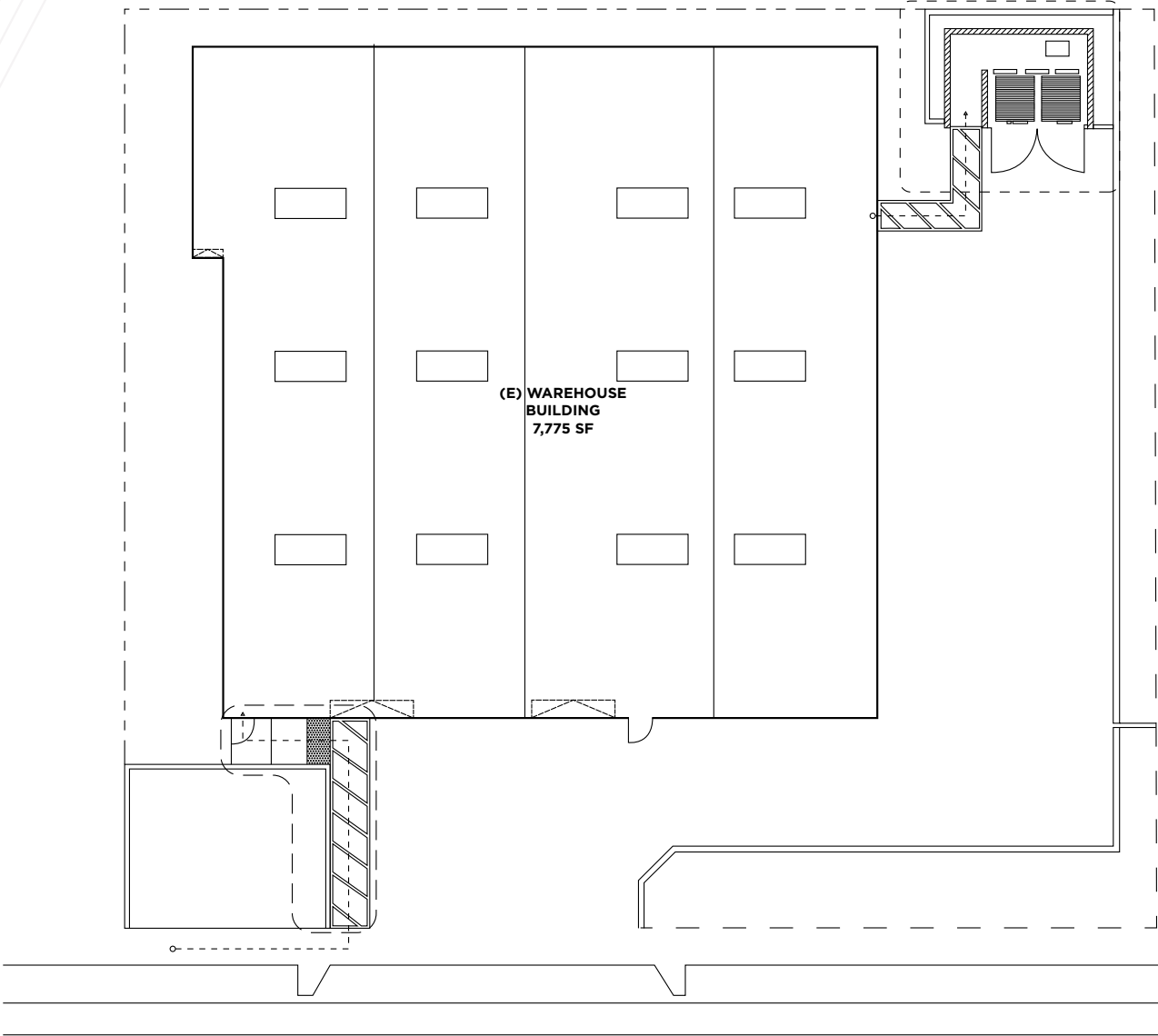

GRIFFIN ST.

155 GRIFFIN STREET
SALINAS, CA 93901



155 GRIFFIN STREET
SALINAS, CA 93901





FOR MORE INFORMATION, CONTACT:

GREG FINDLEY

Managing Director
+1 831 755 1639
greg.findley@cushwake.com
Lic #01170453

MICHAEL BASSETTI

Director
+1 831 737 1124
michael.bassetti@cushwake.com
Lic #01422049

WOODY FENLEY

Associate
+1 831 320 8060
richard.fenley@cushwake.com
Lic #02253434

328-B Main Street, Salinas, CA 93901

©2025 Cushman & Wakefield. All rights reserved. The information contained in this communication is strictly confidential. This information has been obtained from sources believed to be reliable but has not been verified. No warranty or representation, express or implied, is made as to the condition of the property (or properties) referenced herein or as to the accuracy or completeness of the information contained herein, and same is submitted subject to errors, omissions, change of price, rental or other conditions, withdrawal without notice, and to any special listing conditions imposed by the property owner(s). Any projections, opinions or estimates are subject to uncertainty and do not signify current or future property performance.

