For Lease MacFarlane Center Medical Office Building

8352 W. WARM SPRINGS ROAD,
LAS VEGAS, NV 89113



NEWMARK

FOR LEASE

8352 W. Warm Springs Road

Las Vegas, NV 89113



Building Size	40,000 SF
Available SF	2,530 SF
Parking	3.45/1,000 SF
Year Built	2009
Office Class	A
CAM	\$0.61
Lease Rate Per SF	\$2.15 NNN
Available for Lease	December 1, 2026

HIGHLIGHTS

This is the first medical stop on Durango coming from Southern Highlands, Mountain Edge and Arlington Ranch. In the center of the SW housing market next to Rhodes Ranch and Nevada Trails. Retail services within one mile for staff and clients include: banking, restaurants, dry-cleaning. Close to 3 major hospitals.

FOR LEASE

SUITE 210

2,530 SF

SUITE HIGHLIGHTS

- 13 Exam Rooms
- 2 Doctor's Offices
- 2 In-Suite Restrooms
- Break Room
- Nurse's Station
- Storage
- Dual Reception Areas
- Administration Area

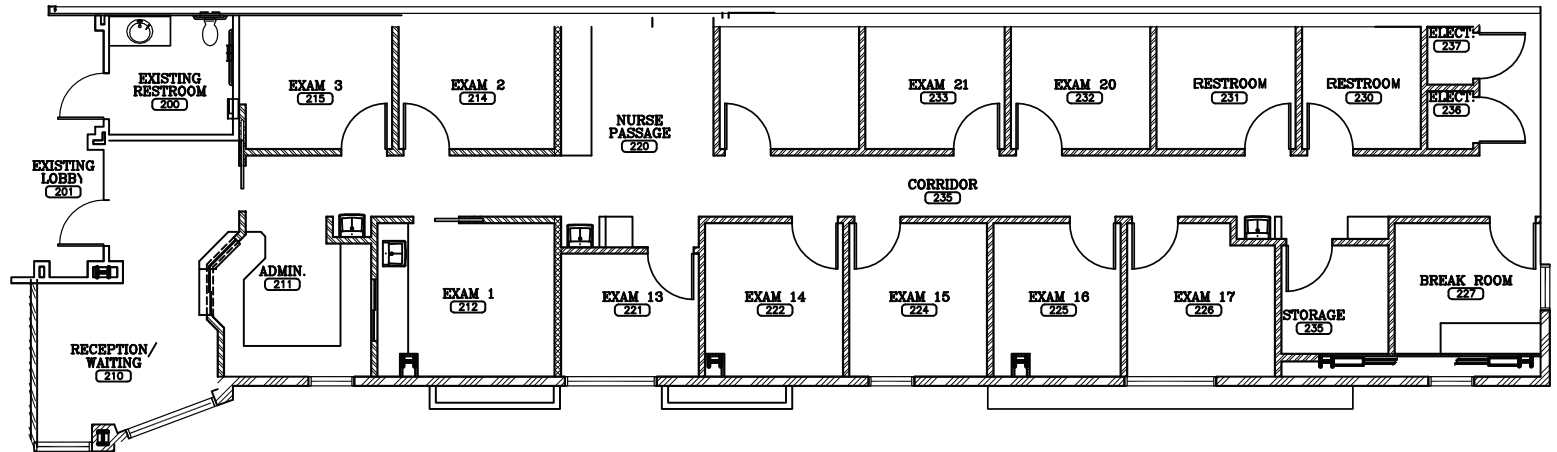

FOR LEASE



NEWMARK

FOR LEASE



NEWMARK

FOR LEASE

For Lease

8352 W. WARM SPRINGS ROAD,
LAS VEGAS, NV 89113

Prepared by:

Mike Tabeek, SIOR, CCIM
Senior Managing Director

t 702-405-1750
mike.tabeek@nmrk.com
NV RE Lic. #B.0145775

Thomas Olsen
Associate

t 702-405-1714
thomas.olsen@nmrk.com
NV RE Lic. #S.0200270



The information contained herein has been obtained from sources deemed reliable but has not been verified and no guarantee, warranty or representation, either express or implied, is made with respect to such information. Terms of sale or lease and availability are subject to change or withdrawal without notice.