

FOR SALE

5350 BALL GROUND HIGHWAY, BALL GROUND, GA 30107

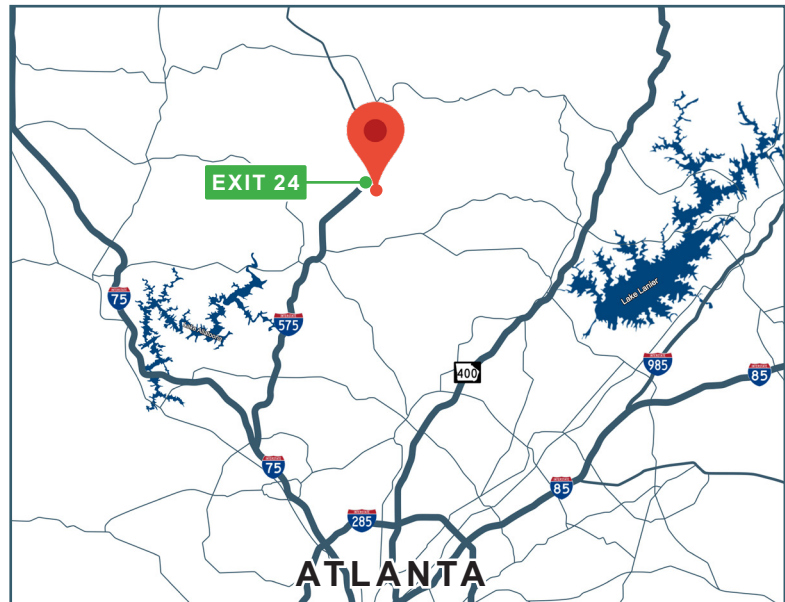

TOTAL BUILDING SIZE	27,000 SF
BUILDING DIMENSIONS	270' D X 100' W
DOCK HIGH COVERED OPEN STORAGE	9,920 SF
OFFICE	6,000 SF
CLEAR HEIGHT	20' - 30'
COLUMN SPACING	Clear Span (No Columns)
TRUCK DOORS	7 Dock-High, 1 Drive-In
FIRE PROTECTION	Wet Sprinkler
ZONING	Light Industrial
LOCATION	Hwy 5 / Airport Drive Intersection, 0.5 miles to I-575



All information contained herein is believed to be accurate but is not warranted. This offer is subject to errors, omissions, prior sale or withdrawal.



Hughes Commercial Real Estate, Inc.
8215 Roswell Road, Building 700
Atlanta, GA 30350
770-559-1099 | hughes-cre.com

Cade McDonald
404-307-5166

cade@hughes-cre.com

FOR SALE

5350 BALL GROUND HIGHWAY, BALL GROUND, GA 30107

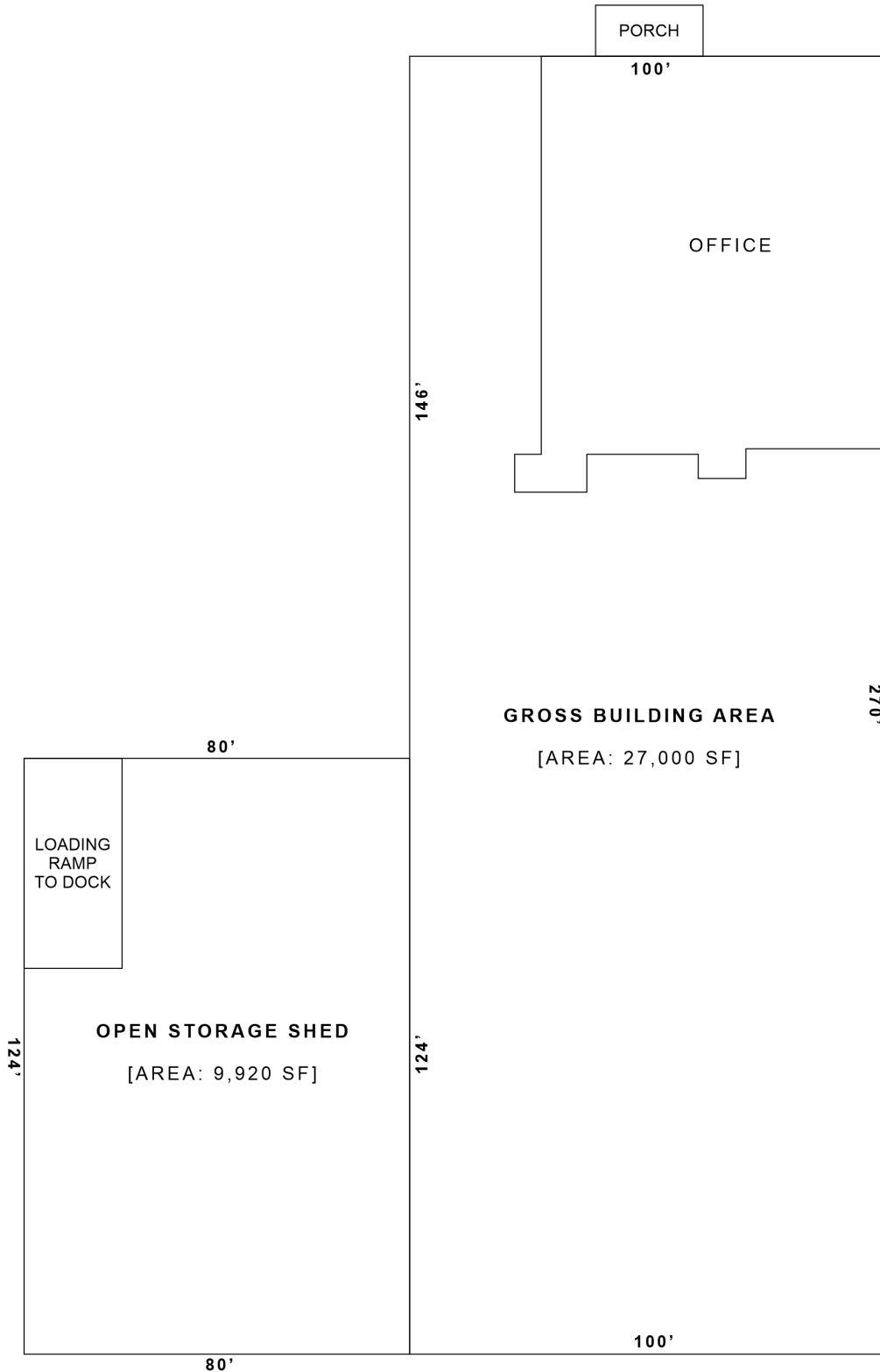

All information contained herein is believed to be accurate but is not warranted. This offer is subject to errors, omissions, prior sale or withdrawal.



Hughes Commercial Real Estate, Inc.
8215 Roswell Road, Building 700
Atlanta, GA 30350
770-559-1099 | hughes-cre.com

Cade McDonald
404-307-5166
cade@hughes-cre.com

FOR SALE

5350 BALL GROUND HIGHWAY, BALL GROUND, GA 30107



All information contained herein is believed to be accurate but is not warranted. This offer is subject to errors, omissions, prior sale or withdrawal.



Hughes Commercial Real Estate, Inc.
8215 Roswell Road, Building 700
Atlanta, GA 30350
770-559-1099 | hughes-cre.com

Cade McDonald
404-307-5166
cade@hughes-cre.com