



For Lease

LARC INDUSTRIAL BURNSVILLE

1331 Larc Industrial Blvd, Burnsville, MN 55337

ETHAN FINGER

Vice President
(507) 581-3479
Ethan@obsidiangroup.com





Property Profile

This property is located in a high-demand industrial park in Burnsville, Minnesota. Currently set up as a turn-key auto body shop, the flexible layout also allows for easy conversion to a variety of other uses.

Address

1331 Larc Industrial Blvd, Burnsville, MN



Availability

Approx. 8,300 SF

- 15' Clear
- Two 14' Drive-In
- One 12' Drive-In
- Floor Drains

Rent + CAM/Tax:

Negotiable (NNN) + \$5.00/sf (2025)



Zoning

I-1 (Industrial)

Uses

Auto/General Warehouse

Available Space

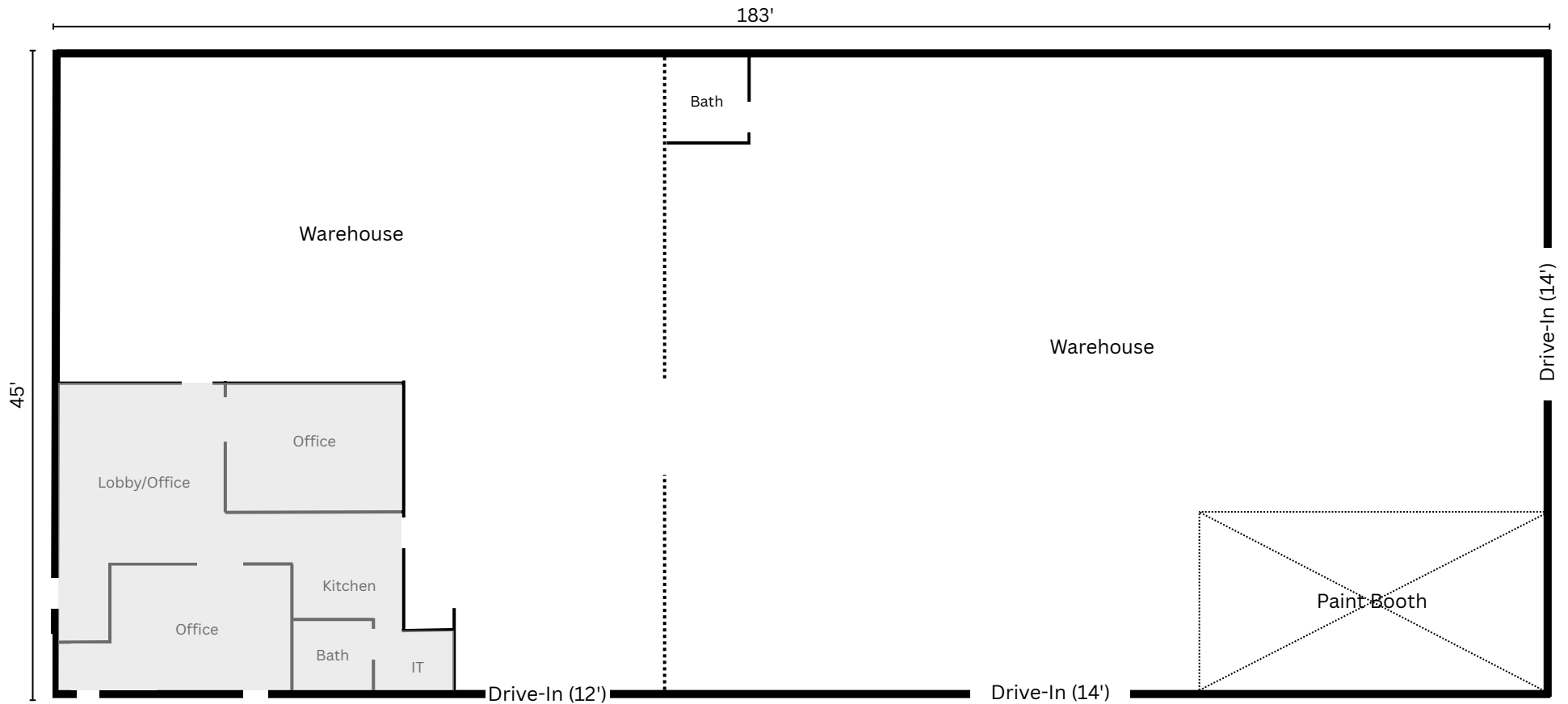

Suite A

Approx. 8,300 SF

- 15' Clear
- Two 14' Drive- In
- One 12' Drive In



Property Photos



Property Aerial

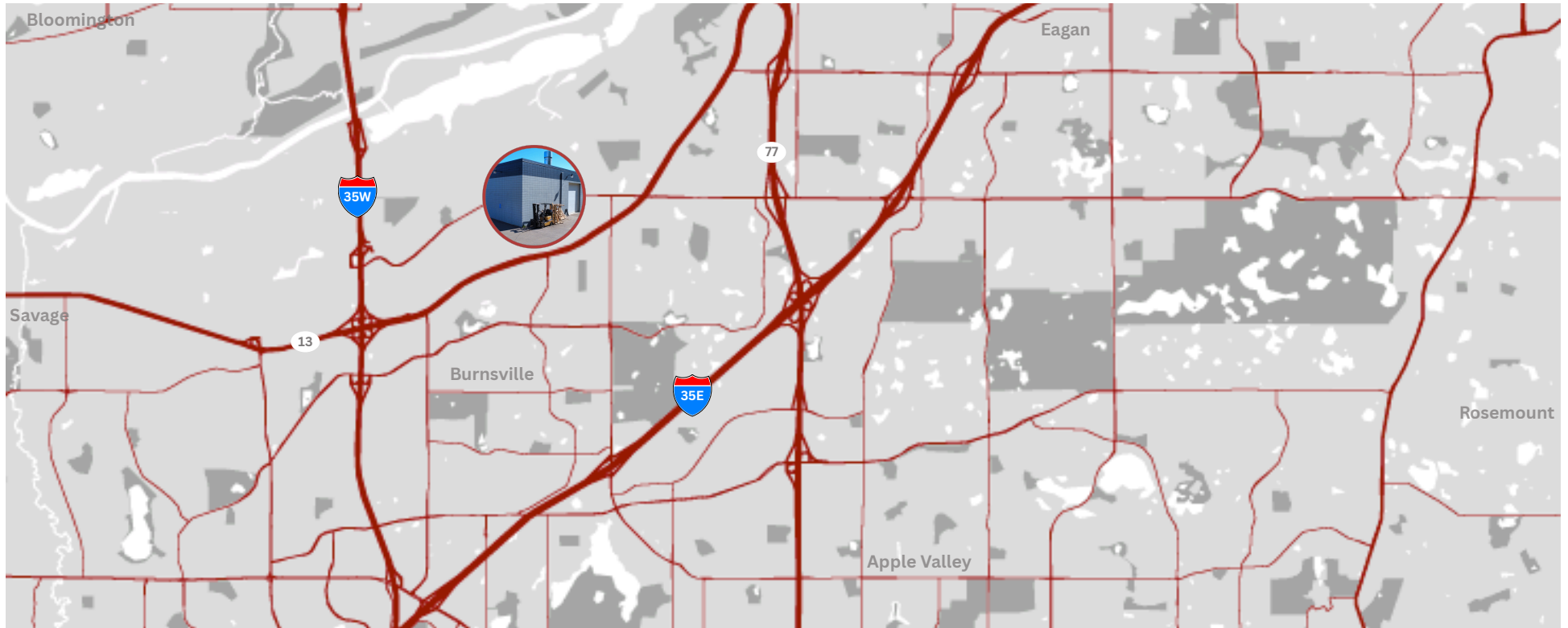

POPULATION		1 MILE	3 MILES
POPULATION		10,247	69,228
MEDIAN AGE		37	39
DAYTIME EMPLOYEES		7,216	28,651
HOUSEHOLDS		1 MILE	3 MILES
HOUSEHOLDS		4,441	27,991
MEDIAN HH INCOME		\$75,792	\$82,734



For more Information on

LARC INDUSTRIAL BURNSVILLE

1331 Larc Industrial Blvd, Burnsville, MN 55337

ETHAN FINGER

Vice President
(507) 581-3479
Ethan@obsidiangroup.com

This information has been obtained from sources believed reliable, but has not been verified for accuracy or completeness. Any projections, opinions, or estimates are subject to uncertainty. The information may not represent the current or future performance of the property. You and your advisors should conduct a careful, independent investigation of the property and verify all information. Any reliance on this information is solely at your own risk.



OBSIDIAN
— GROUP —