

INDUSTRIAL BUILDING FOR SUBLEASE

150 REED CT, CHULA VISTA, CA 91911



Building Features

±27,966 SF building

±3,000 SF of office external to building

One (1) dock-high door

Two (2) roll-up doors (14' x 16')

600 amps, 220 3-phase power

Fully fenced yard space of ±18,900 SF

15 parking spaces

Sublease Rate: \$1.00/SF MG

FOR MORE
INFORMATION
PLEASE CONTACT

MICHAEL LAMBESIS
858.369.3188
michael.lambesis@kidder.com
LIC N° 02071129

BRANDON VOGT
858.369.3187
brandon.vogt@kidder.com
LIC N° 02161018

KIDDER.COM

This information supplied herein is from sources we deem reliable. It is provided without any representation, warranty, or guarantee, expressed or implied as to its accuracy. Prospective Buyer or Tenant should conduct an independent investigation and verification of all matters deemed to be material, including, but not limited to, statements of income and expenses. Consult your attorney, accountant, or other professional advisor.



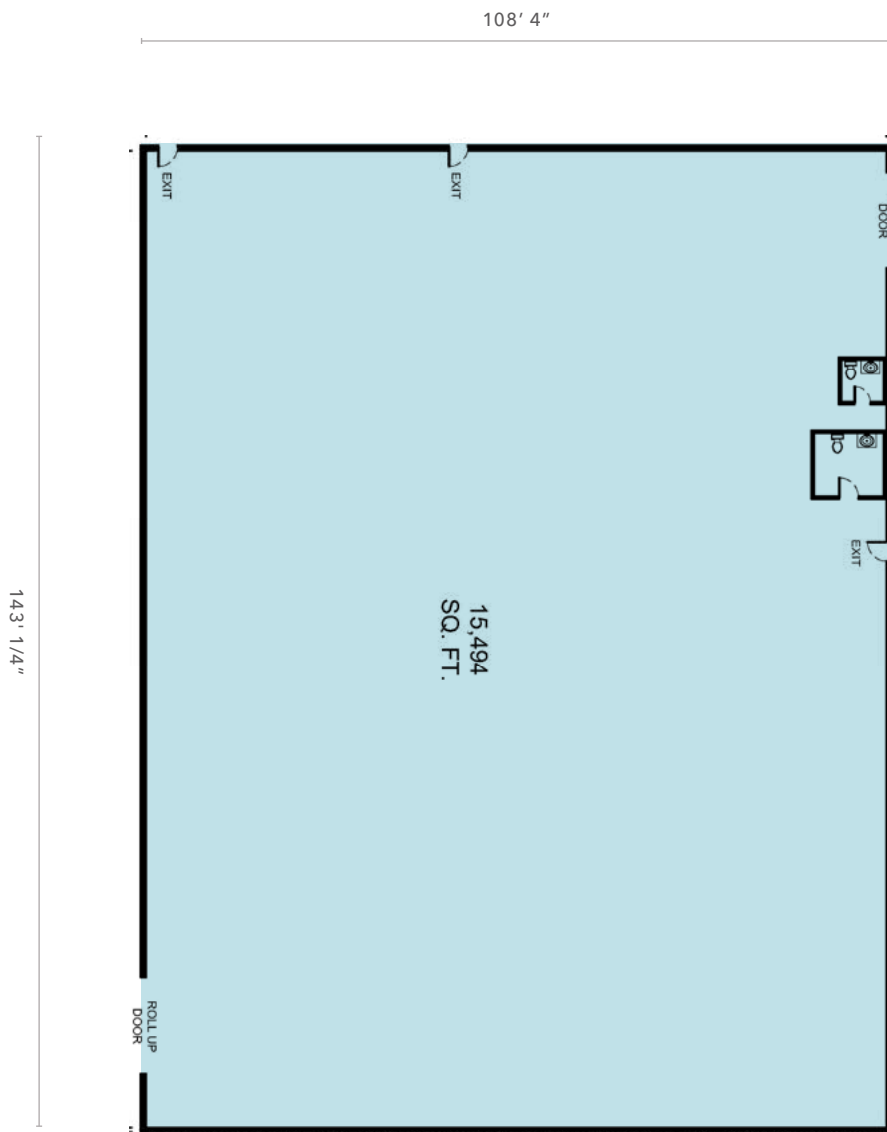

±27,966 SF

AVAILABLE

\$1.00/SF MG

SUBLEASE RATE

NOW

AVAILABLE

FOR MORE
INFORMATION
PLEASE CONTACT

MICHAEL LAMBESIS
858.369.3188
michael.lambesis@kidder.com
LIC N° 02071129

BRANDON VOGT
858.369.3187
brandon.vogt@kidder.com
LIC N° 02161018

KIDDER.COM

This information supplied herein is from sources we deem reliable. It is provided without any representation, warranty, or guarantee, expressed or implied as to its accuracy. Prospective Buyer or Tenant should conduct an independent investigation and verification of all matters deemed to be material, including, but not limited to, statements of income and expenses. Consult your attorney, accountant, or other professional advisor.



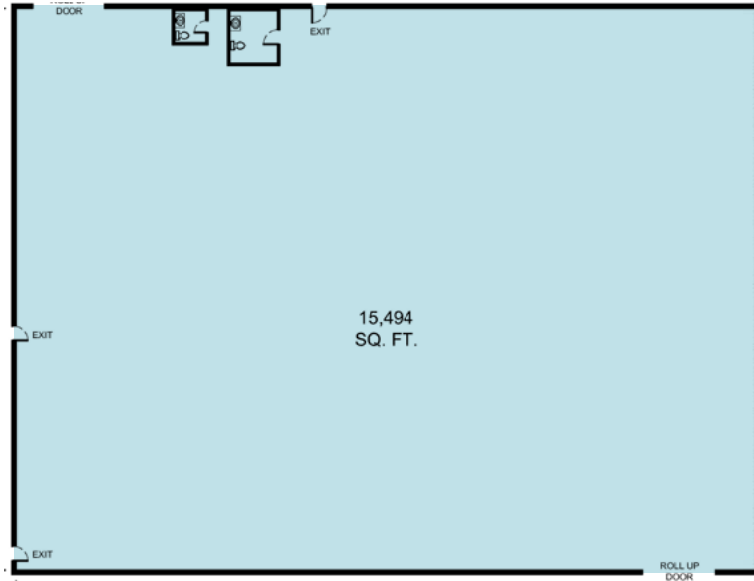

±27,966 SF

AVAILABLE

\$1.00/SF MG

SUBLEASE RATE

NOW

AVAILABLE



KIDDER.COM

This information supplied herein is from sources we deem reliable. It is provided without any representation, warranty, or guarantee, expressed or implied as to its accuracy. Prospective Buyer or Tenant should conduct an independent investigation and verification of all matters deemed to be material, including, but not limited to, statements of income and expenses. Consult your attorney, accountant, or other professional advisor.

