

Prologis Riverside

8080 Troon Circle, Suite 100

Austell, Georgia 30168



PROLOGIS®

18,916 Square Feet Industrial Space For Lease

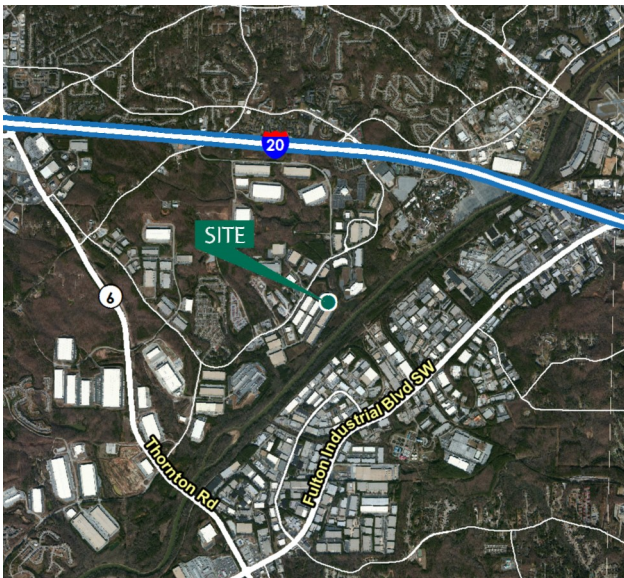

location

- Riverside Distribution Center is conveniently located off I-20 at Riverside Parkway in Cobb County. It is an excellent corporate setting in a controlled master planned business park. The location provides access to Hartsfield Jackson Atlanta Airport via Camp Creek Parkway, and is 4.4 miles from I-285.

facility

- 100,000 SF Total Building Size
- 18,916 SF Suite Available For Lease
- 1,726 SF Office
- 24' Clear Ceiling Height
- Six (6) Dock High Doors (9' x 10')
- One (1) Concrete Ramped Drive - In Door
- ESFR Sprinkler System



King Industrial Realty, Inc.
Wilson Covington
wcovington@kingindustrial.com
ph +1 404.942.2073
fax +1 404.942.2073
cell +1 404.966.3818
210 The Bluffs, Suite B
Austell, GA 30168

King Industrial Realty, Inc.
Randall Bryan
rbryan@kingindustrial.com
ph +1 404.942.2015
fax +1 404.942.2015
cell +1 808.0490
210 The Bluffs, Suite B
Austell, GA 30168

Prologis
Kent Mason
kmason@prologis.com
ph +1 404.760.7208
fax +1 404.760.7201
cell +1 678.249.7001
3475 Piedmont Rd., #650
Atlanta, GA 30305

Prologis Riverside

8080 Troon Circle, Suite 100

Austell, Georgia 30168



PROLOGIS

18,916 Square Feet Industrial Space For Lease

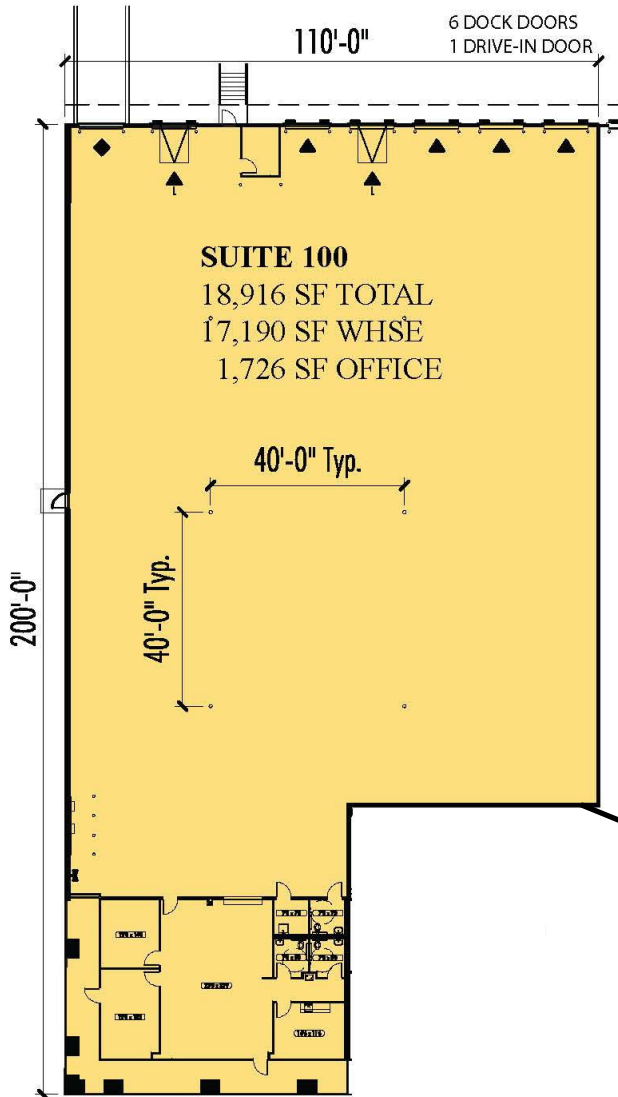

- PROLOGIS LEASED AREA
- PROLOGIS AVAILABLE AREA
- PROLOGIS FUTURE AREA
- DETENTION / RETENTION / WETLAND
- LAND / NON PROLOGIS BUILDING

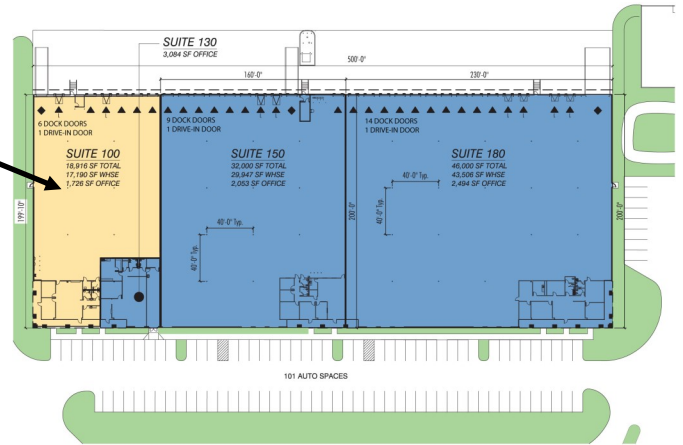

King Industrial Realty, Inc.
Industrial • Commercial • Investment

King Industrial Realty, Inc.
Wilson Covington
wcovington@kingindustrial.com
ph +1 404.942.2073
fax +1 404.942.2073
cell +1 404.966.3818
210 The Bluffs, Suite B
Austell, GA 30168

King Industrial Realty, Inc.
Randall Bryan
rbryan@kingindustrial.com
ph +1 404.942.2015
fax +1 404.942.2015
cell +1 808.0490
210 The Bluffs, Suite B
Austell, GA 30168

Prologis
Kent Mason
kmason@prologis.com
ph +1 404.760.7208
fax +1 404.760.7201
cell +1 678.249.7001
3475 Piedmont Rd., #650
Atlanta, GA 30305