

# 111 GREAT NECK ROAD

GREAT NECK, NEW YORK



## Office Space Available for Lease

Introducing "**The Towers**": Premier Class A Office Building.

Nestled in a prime location, "**The Towers**" presents an exemplary embodiment of sophisticated office environments. These distinguished offices, renowned for its architectural elegance, offers unparalleled amenities and strategic advantages for discerning professionals.

**Elegant Modernity:** Step into the realm of contemporary sophistication with "The Towers." A grandiose modern lobby greets visitors, setting the tone for an unparalleled professional experience. The meticulously designed interiors exude refinement and class, elevating the workplace ambiance to new heights of prestige.

**Convenient Accessibility:** Convenience is paramount at "The Towers." Situated in close proximity to the Long Island Rail Road (LIRR) station, a mere 20-minute commute to Manhattan, accessibility is unrivaled. With ample parking available on both ground and subterranean levels, commuting is streamlined for tenants and visitors alike.



**ROZITA SOOMEKH**

Licensed Real Estate Broker

[Rozita.Soomekh@elliman.com](mailto:Rozita.Soomekh@elliman.com)

**516.205.2279**





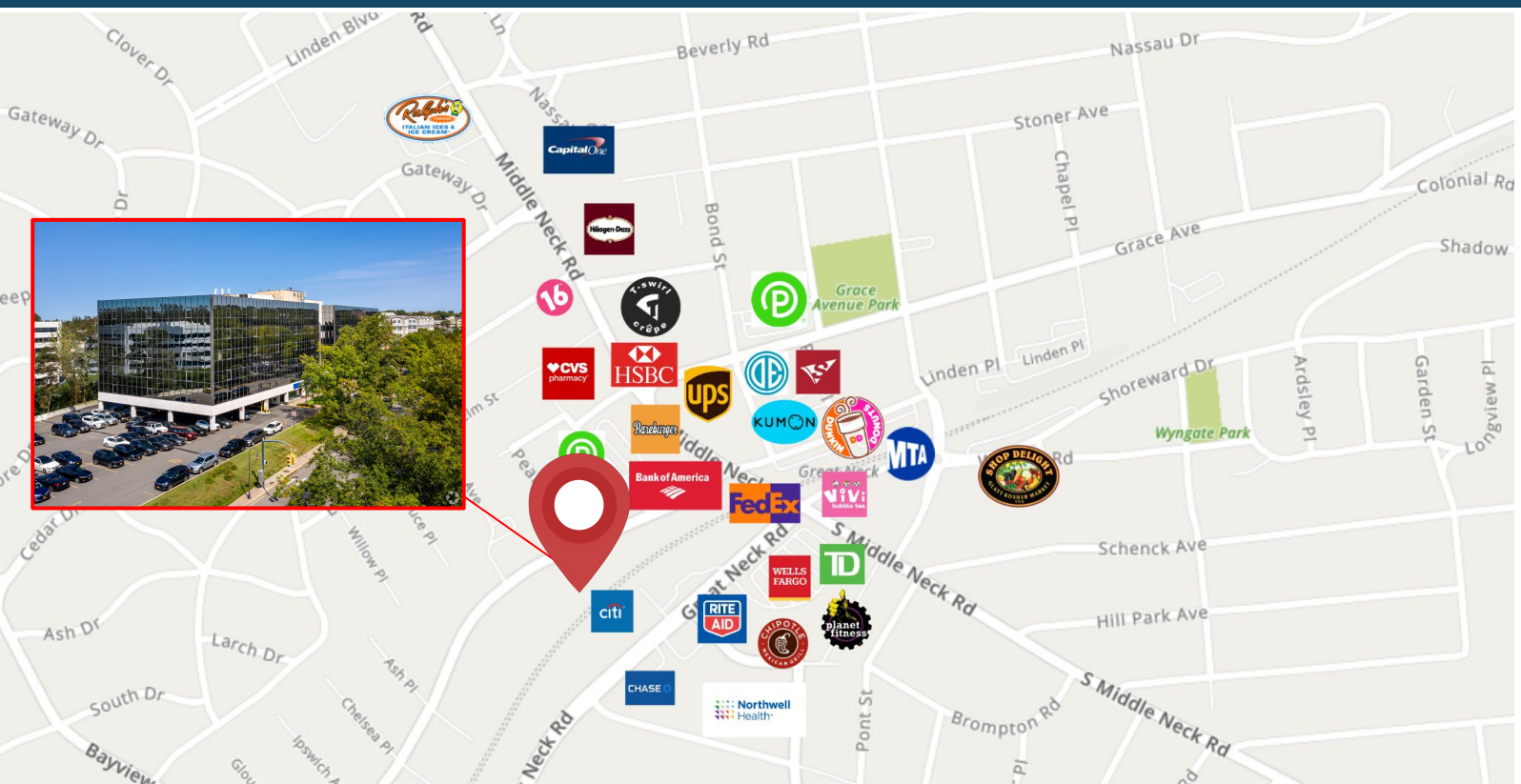

OTHER NOTABLE BUSINESSES IN THE AREA



**Available Units - All Utilities, Wifi & Parking  
Included (Per Month)**

**201-B \$ 950**

**201-M \$ 1,195 w/ Window**

**SUBLEASE SPACE**

**201-C \$ 850 (Ends 8/31/27)**

**THE ROZITA SOOMEKH TEAM**  
at Douglas Elliman  
Real Estate

**ROZITA SOOMEKH**  
Licensed Real Estate Broker  
[Rozita.Soomekh@elliman.com](mailto:Rozita.Soomekh@elliman.com)  
**516.205.2279**



# NEW Carpet, Lighting, Paint, and Furniture.

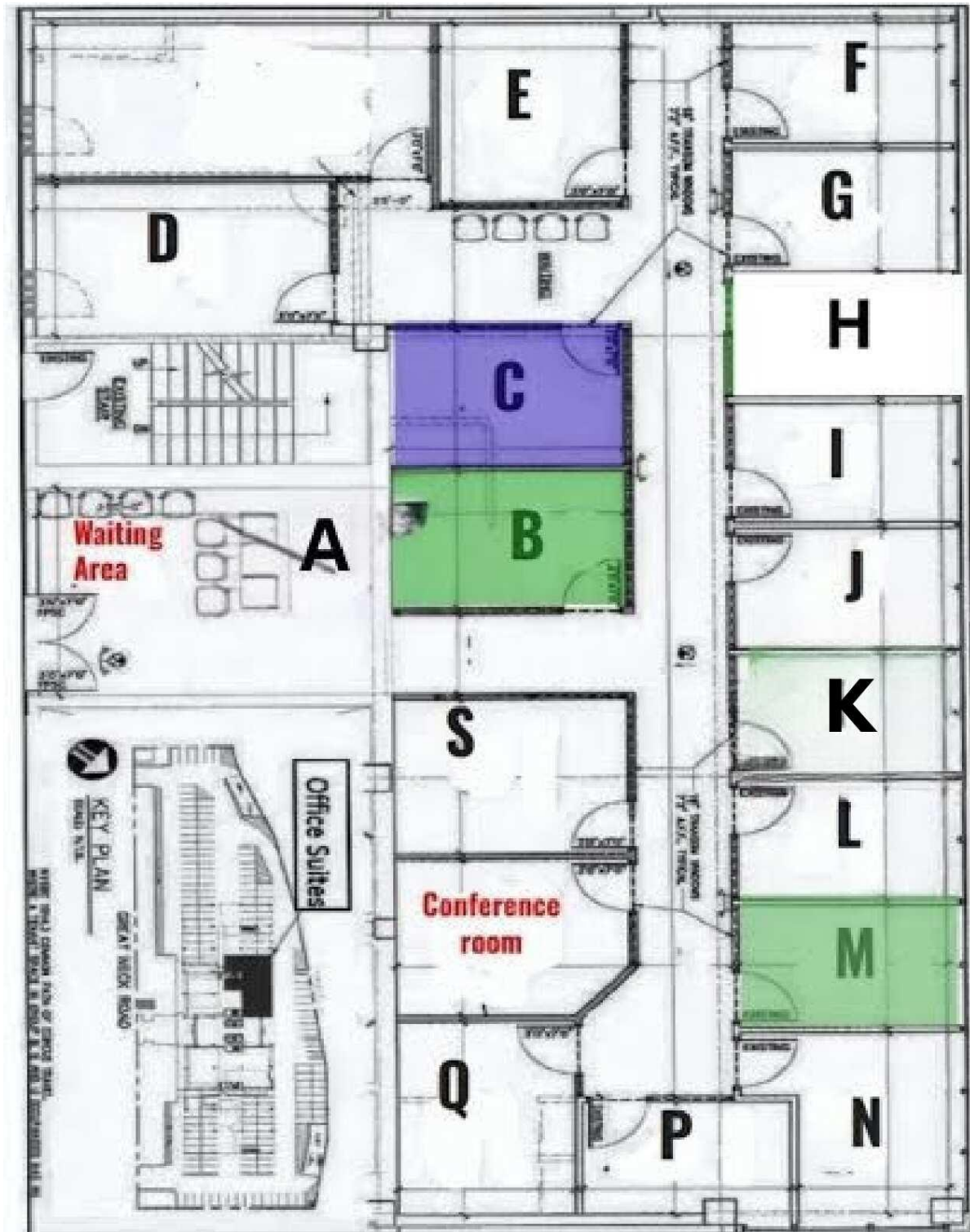



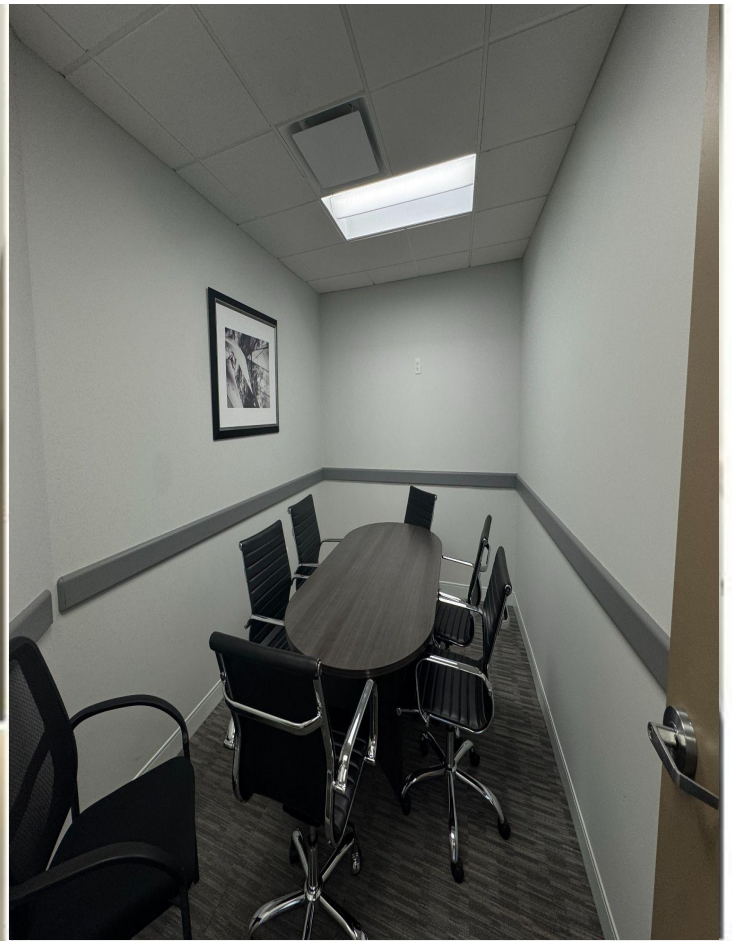

**ROZITA SOOMEKH**  
Licensed Real Estate Broker  
[Rozita.Soomekh@elliman.com](mailto:Rozita.Soomekh@elliman.com)  
**516.205.2279**



# GREAT NECK

NEW YORK



Great Neck is a region on Long Island, New York, that covers a peninsula on the North Shore and includes 9 villages, such as the villages of Great Neck, Great Neck Estates, Great Neck Plaza, Kings Point, and Russell Gardens, and a number of unincorporated areas, as well as an area south of the peninsula near Lake Success and the border territory of Queens.



TOTAL POPULATION

±11.000



SCAN TO VIEW  
ALL OUR LISTINGS



 Douglas Elliman

## Age Demographic

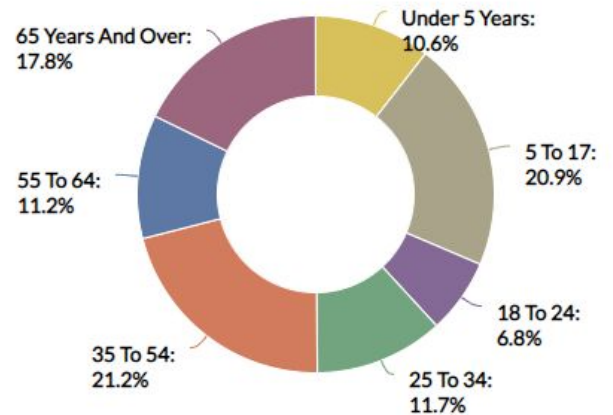

## MEDIAN HOUSEHOLD INCOME

