

37564-37584 AMRHEIN ROAD

UNIT #37564

LIVONIA, MICHIGAN

FOR LEASE

10,385 Square Feet



**SIGNATURE ASSOCIATES**  
KNOW SIGNATURE | KNOW RESULTS

**DEMBS-ROTH GROUP**



## PROPERTY FEATURES

- 10,385 square feet available
- 5,064 sq. ft. air-conditioned warehouse, 5,321 first floor office
- 21' clear height
- (1) 12' x 14' grade level door
- 800 amps, 480 volts, 3-phase power with potential to upgrade to 2000 amps of 480 power
- 180 shared parking spaces
- Lease Rate: \$8.75/sq. ft. NNN



For more information, please contact:

**GARY SALLEN**  
(248) 948 0105  
gsallen@signatureassociates.com

**STEVE GORDON**  
(248) 948 0101  
sgordon@signatureassociates.com

**SIGNATURE ASSOCIATES**  
One Towne Square, Suite 1200  
Southfield, MI 48076  
www.signatureassociates.com

# 37564-37584 Amrhein Road – Livonia, Michigan

## Industrial For Lease

10,385  
Square Feet  
AVAILABLE

### First Floor Plan

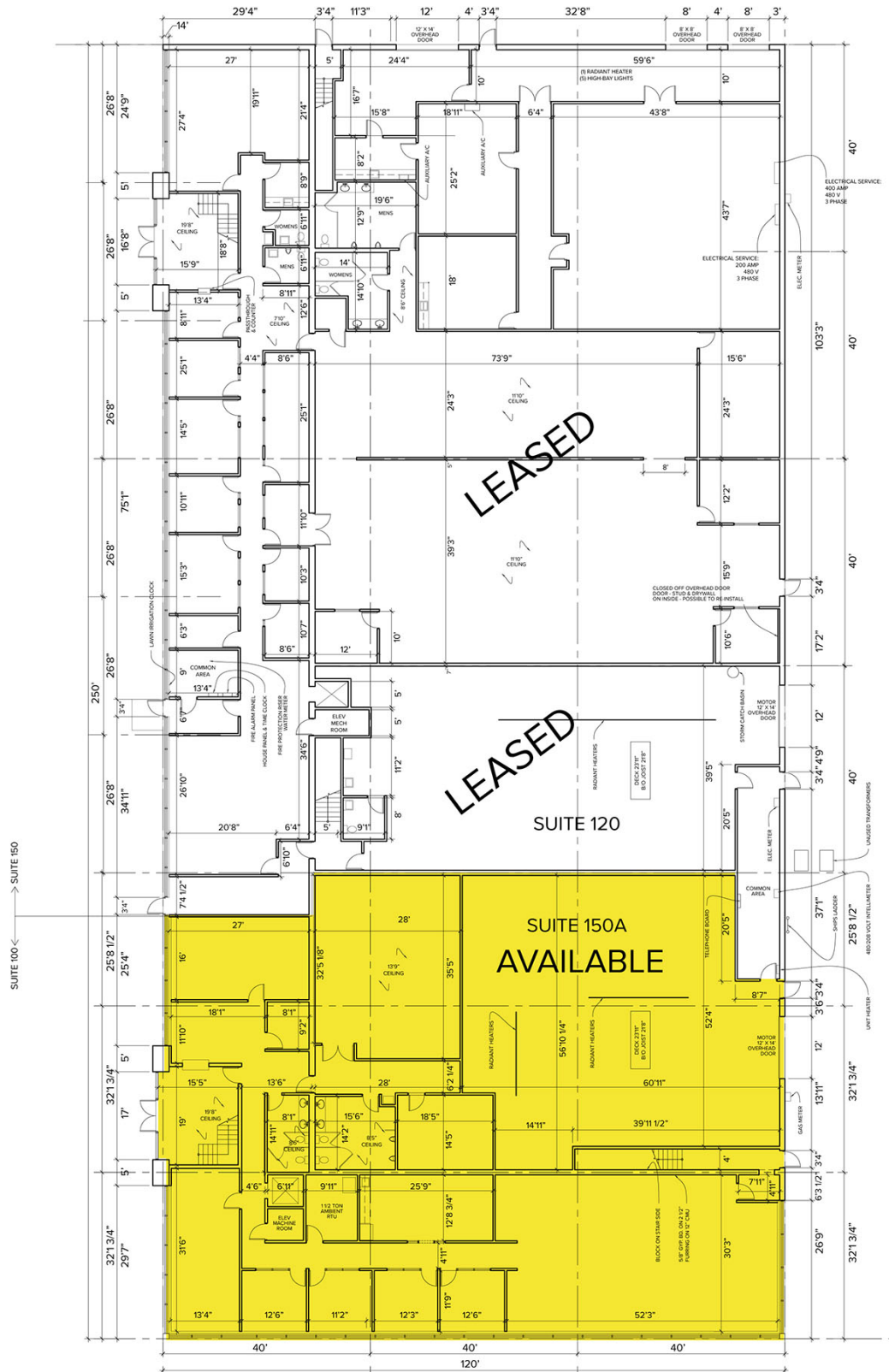

For more information, please contact:

**GARY SALLEN**  
(248) 948 0105

gsallen@signatureassociates.com

**STEVE GORDON**  
(248) 948 0101

sgordon@signatureassociates.com

**SIGNATURE ASSOCIATES**  
One Towne Square, Suite 1200  
Southfield, MI 48076  
www.signatureassociates.com

Second Floor Plan



For more information, please contact:

**GARY SALLEN**  
(248) 948 0105  
gsallen@signatureassociates.com

**STEVE GORDON**  
(248) 948 0101  
sgordon@signatureassociates.com

**SIGNATURE ASSOCIATES**  
One Towne Square, Suite 1200  
Southfield, MI 48076  
www.signatureassociates.com



# 37564-37584 Amrhein Road – Livonia, Michigan

Industrial For Lease

10,385  
Square Feet  
AVAILABLE

Aerial



For more information, please contact:

**GARY SALLEN**  
(248) 948 0105  
gsallen@signatureassociates.com

**STEVE GORDON**  
(248) 948 0101  
sgordon@signatureassociates.com

**SIGNATURE ASSOCIATES**  
One Towne Square, Suite 1200  
Southfield, MI 48076  
www.signatureassociates.com