

Retail | For Lease

End Cap Unit in Three-Tenant Corner Retail Plaza

2890 Sand Run Parkway, Fairlawn, Ohio 44333

Contact Us

Katie Thome
Senior Associate
330 670 4411
katie.thome@cbre.com

CBRE, Inc.
3421 Ridgewood Rd, Suite 150
Akron, Ohio 44333
www.cbre.us



CBRE

End Cap Unit in Three-Tenant Corner Retail Plaza

2890 Sand Run Pkwy, Fairlawn, Ohio 44333

For Lease



Property Overview

A three-tenant 6,020 SF retail building at the corner of Sand Run and Merz Blvd - one block from Summit Mall in the Fairlawn retail trade market. Ideal for medical, office or retail user to complete this well-maintained plaza. Façade and monument signage options. Plaza includes Strickland's Homemade Ice Cream and Seamless Color Salon.

- + End Cap Unit
- + Prominent corner exposure
- + Exterior façade and monument signage
- + Ample surface parking located steps from suite entrance
- + Former medical office

Suite A Floor Plan

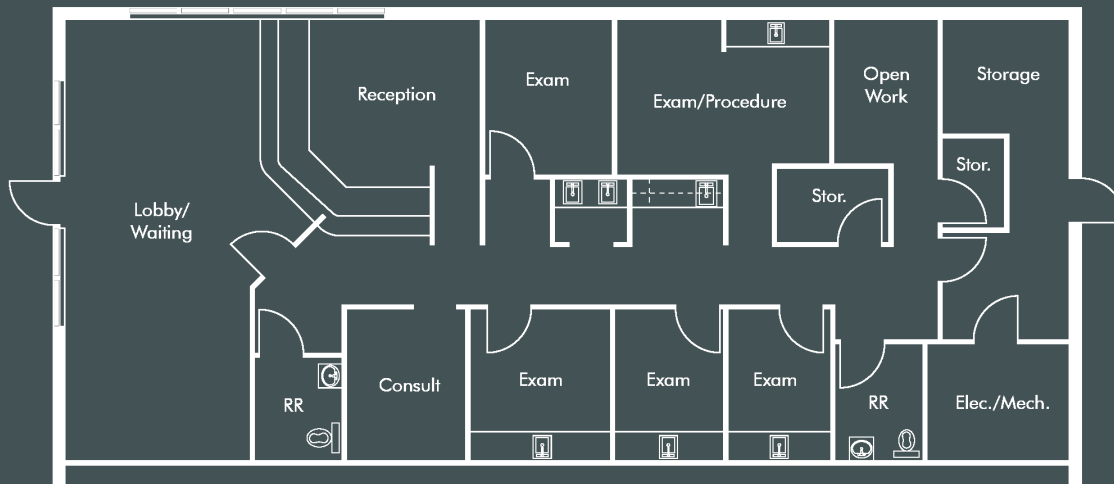

Suite Available

- + Suite A: 2,263 RSF
- + 32'-4"W x 70'0"D End Cap Suite
- + Lease Rate: \$18/RSF NNN
 - NNN est: \$4/RSF

2890 Sand Run Pkwy, Fairlawn, Ohio 44333

Fairlawn- Montrose

RETAIL TRADE AREA

±6,100,000 Total SF
(Source, CoStar)

- ## HOTELS

1. Residence Inn - 107
2. Baymont - 62
3. Super 8 - 64
4. Comfort Inn - 51
5. Extended Stay America - 167
6. Radisson - 128
7. Homewood Suites - 105
8. Fairfield Inn - 98
9. Courtyard - 78
10. Hampton Inn - 63
11. Copley Inn & Suites - 102
12. Econolodge - 54
13. Hilton - 203
14. Holiday Inn Express - 92

1. Signet Jewelers - 1,400
2. Cleveland Clinic-Akron General - 600
3. Dial America - 300

Not on Map:
Copley-Fairlawn Schools - 400
YRC Freight - 600

© 2023 CBRE, Inc. All rights reserved. This information has been obtained from sources believed reliable, but has not been verified for accuracy or completeness. You should conduct a careful, independent investigation of the property and verify all information. Any reliance on this information is solely at your own risk. CBRE and the CBRE logo are service marks of CBRE, Inc. All other marks displayed on this document are the property of their respective owners, and the use of such logos does not imply any affiliation with or endorsement of CBRE. Licensed Real Estate Broker.

Updated: March 20, 2025



Traffic Counts: Ohio Department of Transportation (ODOT) 2022-2023

QUICK STATS - 3 MILE RADIUS



DAYTIME
POPULATION

50,108



2024
POPULATION

36,855



2024
HOUSEHOLDS

16,909



2024
POPULATION
25 & OVER

27,767



2024
AVG. HOUSEHOLD
INCOME

\$147,896

Demographics

	1 Mile	3 Miles	5 Miles
2024 Population	7,402	36,855	92,498
2024 Daytime Population	15,444	50,108	90,404
2024 Households	3,135	16,909	41,925
2024 Average Household Income	\$140,559	\$147,896	\$127,805
2024 Median Household Income	\$96,533	\$101,521	\$82,269
2024 Per Capita Income	\$57,826	\$67,858	\$57,825
2024 Median Age	5,591	27,767	68,109

Contact Us

Katie Thome
Senior Associate
330 670 4411
katie.thome@cbre.com

CBRE, Inc.
3421 Ridgewood Rd, Suite 150
Akron, Ohio 44333
www.cbre.us

© 2025 CBRE, Inc. All rights reserved. This information has been obtained from sources believed reliable, but has not been verified for accuracy or completeness. You should conduct a careful, independent investigation of the property and verify all information. Any reliance on this information is solely at your own risk. CBRE and the CBRE logo are service marks of CBRE, Inc. All other marks displayed on this document are the property of their respective owners, and the use of such logos does not imply any affiliation with or endorsement of CBRE. Photos herein are the property of their respective owners. Use of these images without the express written consent of the owner is prohibited. Licensed Real Estate Broker.