

LONE MOUNTAIN PLAZA

Anchor & Pad Space Available

LONE MOUNTAIN & DECATUR NWC | LAS VEGAS, NV 89130



DAN ADAMSON

702.550.4934 | dan@roicre.com
Lic # B.0026992.CORP

EDWARD LEHNARDT, CCIM

702.830.1119 | edward@roicre.com
Lic # S.0180688

CHRIS WALDBURGER, CCIM

702.483.3683 | chris@roicre.com
Lic # S.0190814



roicre.com

PROPERTY HIGHLIGHTS

- Located in rapidly growing Northwest Las Vegas submarket
- Serves the Los Prados Master Planned Community and surrounded by mature residential neighborhoods
- Close proximity and easy access to both US-95 and CC 215 Beltway
- Excellent visibility with exposure to over 24,100 VPD along Decatur Blvd - a major north-south arterial

±5,260 SF

PAD SPACE AVAILABLE

- Proposed Drive Thru or Supper Club
- Pad has cross access with McDonald's
- Site plan moldable based on qualified tenant's needs.
- Ground Lease, Build to Suit, Reverse Build to Suit options available

±55,880 SF

ANCHOR SPACE AVAILABLE

- Second generation retail space
- Former discount furniture retailer showroom

SHOPPING CENTER RETAILERS



LONE MOUNTAIN PLAZA
Lone Mountain & Decatur NWC
Las Vegas, NV 89130



125-36-818-001
APN



LIMITED COMMERCIAL (C-1)
ZONING



PROPOSED SITE PLAN

LONE MOUNTAIN PLAZA
Lone Mountain & Decatur NWC
Las Vegas, NV 89130

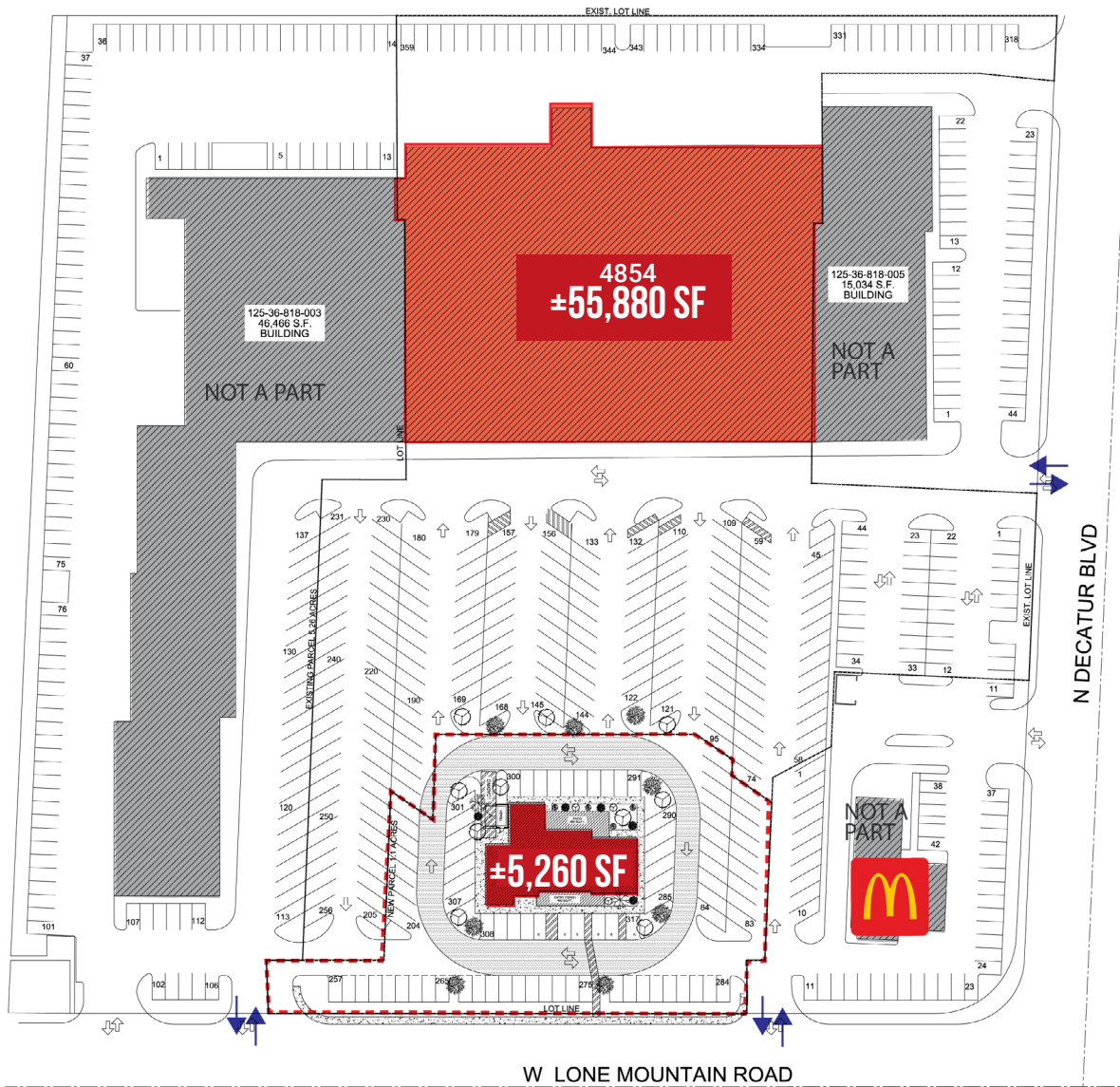

DESIGN OPTION

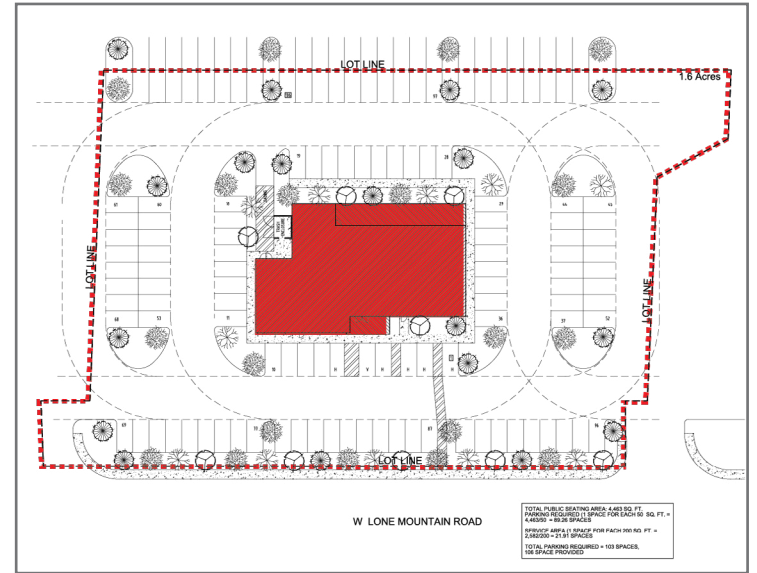

| BLDG | TENANT | SQ. FT. |
|------|------------------------|----------|
| 4854 | AVAILABLE ANCHOR SPACE | ± 55,880 |
| PAD | OPTIONS AVAILABLE | ± 5,260 |

CLICK OR SCAN



INTERACTIVE
VIRTUAL TOUR

TRADE AREA AERIAL

LONE MOUNTAIN PLAZA
Lone Mountain & Decatur NWC
Las Vegas, NV 89130



AREA DEMOGRAPHICS



POPULATION

| 1 Mile | 3 Miles | 5 Miles |
|--------|---------|---------|
| 15,898 | 161,411 | 427,833 |



AVERAGE HOUSEHOLD INCOME

| 1 Mile | 3 Miles | 5 Miles |
|-----------|-----------|-----------|
| \$110,767 | \$104,737 | \$103,106 |



TRAFFIC COUNTS

| Lone Mountain Rd | Decatur Blvd |
|------------------|--------------|
| 7,100 VPD | 24,100 VPD |

Sources:
SitesUSA 2024
TRINA, NV DOT, 2023



LONE MOUNTAIN PLAZA

Lone Mountain & Decatur NWC
Las Vegas, NV 89130



www.roicre.com



9121 W Russell Rd
Suite 111
Las Vegas, NV 89148

CALL US FOR MORE INFO

DAN ADAMSON



702.550.4934



dan@roicre.com



Lic # B.0026992.CORP

EDWARD LEHNARDT, CCIM



702.830.1119



edward@roicre.com



Lic # S.0180688

CHRIS WALDBURGER, CCIM



702.483.3683



chris@roicre.com



Lic # S.0190814

Let's keep in touch.



[roicre](https://www.facebook.com/roicre)



[@roicre](https://twitter.com/@roicre)



[roicre](https://www.linkedin.com/company/roicre)

DISCLAIMER

All information contained herein is from sources we deem reliable, and we have no reason to doubt its accuracy; however, no guarantee or responsibility is assumed thereof, and it shall not form any part of future contracts. Properties are submitted subject to errors and omissions and all information should be carefully verified. All measurements quoted herein are approximate.

Demographics are provided by SitesUSA using data from private and government sources deemed to be reliable. The information herein is provided without representation or warranty.

Georeferenced data herein are provided by Placer Labs, Inc. and is provided without representation or warranty.

Photos contained herein are property of their respective owners. Photos do not guarantee the current condition of the property.