



THE VILLAGE AT VINTAGE CLUB  
1010 Vintage Club Boulevard









The Village at Vintage Club is located within the historic, family-oriented, affluent, suburb of Montgomery, Ohio. Beautifully landscaped sidewalks and walking paths create a pedestrian-friendly community of connection, linking the best in luxury living with adjacent parks and recreation, shopping and dining conveniently nearby.

This amenity-rich master planned community is surrounded by some of Cincinnati's wealthiest neighborhoods including Indian Hill, Kenwood and Blue Ash. There is immediate access onto I-275 and only 1.3 miles to I-71. The site is located in close proximity to Harper's Station and The Shops at Harper's Point, which include a new Kroger Marketplace, TJ Maxx, Homegoods, Steinmart, LA Fitness, Fresh Thyme and a variety of restaurants. The brand new Christ Hospital outpatient center is part of the development.

# THE VISITORS

	1 Mile	3 Mile	5 Mile
 Population	7,246	51,918	140,964
 Total Households	2,993	21,487	58,504
 Average Household Income	\$170,302	\$155,893	\$149,752

## ANNUAL VISITS

1.6M **KROGER**

2M **HARPER'S POINT**

2.4M **HARPER'S STATION**

3

Of the top wealthiest neighborhoods in Cincinnati are within the trade area: Indian Hill, Kenwood and Blue Ash.



Highly-educated, affluent market



Style matters, from personal appearance to their homes



Well-connected on the latest devices and understand how to use them



Physical fitness is a priority, including club memberships and home equipment



Family-oriented market and live in new housing away from the bustle of the city, but close enough to commute



Participate in bicycling, jogging, golfing, boating and target shooting



# THE PROPERTY - 1010 Vintage Club Boulevard







FUTURE  
DEVELOPMENT

FUTURE  
DEVELOPMENT

Luxury  
Homes



ALL ABOUT  
**KIDS**  
A GREEN Childcare and Learning Center

General Electric  
Credit Union

Orangetheory  
FITNESS

The  
Christ Hospital  
Health Network

34,182 AADT

22



# FLOOR PLAN

## Montgomery Road (34,182 VPD)

First Floor 8,296 sf



Second Floor 8,223 sf

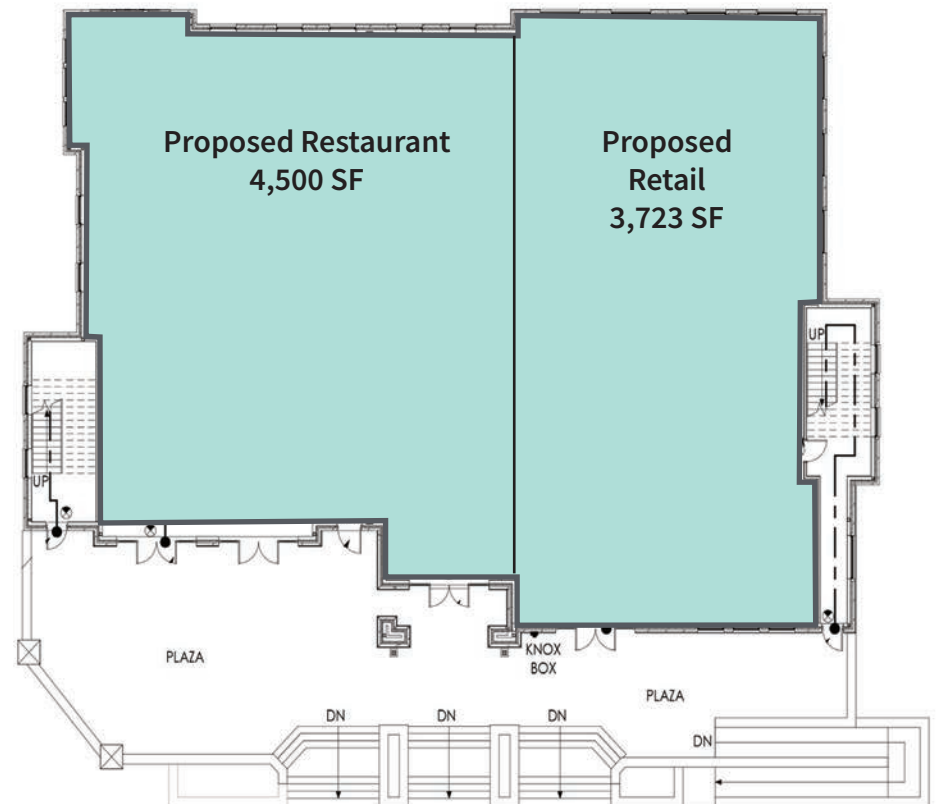



# CONTACTS

**Giorgio A. Karras**

Vice President

+1 513 719 3720

[giorgio.karras@jll.com](mailto:giorgio.karras@jll.com)

**Kevin Thobe**

Vice President

+1 513 252 2189

[kevin.thobe@jll.com](mailto:kevin.thobe@jll.com)

[jll.com/properties](http://jll.com/properties)



## THE VILLAGE AT VINTAGE CLUB

