

Office Space For Lease

6400 Cornhusker Hwy

NAIFMA Realty



For more information:

Jared Froehlich, CCIM, SIOR

402 441 5830 • jfroehlich@naifma.com

NO WARRANTY OR REPRESENTATION, EXPRESS OR IMPLIED, IS MADE AS TO THE ACCURACY OF THE INFORMATION CONTAINED HEREIN, AND THE SAME IS SUBMITTED SUBJECT TO ERRORS, OMISSIONS, CHANGE OF PRICE, RENTAL OR OTHER CONDITIONS, PRIOR SALE, LEASE OR FINANCING, OR WITHDRAWAL WITHOUT NOTICE, AND OF ANY SPECIAL LISTING CONDITIONS IMPOSED BY OUR PRINCIPALS NO WARRANTIES OR REPRESENTATIONS ARE MADE AS TO THE CONDITION OF THE PROPERTY OR ANY HAZARDS CONTAINED THEREIN ARE ANY TO BE IMPLIED.

1248 'O' Street, Suite 550

Lincoln, NE 68508

(402) 441-5800

naifmarealty.com

For Lease

6400 Cornhusker Hwy

Available Suites

Property Features

- Ste. 5: 9,514 SF @ \$8.75/SF NNN
 - Ste. 50: 3,232 SF @ \$8.75/SF NNN
 - Ste. 75: 160 SF @ \$260/Month FS*
 - Ste. 80: 479 SF @ \$485/Month FS*
 - Ste. 85: 1,395 SF @ \$6.75/SF NNN
 - Ste. 95: 221 SF @ \$350/Month FS*
 - Ste. 325: 1,188 SF @ \$7.75/SF NNN
- (*This is the total monthly rate, includes all expenses)
- Affordable flex space available in multi-tenant building
 - The site has a large parking lot with adequate parking for the building
 - Tenants may rent out the 2,253 SF multi-purpose room on an as needed basis
 - Free dock access
 - Zoned I-1
 - NNN Charge (For-Profit Tenants, 2026) \$4.09/SF
 - NNN Charge (Non-Profit Tenants, 2026) \$2.85/SF



For Lease

6400 Cornhusker Hwy

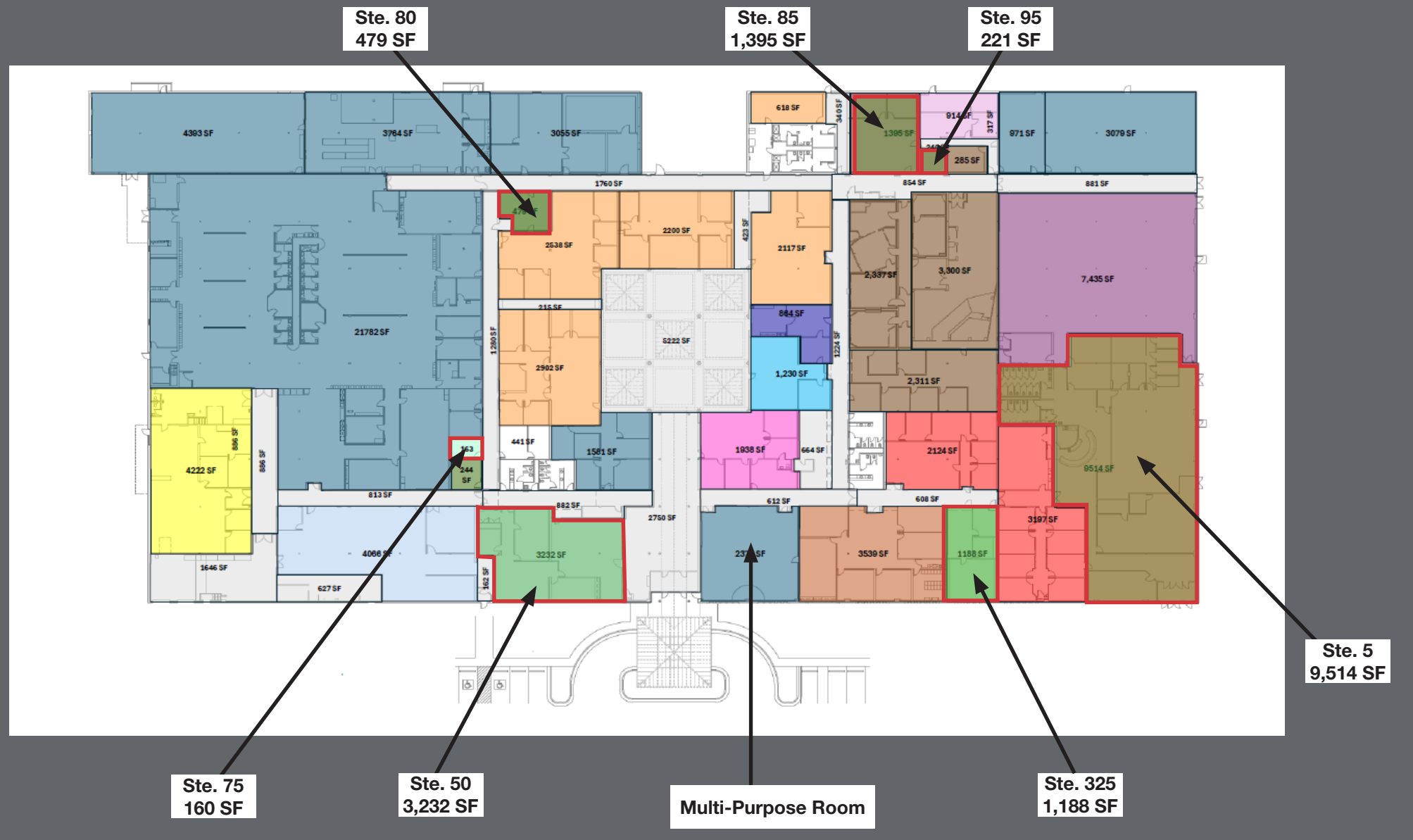

For Lease
6400 Cornhusker Hwy

Suite 5

