



# FOR SALE

## ± 2,002 SF OFFICE BUILDING ON FENCED LOT

1642 E. 4TH STREET | SANTA ANA, CA



### PROPERTY FEATURES

- ± 4,017 Total SF Consisted of:
  - ± 2,002 SF Office
  - ± 2,015 SF Warehouse/Garage Storage
- ± 18,600 SF (0.43 Acre) Lot
- P (Professional) Zoning ([Click Here](#))
- Box Shaped Lot (186' H x 100' W)
- Secured Fenced Storage Yard
- Multi-Tenancy Option
- Drive Through Lot with Multiple Access Points
- Immediate access to  and  Freeways

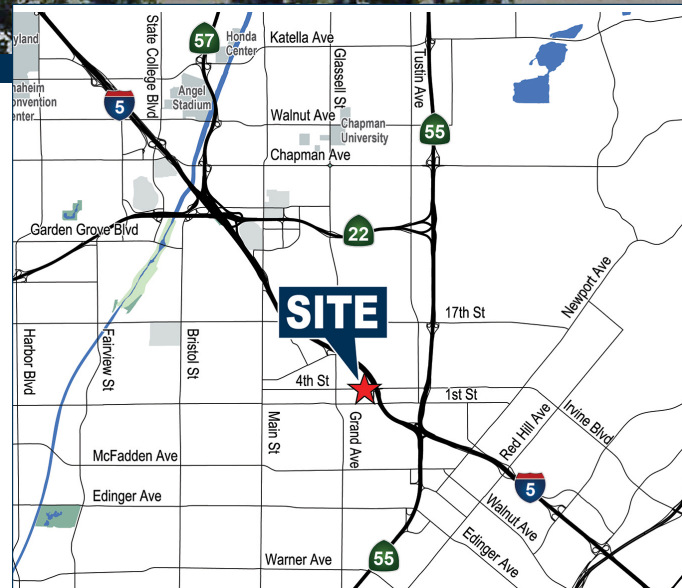

Exclusively Offered By:

## Voit

REAL ESTATE SERVICES



**JASON DIROCCO**  
Senior Vice President | Partner

**(714) 935-2305**  
JDiRocco@voitco.com  
License #01842301

1642 E. 4TH STREET | SANTA ANA, CA

**SITE PLAN**  
**4th STREET**

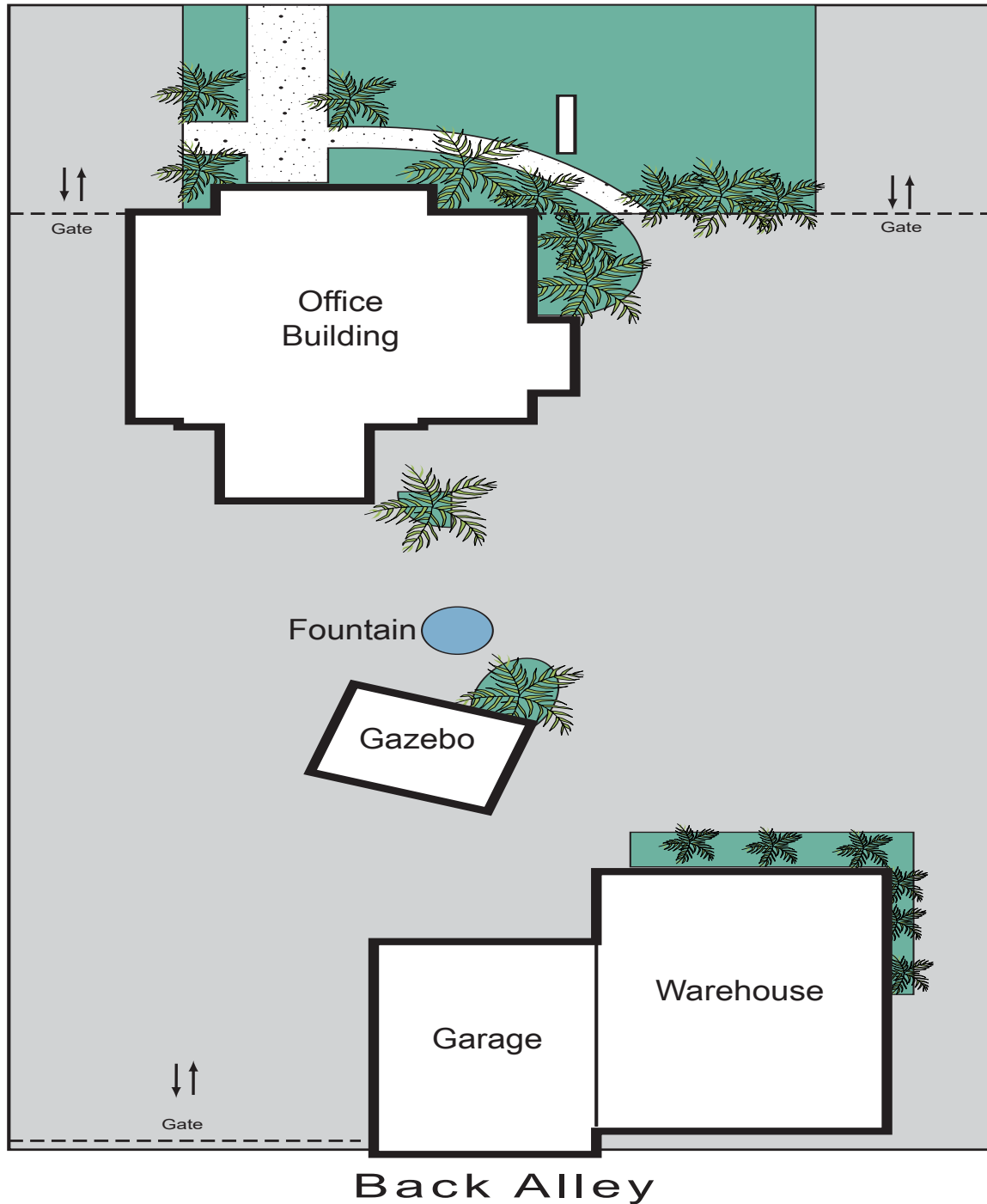

Exclusively Offered By:

**Voit**

REAL ESTATE SERVICES



**JASON DIROCCO**  
Senior Vice President | Partner

**(714) 935-2305**

[JDiRocco@voitco.com](mailto:JDiRocco@voitco.com)

License #01842301