

665.49  
N00°02'38\"/>

*[Signature]*

CERTIFIED TO:  
ROBERT FLORA

LEGAL DESCRIPTION:

PARCEL "A": THE SOUTH 327.0 FEET OF THE NORTH 982.5 FEET OF THE EASTERLY 668.93 FEET OF THE NORTHWEST 1/4, SECTION 1, TOWNSHIP 45 SOUTH RANGE 41 EAST

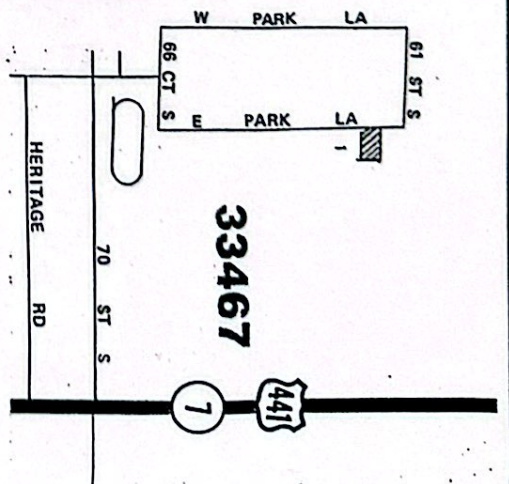

I HEREBY CERTIFY THAT THE SKETCH SHOWN HEREON IS A TRUE AND CORRECT REPRESENTATION OF A SURVEY MADE UNDER MY DIRECTION, AND THAT SAID SURVEY IS ACCURATE AND CORRECT TO THE BEST OF MY KNOWLEDGE AND BELIEF. THERE ARE NO APPARENT GROUND ENCROACHMENTS, UNLESS OTHERWISE SHOWN AND THAT THE SURVEY MEETS THE MINIMUM TECHNICAL STANDARDS SET FORTH BY THE FLORIDA BOARD OF PROFESSIONAL SURVEYORS AND MAPPERS, PURSUANT TO SECTION 472.027, FLORIDA STATUTES AND CHAPTER 61G17-6 OF THE FLORIDA ADMINISTRATIVE CODE.

DATE 4/24/96

REGISTERED SURVEYOR NO. 3285

PROPERTY SHOWN HEREON HAS NOT BEEN ABSTRACTED BY SURVEYOR FOR RIGHTS-OF-WAY, AND/OR EASEMENTS OF RECORD. ELEVATIONS SHOWN HEREON ARE BASED ON N.O.S DATUM UNLESS OTHERWISE NOTED; ALL PROPERTY CORNERS ARE IRON ROD WITH CAPS, UNLESS OTHERWISE NOTED; FOUNDATION OF EXISTING BUILDINGS LYING BELOW SURFACE NOT LOCATED. BEARINGS AND/OR ANGLES SHOWN HEREON ARE BASED ON RECORD PLAT OR DEED CALLS UNLESS OTHERWISE NOTED. MEASUREMENTS MADE IN ACCORDANCE WITH UNITED STATES STANDARD, UNLESS IT BEARS THE SIGNATURE AND THE ORIGINAL RAISED SEAL OF A FLORIDA LICENSED SURVEYOR AND MAPPER THIS DRAWING OR SKETCH IS FOR INFORMATIONAL PURPOSES ONLY, AND IS NOT VALID.

SURVEY OF PROPERTY DESCRIBED HEREON

**RICHARD L. SHEPARD and Associates**  
LAND SURVEYORS  
310 SOUTH FEDERAL HIGHWAY  
P.O. BOX 739  
BOYNTON BEACH, FLORIDA 33435  
Phone: (407) 391-4388  
Boca Raton (407) 737-6546  
Boynton (407) 734-7546  
FAX: (407) 734-7546

Scale 1"=100' By JT  
Date 4/24/96 FB #74 Pg 5L Drawing No. 01964-133

PARCEL "A"