

An aerial photograph of the Bonney Lake Village Shopping Center. The image shows a large, multi-tenant commercial building with a flat roof, surrounded by extensive parking lots filled with cars. The center is bordered by a dense forest of tall evergreen trees on the left and back. In the foreground, there are landscaped areas with small trees and shrubs. A teal banner in the top right corner contains the text 'RETAIL LEASE'.

RETAIL
LEASE

BONNEY LAKE VILLAGE SHOPPING CENTER

21107 - 21291 State Route 410 E | Bonney Lake, WA

Jack Rosen

425.289.2221

jack@rosenharbottle.com

Stossi Tsantilas

425.279.7943

stossit@rosenharbottle.com

425.454.3030
rosenharbottle.com

PO Box 5003
Bellevue, WA 98009 - 5003





SAFeway ANCHORED RETAIL SHOPPING CENTER

2,522 SF Available

LOCATION FEATURES:

- Other Anchored Retailers include Goodwill, Ben Franklin, Taco Bell, US Bank, and Round Table
- Neighboring Retailers: Costco, Walmart, Fred Meyer, and Target
- Close Proximity to the New and Growing Tehaleh Residential Development
- Abundant Parking



DEMOGRAPHICS:

| | 1 Mile | 3 Miles | 5 Miles |
|----------------------------|----------|-----------|-----------|
| 2023 Population | 6,621 | 49,637 | 210,067 |
| 2028 Population Projection | 6,842 | 49,939 | 216,117 |
| 2023 Avg. HH Income | \$98,767 | \$106,666 | \$102,993 |

The information provided herein has been obtained from sources believed to be reliable, but no representation or warranty, express or implied, is made with respect to the accuracy or completeness of any such information. Each prospective buyer or tenant should independently investigate, evaluate and verify all information provided herein and any other matters deemed material. Please consult your attorney, tax advisor or other professional advisor. The terms of sale or lease set forth herein are subject to change or withdrawal at any time and without notice.

BUILDING A FLOOR PLAN

| Suite | Square Feet | Rent | Notes |
|------------|-------------|-----------------|--|
| 21201 (A9) | 2,522 SF | \$38.00/SF, NNN | Endcap retail space with potential for drive-thru addition. Available 7/1/2026. |

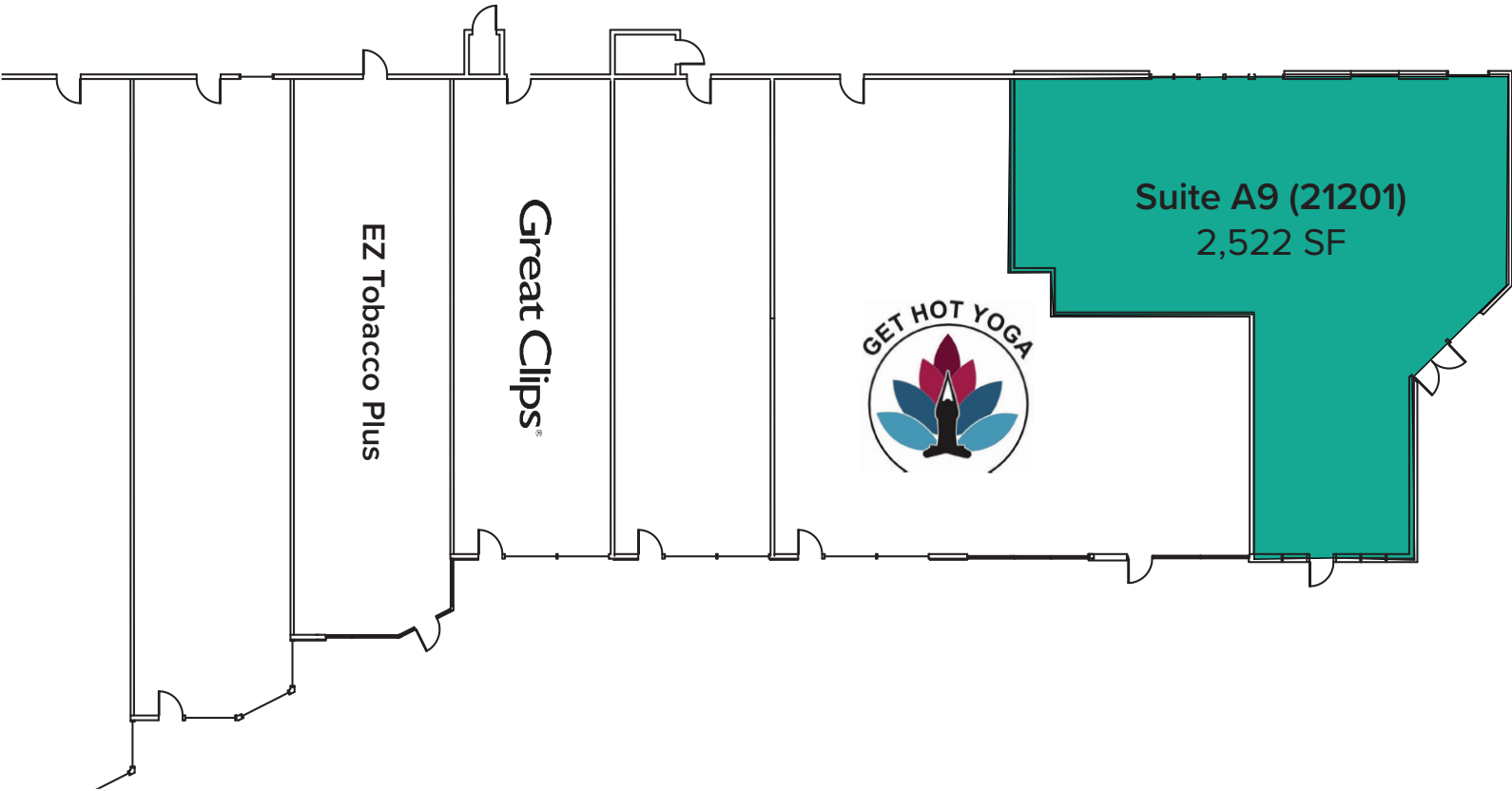

The information provided herein has been obtained from sources believed to be reliable, but no representation or warranty, express or implied, is made with respect to the accuracy or completeness of any such information. Each prospective buyer or tenant should independently investigate, evaluate and verify all information provided herein and any other matters deemed material. Please consult your attorney, tax advisor or other professional advisor. The terms of sale or lease set forth herein are subject to change or withdrawal at any time and without notice.

SITE PLAN

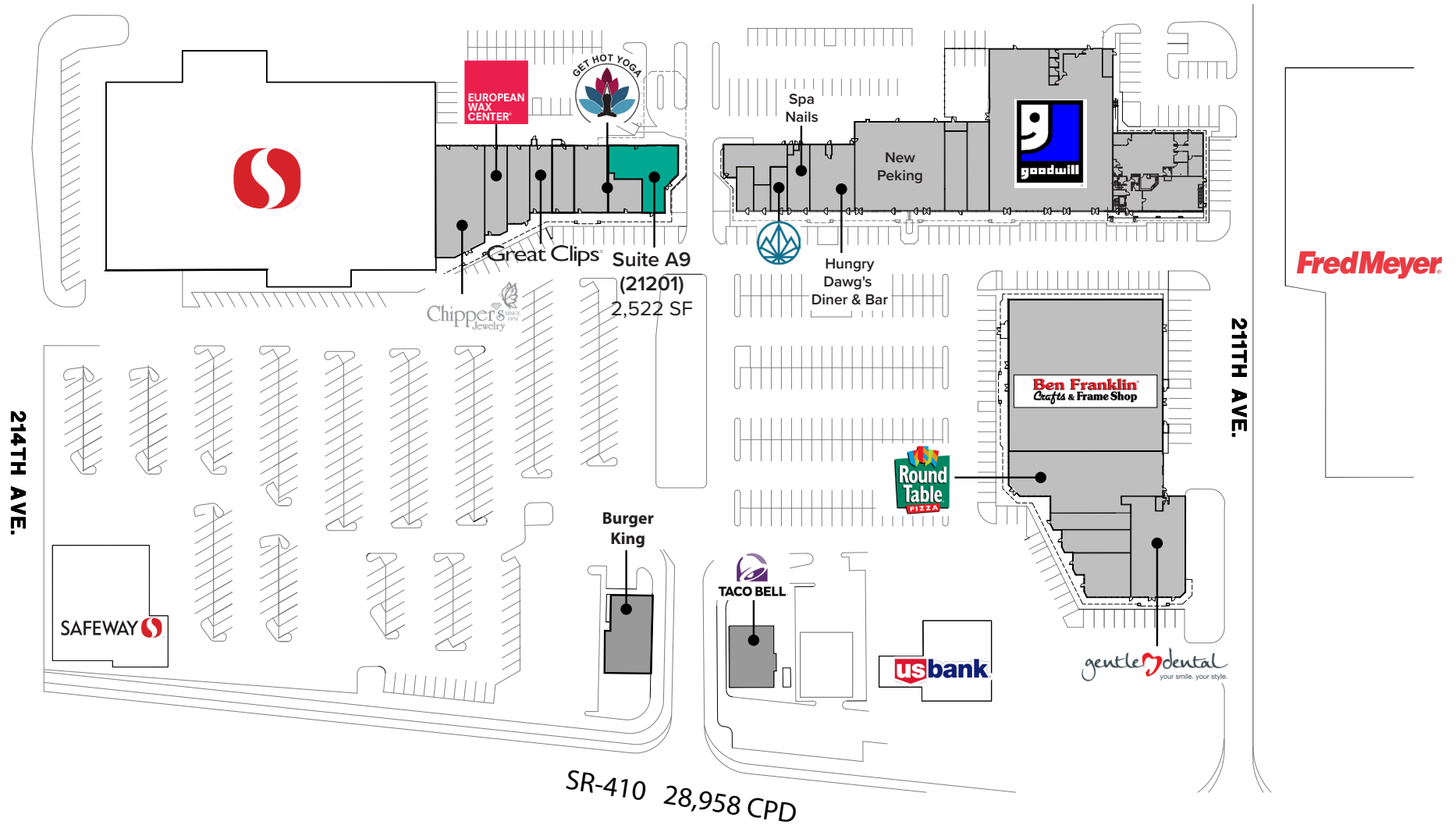

The information provided herein has been obtained from sources believed to be reliable, but no representation or warranty, express or implied, is made with respect to the accuracy or completeness of any such information. Each prospective buyer or tenant should independently investigate, evaluate and verify all information provided herein and any other matters deemed material. Please consult your attorney, tax advisor or other professional advisor. The terms of sale or lease set forth herein are subject to change or withdrawal at any time and without notice.

LOCATION MAP

