

CLOUTER CREEK

DANIEL ISLAND, SC

16.41 ACRES LAND FOR RESIDENTIAL AND
MARINA DEVELOPMENT
FOR SALE

HAGOOD S. MORRISON, II

+1 843 830 9108

hs.morrison@bridge-commercial.com

JOHN BEAM

+1 843 810 6868

john.beam@bridge-commercial.com

HAGOOD MORRISON

+1 843 270 5219

hagood.morrison@bridge-commercial.com

BROOKS COURTNEY

+1 859 327 8749

brooks.courtney@bridge-commercial.com

GRAHAM MEISEL

+1 301 580 8099

graham.meisel@bridge-commercial.com



TABLE OF CONTENTS

- 1 PROPERTY INFORMATION
- 2 RESIDENTIAL SITE PLAN
- 3 PERMITTED DOCK SLIPS
- 4 MARINA STORE CONCEPT
- 5 DISCLAIMER
- 6 LOCATION OVERVIEW

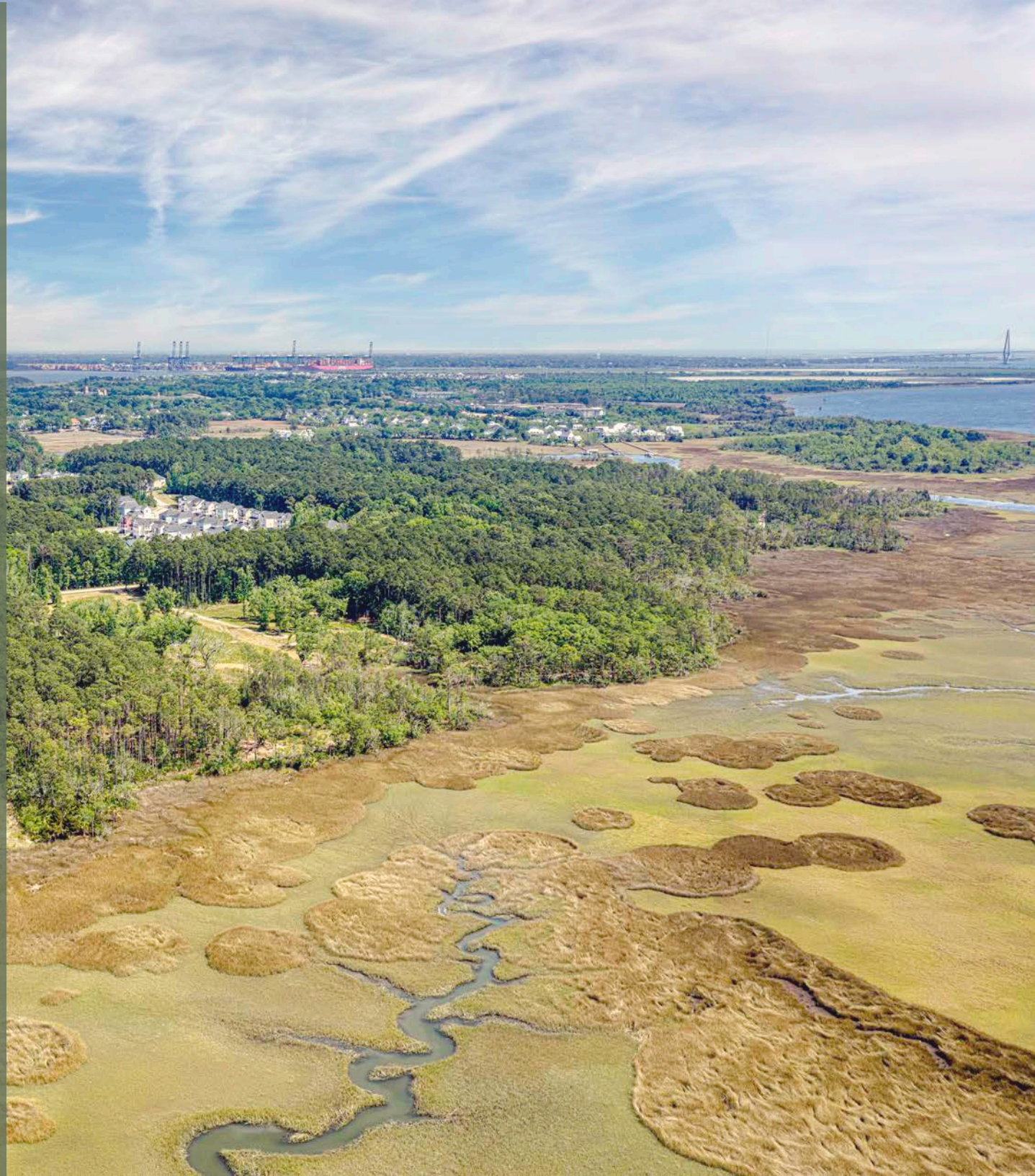

PROPERTY INFORMATION

CLOUTER CREEK

ADDRESS:	Clements Ferry Rd (South of 1-526)
PARCEL ID:	275-00-00-005 275-00-00-323
SITE AREA:	16.41 Acres
UPLAND AREA:	±14 Acres
MARSH AREA:	± 2 Acres
COUNTY:	Berkeley County <small>*While the land has been annexed into the City of Charleston, the road has not been annexed.</small>
ZONING:	RR-1/RR-1/C
PERMITTED SLIPS:	110 <small>*Permitted through DHEC-OCRM / Army Corps of Engineers</small>
SLIP MIX:	56 x 30 ft 45 x 40 ft
CONCEPTUAL RESIDENTIAL SITE PLAN:	38 Lot Subdivision (See following plans for more info)
SALE REQUIREMENTS:	The entity which owns this property has filed for Chapter 11 bankruptcy. This sale is occurring as a result of that bankruptcy. Any sale, if approved, must occur prior to August 1, 2026 and must conform with the debtor's plan of reorganization. Please contact broker for additional information.



THOMAS ISLAND DR

CLEMENTS FERRY RD



Bridge Commercial makes no guarantees, representations or warranties of any kind, expressed or implied, including warranties of content, accuracy and reliability. Any interested party should do their own research as to the accuracy of the information. Bridge Commercial excludes warranties arising out of this document and excludes all liability for loss and damages arising out of this document.

RESIDENTIAL SITE PLAN

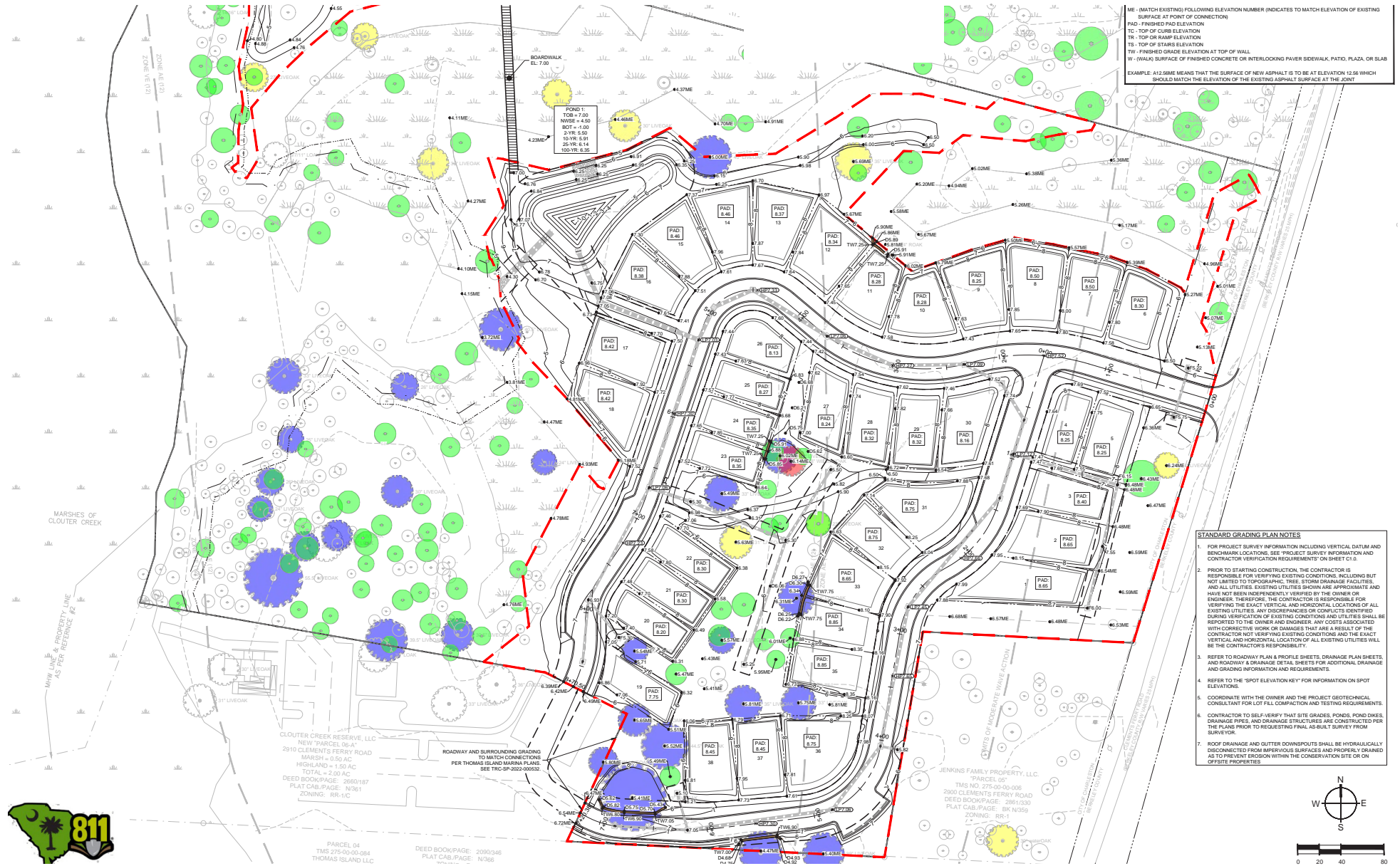

Bridge Commercial makes no guarantees, representations or warranties of any kind, expressed or implied, including warranties of content, accuracy and reliability. Any interested party should do their own research as to the accuracy of the information. Bridge Commercial excludes warranties arising out of this document and excludes all liability for loss and damages arising out of this document.

PERMITTED DOCK SLIPS

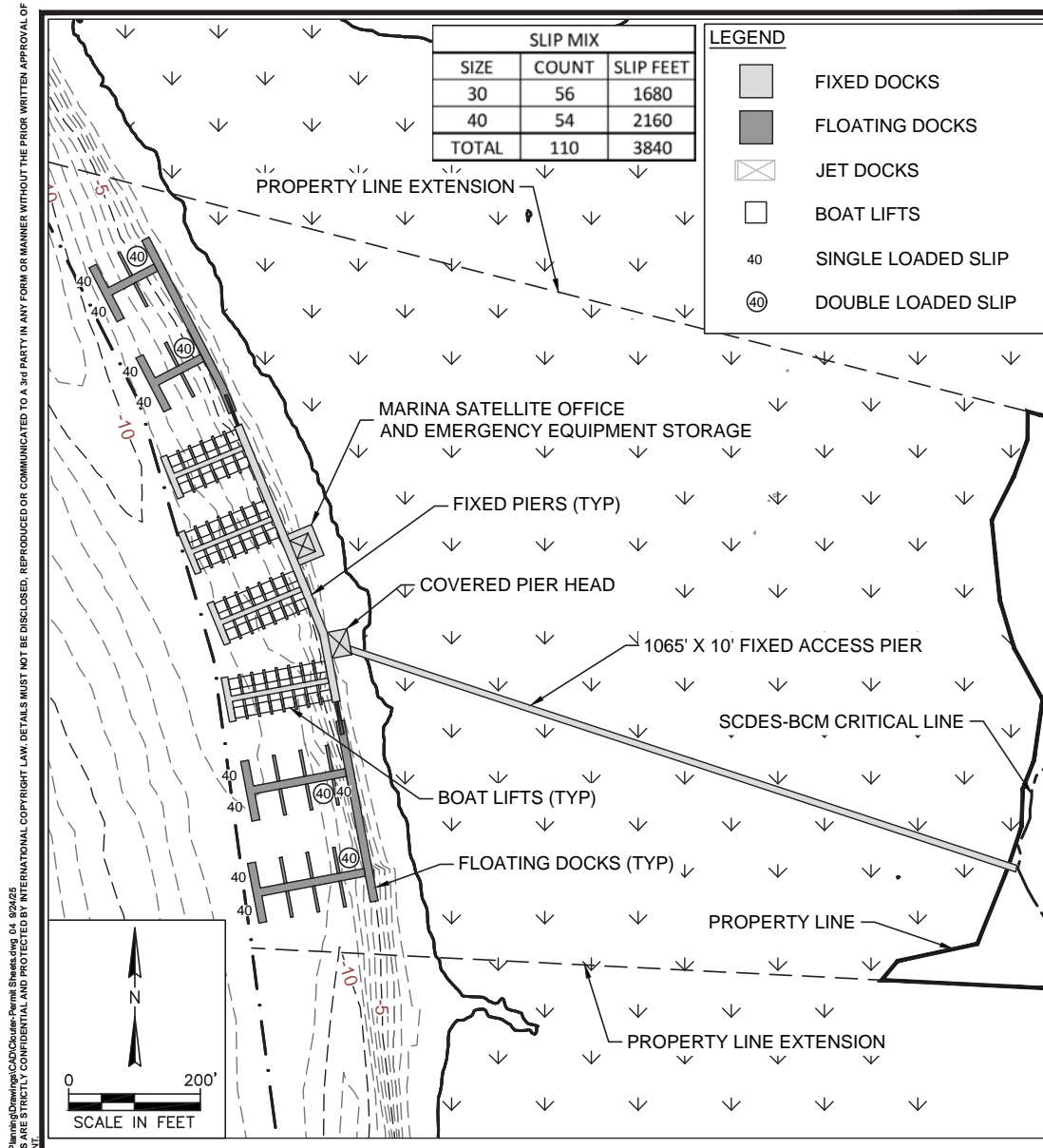

Bridge Commercial makes no guarantees, representations or warranties of any kind, expressed or implied, including warranties of content, accuracy and reliability. Any interested party should do their own research as to the accuracy of the information. Bridge Commercial excludes warranties arising out of this document and excludes all liability for loss and damages arising out of this document.

MARINA STORE CONCEPT



Bridge Commercial makes no guarantees, representations or warranties of any kind, expressed or implied, including warranties of content, accuracy and reliability. Any interested party should do their own research as to the accuracy of the information. Bridge Commercial excludes warranties arising out of this document and excludes all liability for loss and damages arising out of this document.

DISCLAIMER

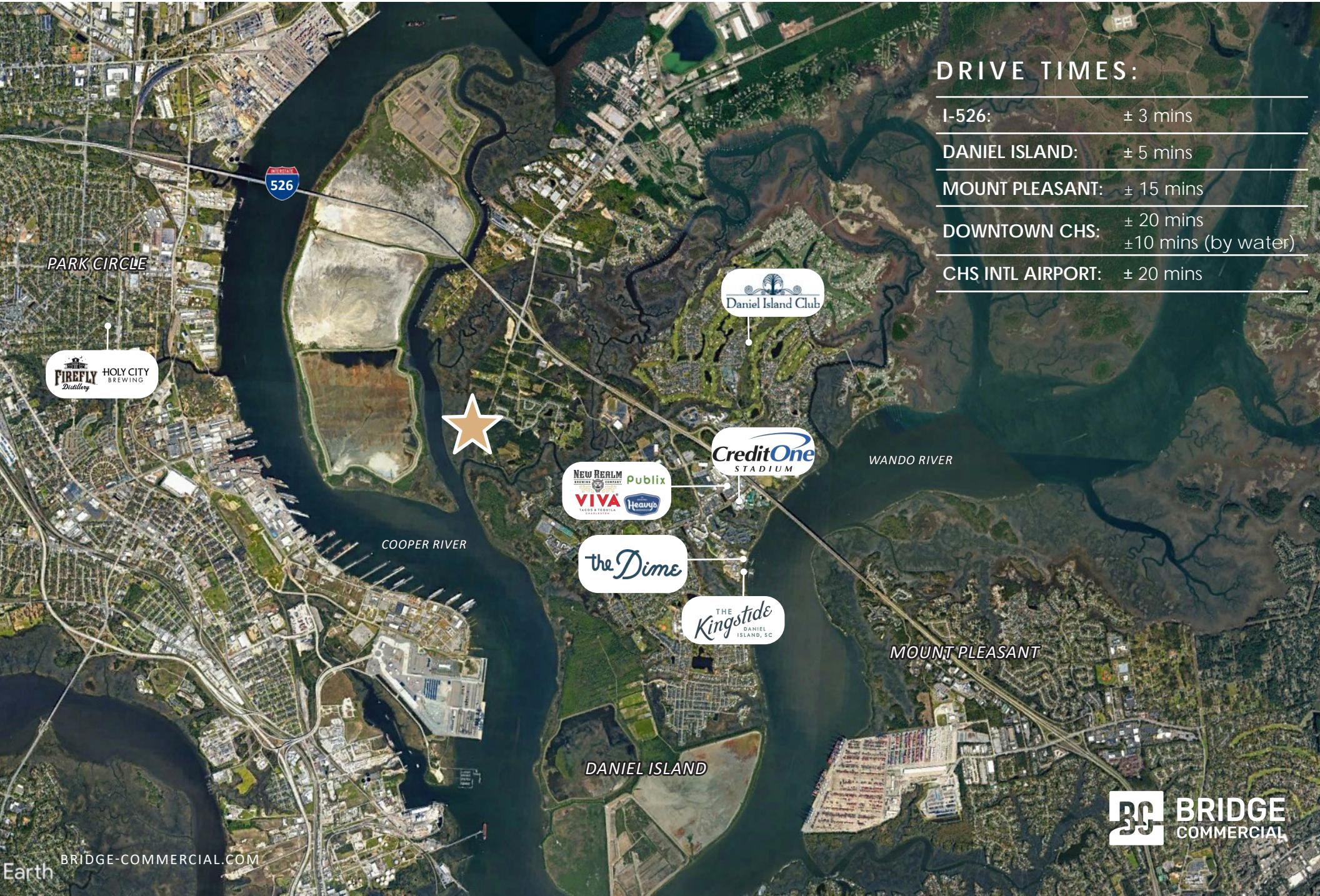

Exhibit F Page 1 of 1

Due to encroachments on the access road, permitting has been delayed. Please inquire for more information.

Bridge Commercial makes no guarantees, representations or warranties of any kind, expressed or implied, including warranties of content, accuracy and reliability. Any interested party should do their own research as to the accuracy of the information. Bridge Commercial excludes warranties arising out of this document and excludes all liability for loss and damages arising out of this document.

LOCATION OVERVIEW | DANIEL ISLAND AMENITIES



DRIVE TIMES:

I-526:	± 3 mins
DANIEL ISLAND:	± 5 mins
MOUNT PLEASANT:	± 15 mins
DOWNTOWN CHS:	± 20 mins ±10 mins (by water)
CHS INTL AIRPORT:	± 20 mins

PARK CIRCLE

FIREFLY HOLY CITY
Distillery BREWING

Daniel Island Club

Credit One
STADIUM

WANDO RIVER

NEW REALM
BREWING COMPANY
Publix
VIVA TACOS & TEQUILA
Heavenly

COOPER RIVER

the Dime

THE Kingstide
DANIEL ISLAND, SC

MOUNT PLEASANT

DANIEL ISLAND



FOR MORE INFORMATION

HAGOOD S. MORRISON, II

+1 843 830 9108

hs.morrison@bridge-commercial.com

JOHN BEAM

+1 843 810 6868

john.beam@bridge-commercial.com

HAGOOD MORRISON

+1 843 270 5219

hagood.morrison@bridge-commercial.com

BROOKS COURTNEY

+1 859 327 8749

brooks.courtney@bridge-commercial.com

GRAHAM MEISEL

+1 301 580 8099

graham.meisel@bridge-commercial.com

