

# COLUMBIA BLVD IOS SITE



SUBJECT  
PROPERTY

FOR LEASE

*16,769 SF Building with Secured Yard  
Available for Lease in NE Portland*

1601 N COLUMBIA BLVD, PORTLAND, OR 97217

SCOTT MURPHY, SIOR  
503.221.2287  
scott.murphy@kidder.com

JOHN HALLMAN  
503.721.2721  
john.hallman@kidder.com



*Centrally located warehouse/  
manufacturing space with secured  
yard and great access to I-5  
available for lease.*

TOTAL BUILDING AREA	16,769 SF
OFFICE AREA	1,600 SF
SECURED YARD	97,955 SF
YARD IMPROVEMENTS	Fully fenced and secured; 8' perimeter fence with two (2) 24' Gates
LIGHTING	Interior and exterior LED lighting
ELECTRICAL	400A, 480V 3-phase power (more power available)
LOADING	8 grade-level doors <ul style="list-style-type: none"><li>• 5 - 12' x 14'</li><li>• 1 - 16' x 14'</li><li>• 1 - 10'8" x 13'</li><li>• 1 - 8'2½" x 7'11"</li></ul>

*16,769 SF*  
TOTAL BUILDING AREA

*CALL*  
FOR LEASE RATE

# FLOOR PLAN

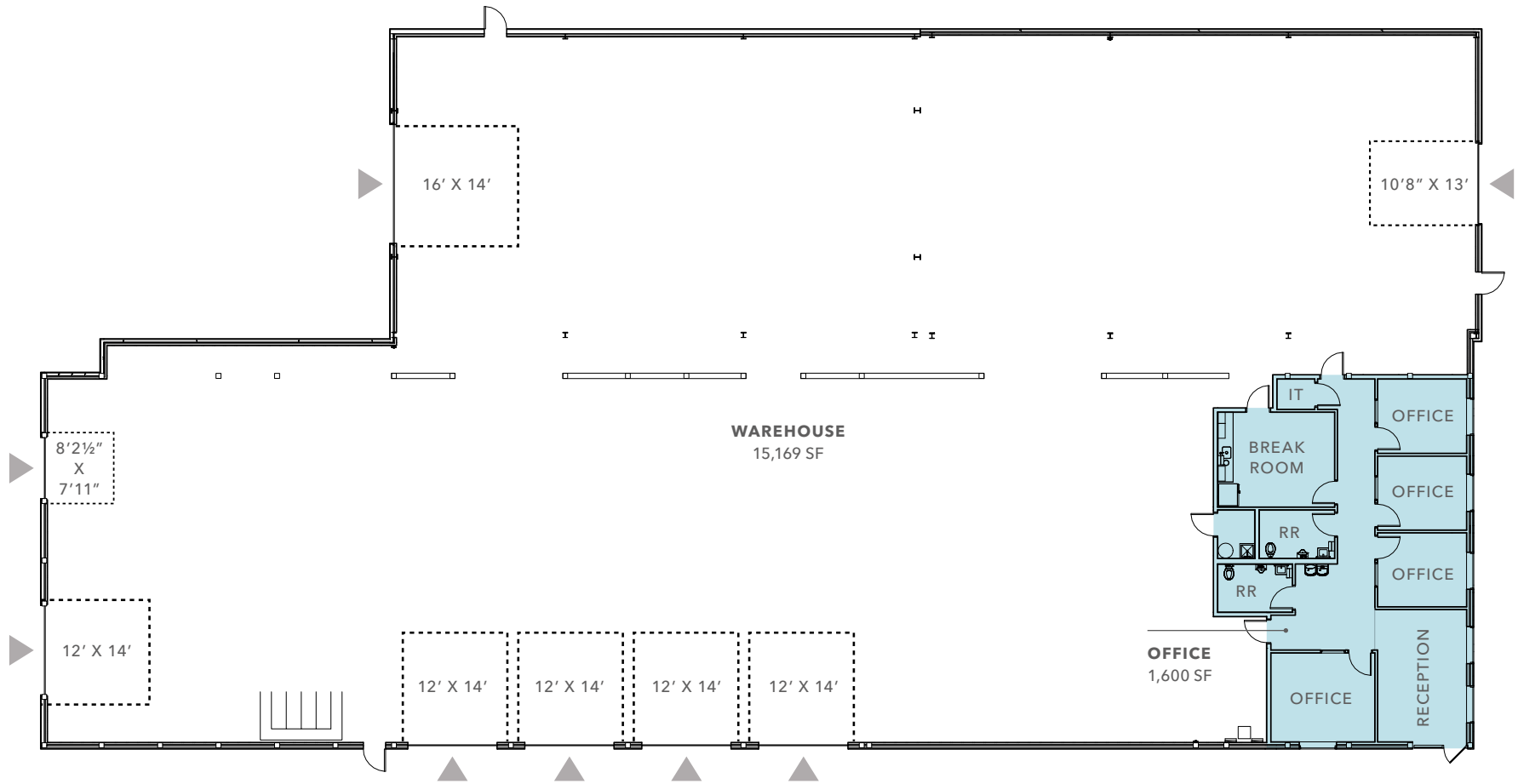

▲ Grade level loading



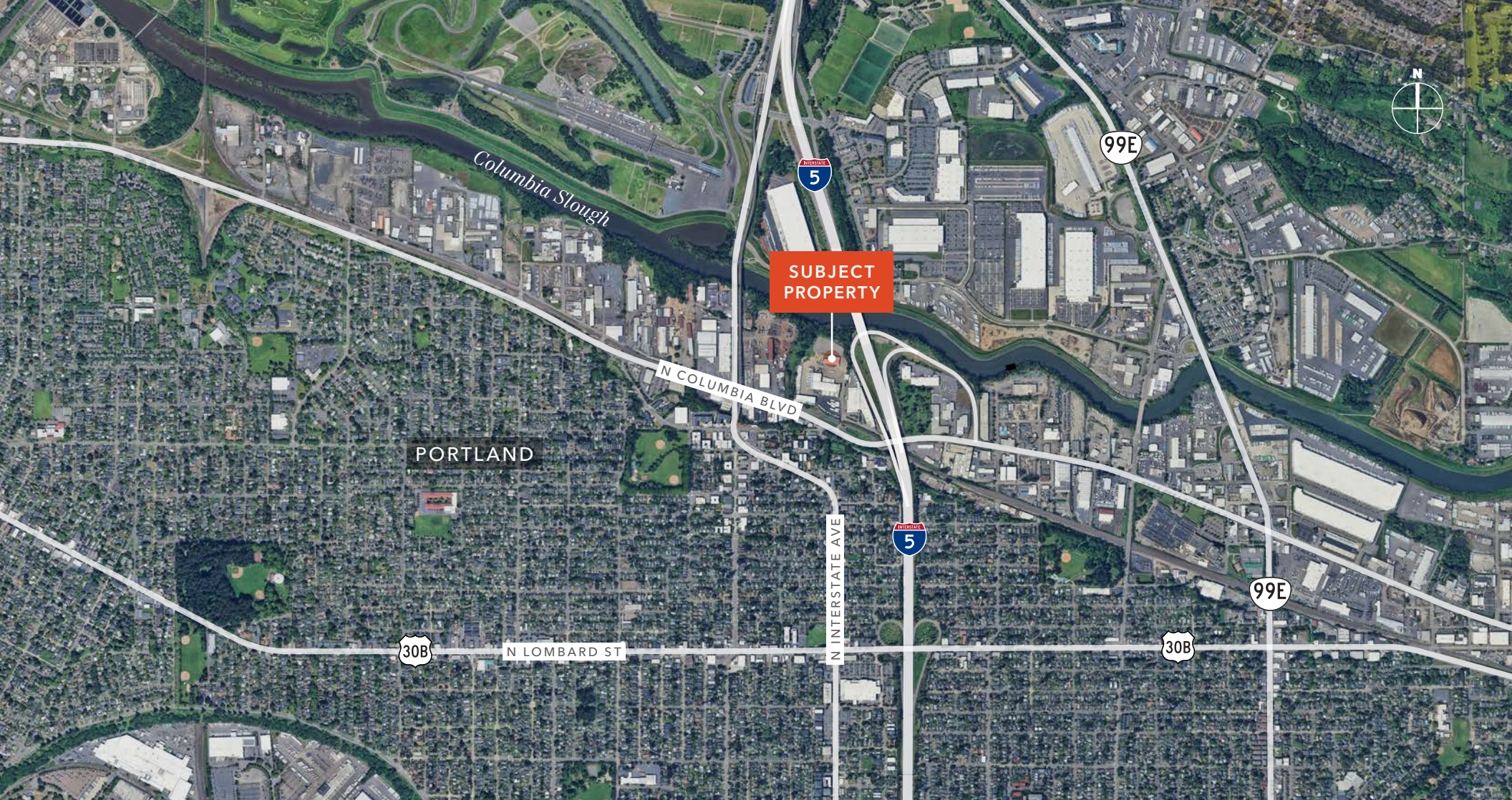

## COLUMBIA BLVD IOS SITE

*For more information on  
this property, please contact*

SCOTT MURPHY, SIOR  
503.221.2287  
scott.murphy@kidder.com

JOHN HALLMAN  
503.721.2721  
john.hallman@kidder.com

KIDDER.COM

This information supplied herein is from sources we deem reliable. It is provided without any representation, warranty, or guarantee, expressed or implied as to its accuracy. Prospective Buyer or Tenant should conduct an independent investigation and verification of all matters deemed to be material, including, but not limited to, statements of income and expenses. Consult your attorney, accountant, or other professional advisor. All Kidder Mathews designs are the sole property of Kidder Mathews. Branded materials and layouts are not authorized for use by any other firm or person.

