



## Highway Commercial Parcels Available

Highway 55 East, Clover, SC 29710



### 3 Commercial Parcels For Sale | Ground Lease | Build-to-Suit

- Zoned B-2 (Highway Commercial) in the City of Clover
- Excellent location for Office, Medical and Retail
- Public Utilities Available
- 1/3 mile from Clover High School
- Just west of Hwy 557

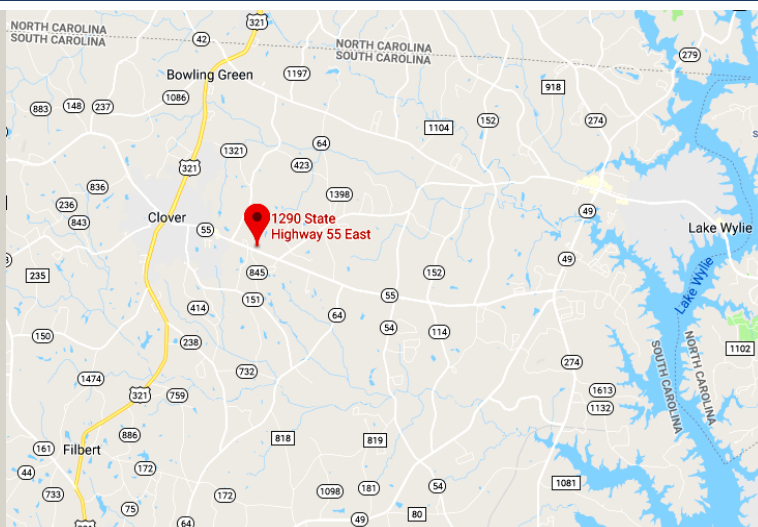

#### Pricing

PARCEL A: ±0.901 AC **SOLD**

PARCEL B: ±1.148 AC \$230,000

PARCEL C: ±2.042 AC **SOLD**

**Debbie Weatherby**

803-992-6110

debbie@tuttleco.com





# Highway Commercial Parcels Available

Highway 55 East, Clover, SC 29710

## 3 Commercial Parcels For Sale | Ground Lease | Build-to-Suit CONCEPTUAL SITE PLANS

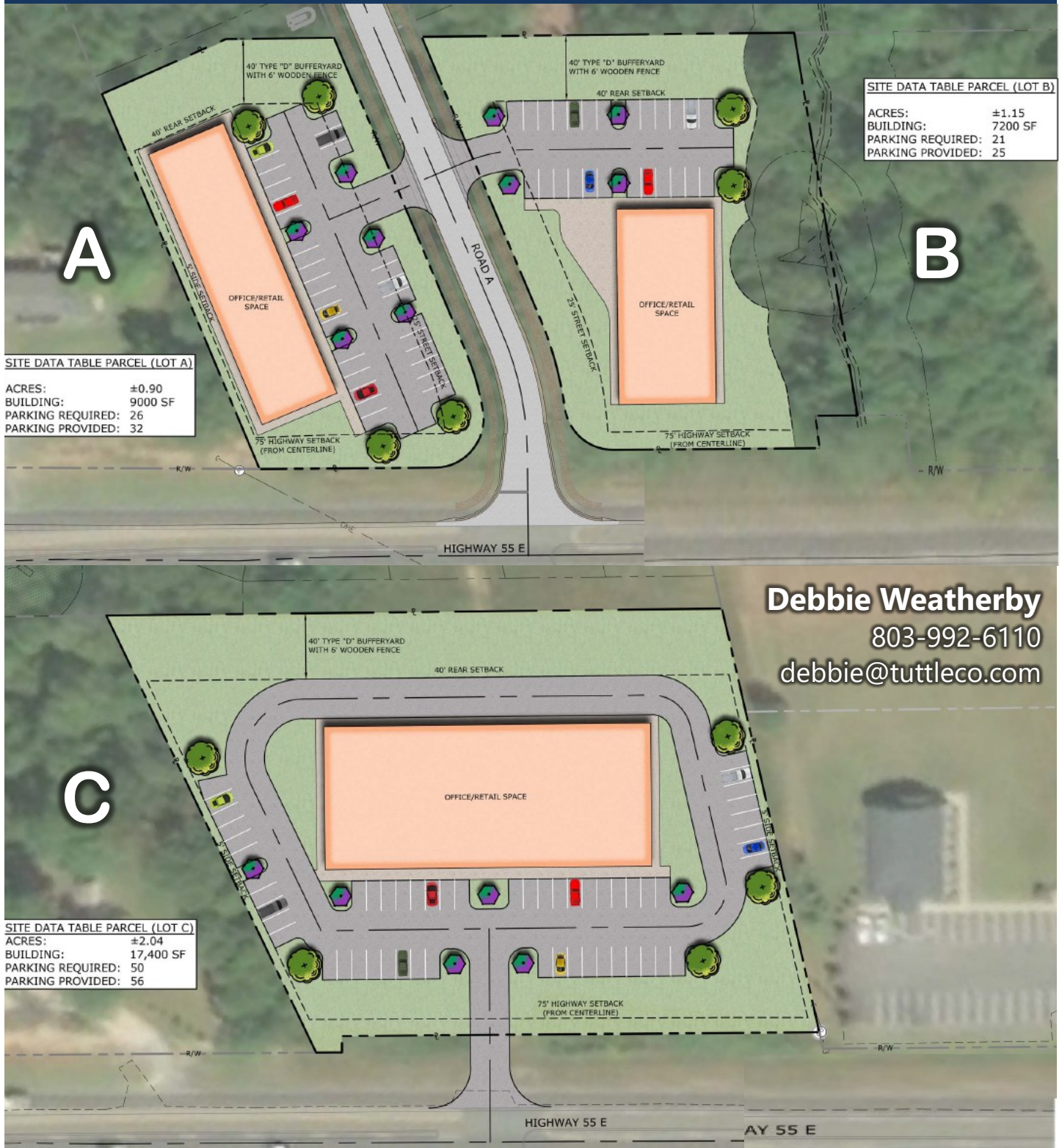

**Debbie Weatherby**  
803-992-6110  
debbie@tuttleco.com



Highway Commercial Parcels Available  
Highway 55 East, Clover, SC 29710

## 3 Commercial Parcels For Sale | Ground Lease | Build-to-Suit CONCEPTUAL SITE PLAN - PARCEL C

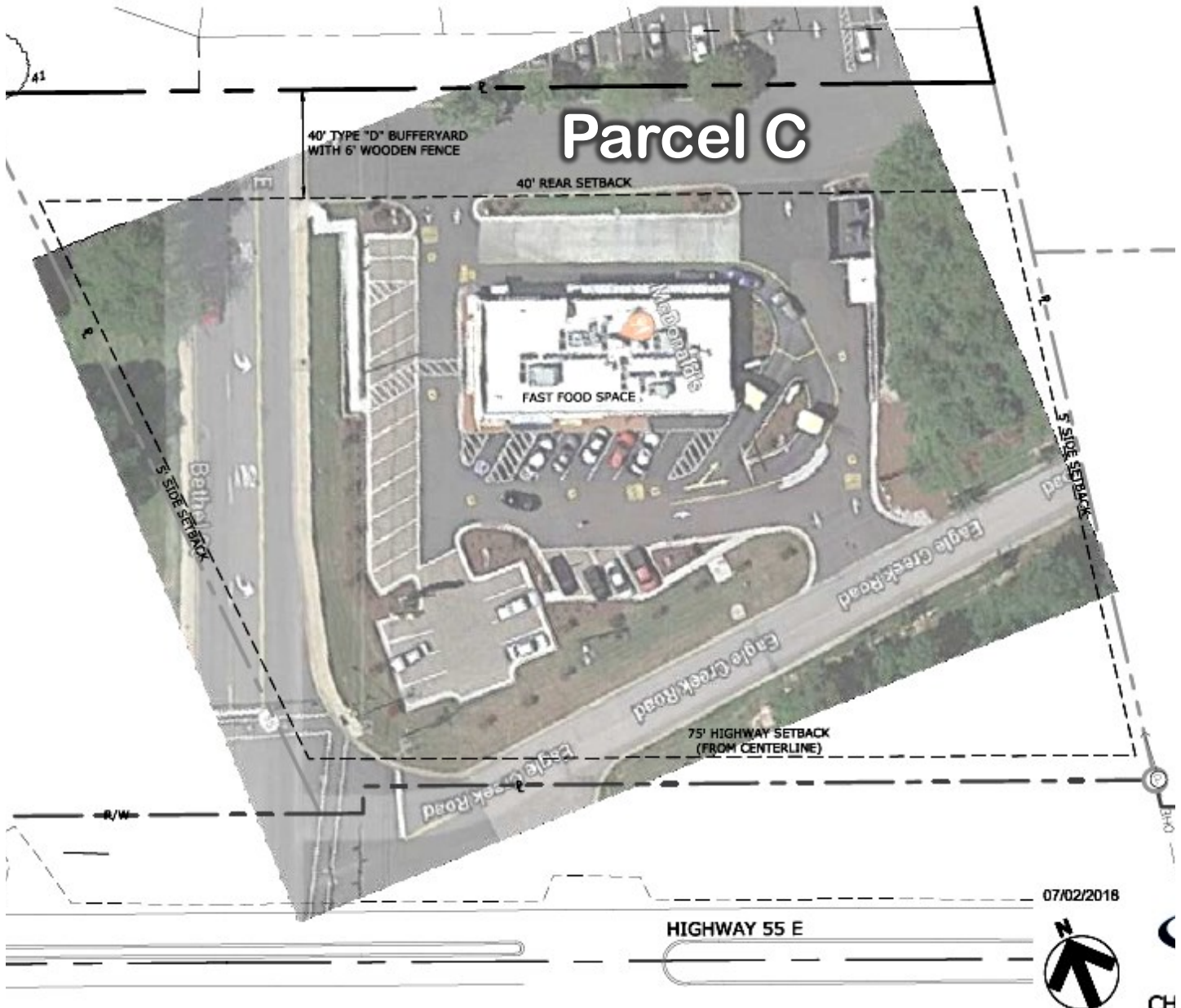

**Debbie Weatherby**  
803-992-6110  
debbie@tuttleco.com





# Highway Commercial Parcels Available

Highway 55 East, Clover, SC 29710

## 3 Commercial Parcels For Sale | Ground Lease | Build-to-Suit



**Debbie Weatherby**  
803-992-6110  
debbie@tuttleco.com

## Demographics

Population	1 Mile	3 Mile	5 Mile
2018 Total Population:	358	7,948	24,909
2023 Population:	392	8,879	27,851
Pop Growth 2018-2023:	9.50%	11.71%	11.81%
Average Age:	42.40	40.20	39.30
Households			
2018 Total Households:	134	2,919	9,253
HH Growth 2018-2023:	9.70%	11.78%	11.93%
Median Household Inc:	\$78,125	\$63,926	\$61,526
Avg Household Size:	2.70	2.70	2.70
2018 Avg HH Vehicles:	2.00	2.00	2.00
Housing			
Median Home Value:	\$198,935	\$180,711	\$176,728
Median Year Built:	1991	1993	1993



# Highway Commercial Parcels Available

Highway 55 East, Clover, SC 29710

**3 Commercial Parcels For Sale | Ground Lease | Build-to-Suit**

