

SEPTIC TANK INSPECTION

1981

Property Owner: Tanglewood Motel (Gene Breed) Address: Rt. #1 Maggie
Location of Property: 1/2 mile across from Station in Maggie
Septic Tank: Dimensions _____ Material concrete
Precast Yes No Capacity 1050 (1200) gal
Type Secondary Treatment: Nitrification Line Filter Trench Length of Lines 100' Width 30"
Number of Lines 3 Installed By: Med Owens

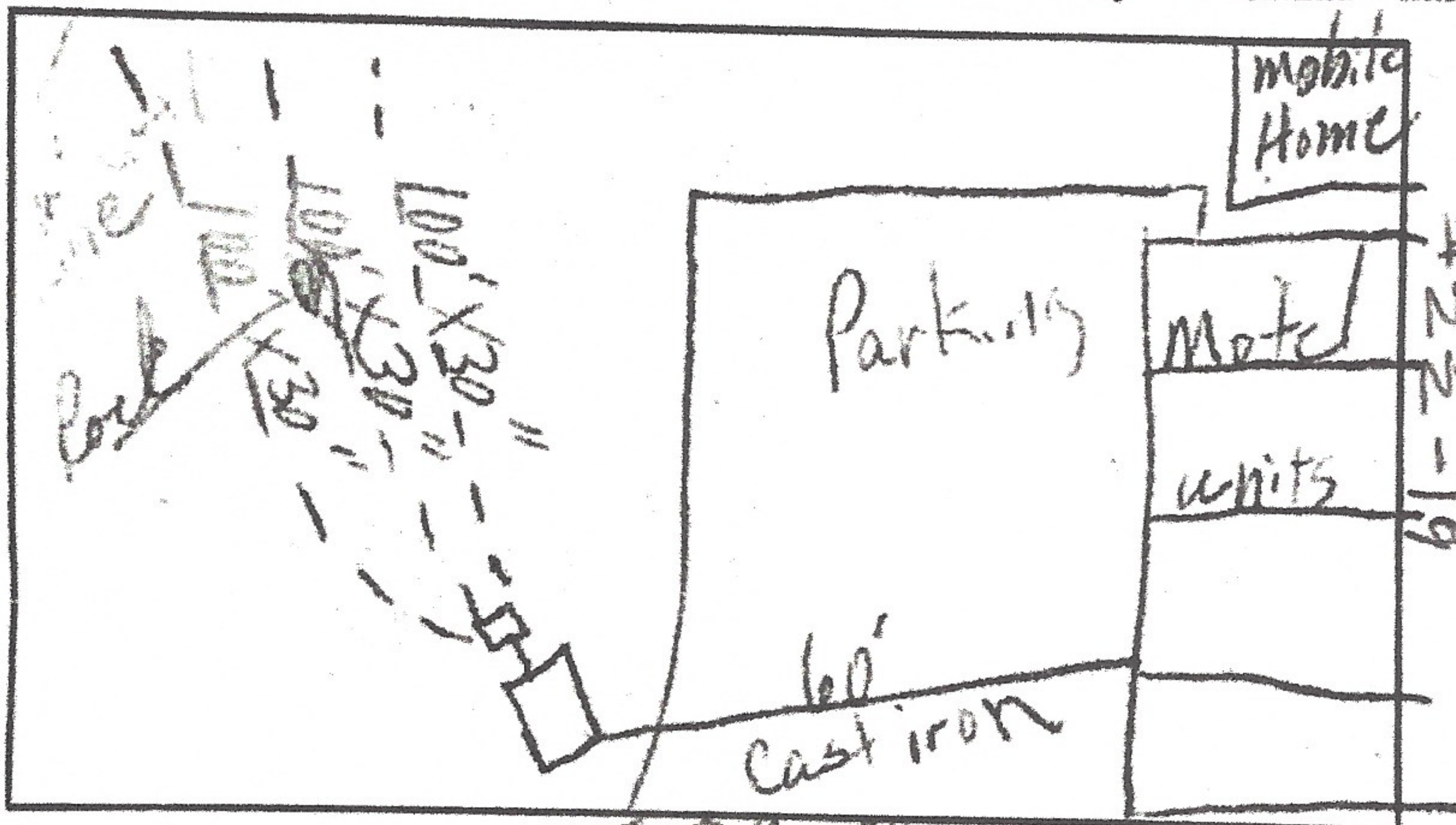

Designed For Use For:
 Commercial Building: Type Motel
 Residence: Number Bedrooms _____
Automatic Washer: Yes No
Garbage Grinder: Yes No
Approved: Yes No
Source of Water Supply: Drilled Well
Remarks: approved for 4 units and
one mobile home - cast iron
under pavement

Date 5-25-74

Sanitarian Leslie Matthews

Haywood County Health Department

NOTE—This permit is issued subject to all the provisions of the Board of Health governing the installation of septic tanks or plumbing in unsewered areas of Haywood County. No plumber or other person is permitted to make any alteration other than that which is specifically stated in this permit.

LOCATION Maggie OWNER TANGLEWOOD M^{TEL} WH COLORED _____
 ADDRESS Rt. 2, Waynesville OCCUPANT GENE BREECE Garret Court WHITE _____ COLORED _____

PRIVY: Type wood SEPTIC TANK: Material 6" blocks FHA CASE NUMBER _____
 Number _____ Dimensions _____ VA CASE NUMBER _____
 New _____ Volume 2300 gal.
 Repaired _____ date _____ Type secondary treatment 3 lines 100'x30" each
 date _____ nitrification line filter trench

WATER SUPPLY: Source In well
 If well, type _____
 (Bored)
 (Drilled)
 _____ (Dug)
 Distance from nearest pollution _____ ft.

No. of bedrooms 8 units
 Permit Number _____ Date _____
 Approved _____ Date 11-2-60
 Approved by Don J. McCracken
 Contractor or Plumber Bill Kanos
 Address Waynesville, N.C.
 Remarks _____

SEWAGE DISPOSAL RECORD

Form No. 473 (Rev. 9/58)

NOTE: Make sketch of installation showing location of house, septic tanks, privies, water supplies on adjacent property, etc. Write in measurements in order that installations may be located at later date.

