

FOR LEASE

Small suites available

Baker Plaza

37608 N Cave Creek Rd
Cave Creek, AZ 85331



Get more information

Kyle Farrell

T 480 994 8155

C 480 815 3755

kyle.farrell@avisonyoung.com

Matt Milinovich

D 480 423 7959

C 602 885 9393

matt.milinovich@avisonyoung.com

**AVISON
YOUNG**

Property overview

For lease
37608 N Cave Creek Rd

Small suite available, perfect for office, medical, or retail use. Located just minutes away from The Boulders Resort, Rancho Mañana Golf Club, and the Black Mountain Summit Recreational Area. Near high growth, high income trade areas of Cave Creek & Carefree.

Property features include:

- Small suite sizes
- Private parking lot
- Close proximity to Carefree Highway



Offering summary

| | |
|---------------|---------------------------|
| Use | Office, Medical or Retail |
| Lease rate | Call for pricing |
| Building size | ±9,713 sf |

Notable tenants in area:



Site plan

For lease
37608 N Cave Creek Rd

First floor

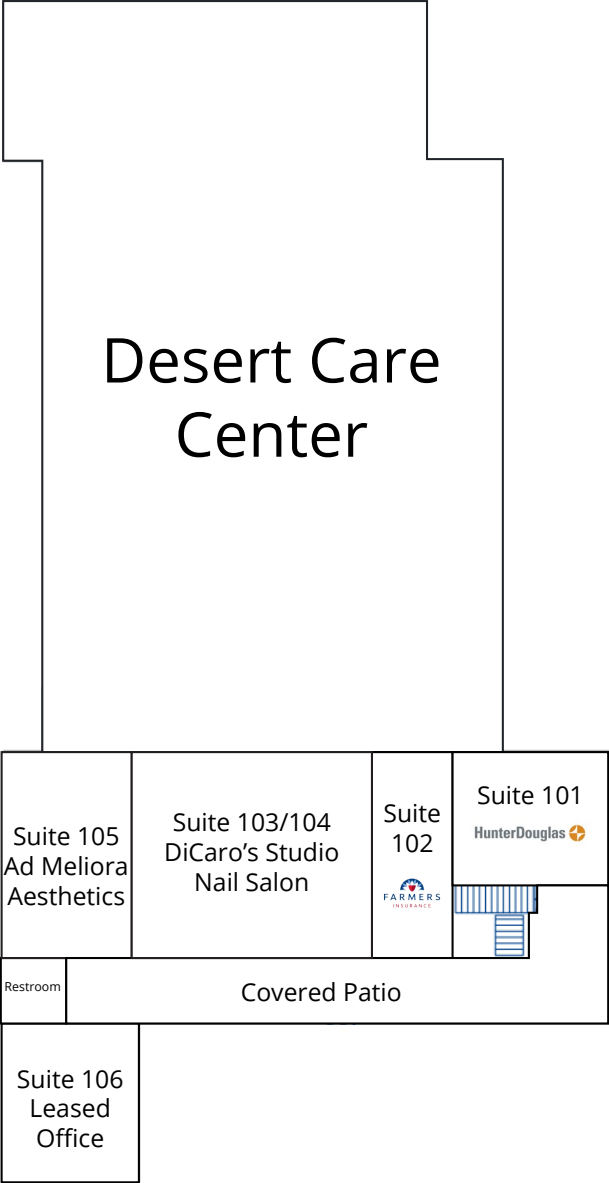

Second floor

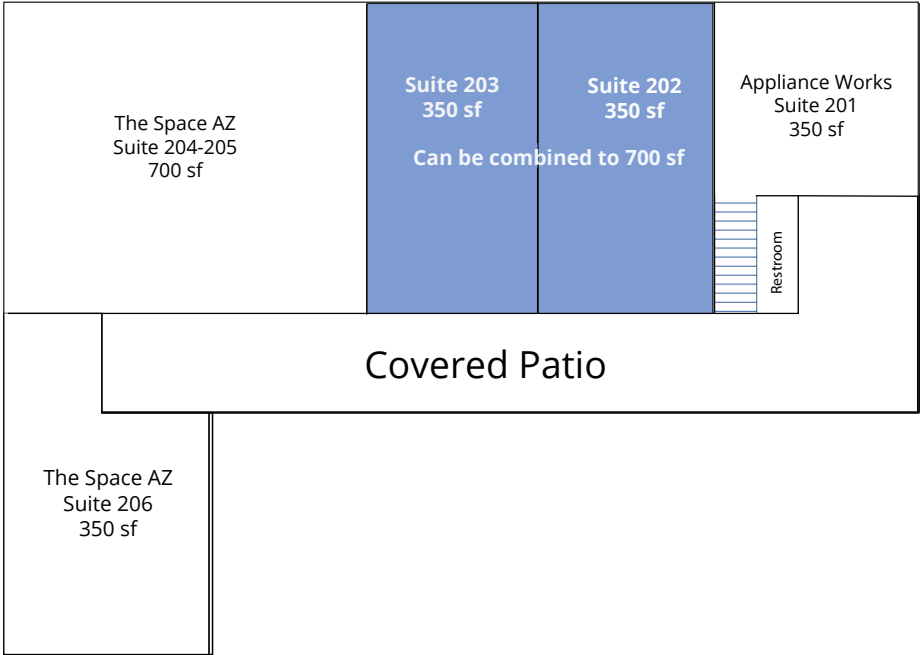

Suite 202/203: 350-700 sf

For lease
37608 N Cave Creek Rd





Location

For lease
37608 N Cave Creek Rd



Demographics

| | | | |
|---|--------------|---------------|---------------|
|  | 1-mile | 3-miles | 5-miles |
| Population | 2,217 | 14,368 | 37,260 |

| | | | |
|---|-------------|-------------|-------------|
|  | 1-mile | 3-miles | 5-miles |
| Median age | 57.2 | 57.7 | 55.3 |

| | | | |
|---|------------|--------------|---------------|
|  | 1-mile | 3-miles | 5-miles |
| Daytime employment | 978 | 6,058 | 10,136 |

| | | | |
|---|------------------|------------------|------------------|
|  | 1-mile | 3-miles | 5-miles |
| Avg. HH income | \$147,685 | \$176,126 | \$202,094 |

| | | | |
|---|--------------|--------------|---------------|
|  | 1-mile | 3-miles | 5-miles |
| HH units | 1,218 | 7,694 | 18,683 |

Travel time within 5-miles

| | | |
|---|--------------------------------------|--------------------|
|  | Travel to work in 14 minutes or less | 2,665 15.5% |
| | Average minutes travel to work | 25.7 |

