

# POTRERO CENTER

2300 16TH STREET,  
SAN FRANCISCO, CA 94103



±1,900 SF - ±38,370 AVAILABLE

# HIGHLIGHTS



Predominant power center in the Mission of San Francisco



Strong daily needs co-tenancy including Safeway, 24Hr Fitness, Petco and Decathlon



Excellent visibility from three major roads



Extremely dense daytime population of 836,000 within three miles

## TRAFFIC COUNTS

Potrero Ave & Utah St	16,390 ADT
Central Fwy & Bryant St	63,000 ADT
James Lick Fwy & 16th St	107,300 ADT

## DEMOGRAPHICS

	1 MILE	3 MILES	5 MILES
Population	91,980	552,081	855,374
Average HH Income	\$182,114	\$182,425	\$176,563
Daytime Population	126,012	835,939	1,133,501



# AVAILABLE SPACES



# SITE MAP

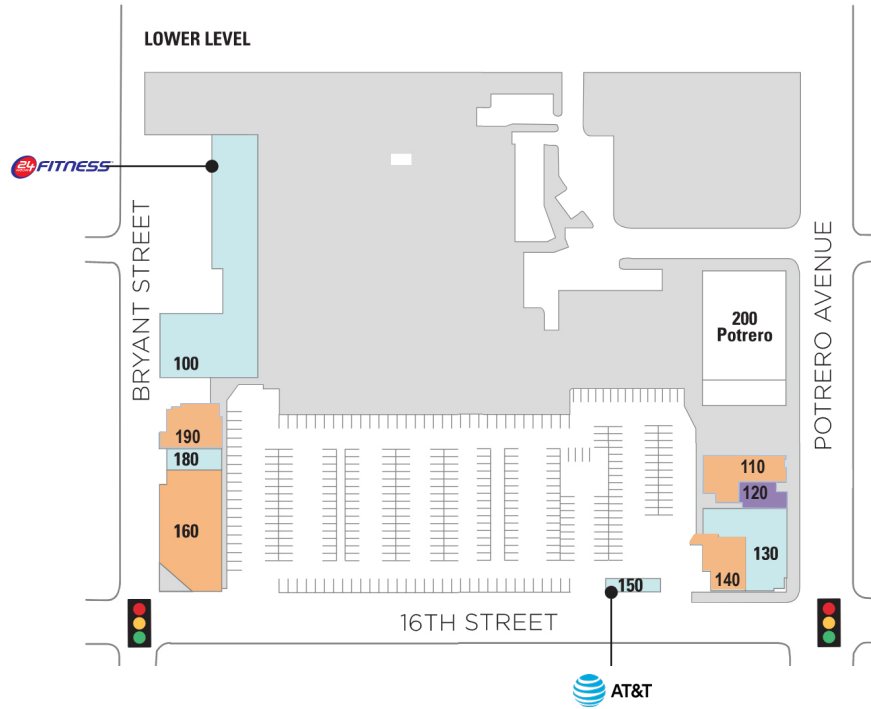

<span style="color: orange;">■</span> Available	<span style="color: lightblue;">■</span> Leased
<span style="color: purple;">■</span> Available Soon	<span style="border: 1px solid black; display: inline-block; width: 10px; height: 10px;"></span> Not a Part

SPACE	TENANT	SF
110	AVAILABLE	4,597
140	AVAILABLE (Restaurant)	3,144
160	AVAILABLE	10,747
190	AVAILABLE	3,890
210	AVAILABLE	38,370
340A	AVAILABLE (Restaurant)	2,713
120	AVAILABLE SOON (Restaurant)	1,900
100	24 HOUR FITNESS	27,105

SPACE	TENANT	SF
130	O'REILLY AUTO PARTS	7,215
150	AT&T	915
180	H&R BLOCK	1,487
200	PETCO	13,070
240	SAFEWAY	59,566
250	PEET'S COFFEE & TEA	1,673
260	JAMBA JUICE	969
270	NOAH'S NEW YORK BAGELS	1,688

SPACE	TENANT	SF
280	SALLY BEAUTY SUPPLY	1,633
290	ROSS DRESS FOR LESS	25,277
300	TOGO'S	1,500
310	AAA	5,680
320	MANCINI'S SLEEPWORLD	5,200
330	JPMORGAN CHASE BANK	4,486
340	COMCAST	3,317
350	EYEBROW SHAPERS	280





WHOLE FOODS MARKET

TJ-maxx

SAFeway

AT&T PARK

SAN FRANCISCO CITY HALL

NORDSTROM  
rack  
TRADER JOE'S  
BED BATH & BEYOND

KREI

ZYNGA CORPORATE HQ

COSTCO WHOLESALE

ADOBE CORPORATE HQ

PORT OF SAN FRANCISCO

BEST BUY  
Office DEPOT

POTRERO SHOPPING CENTER  
SAFeway 24 FITNESS  
ROSS DRESS FOR LESS petco

UCSF MEDICAL CENTER AT MISSION BAY

NEW GOLDEN STATE WARRIORS STADIUM

RAINBOW GROCERY

Foods Co.

DESIGN DISTRICT

CALIFORNIA COLLEGE OF THE ARTS (CCA)

Sports Basement



s f d c

DOLBY LABS

TIMKEN HALL - CALIFORNIA COLLEGE OF THE ARTS

GUS'S COMMUNITY MARKET

THE WATTIS INSTITUTE

WHOLE FOODS MARKET

101

# POTRERO CENTER



**JAMES CHUNG** (408) 400-7017 | [jchung@theeoniccompany.com](mailto:jchung@theeoniccompany.com) | LIC #01408190  
**NICOLE LYON** (408) 400-7008 | [nlyon@theeoniccompany.com](mailto:nlyon@theeoniccompany.com) | LIC #01975898  
**MIKE CONROY** (408) 400-7061 | [mconroy@theeoniccompany.com](mailto:mconroy@theeoniccompany.com) | LIC #02046912  
**MARISA DELGADO** (408) 400-7014 | [mdelgado@theeoniccompany.com](mailto:mdelgado@theeoniccompany.com) | LIC #01917354



the eonic company®

© 2024 the eonic company. No warranty or representation, express or implied, is made to the accuracy or completeness of the information contained herein, and same is submitted subject to errors, omissions, change of price, rental or other conditions, withdrawal without notice, and to any special listing conditions imposed by the property owner(s). As applicable, we make no representation as to the condition of the property (or properties) in question.

Pruneyard Tower 1  
1901 S. Bascom Ave., Suite 110  
Campbell, CA 95008