

13685 OTTERSON COURT  
LIVONIA, MICHIGAN

INDUSTRIAL FOR LEASE  
9,625 Square Feet Available



**SIGNATURE  
ASSOCIATES**  
KNOW SIGNATURE | KNOW RESULTS

**MUST SEE BUILDING!**



## PROPERTY FEATURES

- 9,625 square feet available
- 1,625 square feet of office
- 18' clear height
- (1) truckwell, (1) 12x14 overhead door
- New epoxy floor
- (1) 7.5-Ton & (1) 10-Ton bridge crane
- 15 parking spaces
- 1,000 amps, 240 volts, 3-phase power
- Great freestanding building just off I-96 Service Drive east of Levan Road
- Lease Rate: \$8.95/sq. ft. NNN



For more information, please contact:

**GARY SALLEN**  
(248) 948 0105  
gsallen@signatureassociates.com

**STEVE GORDON**  
(248) 948 0101  
sgordon@signatureassociates.com

**SIGNATURE ASSOCIATES**  
One Towne Square, Suite 1200  
Southfield, MI 48076  
www.signatureassociates.com

# 13685 Otterson Court – Livonia, Michigan

## Industrial For Lease

9,625  
Square Feet  
AVAILABLE

### Site Plan

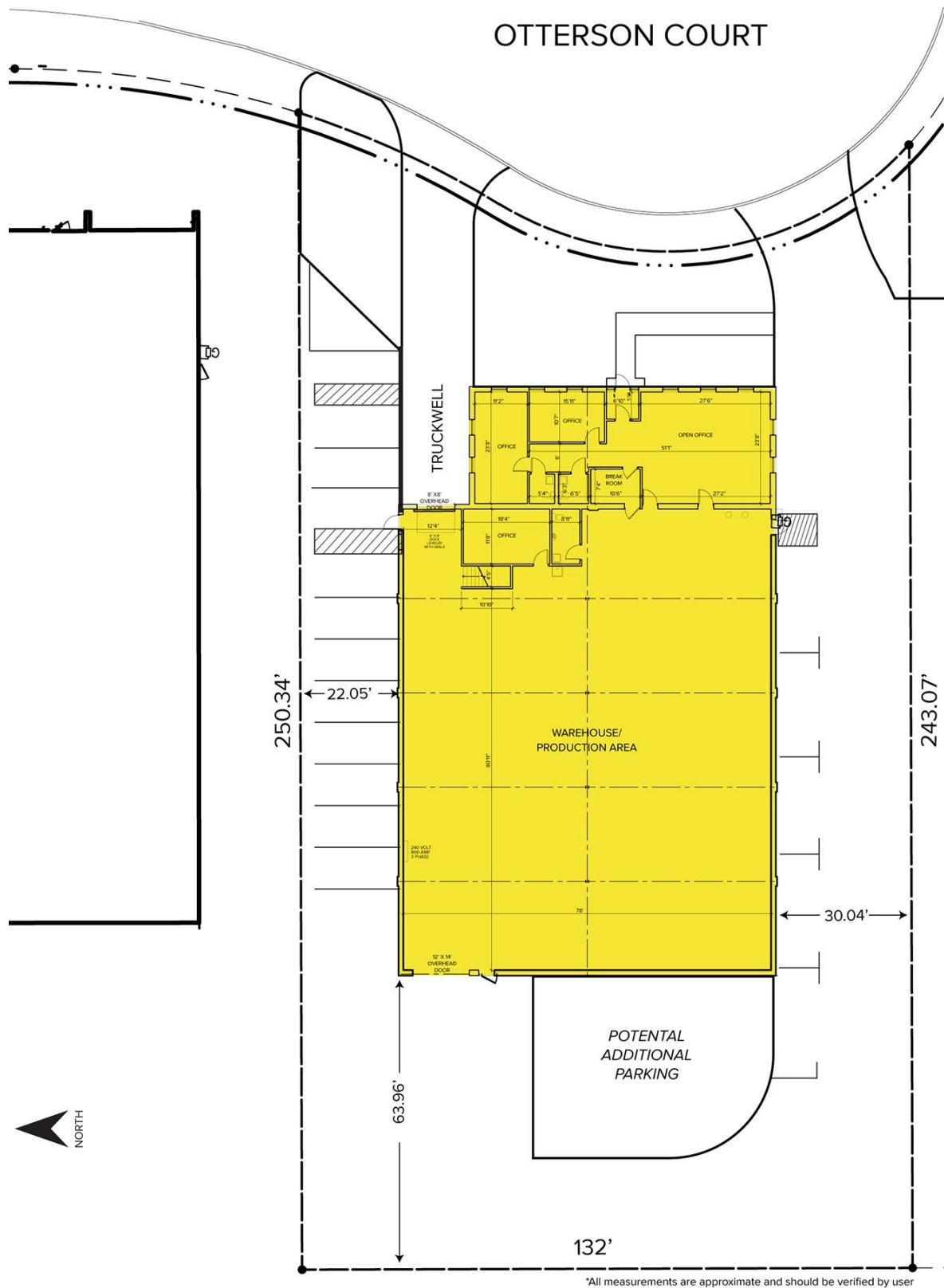

\*All measurements are approximate and should be verified by user

For more information, please contact:

**GARY SALLEN**  
(248) 948 0105  
gsallen@signatureassociates.com

**STEVE GORDON**  
(248) 948 0101  
sgordon@signatureassociates.com

**SIGNATURE ASSOCIATES**  
One Towne Square, Suite 1200  
Southfield, MI 48076  
www.signatureassociates.com

# 13685 Otterson Court – Livonia, Michigan

## Industrial For Lease

9,625  
Square Feet  
AVAILABLE

### Floor Plan

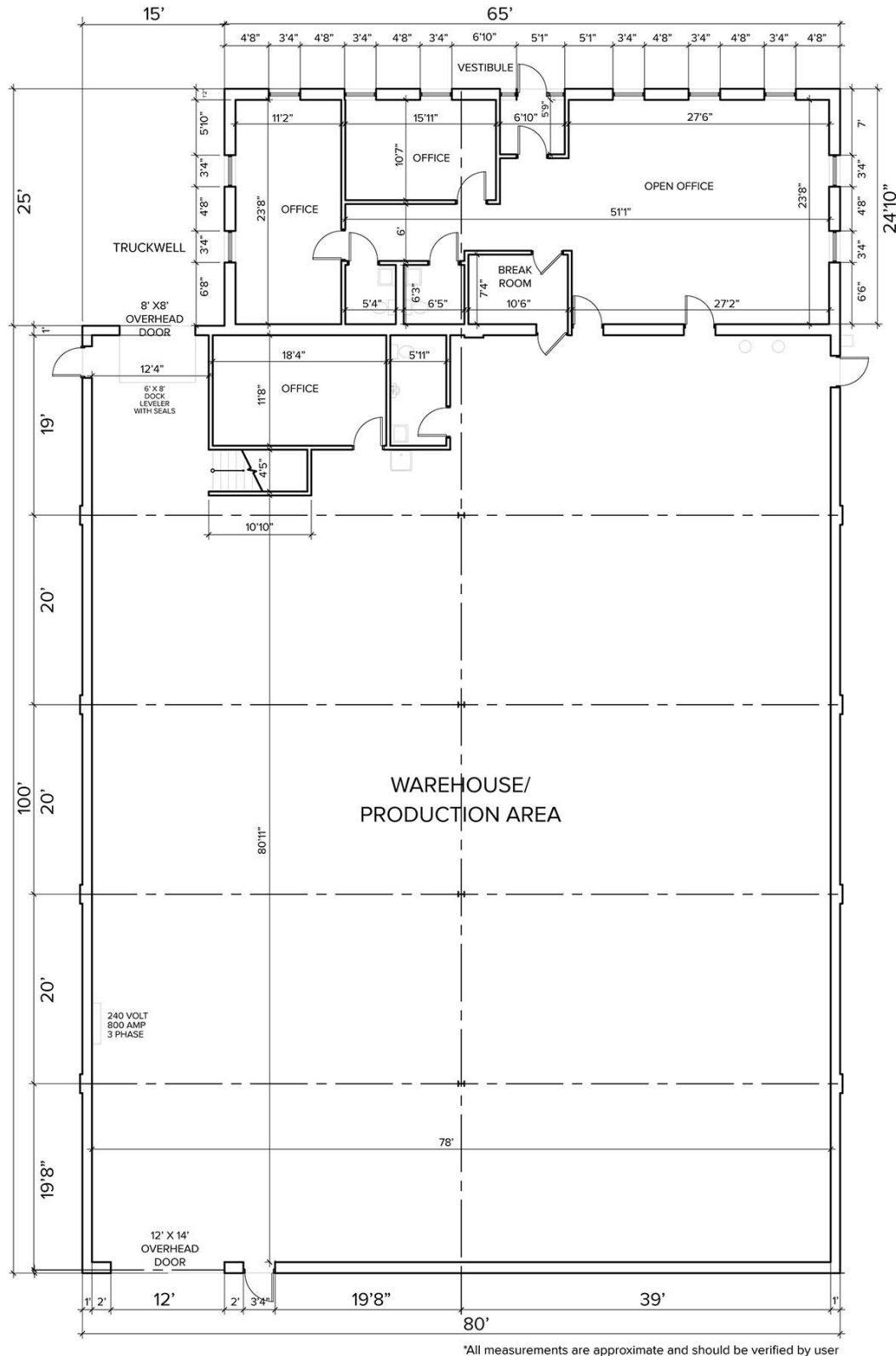

For more information, please contact:

**GARY SALLEN**  
(248) 948 0105  
gsallen@signatureassociates.com

**STEVE GORDON**  
(248) 948 0101  
sgordon@signatureassociates.com

**SIGNATURE ASSOCIATES**  
One Towne Square, Suite 1200  
Southfield, MI 48076  
www.signatureassociates.com



# 13685 Otterson Court – Livonia, Michigan

## Industrial For Lease

9,625  
Square Feet  
AVAILABLE

Aerial



For more information, please contact:

**GARY SALLEN**  
(248) 948 0105  
gsallen@signatureassociates.com

**STEVE GORDON**  
(248) 948 0101  
sgordon@signatureassociates.com

**SIGNATURE ASSOCIATES**  
One Towne Square, Suite 1200  
Southfield, MI 48076  
www.signatureassociates.com

Information is subject to verification and no liability for errors or omissions is assumed. Price is subject to change and listing withdrawal.