



FOR LEASE

# Northup North—Building C

2330 130<sup>th</sup> Ave NE, Bellevue, WA 98005



## Property Highlights

- Suite 100—2,430 RSF  
Suite 101—1,420 RSF  
Suite 100/101 Combined—3,850 RSF
- Available Immediately
- \$30.00/RSF, Full Service
- Plentiful Surface Parking
- Lobby Exposure
- Manicured Grounds with Picnic Tables and Walking Trails

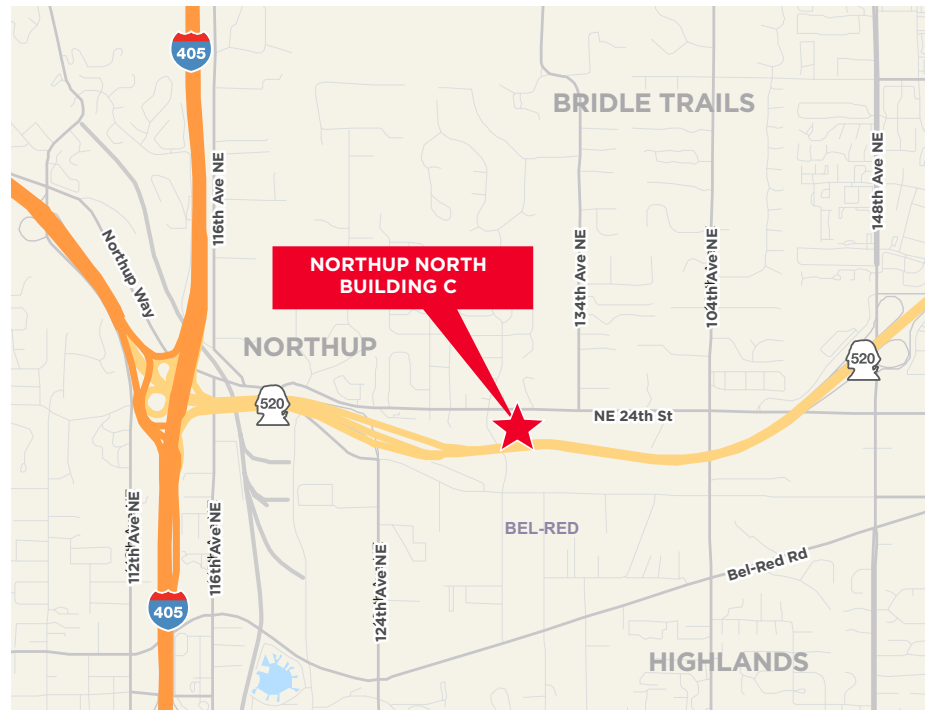

**Brian Toy**  
Director  
+1 425 201 1224  
brian.toy@cushwake.com

**Taylor Hudson**  
Senior Associate  
+1 425 201 1205  
taylor.hudson@cushwake.com

11235 SE 6th Street, Suite 200  
Bellevue, WA  
Main +1 425 455 4500  
Fax +1 425 453 5381  
[cushmanandwakefield.com](http://cushmanandwakefield.com)

©2021 Cushman & Wakefield. All rights reserved. The information contained in this communication is strictly confidential. This information has been obtained from sources believed to be reliable but has not been verified. NO WARRANTY OR REPRESENTATION, EXPRESS OR IMPLIED, IS MADE AS TO THE CONDITION OF THE PROPERTY (OR PROPERTIES) REFERENCED HEREIN OR AS TO THE ACCURACY OR COMPLETENESS OF THE INFORMATION CONTAINED HEREIN, AND SAME IS SUBMITTED SUBJECT TO ERRORS, OMISSIONS, CHANGE OF PRICE, RENTAL OR OTHER CONDITIONS, WITHDRAWAL WITHOUT NOTICE, AND TO ANY SPECIAL LISTING CONDITIONS IMPOSED BY THE PROPERTY OWNER(S). ANY PROJECTIONS, OPINIONS OR ESTIMATES ARE SUBJECT TO UNCERTAINTY AND DO NOT SIGNIFY CURRENT OR FUTURE PROPERTY PERFORMANCE.



**Suite 101 - 1,420 RSF**

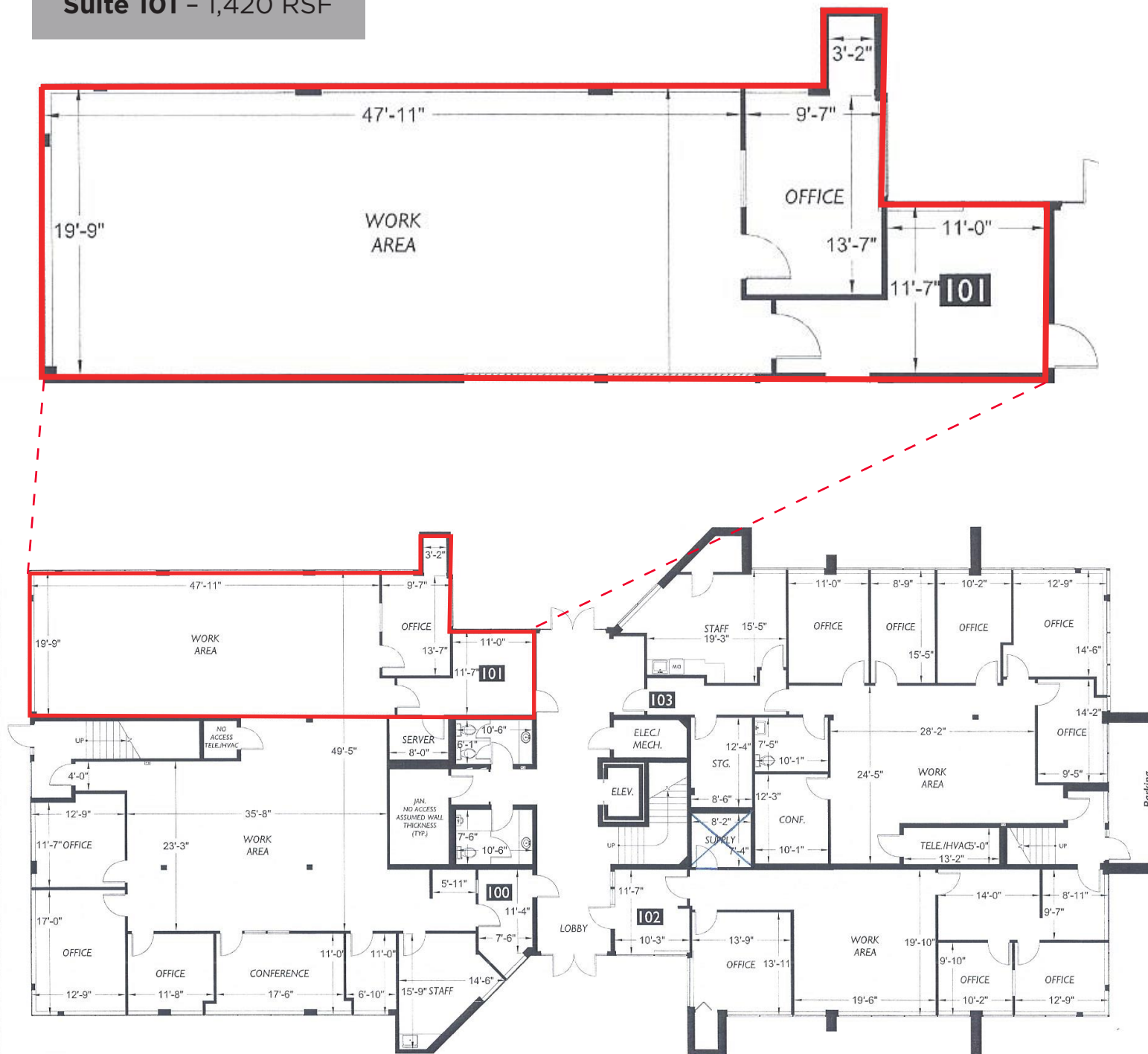

**Brian Toy**  
Director  
+1 425 201 1224  
brian.toy@cushwake.com

**Taylor Hudson**  
Senior Associate  
+1 425 201 1205  
taylor.hudson@cushwake.com

11235 SE 6th Street, Suite 200  
Bellevue, WA  
Main +1 425 455 4500  
Fax +1 425 453 5381  
[cushmanandwakefield.com](http://cushmanandwakefield.com)

