

1234 MARKET STREET
PHILADELPHIA, PA 19107

STEPS
FROM CITY HALL



GROUND FLOOR RETAIL | 1,946 SF AVAILABLE FOR LEASE

PROPERTY HIGHLIGHTS



Turnkey opportunity; currently built out as a pizza restaurant



Furniture and equipment available, including: 2 walk-in refrigerators, built-in tables and seating, built-in counters, full Hood and Ansel System, and more



Located in SEPTA'S Headquarters; 672,143 SF Class-A office building in the heart of Market East



Significant signage opportunities & tremendous visibility -25'2" of frontage along Market Street



Direct concourse access to SEPTA Regional Rail



Within two blocks of City Hall, Jefferson University Hospital, PA Convention Center, and Reading Terminal Market

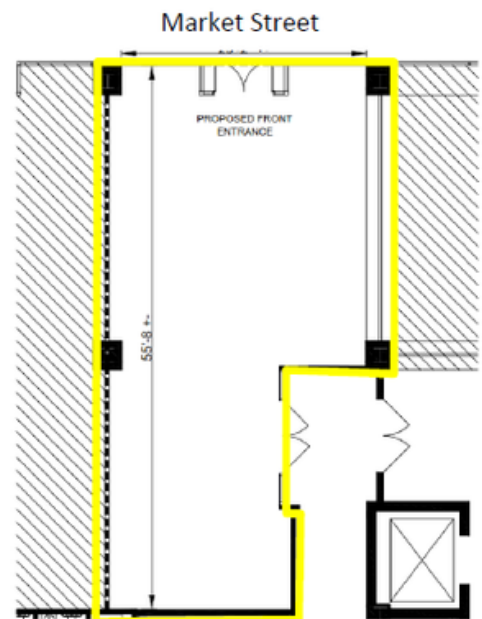

EXCLUSIVELY
REPRESENTED BY
THE FLYNN COMPANY

MICHAEL GALLAGHER
MGALLAGHER@FLYNNCO.COM
215-561-6565 X 151

JOSEPH NASELLI
JNASELLI@FLYNNCO.COM
215-561-6565 X 155

BRENDAN FLYNN
BFLYNN@FLYNNCO.COM
215-561-6565 X 152

The
Flynn
Company

THE FLYNN COMPANY

WWW.FLYNNCO.COM | 1621 WOOD STREET, PHILADELPHIA, PA 19103 | 215.561.6565

PROPERTY PHOTOS

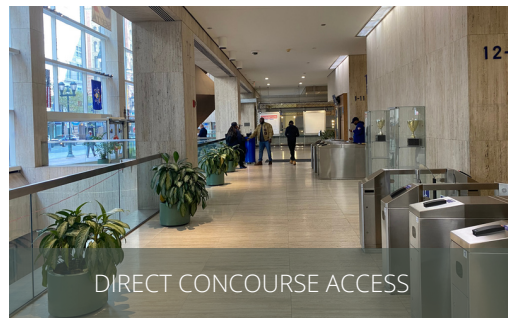
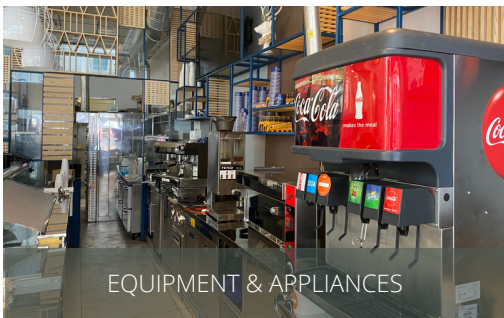
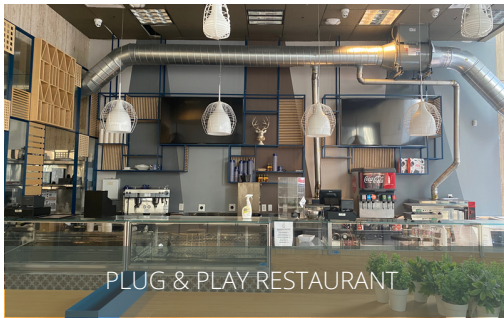

MAP



**For More Information
Please Contact:**

MICHAEL GALLAGHER
MGALLAGHER@FLYNNCO.COM
215-561-6565 X 151

JOSEPH NASELLI
JNASELLI@FLYNNCO.COM
215-561-6565 X 155

BRENDAN FLYNN
BFLYNN@FLYNNCO.COM
215-561-6565 X 152