

**FOR LEASE**

5501 Tabor Road  
Philadelphia, PA

Strategically located industrial facility  
available in Northeast Philadelphia

**Building Features:**

- **Available Space** ±16,800 SF
- **Loading** Grade level loading
- **Parking** Ample off-street parking on over one acre of paved/stoned land
- **High Visibility** Strategically visible across from the Northeast Tower Center
- **Easily Accessible** SEPTA Bus Route K and 26 stops within walking distance
- **Zoning** I-2 Limited Industrial

This document/email has been prepared by Colliers for advertising and general information only. Colliers makes no guarantees, representations or warranties of any kind, expressed or implied, regarding the information including, but not limited to, warranties of content, accuracy and reliability. Any interested party should undertake their own inquiries as to the accuracy of the information. Colliers excludes unequivocally all inferred or implied terms, conditions and warranties arising out of this document and excludes all liability for loss and damages arising there from. This publication is the copyrighted property of Colliers and /or its licensor(s). © 2024. All rights reserved. This communication is not intended to cause or induce breach of an existing listing agreement.

**Available:**

±16,800 SF  
±1 acre

**CONTACT US****Richard Gorodesky, SIOR**

Vice Chair  
+1 215 460 5857  
richard.gorodesky@colliers.com

**Adam Gorodesky, CCIM**

Vice President  
+1 215 873 1718  
adam.gorodesky@colliers.com

**Colliers**

2005 Market Street, Suite 4010  
Philadelphia, PA 19103  
+1 214 925 4600  
[www.colliers.com/philadelphia](http://www.colliers.com/philadelphia)

FOR LEASE

# 5501 Tabor Road

Floor Plan

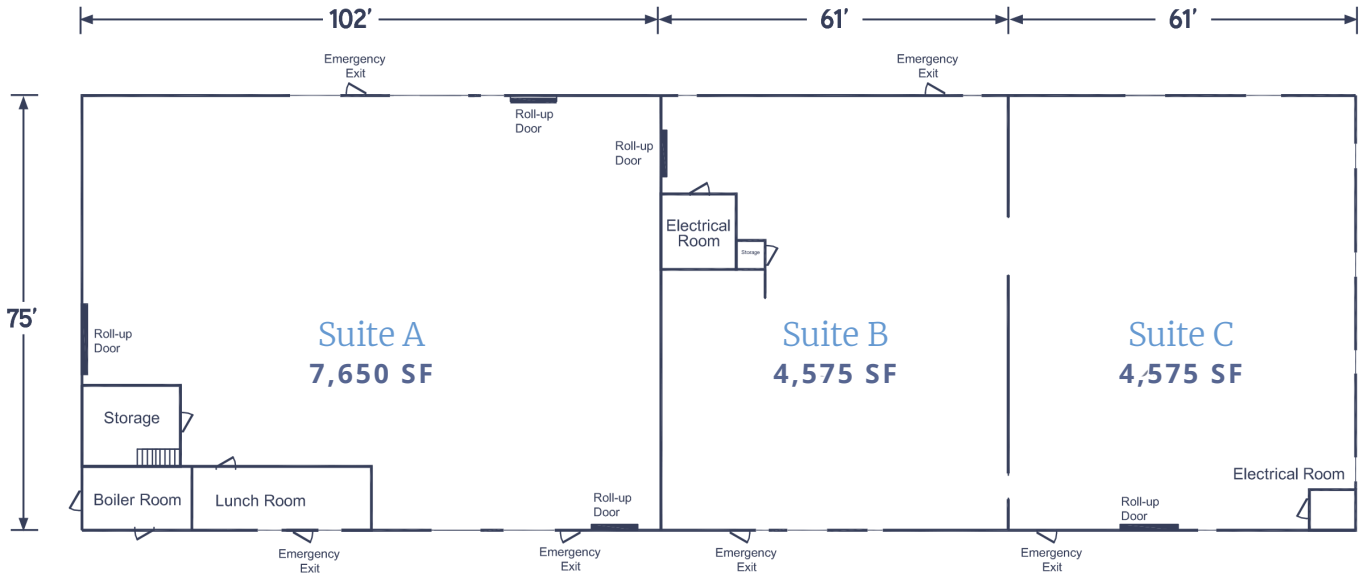

## CONTACT US

**Richard Gorodesky, SIOR**  
Vice Chair  
+1 215 460 5857  
richard.gorodesky@colliers.com

**Adam Gorodesky, CCIM**  
Vice President  
+1 215 873 1718  
adam.gorodesky@colliers.com

**Colliers**  
2005 Market Street, Suite 4010  
Philadelphia, PA 19103  
+1 214 925 4600  
www.colliers.com/philadelphia

