



FOR LEASE



14303 NE 63RD STREET

Available Industrial Space

± 15,000 – ± 40,447 SF Warehouse Development

14303 NE 63rd St, Vancouver, WA

- Cutting-edge warehouse development designed to unlock your business's potential
- Customize your workspace to perfectly suit your needs
- Signalized access to Fourth Plain Blvd via 143rd and 147th for seamless logistics

DANIEL SAYLES

Senior Associate Broker | Licensed in OR & WA
503-542-4351 | dsayles@capacitycommercial.com

MARK CHILDS, SIOR

Principal | Licensed in OR & WA
503-542-4350 | markc@capacitycommercial.com

DANIEL HELM, SIOR

Senior Vice President | Licensed in OR & WA
503-542-2899 | dhelm@capacitycommercial.com



PROPERTY SUMMARY

**FOR
LEASE**



PROPERTY DETAILS

Address	14303 NE 63rd St, Vancouver, WA
Total SF	15,000 – 40,447 SF
Office SF	1,129 SF - Planned
Construction	Concrete Tilt-Up
Dock Loading	4 - 8 Dock High (9' x 11')
Grade Loading	1 - 2 Grade Doors (12' x 14')
Clear Height	36'
Sprinklers	ESFR
Floor Thickness	7" Reinforced
Power	480v
Lighting	Motion-Sensing LED
Zoning	IL (Light Industrial)
Lease Rate	Call for Rates

Office Layout

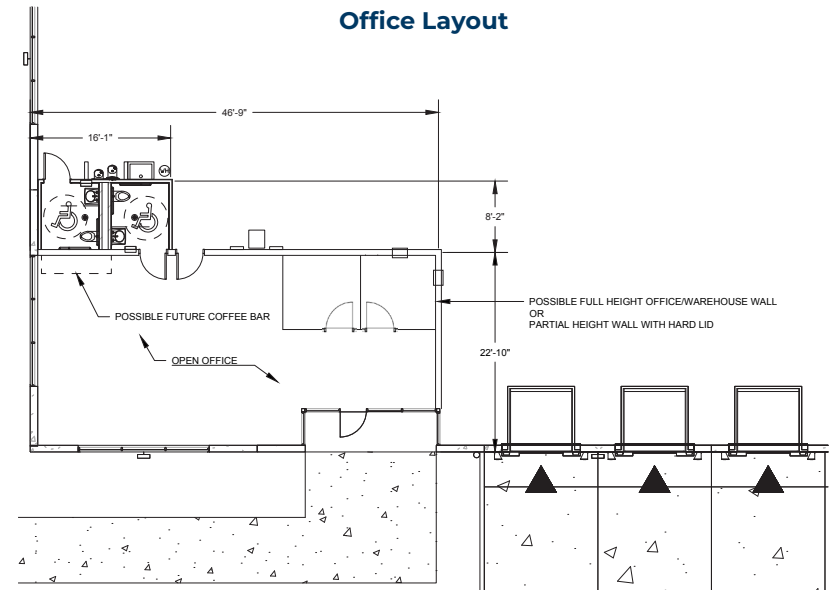
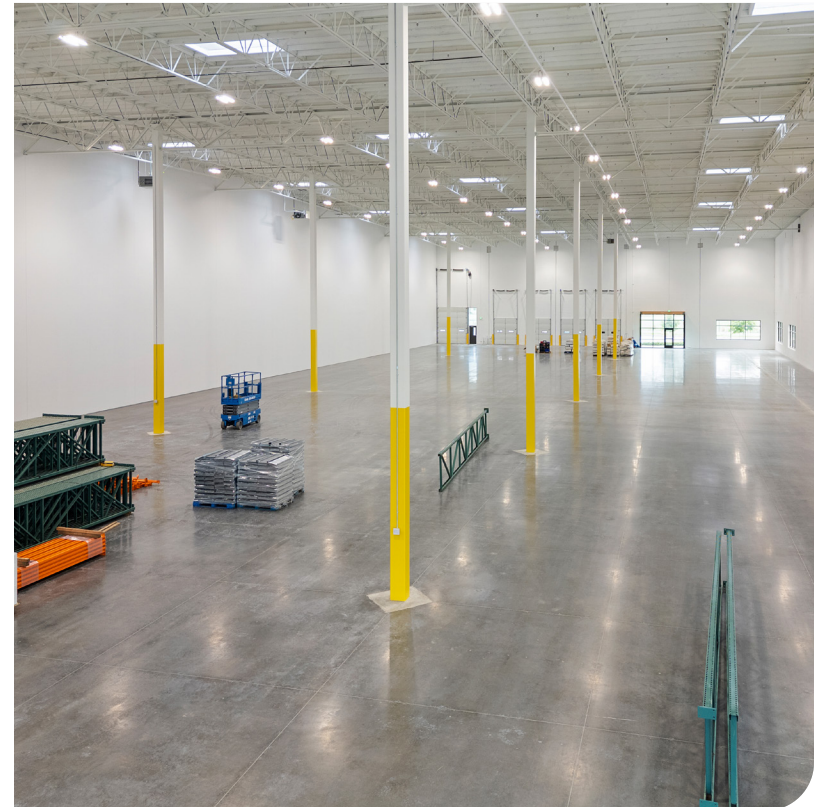

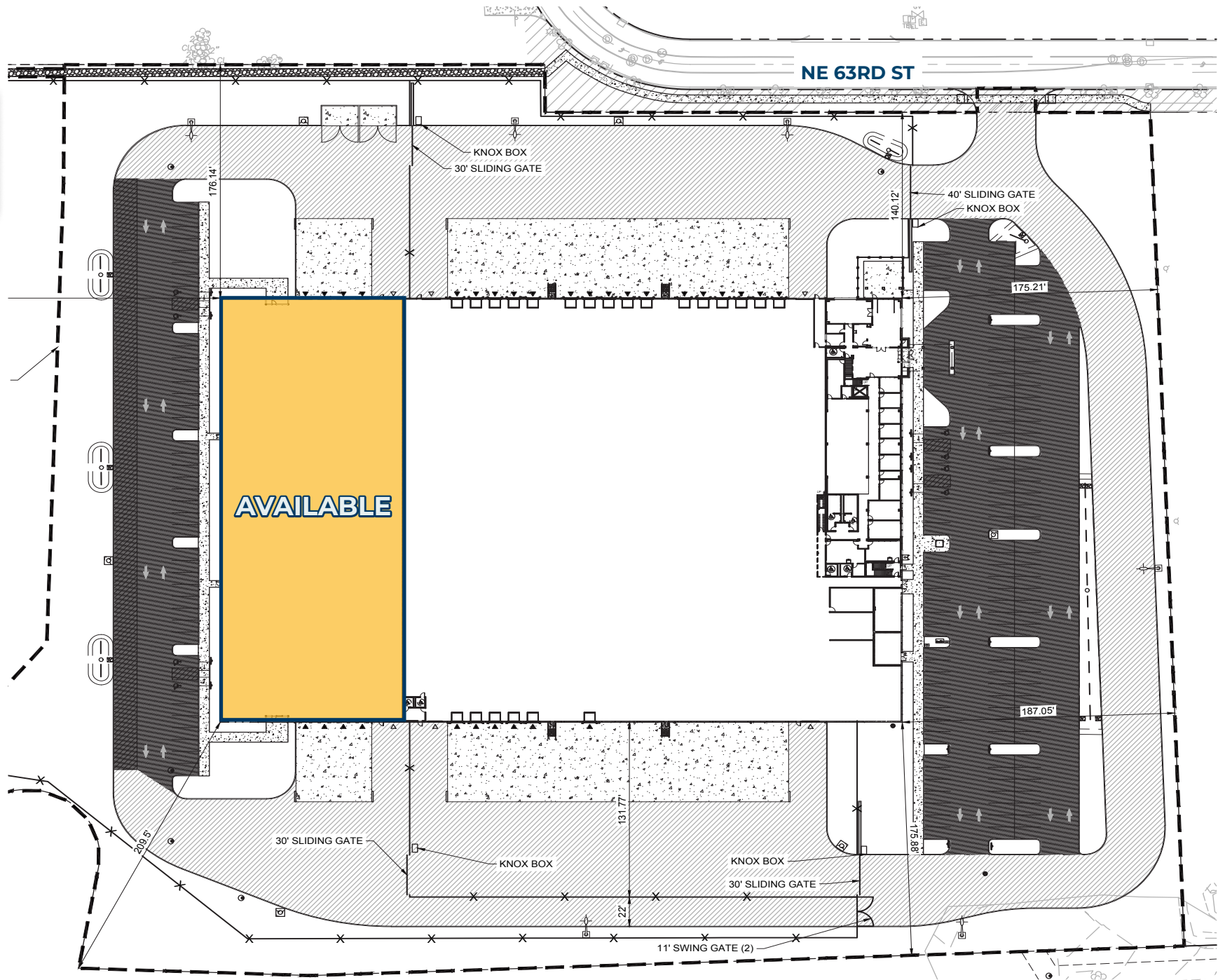

PHOTO LIBRARY





SITE / FLOOR PLAN





LOCATION MAP



The development property offers convenient highway and interstate access, your supply chain will operate smoothly and ensures seamless transportation for you and your customers.

Plus, you'll love the convenience of being just moments away from a diverse selection of restaurants and retailers in vibrant Vancouver, WA.

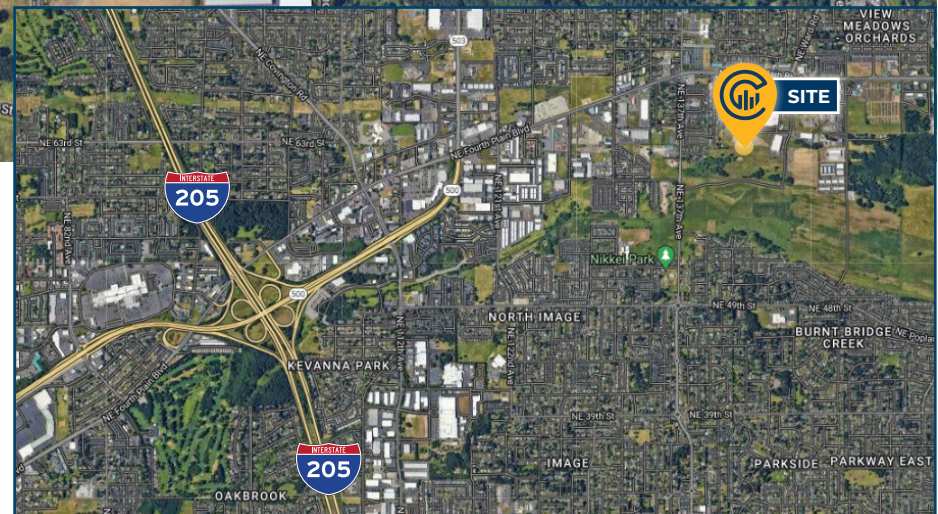

DANIEL SAYLES
Senior Associate Broker | Licensed in OR & WA
503-542-4351
dsayles@capacitycommercial.com

MARK CHILDS, SIOR
Principal | Licensed in OR & WA
503-542-4350
markc@capacitycommercial.com

DANIEL HELM, SIOR
Senior Vice President | Licensed in OR & WA
503-789-5750
dhelm@capacitycommercial.com