

Office | For Lease

CBRE

Truist Place

Class A Office Space

300 Summers Street
Charleston, West Virginia 25301



Class A Office Space

Central Business District Location

Charleston, West Virginia

- Competitive rental rate- \$23.50/SF
- Full service
- Onsite parking garage with ample visitor parking
- Downtown amenities (Restaurants, hotels & shopping)
- Banking facility on premise
- Easy access to I-64, I-77 and I-79
- Lobby Directory
- Onsite management and security

1976 253,950 15

Year Built

Building Square Feet

Stories Class A Office Space



Available Space

7th Floor: 3,721 RSF

8th Floor: 7,773 RSF

12th Floor: 8,093 RSF

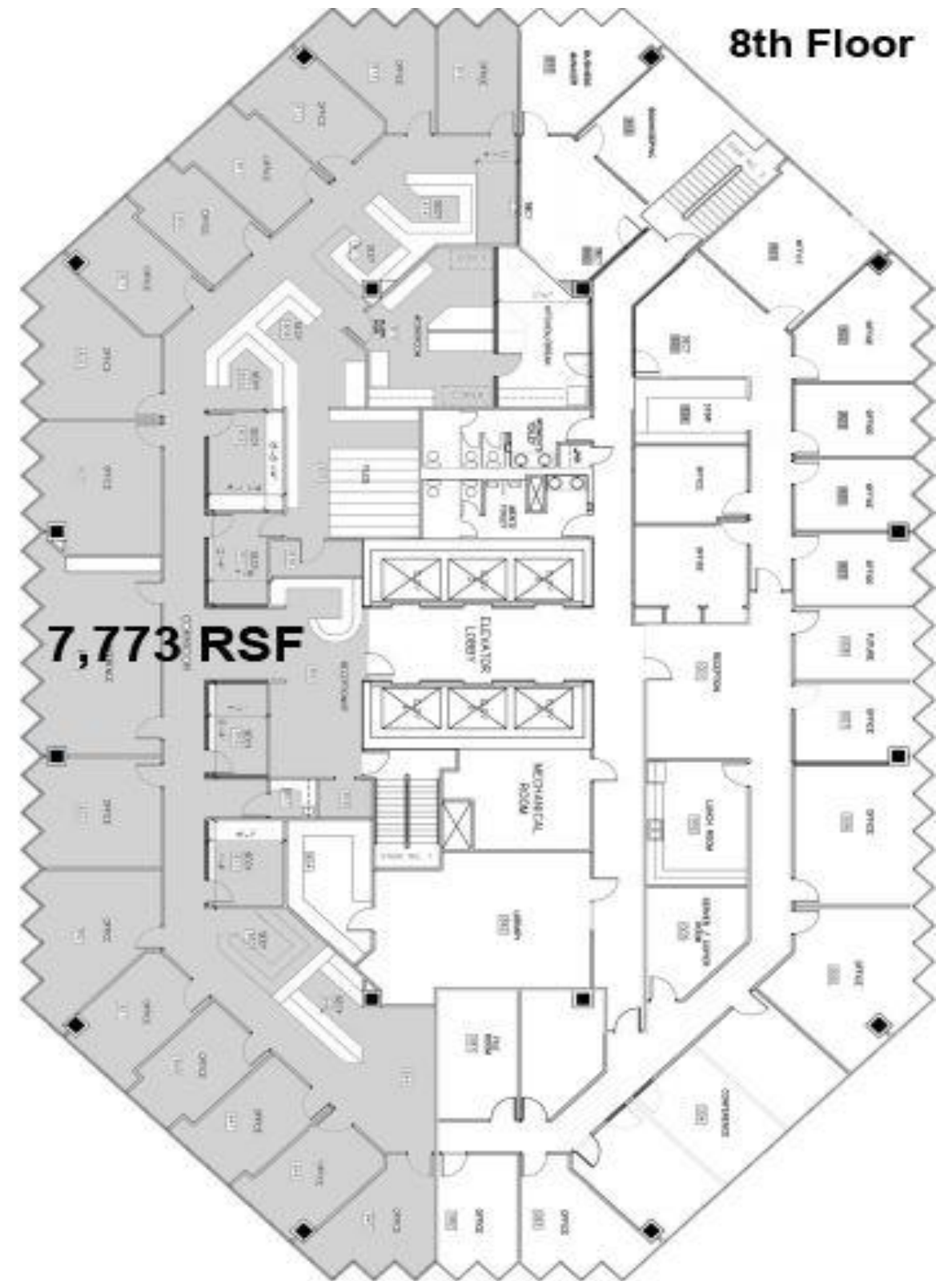
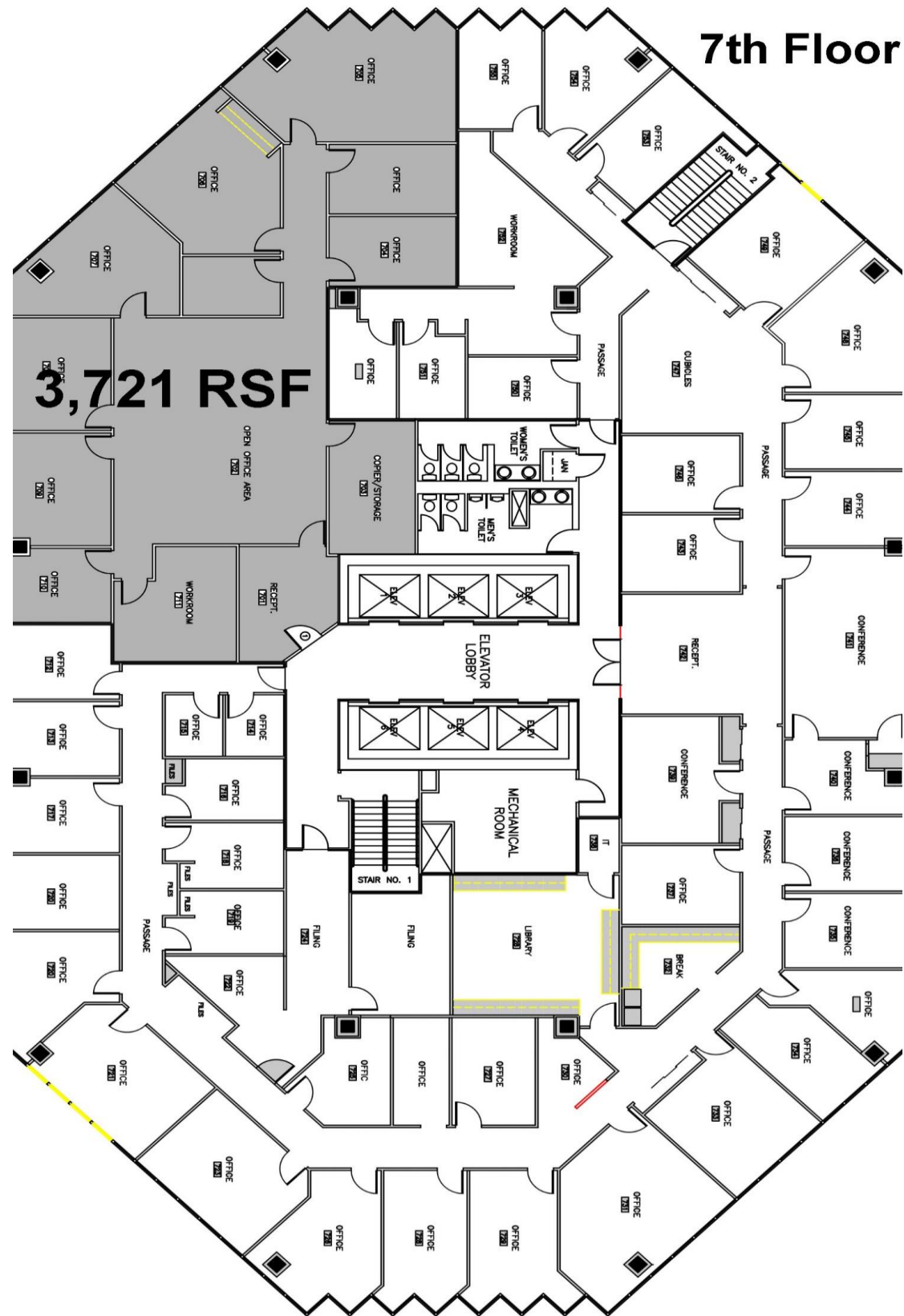

Available Space

7th Floor: 3,721 RSF

8th Floor: 7,773 RSF

12th Floor: 8,093 RSF

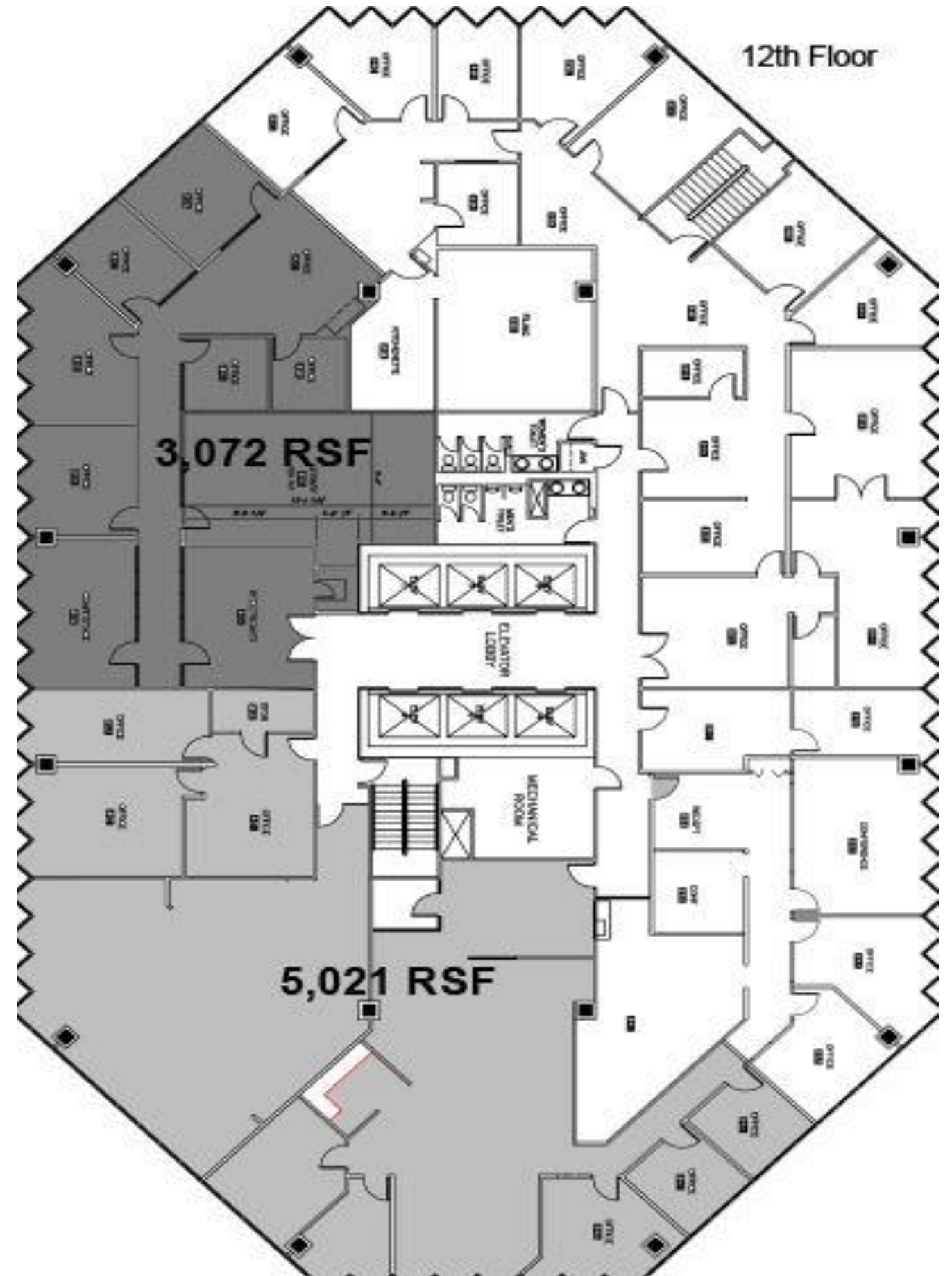
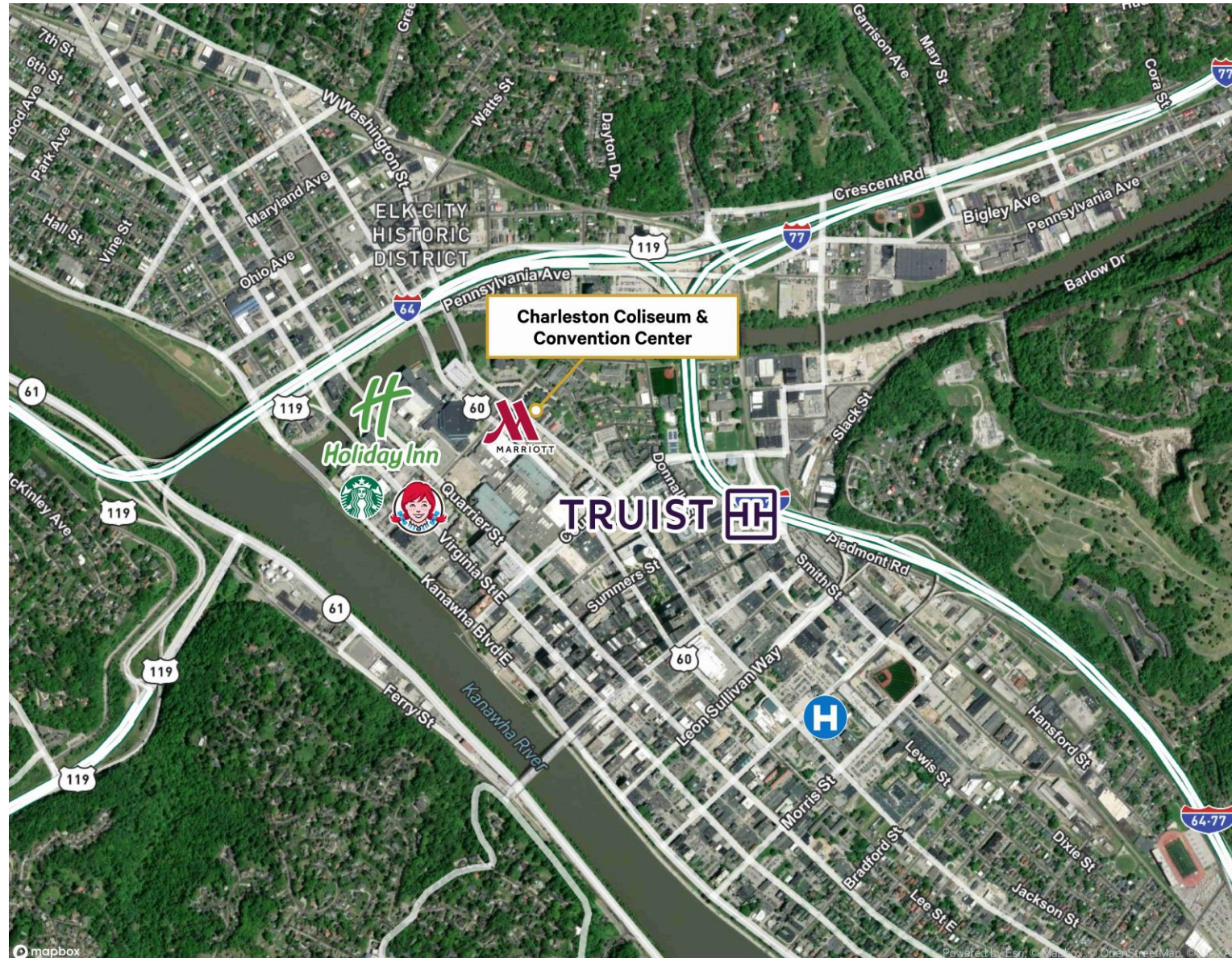

Truist Place

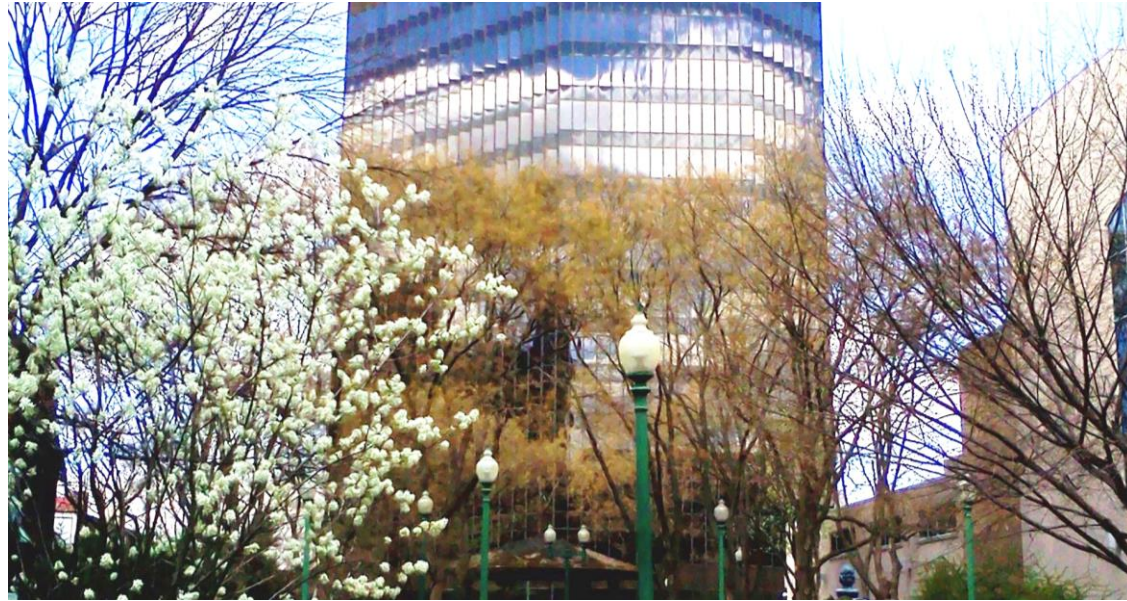

2024 Demographics	1 Mile	3 Miles	5 Miles
Population	6,166	43,649	63,558
Households	3,219	19,843	29,203
Average Household Income	\$66,245	\$92,792	\$93,647
Businesses	1,773	3,083	4,199

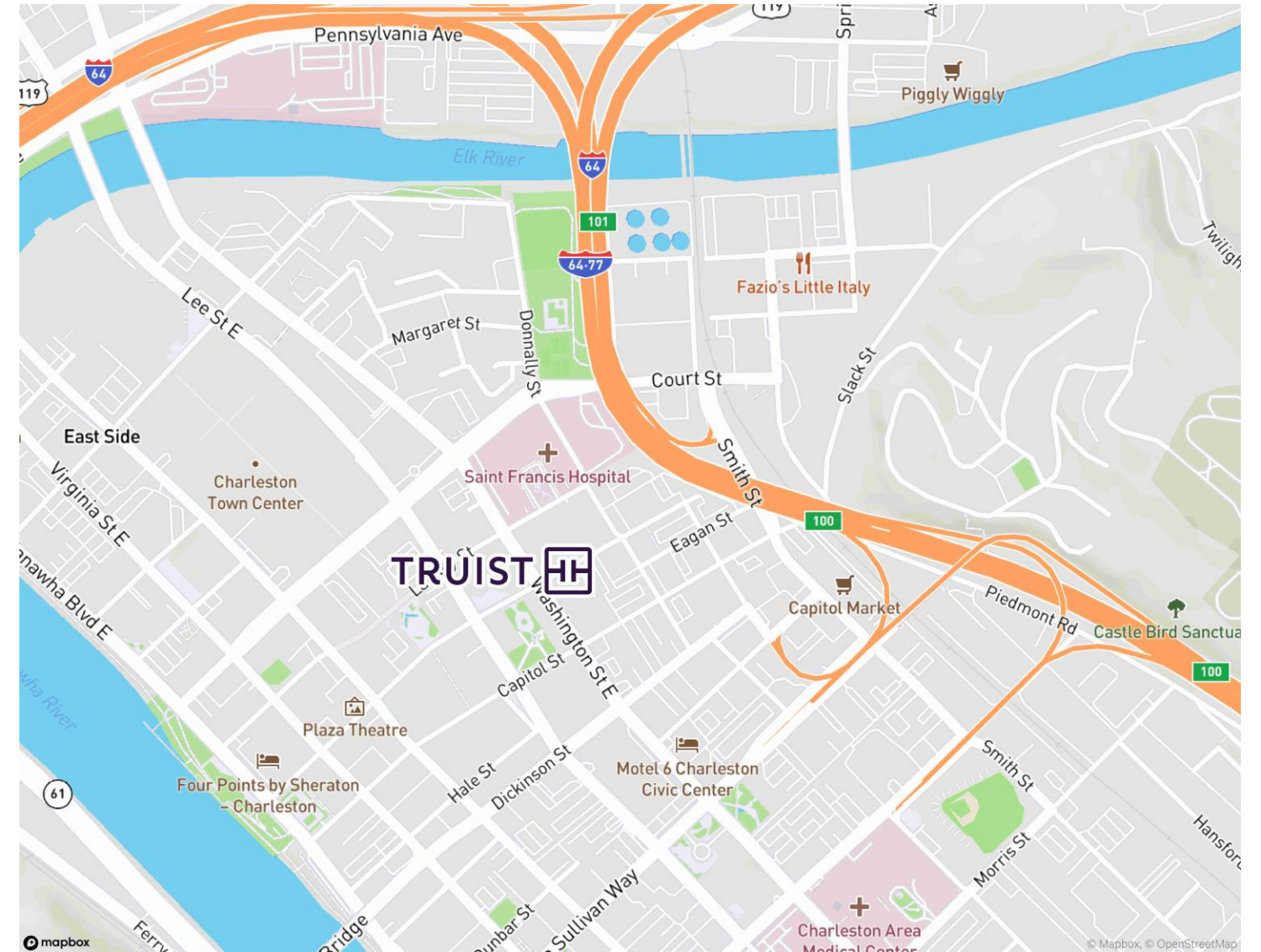

David Durbin
 Broker
 +1 304 720 8497
david.durbin@cbre.com
 707 Virginia Street East
 Charleston, WV 25301

© 2024 CBRE, Inc. All rights reserved. This information has been obtained from sources believed reliable, but has not been verified for accuracy or completeness. You should conduct a careful, independent investigation of the property and verify all information. Any reliance on this information is solely at your own risk. CBRE and the CBRE logo are service marks of CBRE, Inc. All other marks displayed on this document are the property of their respective owners, and the use of such logos does not imply any affiliation with or endorsement of CBRE. Photos herein are the property of their respective owners. Use of these images without the express written consent of the owner is prohibited.