

REDUCED PRICE!

DEVELOPMENT/INVESTMENT OPPORTUNITY

4930 DIXIE HIGHWAY

Fairfield, OH 45014

ASKING PRICE: \$950,000

PROPERTY HIGHLIGHTS

- 5,525 SF Building on 0.47 acres on Dixie Highway
- Full access, easy ingress/egress and ±30 parking spaces
- 2-curb cuts on Dixie Hwy & Donald
- Pylon and on-building signs available
- [Zoned C-3](#) Broad range of uses, including medical, auto service, retail, QSR or drive-thru. Auto Sales excluded.
- Population within a 3-mile radius: 63,122
- Traffic counts along Dixie Hwy: 32,617 VPD



Gary Fisher
gfisher@lee-associates.com
D 513.658.3411

All information furnished regarding property for sale, rental or financing is from sources deemed reliable, but no warranty or representation is made to the accuracy thereof and same is submitted to errors, omissions, change of price, rental or other conditions prior to sale, lease or financing or withdrawal without notice. No liability of any kind is to be imposed on the broker herein.

4930 DIXIE HIGHWAY | FAIRFIELD, OH

Interior Pictures



Site Plan

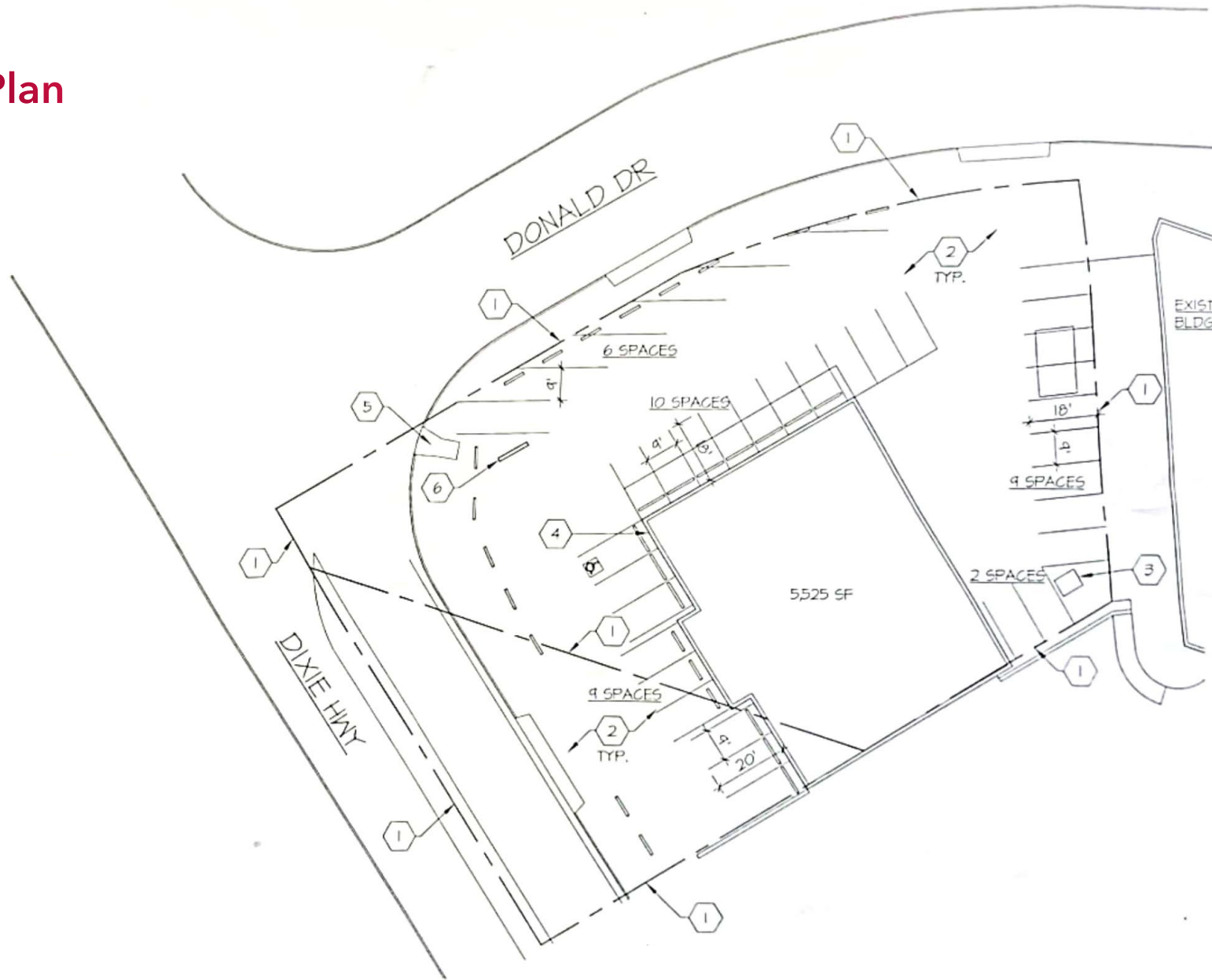

Floor Plan

Estimated Interior Dimensions

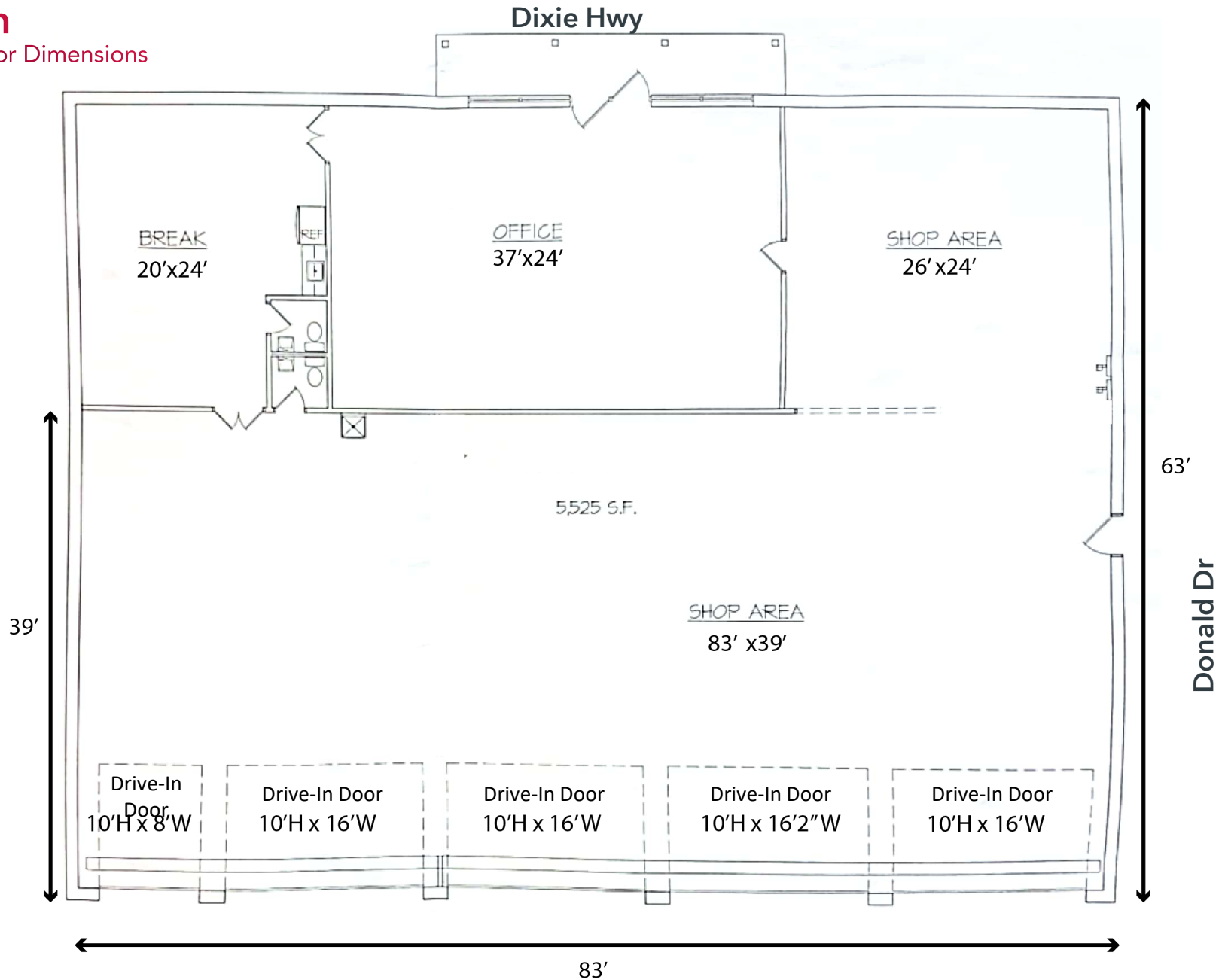

4930 DIXIE HIGHWAY | FAIRFIELD, OH

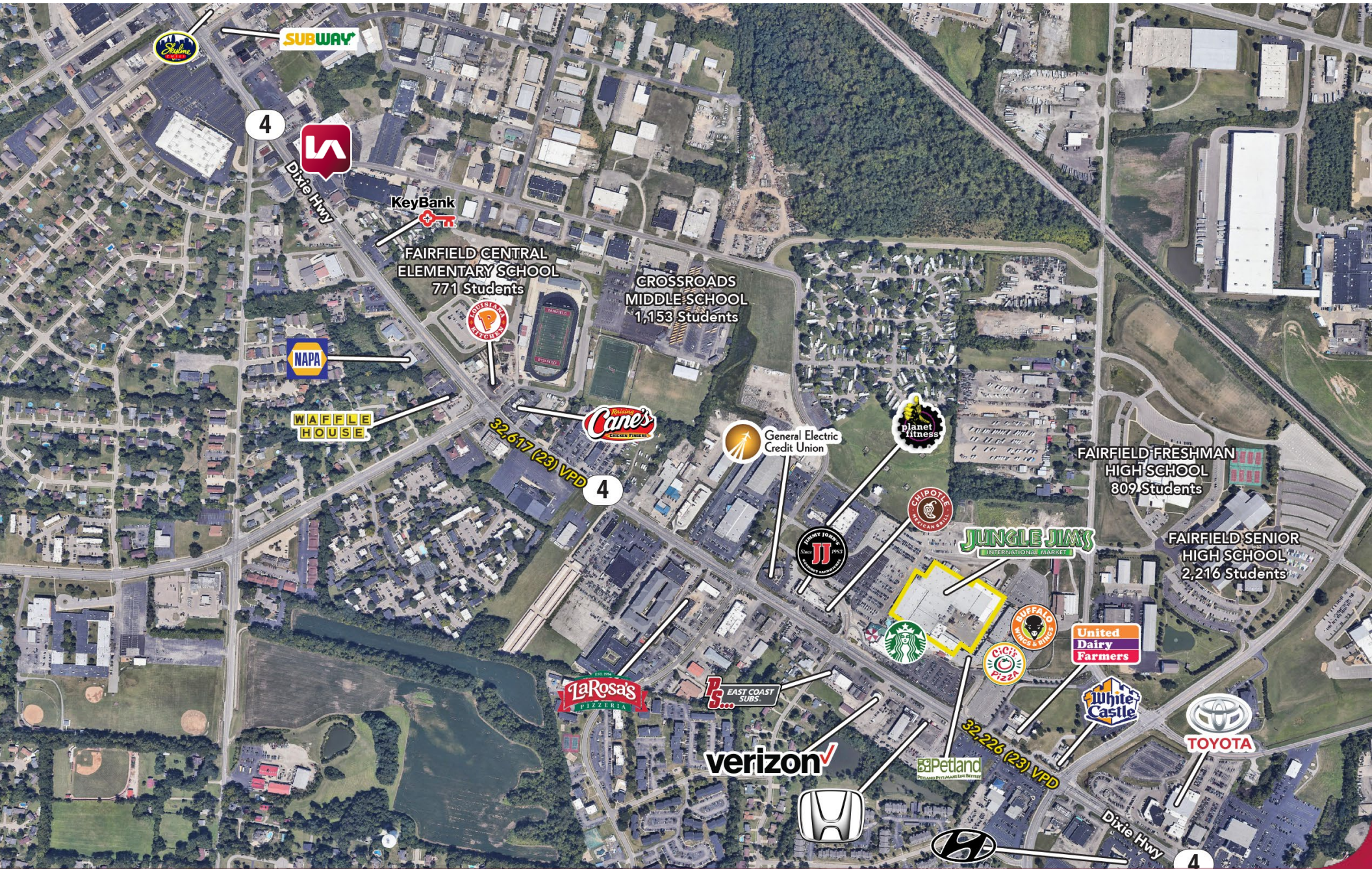

4930 DIXIE HIGHWAY | FAIRFIELD, OH

AREA DEMOGRAPHICS

| | 1 MILE | 3 MILES | 5 MILES |
|--|----------|----------|----------|
| POPULATION | | | |
| Estimated Population (2024) | 8,205 | 63,122 | 158,834 |
| Projected Population (2029) | 8,250 | 63,518 | 160,319 |
| Census Population (2020) | 8,220 | 63,534 | 159,063 |
| Census Population (2010) | 7,873 | 61,248 | 153,446 |
| HOUSEHOLDS | | | |
| Estimated Households (2024) | 3,386 | 25,786 | 62,141 |
| Projected Households (2029) | 3,462 | 26,364 | 63,510 |
| INCOME | | | |
| Estimated Average Household Income (2024) | \$81,579 | \$85,687 | \$92,217 |
| Estimated Median Household Income (2024) | \$68,862 | \$68,540 | \$74,856 |
| EDUCATION | | | |
| Any College (Some College or Higher) | 47.3% | 52.2% | 52.4% |
| College Degree + (Bachelor Degree or Higher) | 21.0% | 23.5% | 25.4% |
| DAYTIME DEMOGRAPHICS | | | |
| Total Businesses | 511 | 2,211 | 5,754 |
| Total Employees | 5,106 | 27,226 | 73,097 |

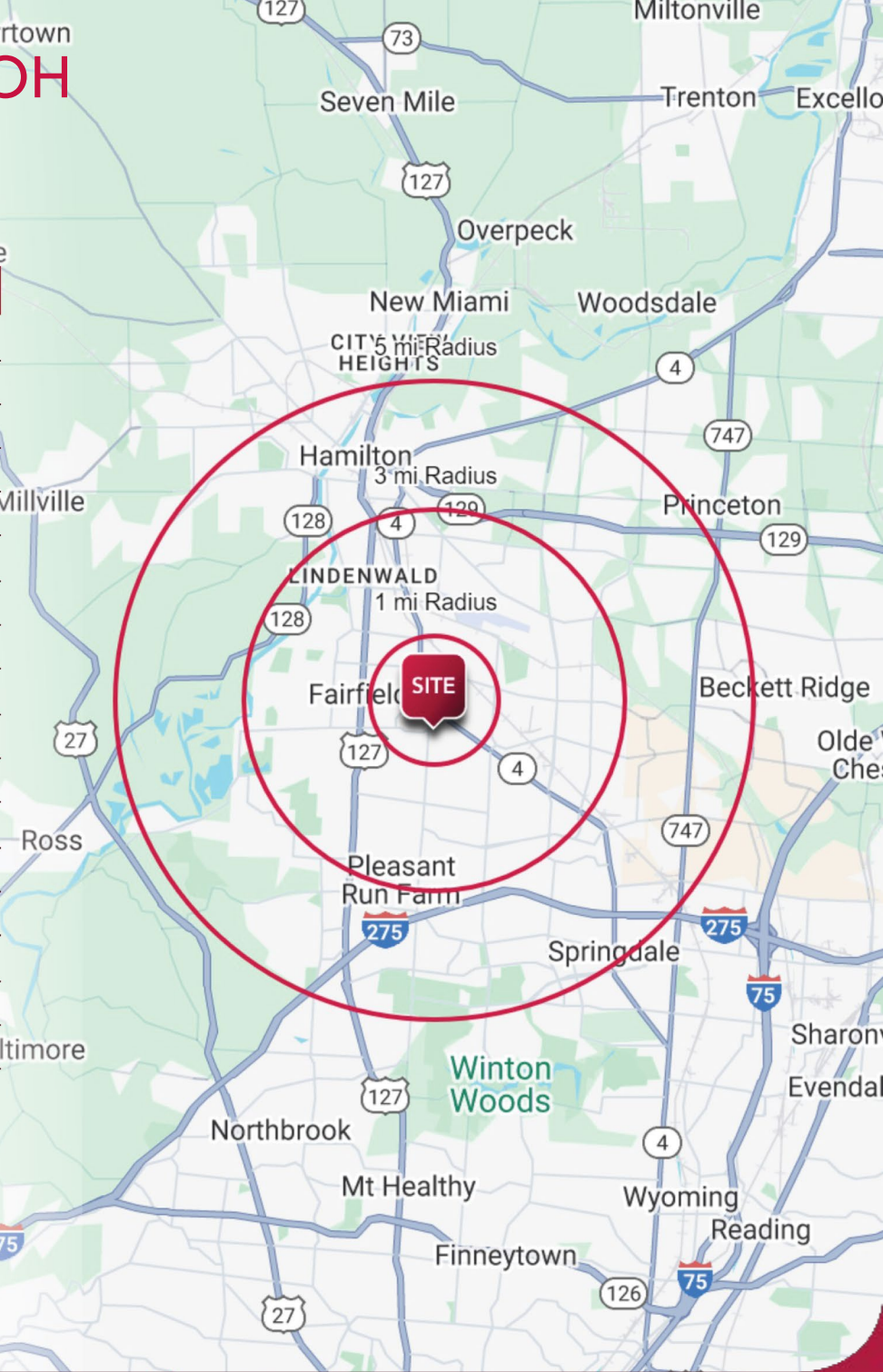

Gary Fisher
 gfisher@lee-associates.com
 D 513.658.3411