

FOR LEASE

RETAIL | OFFICE | DISTRIBUTION

SOUTHLAND TERRACE

3923 S. Seventh Street Road, Louisville, Kentucky



PROPERTY FEATURES

- + Up to 51,460± square feet available for retail, office or distribution space
- + Signalized entrance and ample parking
- + Centrally located with easy access to I-264 & Dixie Highway
- + Building & pylon signage available
- + Public transportation available
- + Wet sprinkler system
- + 14' clear height
- + 3 dock doors with levelers
 - (1) 8' x 8' door
 - (2) 8' x 10' doors
- + 2 roll up doors
- + 2 drive-in doors
 - (1) 5' x 7'
 - (1) 6' x 8'
- + Existing power 208V, 3,000 AMP



CONTACT US

ROBERT SCHWARTZ

Senior Vice President
+1 502 412 7606
robert.schwartz@cbre.com

CLAY HUNT

Senior Associate
+1 502 412 7607
clay.hunt@cbre.com

www.cbre.com/louisville

CBRE

FOR LEASE RETAIL | OFFICE | DISTRIBUTION SPACE

SOUTHLAND TERRACE
3923 S. SEVENTH STREET ROAD
Louisville, Kentucky



LABOR ANALYTICS - OFFICE SPACE

SHIVELY, KY

PROFILE: GEOSKILL - OFFICE
10.0 Mile Radius

97

TOTAL INDEX

Prepared for: -

Prepared by: Scott Gilmore



DEMOGRAPHICS

Key Metrics	Market	National
Population (vs. nat'l metro avg)	565,746	735,789
Labor Force (vs. nat'l metro avg)	292,070	372,838
Proj. Pop Growth	2.3%	4.2%
Unemployment (Monthly)	4.4%	3.7%
Median Household Income - USD	\$40,839	\$56,124
Proj. Income Growth	8.4%	10.6%
Cost of Living	94.9%	100.0%
% Population 21-34 (Millennials)	20.4%	19.3%
Median Home Value	\$ 127,581	\$ 207,344

MEDIAN WAGES BY MARKET (USD)



Job Title - Year of Experience	Market	National
A Accounts Payable and Receivable Clerk - 1 Year	\$30,260	\$32,233
B Administrative Assistant - 1 Year	\$33,977	\$36,319
C Bookkeeping Clerk - 1 Year	\$30,546	\$32,512
D Data Entry Operator - 1 Year	\$25,326	\$27,190
E File Clerk - 1 Year	\$25,136	\$27,027

EMPLOYMENT BY OCCUPATION

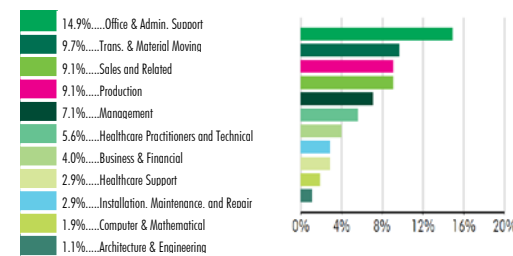

MARKET INDEXES

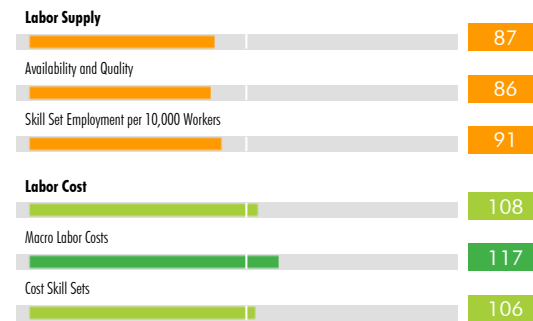

OPTIMAL BALANCE

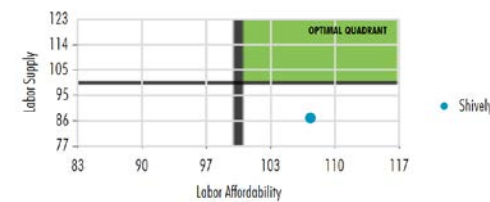

POST SECONDARY SCHOOLS

Post Secondary Schools	Type	Enrollment
Univ. of Louisville	4-Year Public University	21,561
Jefferson Community and Techn...	2-Year Community College	13,550
Indiana Univ.-Southeast	4-Year Public University	6,442
Sullivan Univ.	4-Year Private University	4,394
Bellarmine Univ.	4-Year Private University	3,609

2-Yr Colleges: 13 2-Yr Enrollment: 15,801 Total # of Colleges: 31
4-Yr Colleges: 18 4-Yr Enrollment: 45,214 Total Enrollment: 61,015

EDUCATIONAL ATTAINMENT

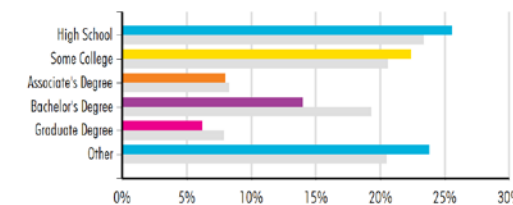

* National Average denoted in Gray



LABOR ANALYTICS - DISTRIBUTION SPACE

SHIVELY, KY

PROFILE: GEOSKILL - DISTRIBUTION
10.0 Mile Radius

114

TOTAL INDEX

Prepared for: -

Prepared by: Scott Gilmore



DEMOGRAPHICS

Key Metrics	Market	National
Population (vs. nat'l metro avg)	565,746	735,789
Labor Force (vs. nat'l metro avg)	292,070	372,838
Proj. Pop Growth	2.3%	4.2%
Unemployment (Monthly)	4.4%	3.7%
Median Household Income - USD	\$40,839	\$56,124
Proj. Income Growth	8.4%	10.6%
Cost of Living	94.9%	100.0%
% Population 21-34 (Millennials)	20.4%	19.3%
Median Home Value	\$ 127,581	\$ 207,344

MEDIAN WAGES BY MARKET (USD)

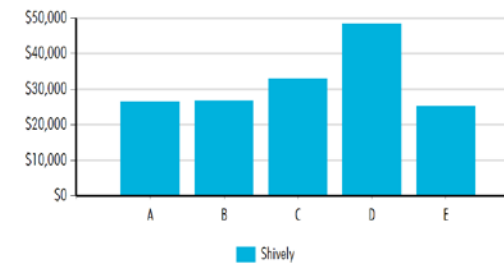

Job Title - Year of Experience	Market	National
A Forklift Operator - 1 Year	\$26,439	\$27,340
B Materials Handler - 1 Year	\$26,703	\$27,611
C Shipping and Receiving Clerk - 1 Year	\$32,952	\$34,711
D Warehouse Supervisor - 3 Year	\$48,406	\$49,844
E Warehouse Worker - 1 Year	\$25,263	\$26,107

EMPLOYMENT BY OCCUPATION

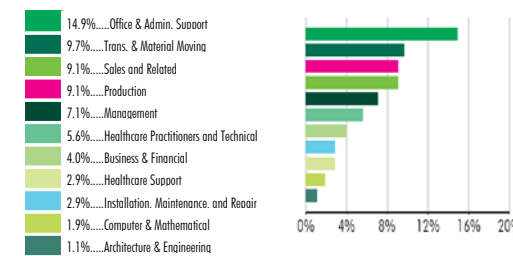

MARKET INDEXES

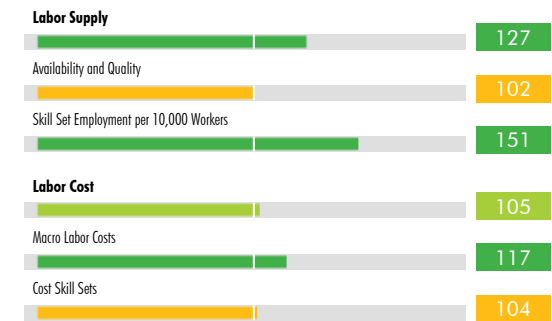

OPTIMAL BALANCE

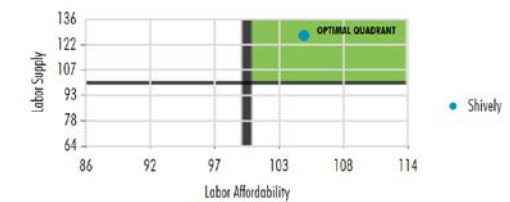

POST SECONDARY SCHOOLS

Post Secondary Schools	Type	Enrollment
Univ. of Louisville	4-Year Public University	21,561
Jefferson Community and Techn...	2-Year Community College	13,550
Indiana Univ.-Southeast	4-Year Public University	6,442
Sullivan Univ.	4-Year Private University	4,394
Bellarmine Univ.	4-Year Private University	3,609

2-Yr Colleges: 13 2-Yr Enrollment: 15,801 Total # of Colleges: 31
4-Yr Colleges: 18 4-Yr Enrollment: 45,214 Total Enrollment: 61,015

EDUCATIONAL ATTAINMENT

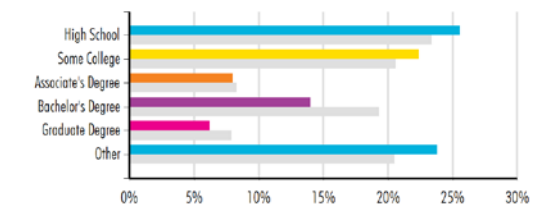

* National Average denoted in Gray

FOR LEASE
RETAIL | OFFICE | DISTRIBUTION SPACE

SOUTHLAND TERRACE
3923 S. SEVENTH STREET ROAD
Louisville, Kentucky

 **CONCEPTUAL SPACE LAYOUT ±25,000 SQUARE FEET**

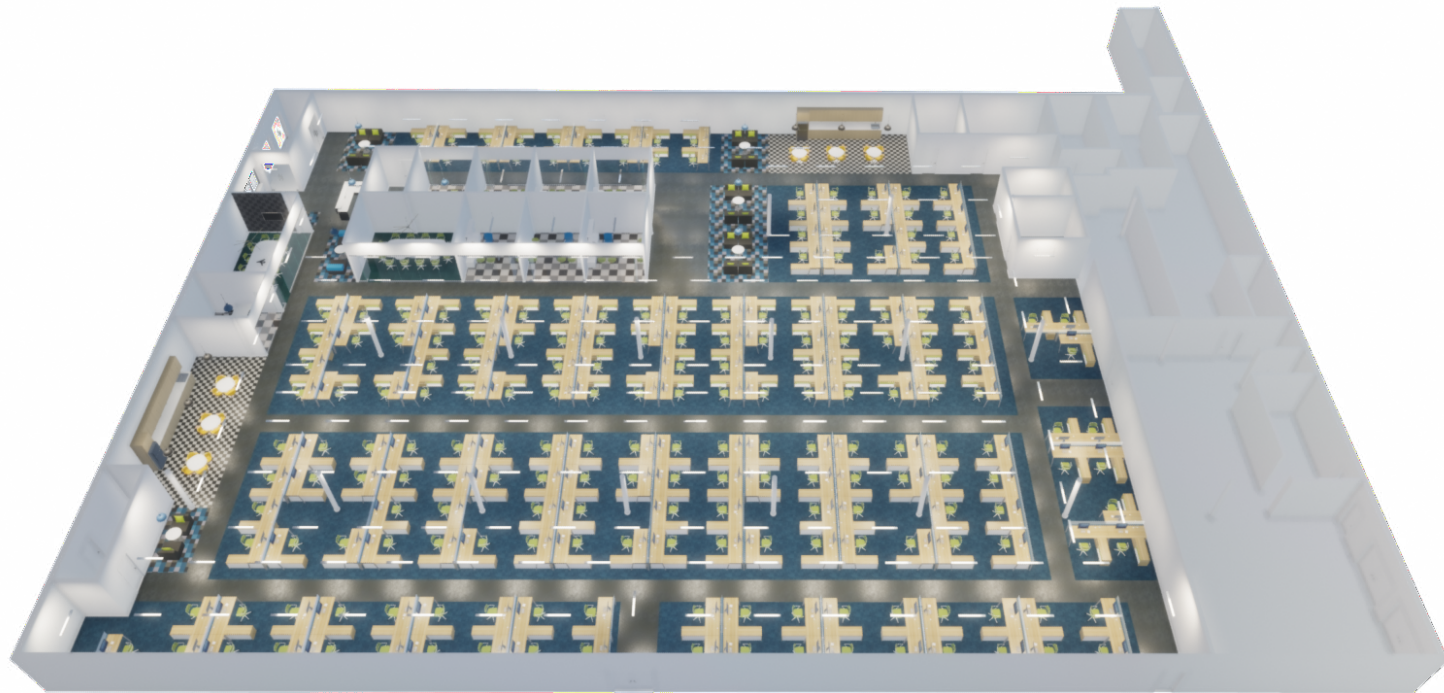
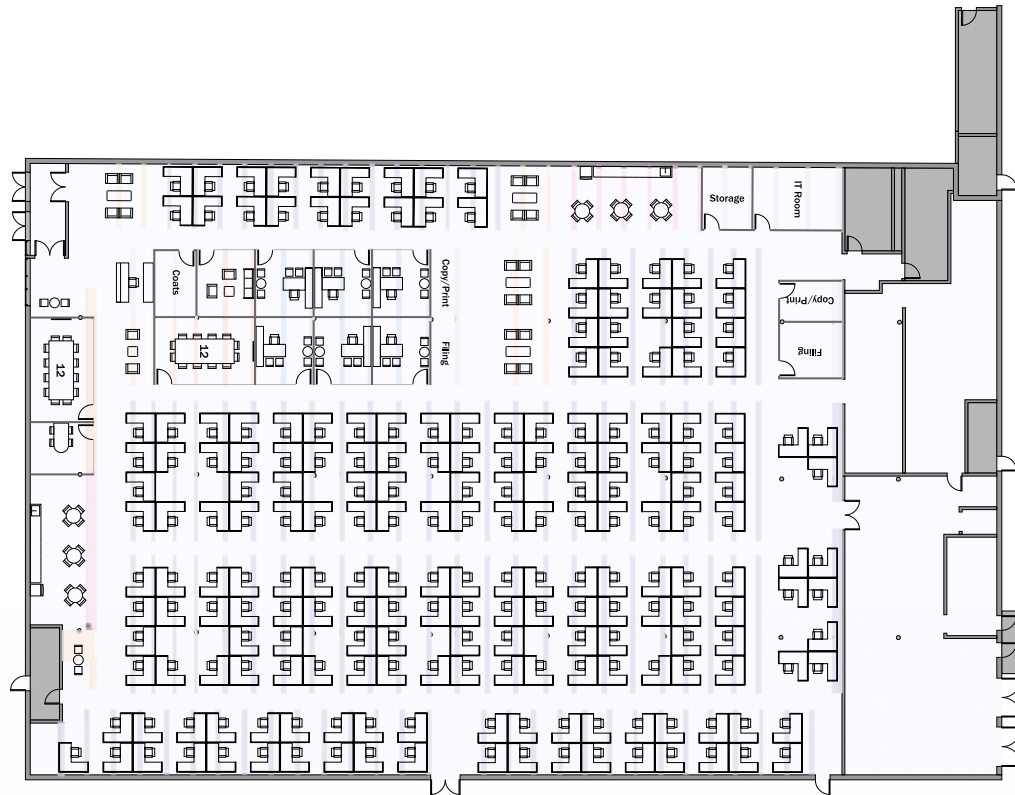

LAYOUT HEADCOUNT: **214** | MAX. OCCUPANCY: **250**

 **CONCEPTUAL SPACE LAYOUT ±51,460 SQUARE FEET**

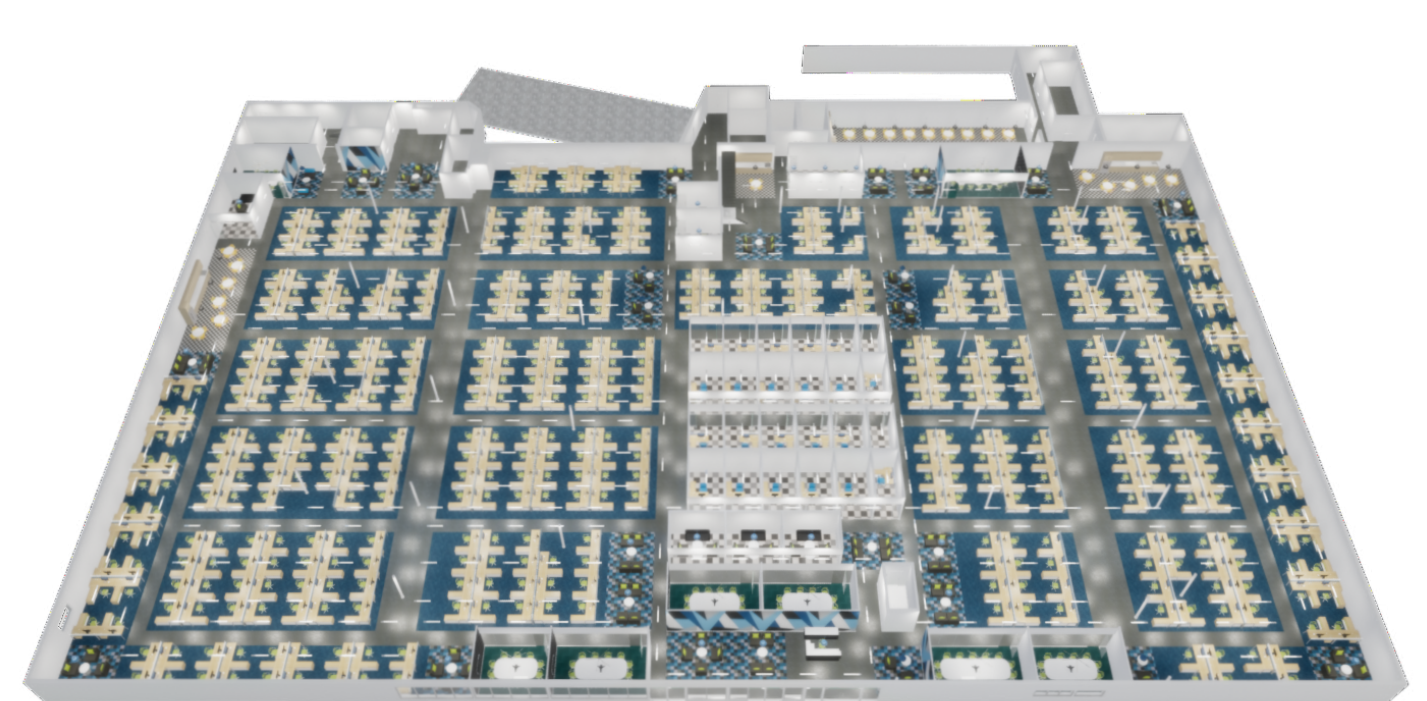
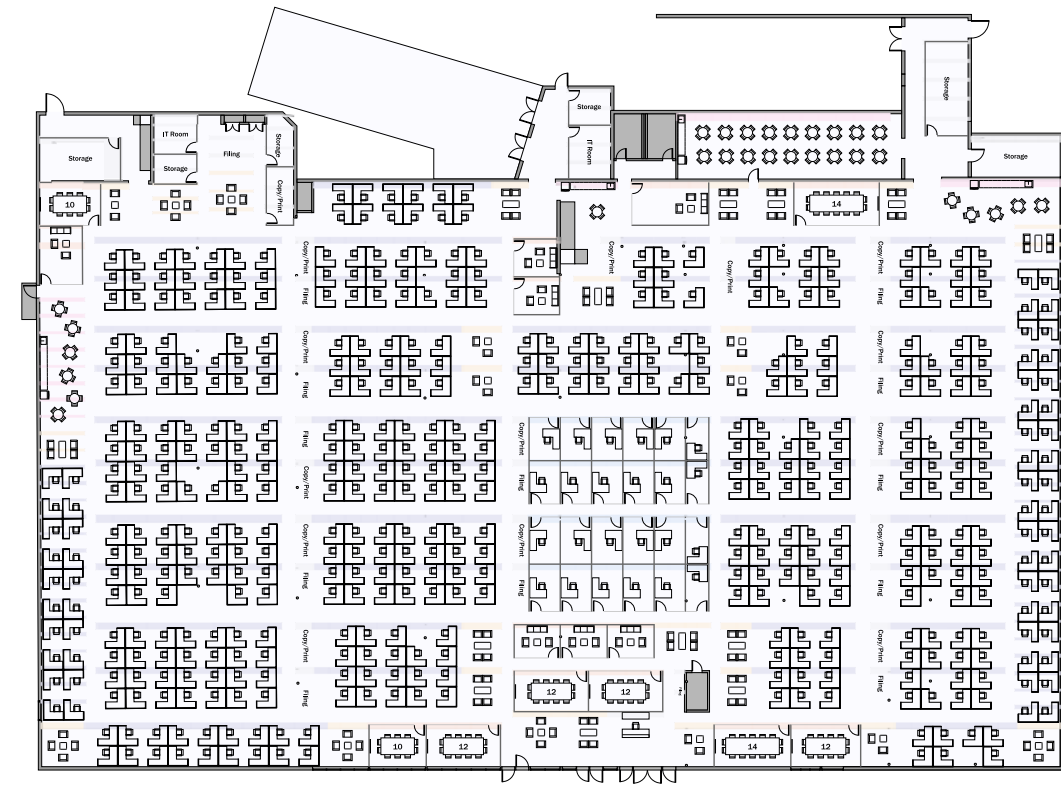

LAYOUT HEADCOUNT: **490** | MAX. OCCUPANCY: **514**

FOR LEASE
RETAIL | OFFICE | DISTRIBUTION SPACE

SOUTHLAND TERRACE
3923 S. SEVENTH STREET ROAD
Louisville, Kentucky

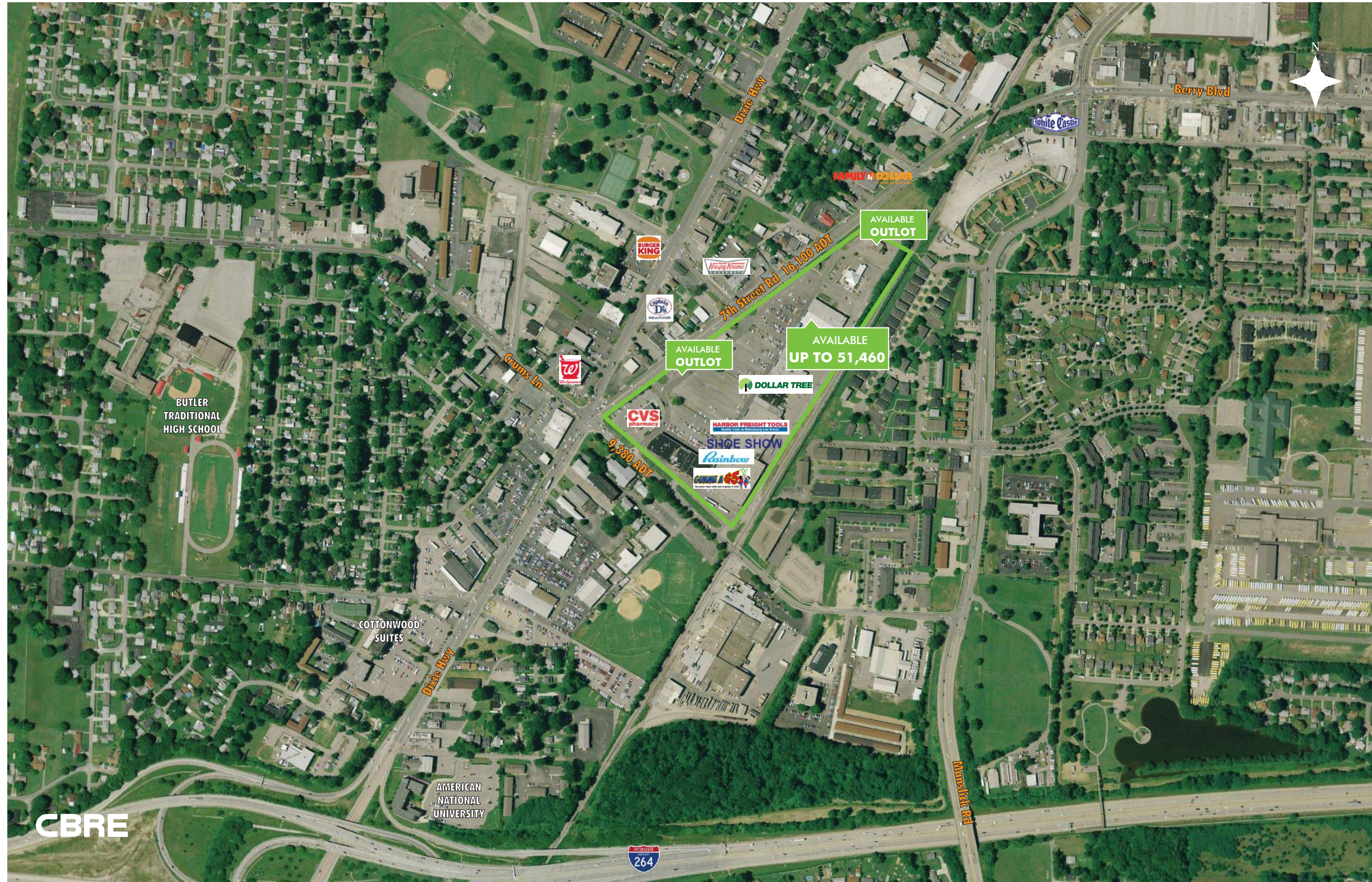

CBRE

FOR SALE OR LEASE PREMIER OFFICE SPACE

SOUTHLAND TERRACE
3923 S. SEVENTH STREET ROAD
Louisville, Kentucky



SITE PLAN



2018 ESTIMATED DEMOGRAPHICS

	1 Mile	3 Miles	5 Miles	10 Miles
Population	14,377	104,802	233,202	583,498
Average Household Income	\$43,634	\$48,893	\$50,354	\$60,379
Unemployed Population + 16	9.1%	8.6%	8.2%	6.0%

© 2019 CBRE, Inc. All rights reserved. This information has been obtained from sources believed reliable, but has not been verified for accuracy or completeness. You should conduct a careful, independent investigation of the property and verify all information. Any reliance on this information is solely at your own risk. CBRE and the CBRE logo are service marks of CBRE, Inc. All other marks displayed on this document are the property of their respective owners. Photos herein are the property of their respective owners. Use of these images without the express written consent of the owner is prohibited.