

22-04 31ST STREET, ASTORIA, NY 11105

FOR LEASE

2,500 SF PRIME RETAIL SPACE WITH MEZZANINE & BASEMENT

Between 31st Street & Ditmars Boulevard



SHLOMI BAGDADI
212.433.3355 x101
sb@tristatecr.com

RICHARD BABECK
212.433.3355 x119
richard.b@tristatecr.com

TRI STATE COMMERCIAL®

PROPERTY SUMMARY

LOCATION

Located in the Astoria neighborhood of Queens.

HIGHLIGHTS

- Many National Tenants on the Block

SPACE DETAILS

- Glass Retail Frontage on 31st Street
- Right Off the Corner of Ditmars Blvd and 31st Street
- Space Comes With Basement + Mezzanine

TRANSPORTATION

N W Trains at Astoria-Ditmars Boulevard

Q101 Q69 Bus Lines

NEIGHBORS

Krispy Kreme, TJ Maxx, Citi, T-Mobile, TacoBell, Target, TD Bank, Santander, Popeyes, Dunkin', Orangetheory, McDonald's, Starbucks, Charlie's Pub, Tesla, Mount Sinai Queens Medical Center, Western Union, Bank of America, Five Below, Burlington, Chase, Verizon, GreenHouse Farmers Market, The Last Word, Astoria Bank, Adega Wine & Spirits, Melt Dip, Van Leeuwen, CVS, UPS, IHOP, Northwell Health Chiropractic, Lincoln Market, Chicken Festival Astoria, Create and more!



PROPERTY PHOTOS



FLOOR PLANS

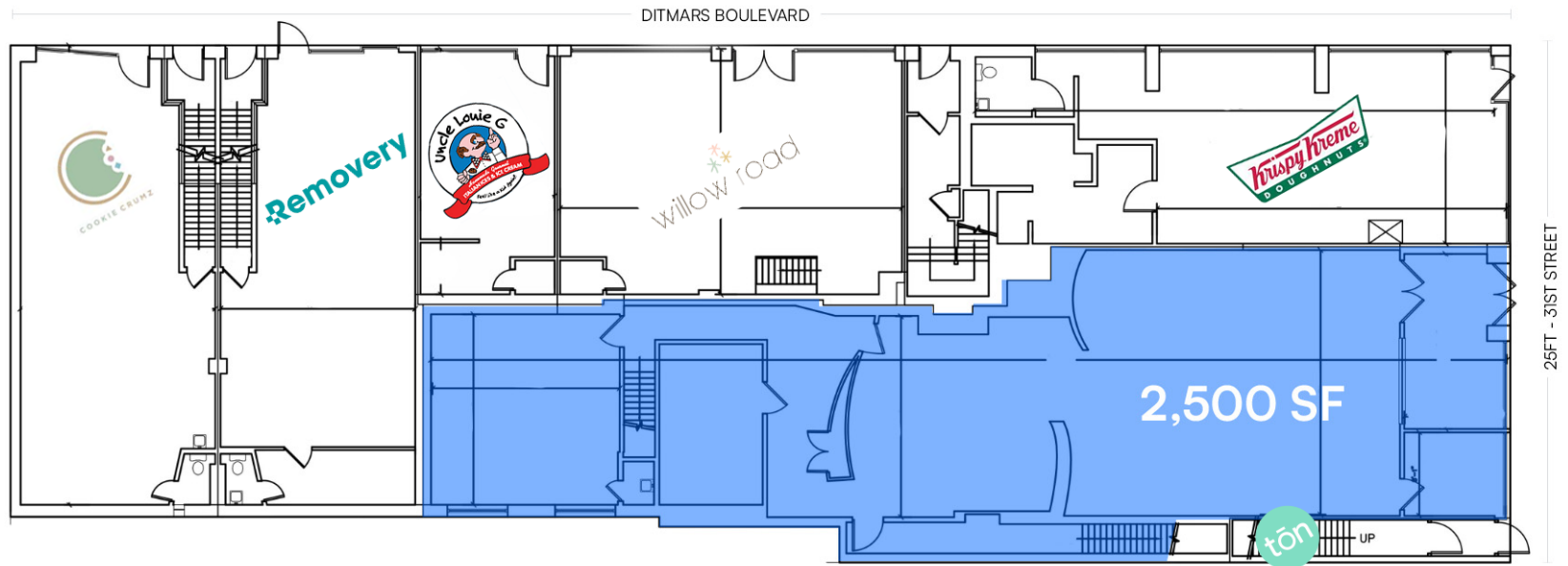

All square footages are approximate

RETAIL MAP



22-04 31ST STREET, ASTORIA, NY 11105

2,500 SF PRIME RETAIL SPACE WITH MEZZANINE & BASEMENT

Between 31st Street & Ditmars Boulevard

For Pricing Call: **212.433.3355**

SHLOMI BAGDADI
212.433.3355 x101
sb@tristatecr.com

RICHARD BABECK
212.433.3355 x119
richard.b@tristatecr.com

TSC.