

SALEM HEIGHTS

5440-5480 South Robert Trail

For Lease



WE ARE
THE CENTER
OF RETAIL



SALEM HEIGHTS

5440-5480 South Robert Trail

SPACE AVAILABLE

1,668 SF

LEASE RATE

Negotiable

OPERATING EXPENSES

CAM & Insurance:	\$5.82 psf
Real Estate Taxes:	\$3.21 psf
Total (2025):	\$9.03 psf

NEIGHBORING TENANTS

Park Dental, Fast Signs, Avis, Budget, Enterprise, Coratel Inn & Suites, Heartland Credit Union and MN Locks.

COMMENTS

- Vacancy just upgraded to a clean, vanilla shell
- Includes a newly created ADA bathroom
- Site is located at the top of the Robert Street ramp off I-494
- Access to retail hub to the north, and entrance to Inver Grove Heights to the south
- Great visibility including pylon signage on South Robert Trail

NEIGHBORHOOD DEMOGRAPHICS



	POPULATION	AVERAGE HOUSEHOLD INCOME	DAYTIME POPULATION
1 Mile	5,208	\$95,648	4,085
3 Miles	62,505	\$92,213	36,610
5 Miles	151,826	\$97,501	106,142



SITE PLAN

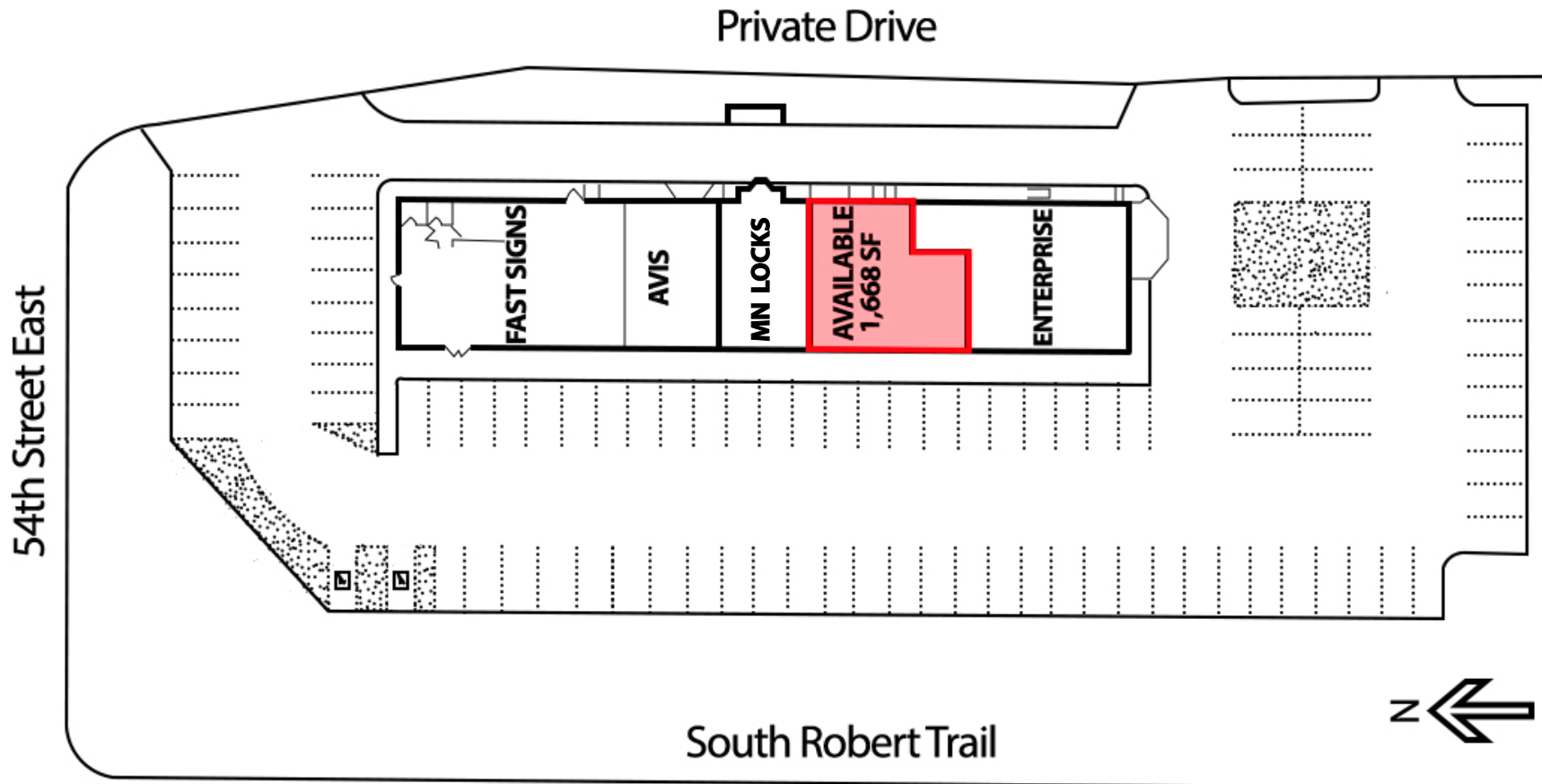

VACANCY PHOTOS



AERIAL



Deb Carlson / Director / deb.carlson@cushwake.com / +1 952 465 3370

Cushman & Wakefield Copyright 2024. No warranty or representation, express or implied, is made to the accuracy or completeness of the information contained herein, and same is submitted subject to errors, omissions, change of price, rental or other conditions, withdrawal without notice, and to any special listing conditions imposed by the property owner(s). As applicable, we make no representation as to the condition of the property (or properties) in question.

AERIAL



Deb Carlson / Director / deb.carlson@cushwake.com / +1 952 465 3370

Cushman & Wakefield Copyright 2024. No warranty or representation, express or implied, is made to the accuracy or completeness of the information contained herein, and same is submitted subject to errors, omissions, change of price, rental or other conditions, withdrawal without notice, and to any special listing conditions imposed by the property owner(s). As applicable, we make no representation as to the condition of the property (or properties) in question.