

**\$1.25 Gross  
1st 6 Months**

**Sublease**  
**±10,000 SF**  
**Industrial Unit**

**1515 E.**  
**McFadden Avenue**  
Santa Ana, CA



### Property Highlights

- ±10,000 SF sublease through May 31, 2029
- Available in 15 days
- ±876 SF office space
- 3 GL doors
- 2 DH loading positions (shared)
- 16' 6" clear height
- 800 amps, 277/480 volts
- Las Palmas Business Park is Santa Ana's premier industrial park featuring 48 units ranging in size from 2,500- 15,640 SF
- The park offers wide drive aisles, 5 access points, a safe and friendly business environment with on-site security services
- Located near the 5 and 55 Freeway interchange

**NEWMARK**

# 1515 E.

## McFadden Avenue

Santa Ana, CA

±10,000 SF Sublease



2 DH Loading Positions  
(Shared)

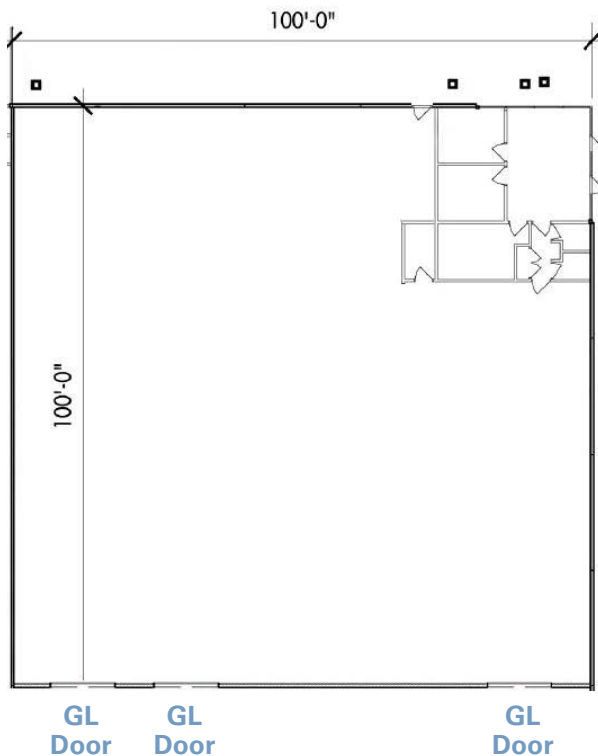

**Troy Wooton**  
Senior Managing Director  
t 949-608-2020  
troy.wooton@nrmk.com  
CA RE Lic. #01377431



**Zac Fielder**  
Director  
t 949-608-2121  
zac.fielder@nrmk.com  
CA RE Lic. #01989549

CORPORATE LICENSE #01355491

The distributor of this communication is performing acts for which a real estate license is required. The information contained herein has been obtained from sources deemed reliable but has not been verified and no guarantee, warranty or representation, either express or implied, is made with respect to such information. Terms of sale or lease and availability are subject to change or withdrawal without notice.