

FOR SALE

Retail | Office | Distribution



1045 N Main Street
Rocky Mount VA
77,550 SF | 9 AC
\$3,640,000

This versatile building offers 24,000 square feet of tall ceiling warehouse with dock and drive in doors. In addition there is another 16,000 square feet of warehouse | production space. 7,600 square feet of open retail space with adjoining storage as well as administrative offices with training rooms and large employee break area.



Henry Scholz

Cell: 540.353.0100

HScholz@mkbrealtors.com

MKB, REALTORS
3801 Electric Road
Roanoke, Virginia 24018
Office: 540.989.4556

Licensed in the Commonwealth
of Virginia

MKBcommercial.com





24,000 SF Tall Ceiling Warehouse



Fully Conditioned Space



2 Front Dock Doors with Levelers + 1 Drive-In Door



Additional Rear Warehouse Area



2 Rear Dock Doors



16,000 SF Production | Storage



View Our Virtual Tour

<https://digitalprecisionphotography.hd.pics/1045-N->



Administrative Offices



Employee Break Room



Training Room



Training Room



Retail Area



Retail Area

Side Drive Through Entrance

Retail Entrance

Administration Entrance

Dock Door 8'

Dock Door 8'

11'4" Ceiling Height

21'9" Eave & 23'7" Center

Dock Door 8'w x 10'h

Dock Door 8'w x 10'h

Drive-In Door 14'w x 12'h

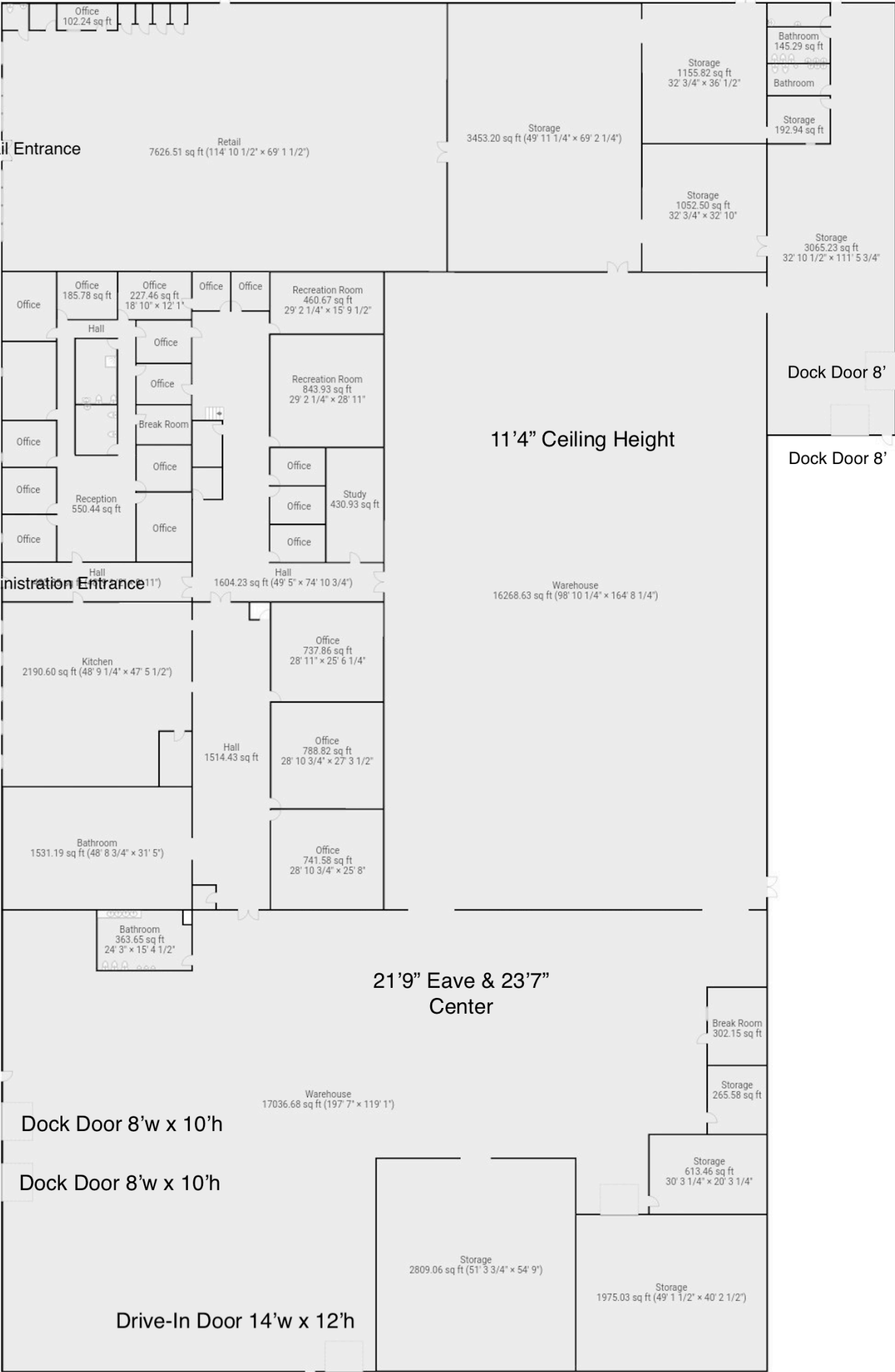

Assessed For Tax Purposes at \$3,211,800

Constructed in 1985 | Major Renovations by Current Owner

M1 Zoning in the Town of Rocky Mount allows for a number of different uses

Fully Conditioned Building

Fully Sprinkled Building

Close Proximity to US 220 for Access to Markets North and South

9.37 Acres with Extensive Parking or Lay-down Area

3 Separate Entrances for Retail | Administrative | Warehouse

4 Dock Height Doors + 1 Drive-In Door

