

NOW LEASING

Preferred
Real Estate Partners



**2402-2404
MAIN ST**

Waller, TX 77484



FLOOR PLAN

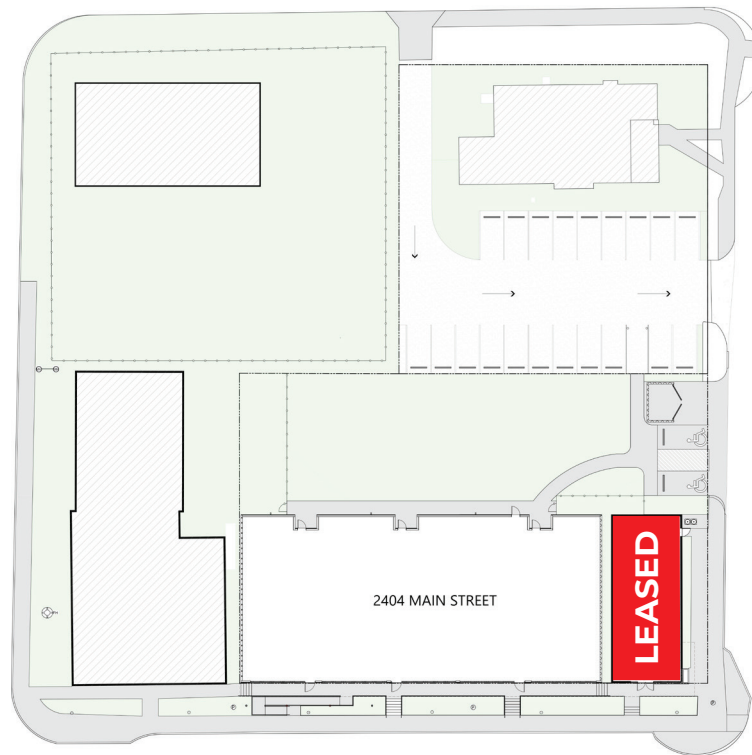

LEASE INFORMATION

Type: NNN

Term: 36 months min.

SUITE

SIZE

DESCRIPTION

Building Floor	+/- 8,140 SF	As is, Buid-out to request
2402 Main	LEASED	As is, Buid-out to request

DISCLAIMER: These numbers reflect what is currently available for lease and do not describe the total square footage



PROPERTY HIGHLIGHTS

Central Location

Easy access to U.S. 290

High traffic area

OFFERING SUMMARY Call for pricing



CONTACT US

Head Office

31406 Farm to Market 2920 Suite B201,
Waller, TX 77484

936-213-9481

Moreinfo@Preferred-Realty.com

Inquiries

For any inquiries, questions
or recommendations,
please call: 936-231-9481

2402-2404
MAIN ST

Preferred
Real Estate Partners