

# INDUSTRIAL FOR LEASE

3280 EDWARD AVE, UNIT E, SANTA CLARA, CA

*Call Agent to Show*

## *Property Highlights*

±6,048 SF available

±800 SF of HVAC office area

Two (2) grade level doors

200 Amps at 120/208 Volts (tenant to verify)

HVAC in warehouse area

Asking Rate: \$1.50 IG + \$0.15 CAM

**STEVE ZAMUDIO, CCIM**

408.888.7529

steve.zamudio@kidder.com

LIC N° 00905956

**KIDDER.COM**

This information supplied herein is from sources we deem reliable. It is provided without any representation, warranty, or guarantee, expressed or implied as to its accuracy. Prospective Buyer or Tenant should conduct an independent investigation and verification of all matters deemed to be material, including, but not limited to, statements of income and expenses. Consult your attorney, accountant, or other professional advisor.



## FLOOR PLAN

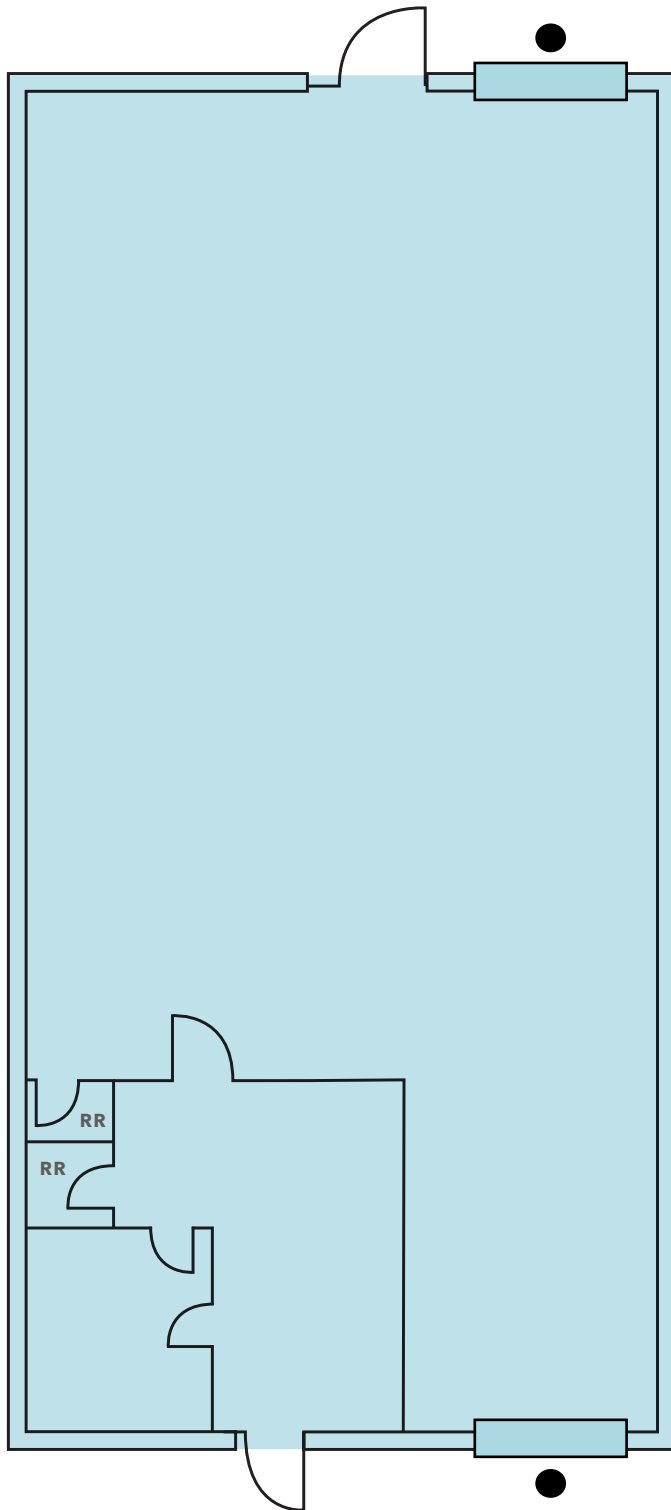

***±6,048 SF***

UNIT E

***\$1.50 IG***

ASKING RATE (PSF/MO)

***\$0.15***

CAM CHARGES

● Grade Level Door

FLOOR PLAN NOT TO SCALE

STEVE ZAMUDIO, CCIM

408.888.7529

steve.zamudio@kidder.com

LIC N° 00905956

KIDDER.COM

This information supplied herein is from sources we deem reliable. It is provided without any representation, warranty, or guarantee, expressed or implied as to its accuracy. Prospective Buyer or Tenant should conduct an independent investigation and verification of all matters deemed to be material, including, but not limited to, statements of income and expenses. Consult your attorney, accountant, or other professional advisor.



SITE PLAN

