

# 3300 Jet Cove

Memphis, TN

## Key Facts

Property type	Industrial space
---------------	------------------

Building size	353,500 SF
---------------	------------

Space available	224,965 SF
-----------------	------------



## Contact Us

Learn more about this property or schedule a tour by reaching out to our local investment and leasing officer.

**Bobby Daush**

+1 (901) 355-0460

[bobby.daush@eqtpartners.com](mailto:bobby.daush@eqtpartners.com)

# 3300 Jet Cove

Memphis, TN

## SITE PLAN



## Contact Us

Learn more about this property or schedule a tour by reaching out to our local investment and leasing officer.

**Bobby Daush**

+1 (901) 355-0460

[bobby.daush@eqtpartners.com](mailto:bobby.daush@eqtpartners.com)

# 3300 Jet Cove

Memphis, TN

## BUILDING SPECIFICATIONS - SUITE 101

---

Building Space Available: 95,475 SF

---

---

Approx. 10,000 SF office space

---

---

25 dock doors

---

---

1 drive-in doors

---

---

T8 fluorescent lighting

---

---

37 car parking spaces

---

---

Adjacent, fenced lot for 50 additional trailer parking spaces

---

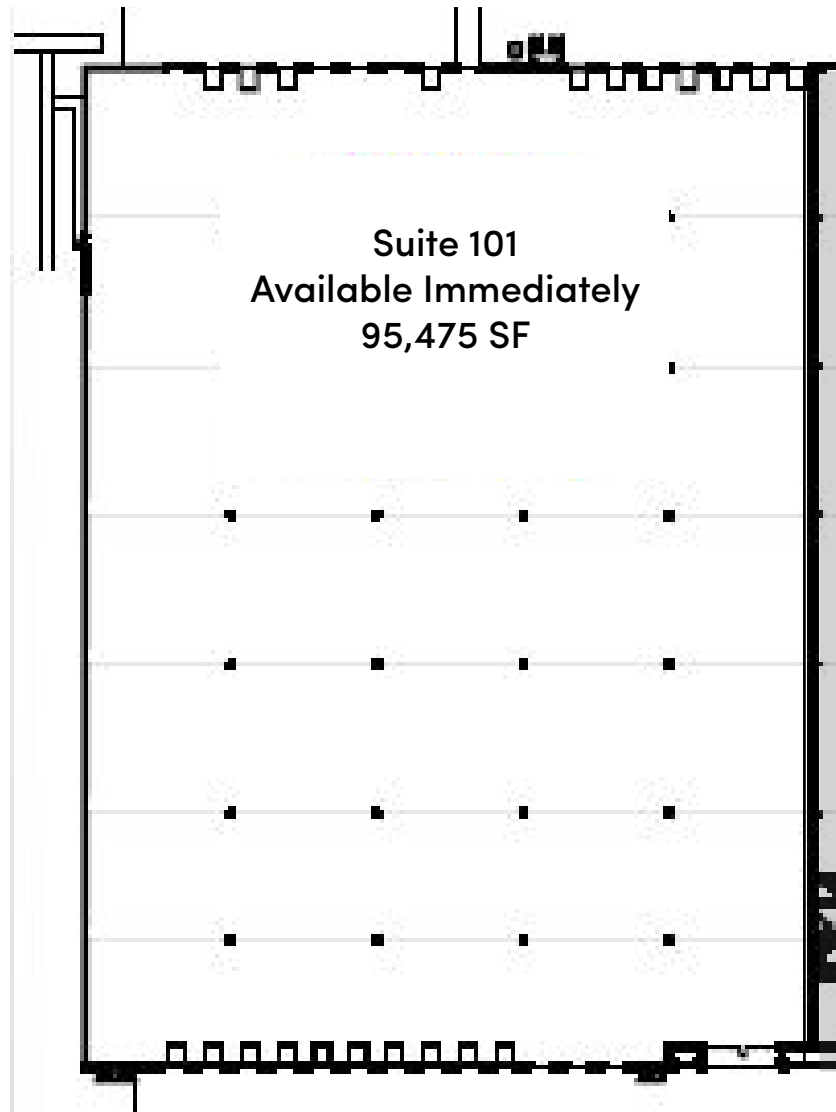

## Contact Us

Learn more about this property or schedule a tour by reaching out to our local investment and leasing officer.

**Bobby Daush**

+1 (901) 355-0460

bobby.daush@eqtpartners.com

# 3300 Jet Cove

Memphis, TN

## BUILDING SPECIFICATIONS - SUITE 107

---

Building Space Available: 57,285 SF

---

---

4,200 SF office space

---

---

Cross docked with 16 dock doors

---

---

LED lighting

---

---

35,000 SF cooler space

---

---

24' ceiling height in the cooler space

---



## Contact Us

Learn more about this property or schedule a tour by reaching out to our local investment and leasing officer.

**Bobby Daush**

+1 (901) 355-0460

[bobby.daush@eqtpartners.com](mailto:bobby.daush@eqtpartners.com)

# 3300 Jet Cove

Memphis, TN

## BUILDING SPECIFICATIONS - SUITE 109

---

Building Space Available: 72,205 SF

---

---

Approx. 3,500 SF office space

---

---

22 dock doors

---

---

1 drive-in doors

---

---

T5 fluorescent lighting

---

---

Contiguous to Suite 107

---

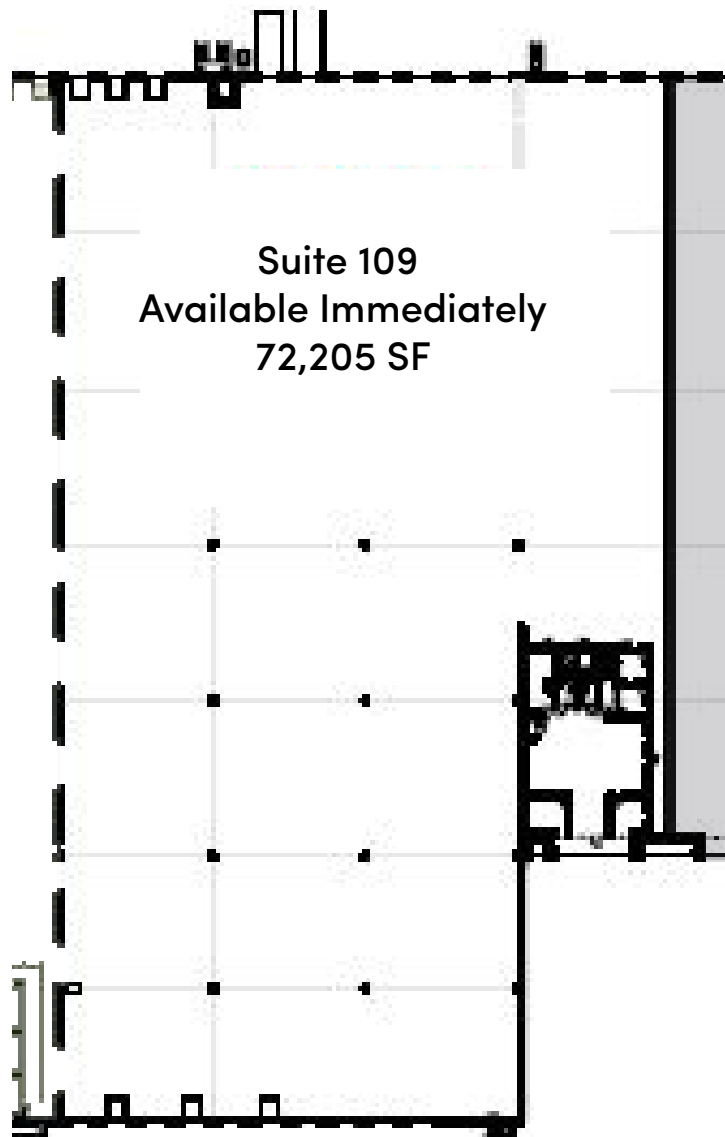

## Contact Us

Learn more about this property or schedule a tour by reaching out to our local investment and leasing officer.

**Bobby Daush**

+1 (901) 355-0460

[bobby.daush@eqtpartners.com](mailto:bobby.daush@eqtpartners.com)