

**FOR LEASE**

Owned and Operated by  **LINK**

## AIRPARK EAST BUSINESS PARK

408, 410 & 412 Gallimore Dairy Road  
Greensboro, NC 27410

**+/- 8,000 - 75,700 SF**



### LEASING INFO & CONTACT

Ryan Conboy, SIOR  
Bobby Finch

(336) 821-3832 / [ryan.conboy@cushwake.com](mailto:ryan.conboy@cushwake.com)  
(336) 812-3303 / [bobby.finch@cushwake.com](mailto:bobby.finch@cushwake.com)

 **CUSHMAN &  
WAKEFIELD**

This is not an offer or acceptance of an offer to lease space. A lease will only be offered or made in a written agreement signed by landlord. No representation or warranty of any kind is made by landlord unless set forth in a written definitive lease executed by the landlord.

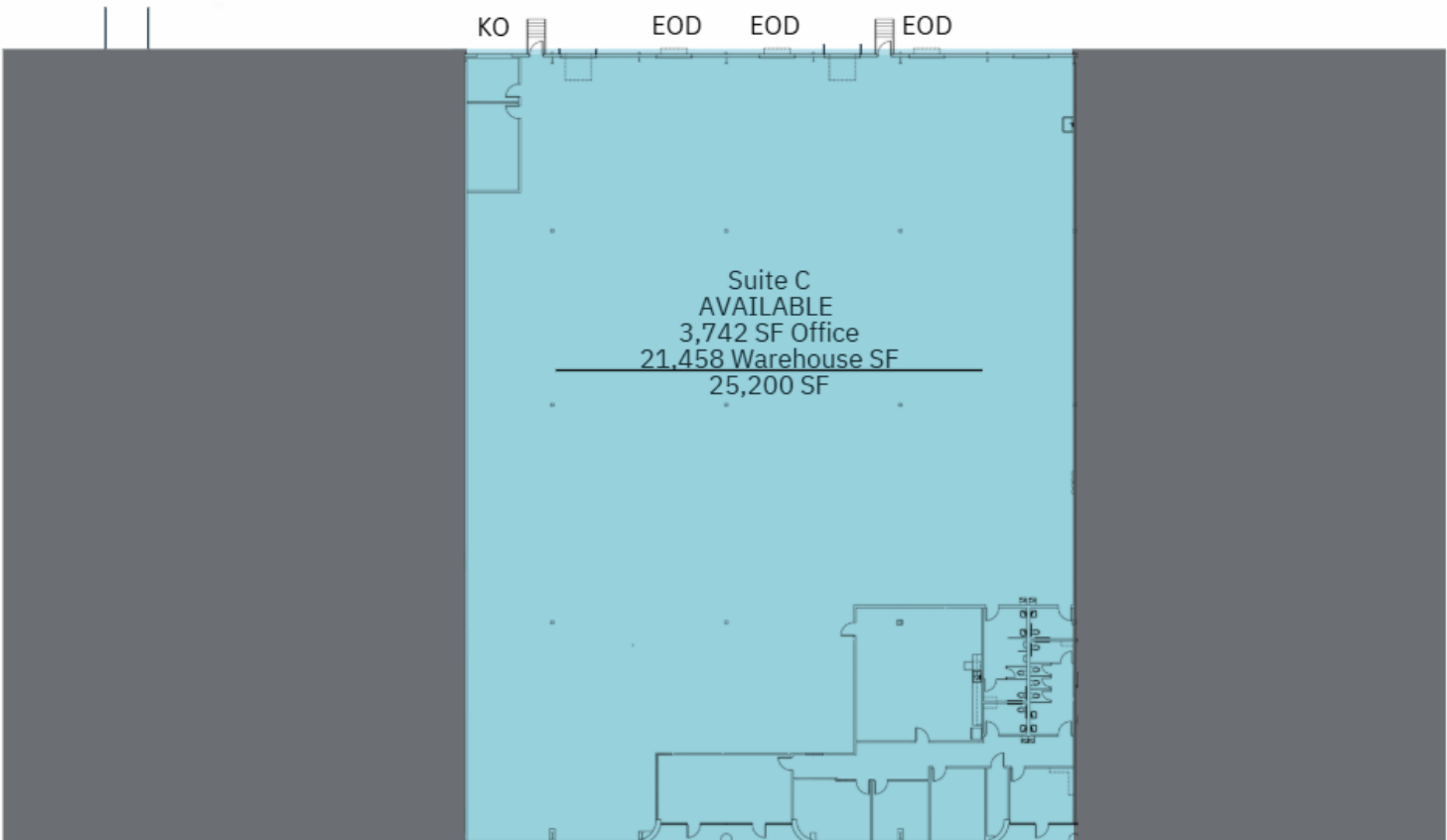

408 Gallimore Dairy Road

Suite C

Size: 25,200 SF (3,742 SF Office)

Clear Height: 21'

Column Spacing: 40' x 50'

Lighting: LED

Dock Doors: Six (6) 8' x 10'

Two (2) W/ Pit Leveler, Three (3) W/Edge of Dock

One (1) Knock-Out Panel

Sprinkler: Wet System

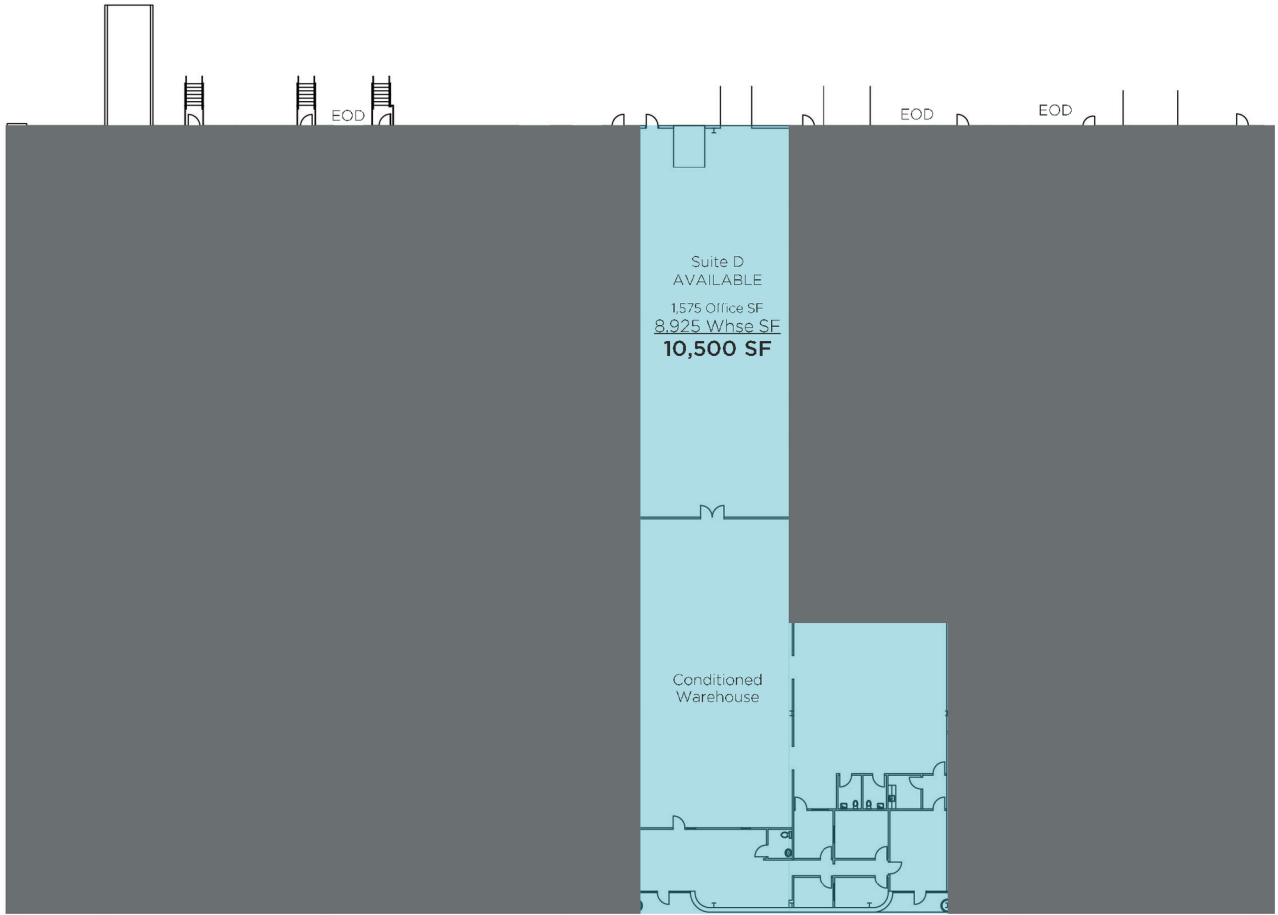

410 Gallimore Dairy Road, Suite D

Size: 10,500 SF (1,575 SF Office)
Partly Conditioned
Clear Height: 21'
Column Spacing: 40' x 50'

Dock Doors: One (1) 8' x 10' w/ Pit Leveler
Drive-up Ramp: One (1) 10' x 10'
Lighting: LED
Sprinkler: Wet System



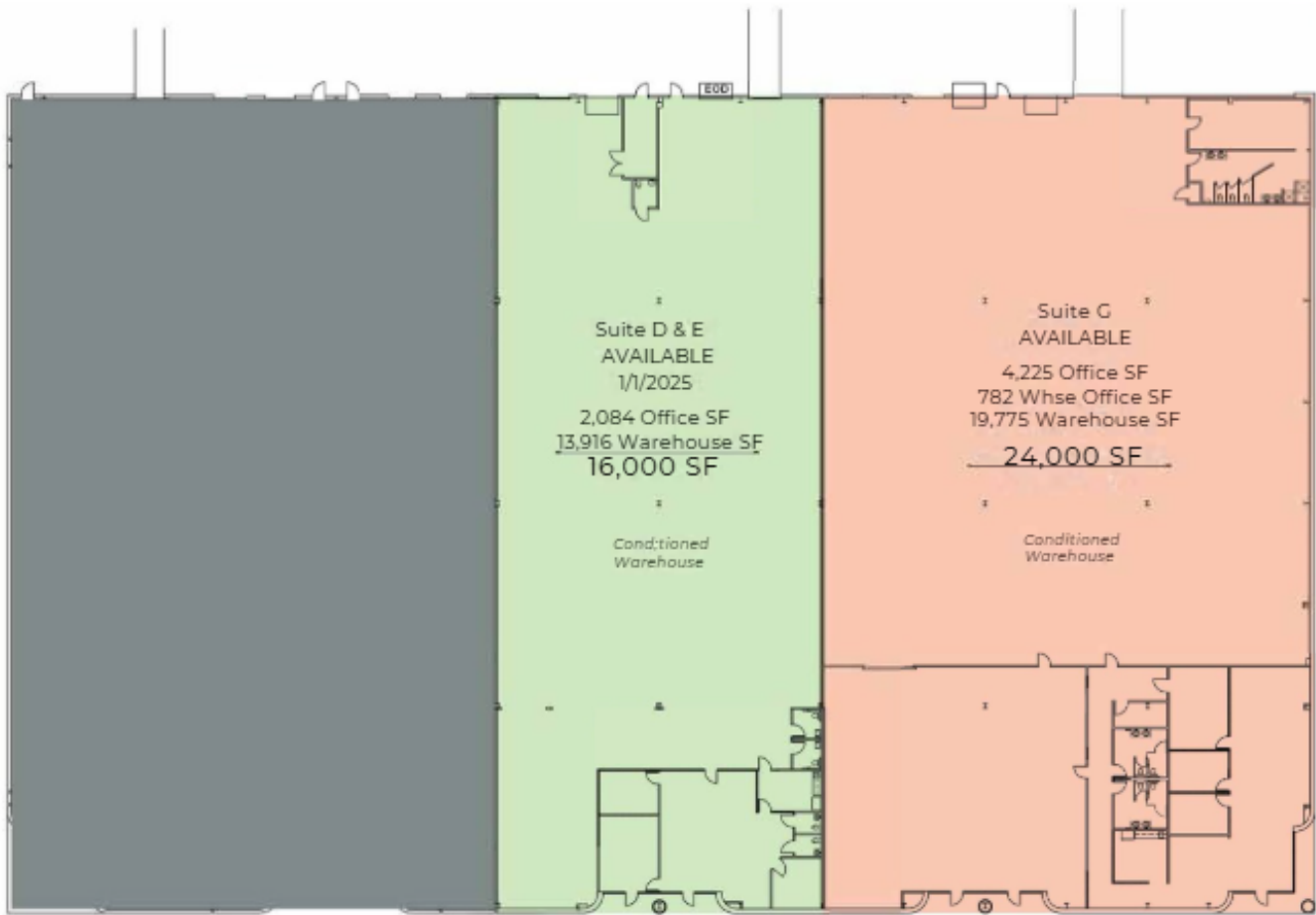

412 Gallimore Dairy Road

Suite D & E

Size: 16,000 SF (2,084 SF Office)

Fully Conditioned

Clear Height: 21'

Column Spacing: 40' x 50'

Dock Doors: Three (3) 8' x 10' - One w/ Pit Leveler  
and One w/ EOD Leveler

Drive-Up Ramp: One (1) 10' x 10'

Lighting: LED

Sprinkler: Wet System

Suite G

Size: 24,000 SF (4,225 SF Office)

Fully Conditioned

Clear Height: 21'

Column Spacing: 40' x 50'

Dock Doors: Three (3) 8' x 10' - One w/ Pit Leveler

Drive-up Ramp: One (1) 10' x 10'

Lighting: LED

Sprinkler: Wet System







