



# CLAY HEMPSTEAD

## BUSINESS PARK

8700 CLAY ROAD | HOUSTON, TX 77080



### PROPERTY HIGHLIGHTS

- 4 buildings
- 286,985 SF total
- 12.19 acres
- Multiple loading configurations
- Built in 1980
- 16' - 22' clear height
- Frontage on Clay and Hempstead
- Infill NW Houston location
- Access to Beltway 8 and Highway 290

### SUITE 200 HIGHLIGHTS

- 34,997 SF available
  - 2,176 SF office
  - 32,821 SF warehouse
- **Retail/showroom with great visibility**
- 22' clear height
- 4 dock-high doors
- 2 loading ramps
- Fully sprinklered
- Security lighting
- Full make-ready complete



FOR LEASING INFORMATION, CONTACT:

**WOODY HILLYER**

713.300.0271

woody.hillyer@streamrealty.com

**JACK RATHE**

713.300.0298

jack.rathe@streamrealty.com

**STREAM**

**ENTRADA**  
PARTNERS



# CLAY HEMPSTEAD

BUSINESS PARK

8700 CLAY ROAD | HOUSTON, TX 77080

## SUITE 200 | FLOOR PLAN

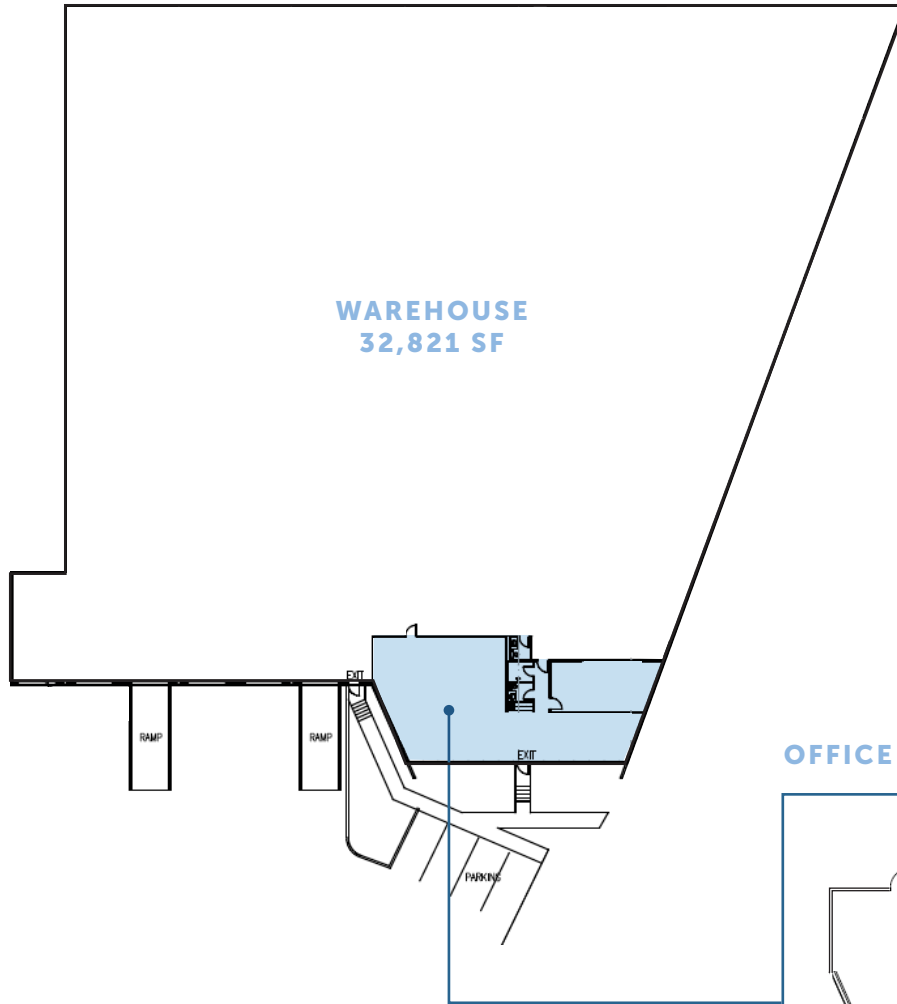

OFFICE | 2,176 SF

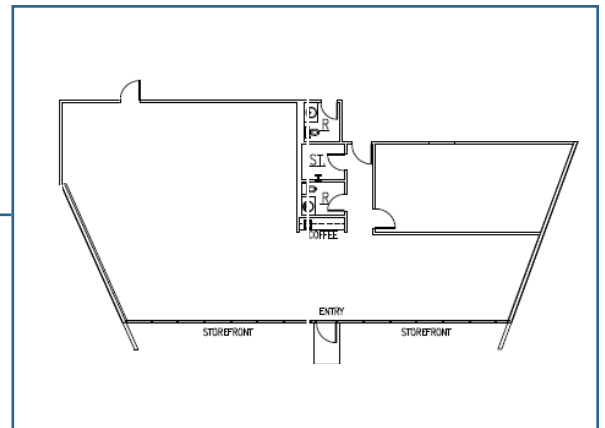

FOR LEASING INFORMATION, CONTACT:

WOODY HILLYER

713.300.0271

woody.hillyer@streamrealty.com

JACK RATHE

713.300.0298

jack.rathe@streamrealty.com







# CLAY HEMPSTEAD

BUSINESS PARK

8700 CLAY ROAD | HOUSTON, TX 77080



FOR LEASING INFORMATION, CONTACT:

WOODY HILLYER

713.300.0271

woody.hillyer@streamrealty.com

JACK RATHE

713.300.0298

jack.rathe@streamrealty.com

STREAM

ENTRADA  
PARTNERS





# CLAY HEMPSTEAD

BUSINESS PARK

8700 CLAY ROAD | HOUSTON, TX 77080

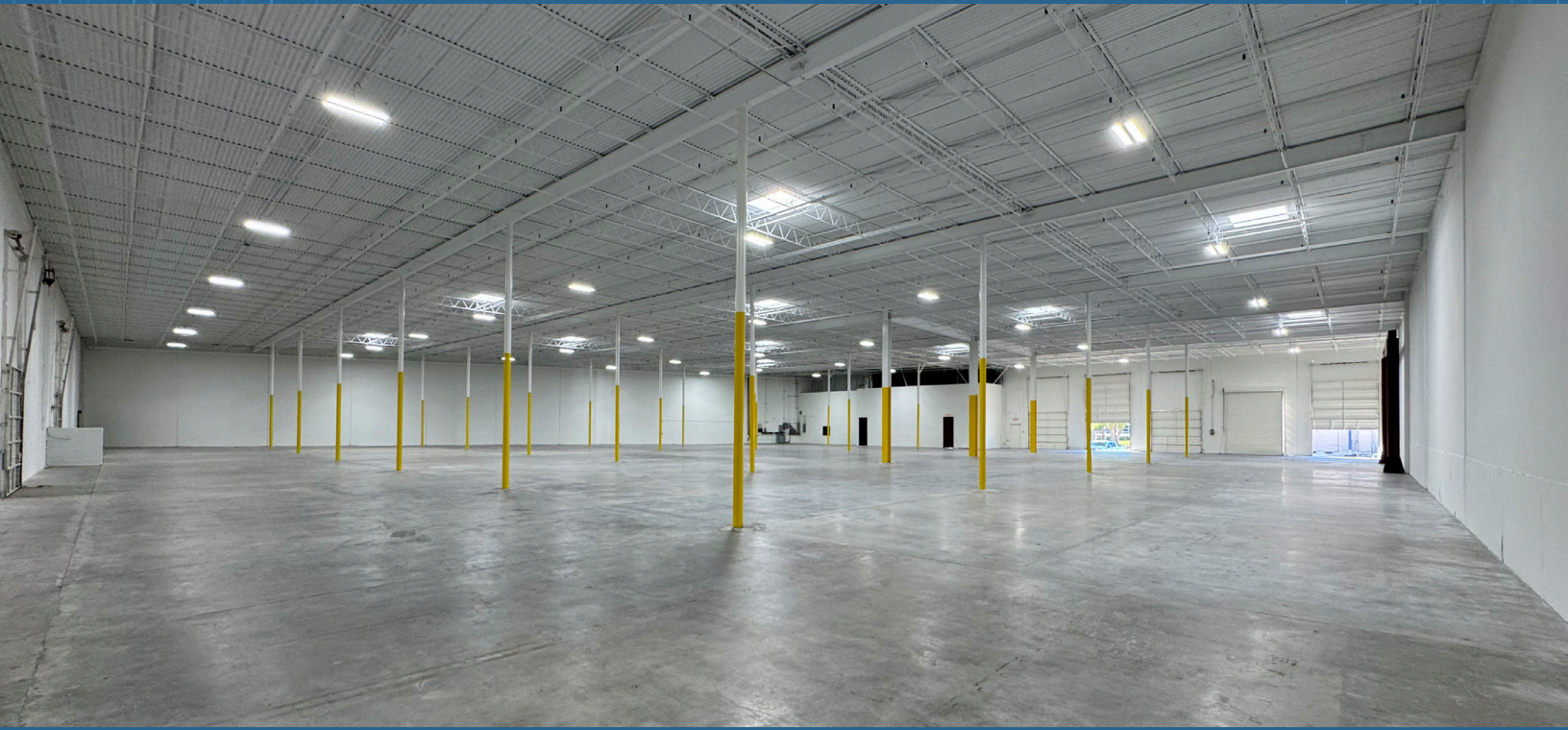

FOR LEASING INFORMATION, CONTACT:

**WOODY HILLYER**

713.300.0271

[woody.hillyer@streamrealty.com](mailto:woody.hillyer@streamrealty.com)

**JACK RATHE**

713.300.0298

[jack.rathe@streamrealty.com](mailto:jack.rathe@streamrealty.com)

**STREAM**

**ENTRADA**  
PARTNERS