



Wally Courtney
Real Estate Broker
(714) 772-0602
wcourtney@pkrealtors.com
Lic: 00859144

Orange County Retail Space For Lease Approx. 3,134 sq.ft

1600 W. Lincoln Avenue
Anaheim, CA 92801



THE SPACE

Location	1600 W. Lincoln Avenue, Anaheim, CA, 92801
COUNTY	Orange
Cross Street	Loara & Lincoln
Square Feet	3134
Annual Rent PSF	\$36.00
Lease Type	NNN

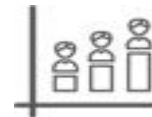

POPULATION

1.00 MILE	3.00 MILE	5.00 MILE
33,213	287,214	692,297



AVERAGE HOUSEHOLD INCOME

1.00 MILE	3.00 MILE	5.00 MILE
\$93,736	\$102,872	\$109,483



NUMBER OF HOUSEHOLDS

1.00 MILE	3.00 MILE	5.00 MILE
10,256	83,247	206,519



Report a map error



Retail Space

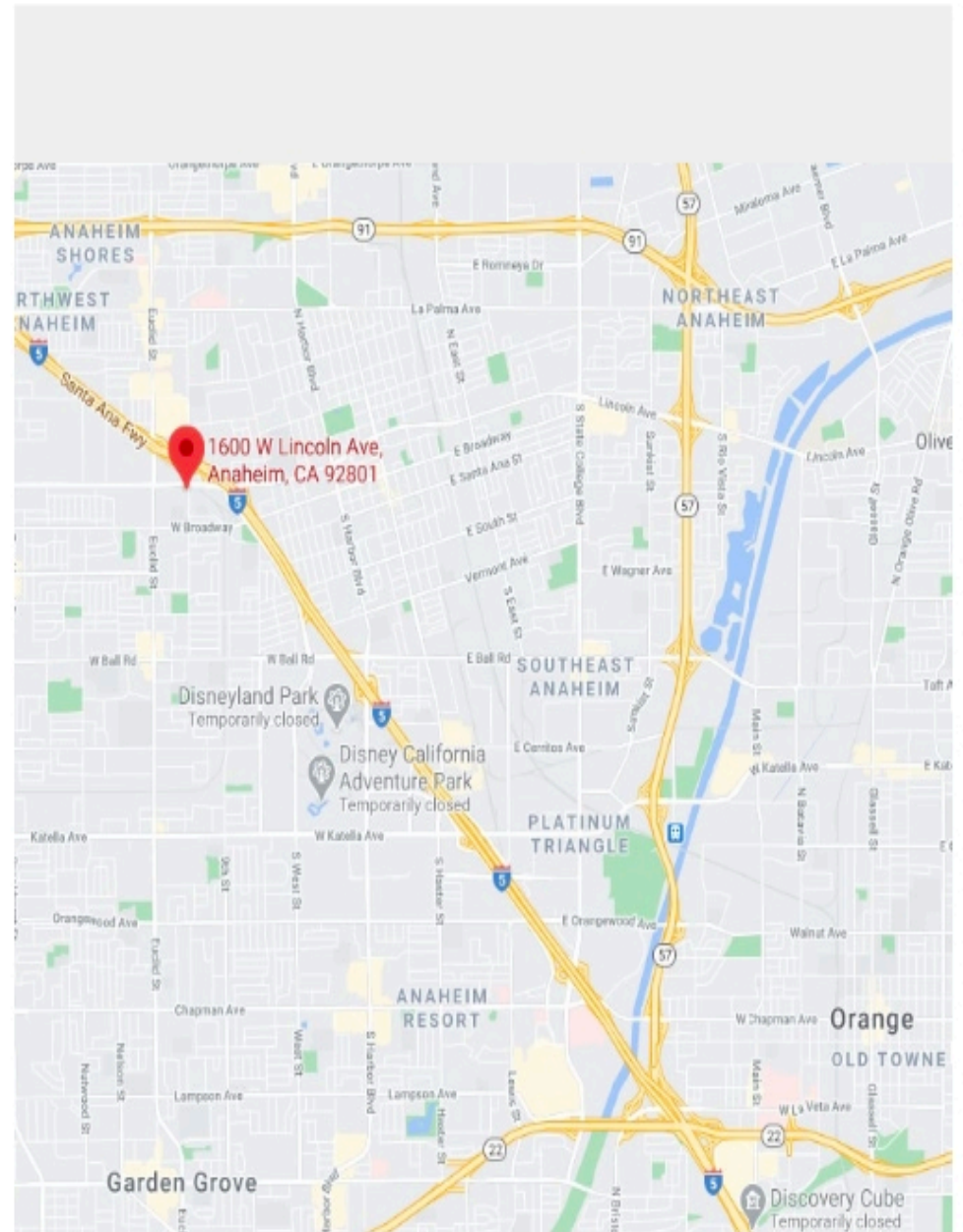



Retail Space

Retail Parking

NORTH ELEVATION



Retail Space



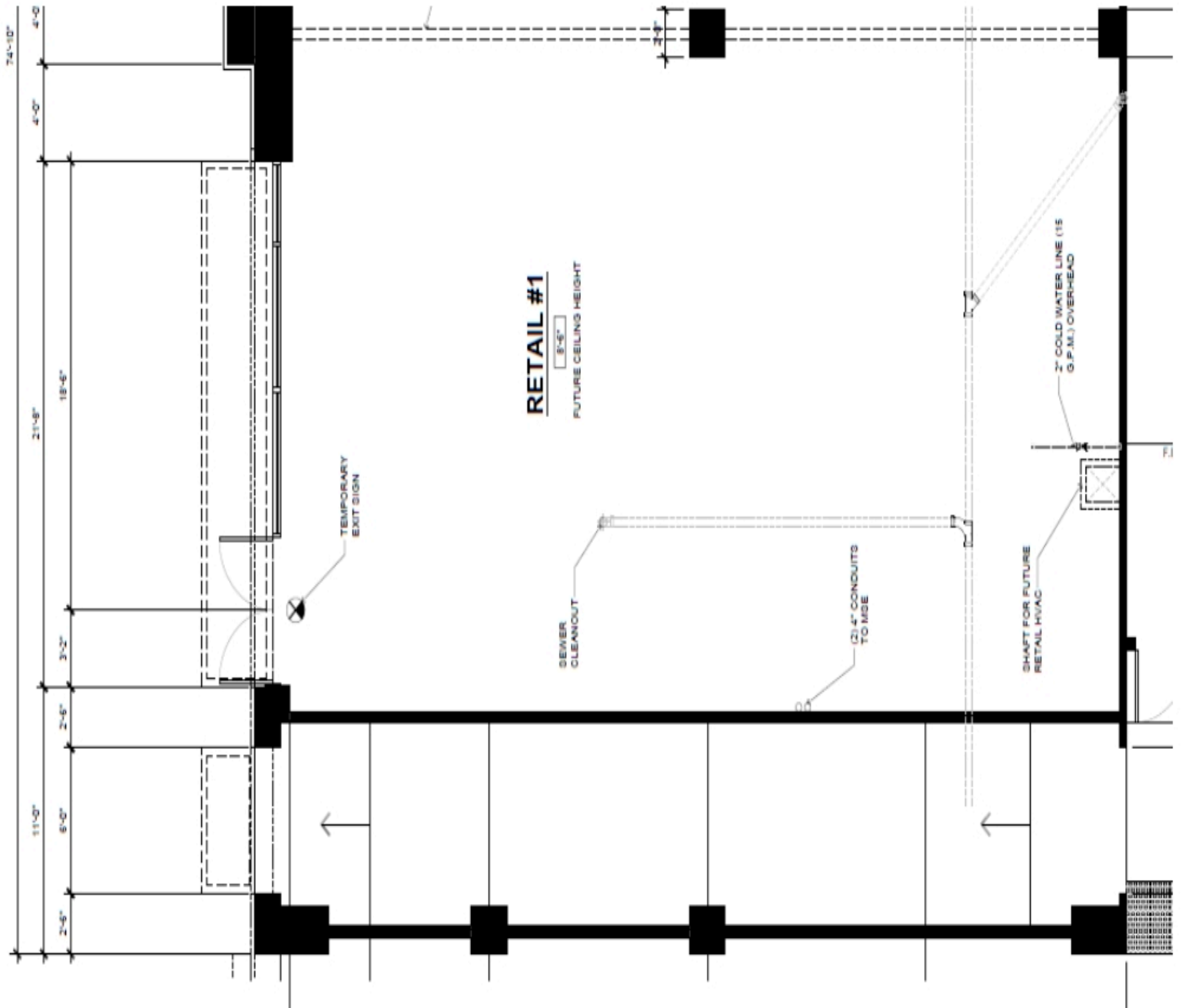

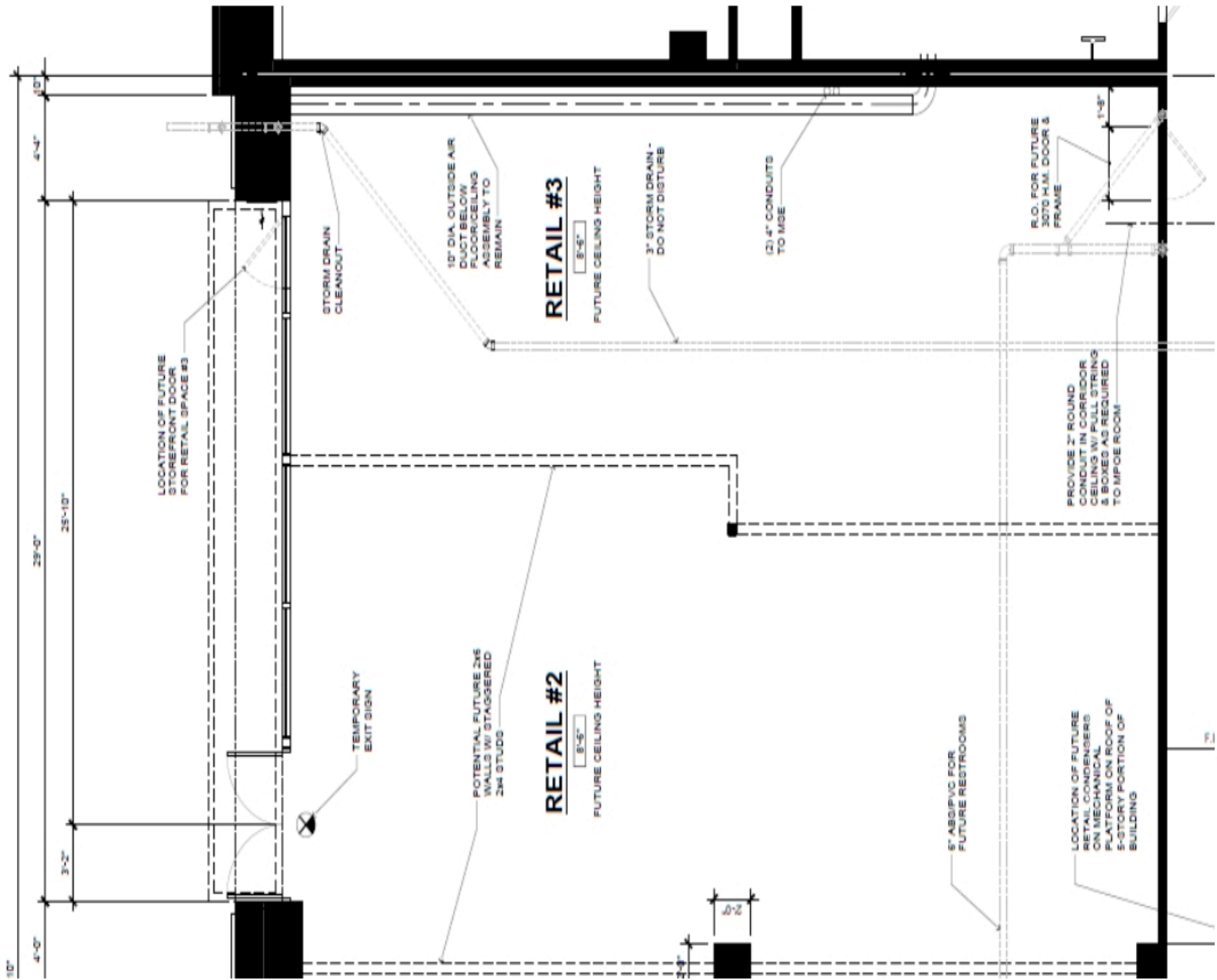

Parking Details

1600 W. Lincoln Ave, Anaheim,
CA 92801

- Total Spaces Available: 12
(Includes 1 ADA and 3 CAV)
- CAV = Clean Air Vehicle

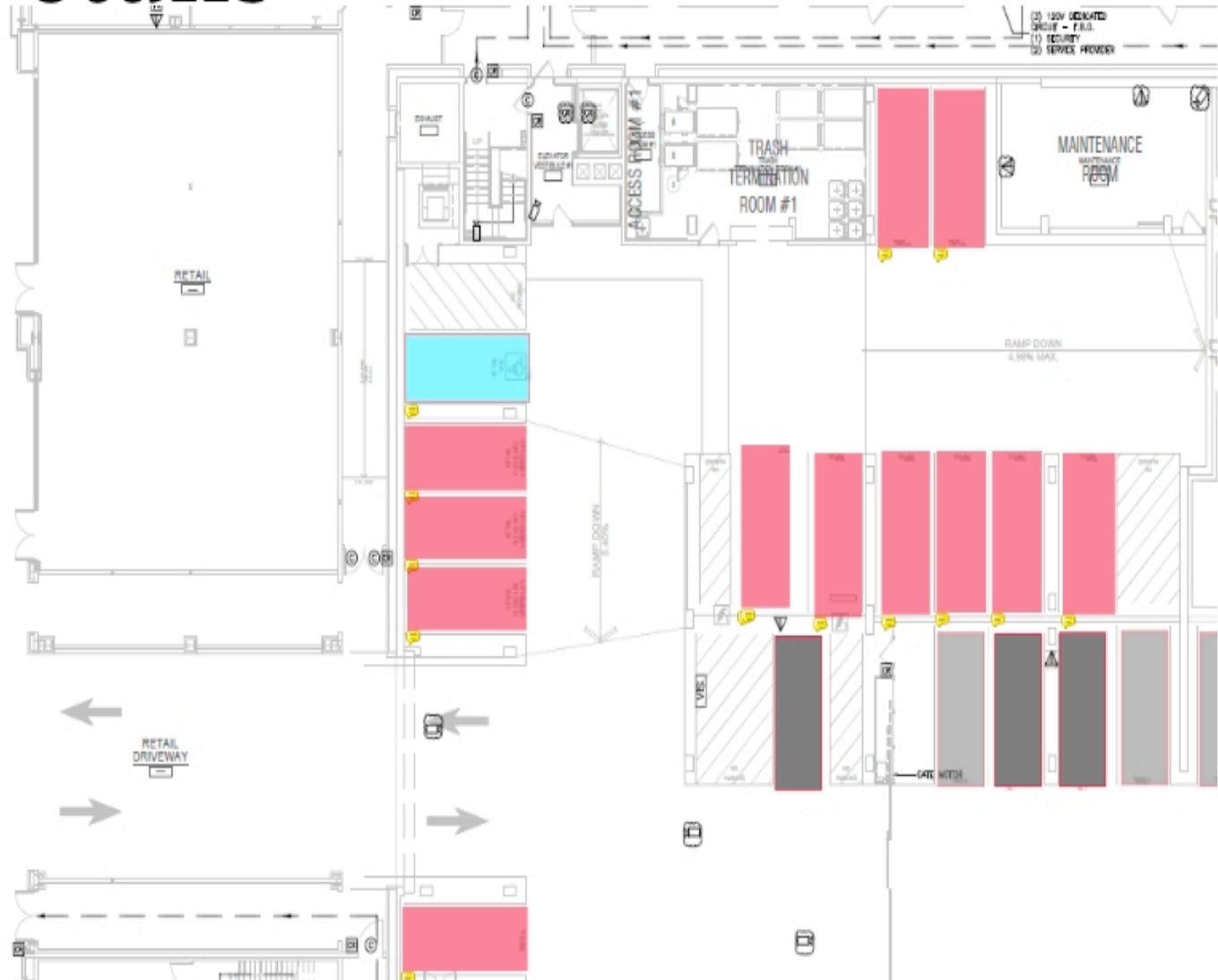

ZIA

LIVING FULL CIRCLE



Zia is a new 2023-built luxury multifamily rental community in Anaheim, California poised to open Summer 2024. Located in the heart of Orange County and set against a backdrop of single-family homes, apartments and business that inspire its local culture, Zia is surrounded by endless opportunities for rich experiences and access to main interstates.

Situated on approx. 5 acres, the property offers modern suburban construction comprised of apartments and approx. 3,134 sq.ft. of retail for lease.

Located prominently at Lincoln Ave. with direct access from the 5 Freeway.

POPULATION	1 MILE	3 MILE	5 MILE
2000 Population	31,899	277,662	642,535
2010 Population	33,222	283,541	670,149
2023 Population	33,213	287,214	692,297
2028 Population	34,212	289,398	696,562
2023-2028: Population: Growth Rate	2.95 %	0.75 %	0.60 %
2023 HOUSEHOLD INCOME	1 MILE	3 MILE	5 MILE
less than \$15,000	1,051	6,835	17,248
\$15,000-\$24,999	703	4,783	10,653
\$25,000-\$34,999	668	5,469	12,786
\$35,000-\$49,999	1,087	7,745	18,197
\$50,000-\$74,999	1,698	13,957	33,488
\$75,000-\$99,999	1,481	12,357	29,025
\$100,000-\$149,999	1,948	16,355	40,997
\$150,000-\$199,999	982	8,953	23,986
\$200,000 or greater	636	6,784	20,128
Median HH Income	\$73,369	\$79,487	\$82,742
Average HH Income	\$93,736	\$102,872	\$109,483

HOUSEHOLDS	1 MILE	3 MILE	5 MILE
2000 Total Housing	9,969	79,594	191,326
2010 Total Households	9,709	77,290	190,953
2023 Total Households	10,256	83,247	206,519
2028 Total Households	10,632	84,543	209,500
2023 Average Household Size	3.19	3.41	3.28
2000 Owner Occupied Housing	3,960	36,310	92,084
2000 Renter Occupied Housing	5,804	41,283	94,446
2023 Owner Occupied Housing	3,909	35,905	93,320
2023 Renter Occupied Housing	6,347	47,342	113,199
2023 Vacant Housing	327	3,190	8,582
2023 Total Housing	10,583	86,437	215,101
2028 Owner Occupied Housing	4,035	36,962	95,906
2028 Renter Occupied Housing	6,596	47,581	113,594
2028 Vacant Housing	307	3,325	8,798
2028 Total Housing	10,939	87,868	218,298
2023-2028: Households: Growth Rate	3.60 %	1.55 %	1.45 %

Source: esri

2023 POPULATION BY AGE	1 MILE	3 MILE	5 MILE
2023 Population Age 30-34	2,888	24,125	57,868
2023 Population Age 35-39	2,520	21,316	50,846
2023 Population Age 40-44	2,130	18,759	45,049
2023 Population Age 45-49	1,949	16,984	41,728
2023 Population Age 50-54	1,901	16,789	41,346
2023 Population Age 55-59	1,685	14,760	37,261
2023 Population Age 60-64	1,625	13,737	35,644
2023 Population Age 65-69	1,314	11,051	29,166
2023 Population Age 70-74	1,066	8,555	23,003
2023 Population Age 75-79	746	5,899	16,419
2023 Population Age 80-84	445	3,713	10,464
2023 Population Age 85+	475	3,748	10,330
2023 Population Age 18+	24,769	213,289	528,230
2023 Median Age	34	33	35

2023 INCOME BY AGE	1 MILE	3 MILE	5 MILE
Median Household Income 25-34	\$77,060	\$81,994	\$84,050
Average Household Income 25-34	\$93,292	\$101,601	\$104,585
Median Household Income 35-44	\$83,229	\$89,687	\$94,224
Average Household Income 35-44	\$107,747	\$116,675	\$122,138
Median Household Income 45-54	\$87,006	\$93,361	\$101,065
Average Household Income 45-54	\$109,999	\$117,655	\$128,178
Median Household Income 55-64	\$75,654	\$82,951	\$90,250
Average Household Income 55-64	\$95,648	\$107,219	\$118,996
Median Household Income 65-74	\$57,069	\$64,851	\$69,933
Average Household Income 65-74	\$79,455	\$89,668	\$97,738
Average Household Income 75+	\$59,852	\$66,037	\$71,500

2028 POPULATION BY AGE	1 MILE	3 MILE	5 MILE
2028 Population Age 30-34	2,624	22,633	53,611
2028 Population Age 35-39	2,860	23,276	56,024
2028 Population Age 40-44	2,499	20,562	48,970
2028 Population Age 45-49	2,099	17,882	43,086
2028 Population Age 50-54	1,908	16,161	39,710
2028 Population Age 55-59	1,826	15,727	38,708
2028 Population Age 60-64	1,569	13,338	33,718
2028 Population Age 65-69	1,441	11,967	31,473
2028 Population Age 70-74	1,150	9,534	25,687
2028 Population Age 75-79	893	7,104	19,396
2028 Population Age 80-84	605	4,649	13,174
2028 Population Age 85+	543	4,297	12,071
2028 Population Age 18+	25,923	218,549	539,603
2028 Median Age	36	35	36

2028 INCOME BY AGE	1 MILE	3 MILE	5 MILE
Median Household Income 25-34	\$84,408	\$90,533	\$94,364
Average Household Income 25-34	\$105,239	\$114,801	\$118,720
Median Household Income 35-44	\$97,434	\$103,718	\$108,046
Average Household Income 35-44	\$127,526	\$136,237	\$142,375
Median Household Income 45-54	\$100,761	\$104,648	\$110,916
Average Household Income 45-54	\$127,629	\$135,093	\$145,909
Median Household Income 55-64	\$85,781	\$95,720	\$103,654
Average Household Income 55-64	\$113,578	\$125,084	\$137,179
Median Household Income 65-74	\$72,610	\$79,443	\$84,834
Average Household Income 65-74	\$95,186	\$107,547	\$117,552
Average Household Income 75+	\$74,164	\$81,306	\$88,901

2023 Household Occupancy - 1 Mile Radius

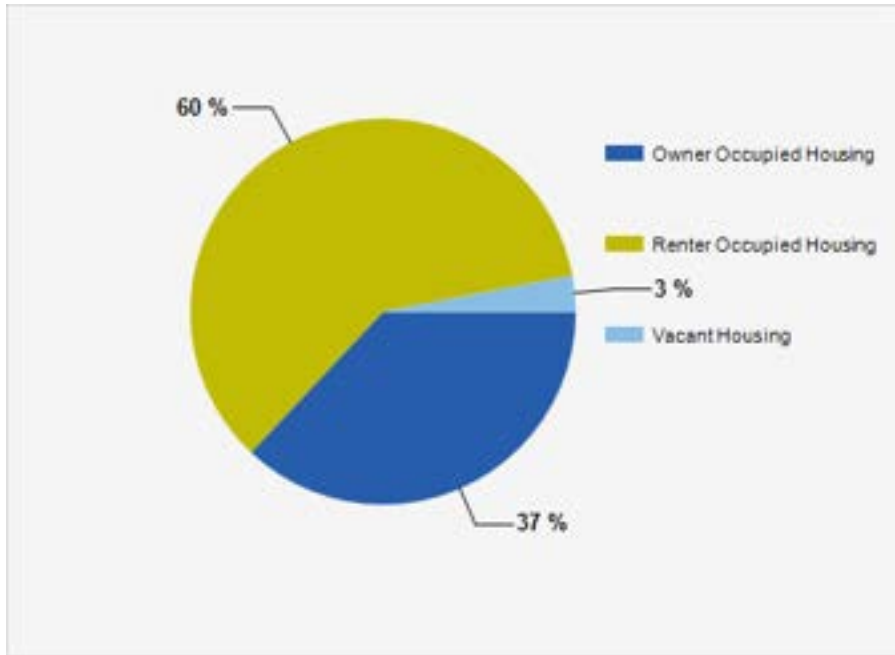

2023 Household Income Average and Median



2023 Household Income

