

Sand Dollar Shopping Center

S A N D C I T Y , C A L I F O R N I A



Retail Space Available for Lease

850 Playa: $\pm 22,775$ SF | 832 Playa: $\pm 1,840$ SF

$\pm 10,000$ SF of Outdoor Space Available



CUSHMAN &
WAKEFIELD

Site PLAN



Legal Address 850 Playa Ave.
City Sand City, CA 93955
Shopping Center Name Sand Dollar Shopping Center
APN 011-011-029
Land Use/Zoning C-4



1964
Year Built



Single Story
Number of Floors



**1x External Dock High
Roll-Up with 8' Clearance**
Receiving Area

850 Playa

HIGHLIGHTS



22,775 SF



Premises Frontage
125' Playa Ave



Lot/Slope
Level - Irregular



Hazardous Materials
None



Shopping Center Frontage
804' HWY 1



Signage
Building



HVAC
Yes, 2 x 6 ton + 2 x 7.5 Ton



Shopping Center Parking
710 Stalls



850 Playa

FLOOR PLAN

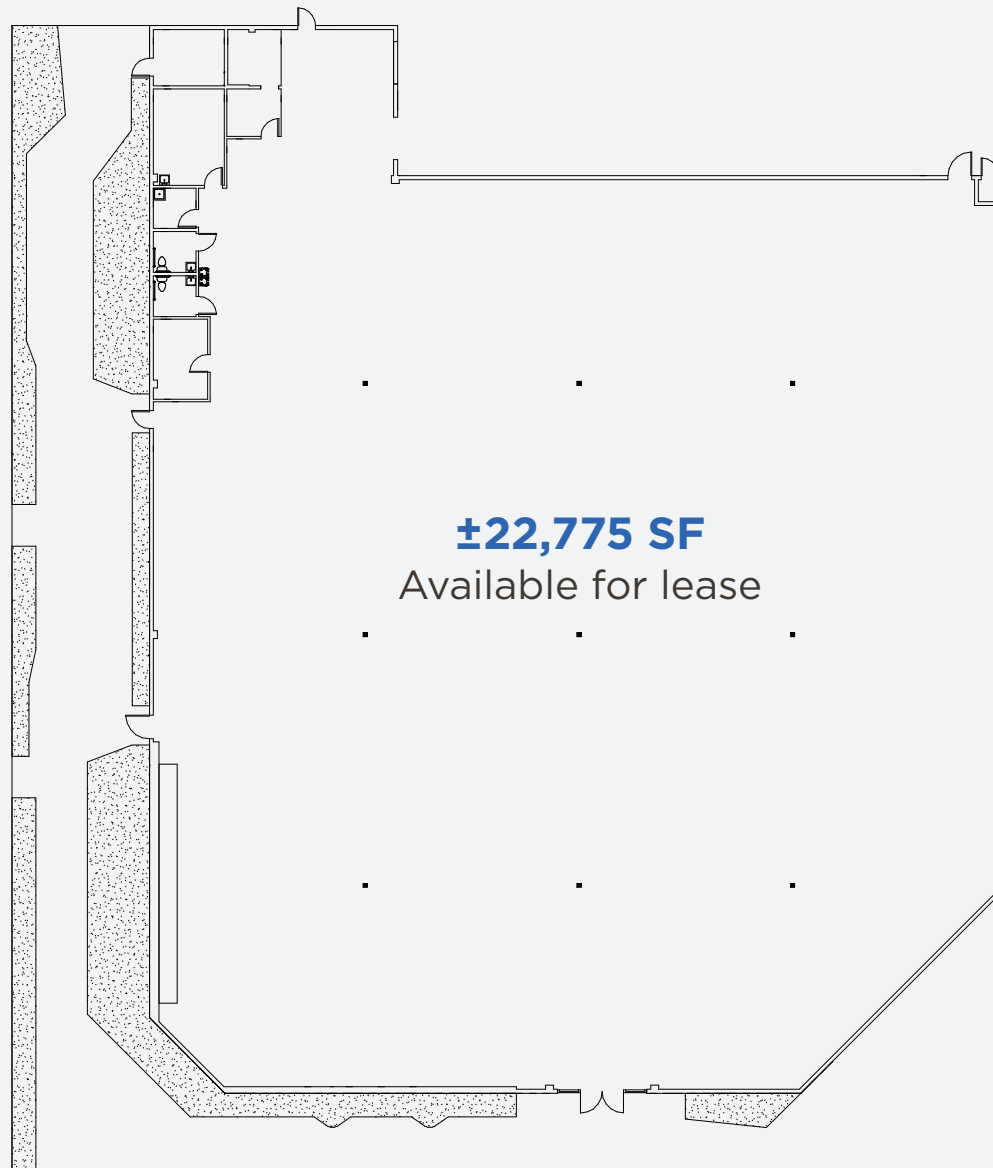

832 Playa

HIGHLIGHTS



1,840 SF



2nd generation
food and beverage suite



Inline suite with visibility
from Del Monte Avenue



In-place FF&E includes:

- Grease Trap
- Service Counter
- Floor drains

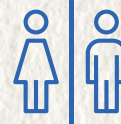

2 restrooms



832 Playa

FLOOR PLAN

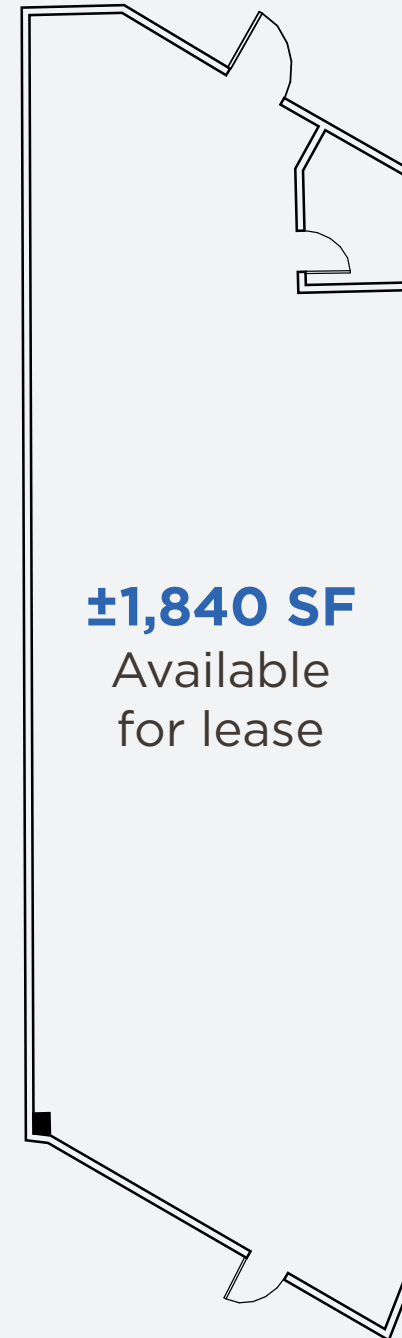

±1,840 SF
Available
for lease

Outdoor Space

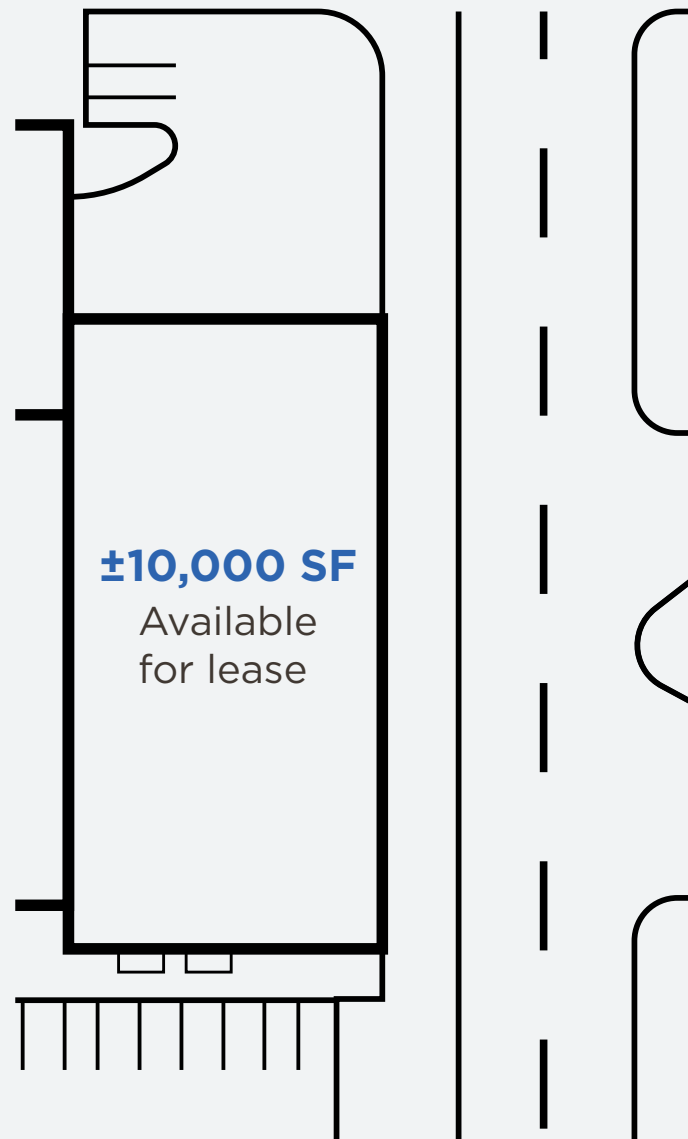

Area Stats | 5 Mile Radius

Total Population
90,264

Avg. Household Income
\$126,259

Avg. Household Size
2.44

Median Age
37

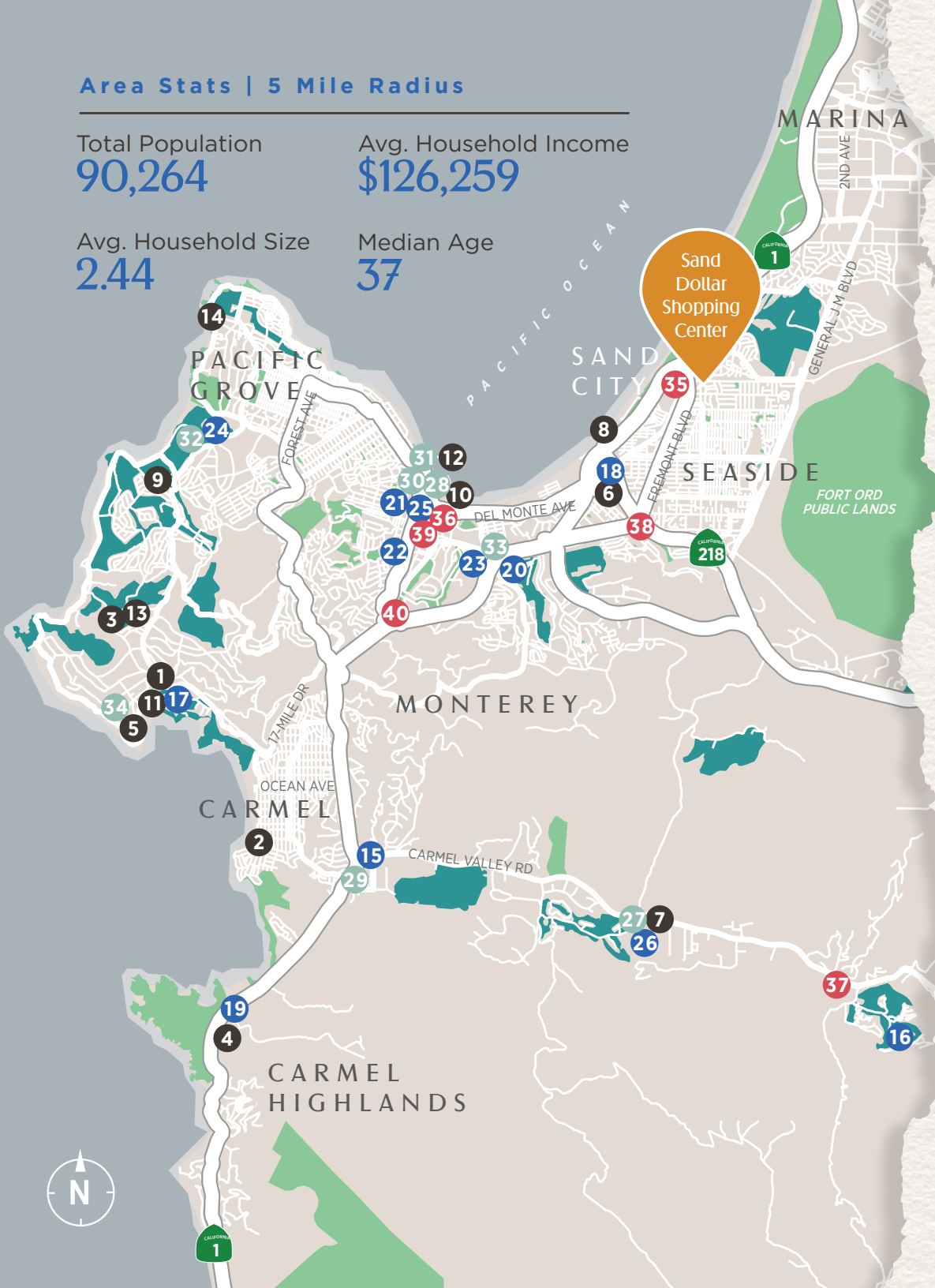

Amenity MAP

- | | |
|---------------------------------|------------------------------|
| 1 17 Mile Drive | 21 Monterey Marriott |
| 2 Carmel Beach | 22 Old Monterey Inn |
| 3 Carmel River State Beach | 23 Portola Hotel & Spa |
| 4 Cypress Grove | 24 The Inn at Spanish Bay |
| 5 Cypress Point Club | 25 The Monterey Hotel |
| 6 Laguna Grande Park | 26 The Quail |
| 7 Laguna Sea Golf Ranch | 27 Baja Cantina & Grill |
| 8 Monterey State Beach | 28 Crab House |
| 9 Moss Beach | 29 Edgar's at Quai Lodge |
| 10 Old Fisherman's Wharf | 30 Old Fisherman's Grotto |
| 11 Pebble Beach Golf Links | 31 Osteria al Mare |
| 12 Seals & Sea Lions | 32 Roys at Pebble Beach |
| 13 Spyglass Hill Golf Course | 33 Sandbar & Grill |
| 14 The Great Tide Pool | 34 Zaniel |
| 15 Carmel Mission Inn | 35 Edgewater Shopping Center |
| 16 Carmel Valley Ranch | 36 Old Monterey |
| 17 Casa Palmero at Pebble Beach | 37 Safeway Foods |
| 18 Embassy Suites | 38 Safeway Foods |
| 19 Hyatt Carmel Highlands | 39 Trader Joe's |
| 20 Hyatt Regency | 40 Whole Foods |

- | | | | |
|-------------|--------------|-------------|--------|
| Attractions | Lodging | Restaurants | Retail |
| Golf Clubs | Parks & Recs | | |

Sand Dollar Shopping Center

S A N D C I T Y , C A L I F O R N I A

For more information, please contact:

NICK GREENUP

+1 831 647 2106

nicholas.greenup@cushwake.com

LIC #02143358



©2025 Cushman & Wakefield. All rights reserved. The information contained in this communication is strictly confidential. This information has been obtained from sources believed to be reliable but has not been verified. NO WARRANTY OR REPRESENTATION, EXPRESS OR IMPLIED, IS MADE AS TO THE CONDITION OF THE PROPERTY (OR PROPERTIES) REFERENCED HEREIN OR AS TO THE ACCURACY OR COMPLETENESS OF THE INFORMATION CONTAINED HEREIN, AND SAME IS SUBMITTED SUBJECT TO ERRORS, OMISSIONS, CHANGE OF PRICE, RENTAL OR OTHER CONDITIONS, WITHDRAWAL WITHOUT NOTICE, AND TO ANY SPECIAL LISTING CONDITIONS IMPOSED BY THE PROPERTY OWNER(S). ANY PROJECTIONS, OPINIONS OR ESTIMATES ARE SUBJECT TO UNCERTAINTY AND DO NOT SIGNIFY CURRENT OR FUTURE PROPERTY PERFORMANCE. COE-PM-West-01.16.2025