

Retail for Lease

# 1517-1523 S Harvard Ave

Tulsa, OK 74112

**WIGGIN**  
PROPERTIES, LLC



## Retail for Lease

1517-1523 S Harvard Ave, Tulsa

**Center Size:** 12,678± SF  
**Available SF:** Ste 1517-C: 2,140± SF  
Ste 1523-A: 3,150± SF  
**Rate:** Negotiable  
**Signage:** Pylon  
**Traffic Counts:** 17,182 vpd S. Harvard Ave  
16,280 vpd E. 15th St  
21,411 vpd S 33rd E Ave

- Highlights:**
- Remodeled exterior 2024
  - White-box ready interior
  - Abundant parking
  - Generous improvement allowance
  - Great location at 15th & Harvard
  - Easy access to Hwy 51
  - Building signage & pylon signage

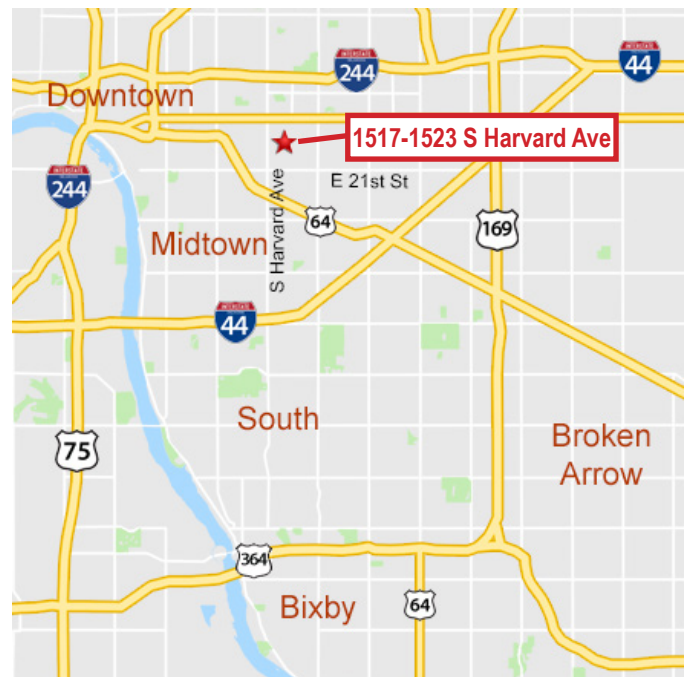

### Demographics

| 2024              | <a href="#">1 mile</a> | <a href="#">3 miles</a> | <a href="#">5 miles</a> |
|-------------------|------------------------|-------------------------|-------------------------|
| Population        | 11,737                 | 101,455                 | 223,463                 |
| Average HH Income | \$83,703               | \$80,712                | \$70,312                |
| Households        | 5,387                  | 44,021                  | 95,731                  |

**Vicki Patterson, CCIM 918.519.6731 || Erica Cunningham 918.829.5754**

[vpatterson@wiggprop.com](mailto:vpatterson@wiggprop.com) | [ecunningham@wiggprop.com](mailto:ecunningham@wiggprop.com) | [wiggprop.com](http://wiggprop.com)

This material is provided for information purposes only. It is from sources believed to be reliable. However, Wiggin Properties makes no warranties or representations, expressed or implied, as to the accuracy or sufficiency of the information. It is presented subject to errors, omissions, changes or withdrawal without notice. Square footage per owner. Photos and graphics ©Costar, ©Wiggin Properties and/or ©Independent contractors. Aerial maps © Google. Photos and graphics used by permission.



Retail for Lease

# 1517-1523 S Harvard Ave

Tulsa, OK 74112

**WIGGIN**  
PROPERTIES, LLC



Vicki Patterson, CCIM 918.519.6731 || Erica Cunningham 918.829.5754

[vpatterson@wigginprop.com](mailto:vpatterson@wigginprop.com) | [ecunningham@wigginprop.com](mailto:ecunningham@wigginprop.com) | [wigginprop.com](http://wigginprop.com)

This material is provided for information purposes only. It is from sources believed to be reliable. However, Wiggin Properties makes no warranties or representations, expressed or implied, as to the accuracy or sufficiency of the information. It is presented subject to errors, omissions, changes or withdrawal without notice. Square footage per owner. Photos and graphics ©Costar, ©Wiggin Properties and/or ©Independent contractors. Aerial maps © Google. Photos and graphics used by permission.



Retail for Lease

# 1517-1523 S Harvard Ave

Tulsa, OK 74112

**WIGGIN**  
PROPERTIES, LLC

## 1517-1523 S Harvard Floorplans

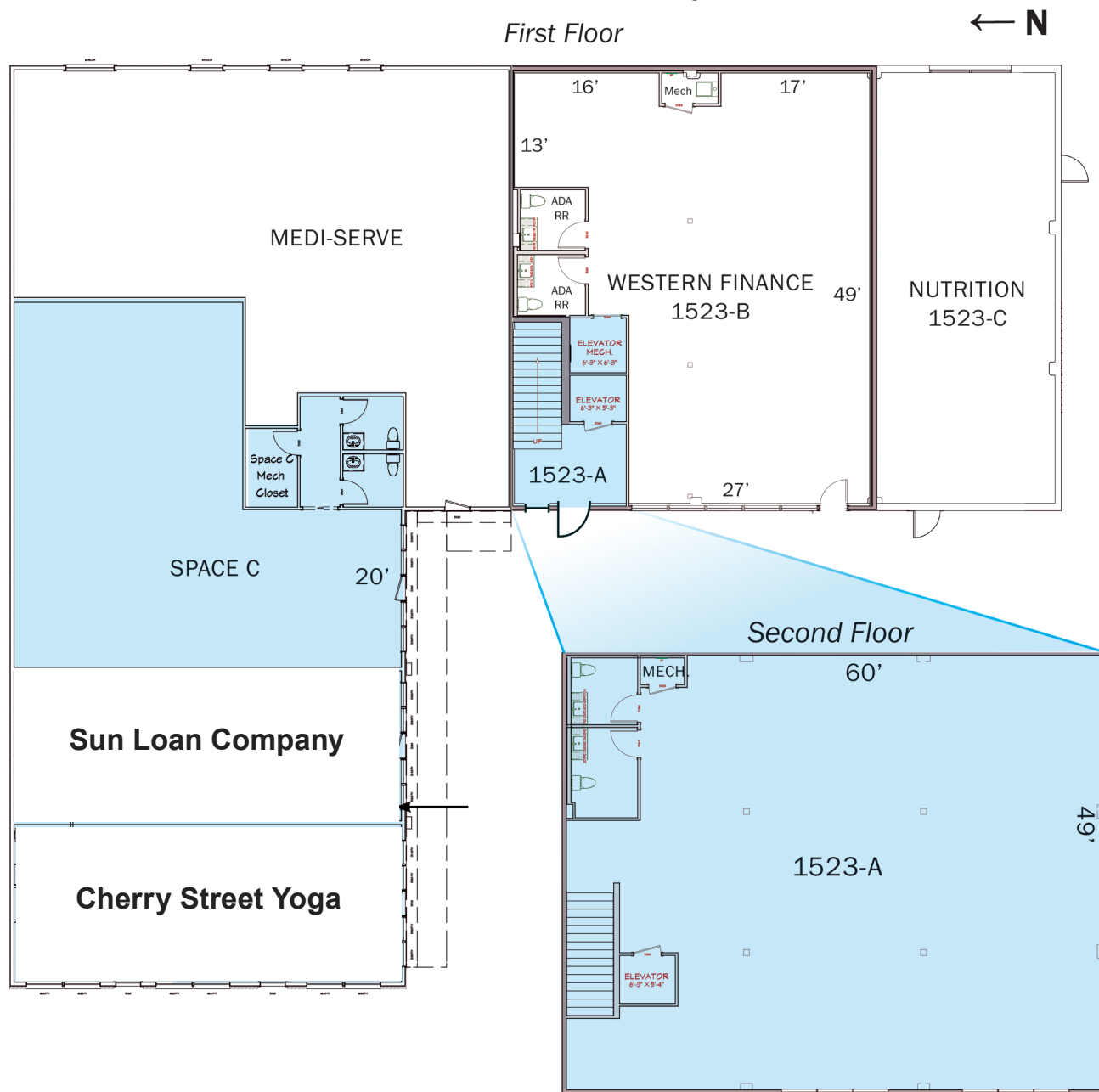

### 1517-C: ±2,140 sf

- New full height storefront entries
- New ADA restrooms
- High ceilings
- Frontage on Harvard Ave

### 1523-A: ±3,150 sf (2nd floor)

- Separate ground floor entry
- Elevator access
- Ready for buildout
- Exposed 9' ceilings

**Vicki Patterson, CCIM 918.519.6731 || Erica Cunningham 918.829.5754**

[vpatterson@wiginprop.com](mailto:vpatterson@wiginprop.com) | [ecunningham@wiginprop.com](mailto:ecunningham@wiginprop.com) | [wiginprop.com](http://wiginprop.com)

This material is provided for information purposes only. It is from sources believed to be reliable. However, Wiggin Properties makes no warranties or representations, expressed or implied, as to the accuracy or sufficiency of the information. It is presented subject to errors, omissions, changes or withdrawal without notice. Square footage per owner. Photos and graphics ©Costar, ©Wiggin Properties and/or ©independent contractors. Aerial maps © Google. Photos and graphics used by permission.