



**FOR LEASE**

**1111 Horan Drive**

Fenton, MO 63026

**Lease Rate:**

**\$9.25** PSF, NNN

**CONTACT US**

**Dan Lesinski, SIOR**

Senior Vice President  
+1 314 412 4345  
dan.lesinski@colliers.com

**Billy Spence**

Associate Vice President  
+1 636 278 0565  
billy.spence@colliers.com

**Colliers**

101 South Hanley Road  
Suite 1400  
St. Louis, MO 63105  
+1 314 863 4447  
colliers.com/stlouis

## Industrial Space for Lease in Fenton

**Highlights**

- Building under new ownership!
- 13,000 SF available for lease
- 1,620 SF office/showroom
- 18' clear height
- One (1) dock-high door
- One (1) grade-level drive in door
- Easy access to I-44 and I-270

## FLOOR PLAN

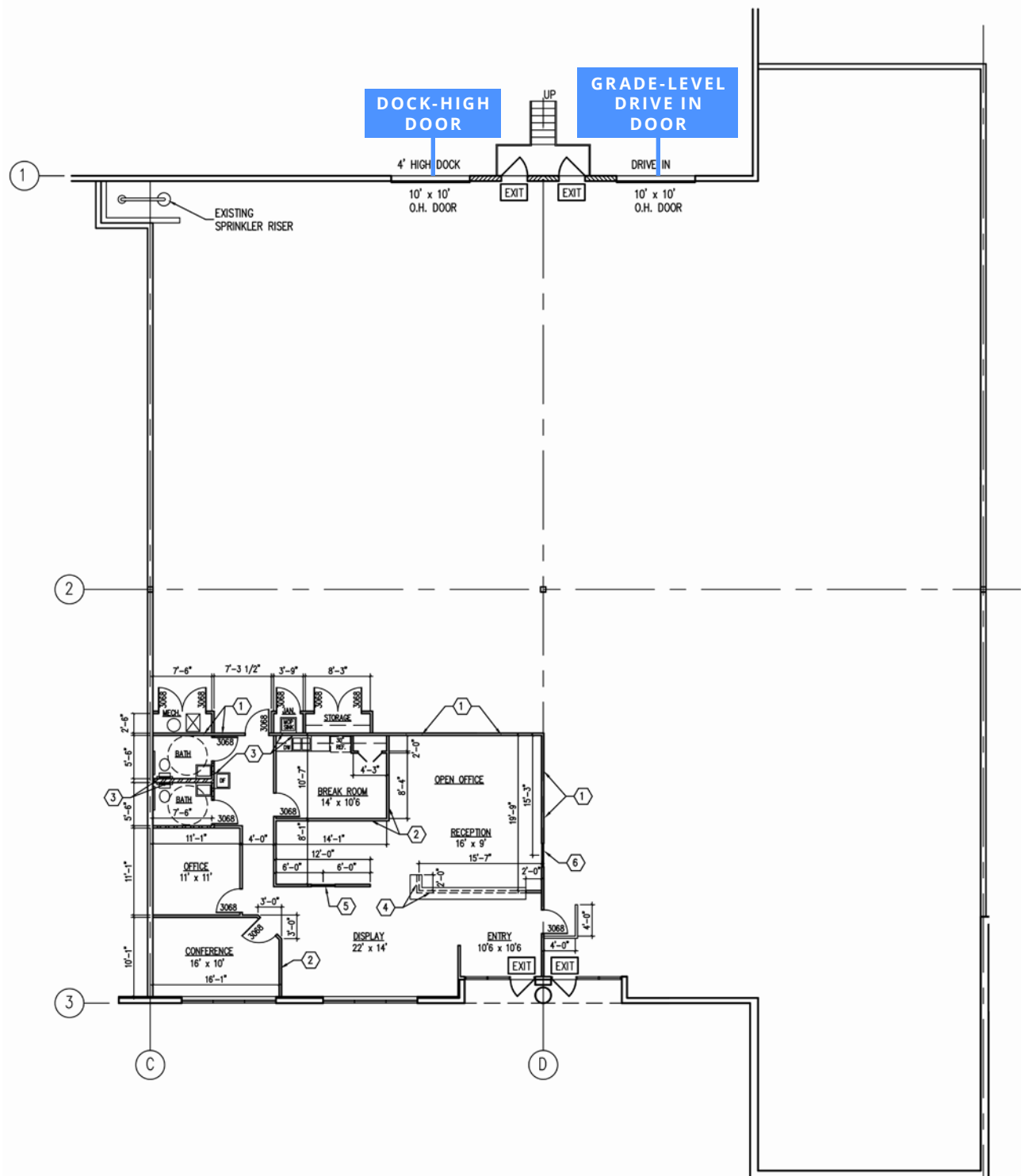



## PROPERTY PHOTOS





LOCATION



Demographics	Population	Households	Avg HH Income	Businesses	Employees
1 Mile	3,228	1,234	\$167,226	487	15,433
3 Miles	47,583	19,574	\$141,166	2,138	44,212
5 Miles	144,921	58,610	\$152,468	6,615	107,121

CONTACT US

**Dan Lesinski, Sior**  
Senior Vice President  
+1 314 412 4345  
dan.lesinski@colliers.com

**Billy Spence**  
Associate Vice President  
+1 636 278 0565  
billy.spence@colliers.com

**Colliers**  
101 South Hanley Road  
Suite 1400  
St. Louis, MO 63105  
+1 314 863 4447  
colliers.com/stlouis

This document/email has been prepared by Colliers for advertising and general information only. Colliers makes no guarantees, representations or warranties of any kind, expressed or implied, regarding the information including, but not limited to, warranties of content, accuracy and reliability. Any interested party should undertake their own inquiries as to the accuracy of the information. Colliers excludes unequivocally all inferred or implied terms, conditions and warranties arising out of this document and excludes all liability for loss and damages arising there from. This publication is the copyrighted property of Colliers and /or its licensor(s). © 2025. All rights reserved. This communication is not intended to cause or induce breach of an existing listing agreement.