

JUNIOR ANCHOR BOX / SHOP SPACE - WILMINGTON, NC

5000 MARKET STREET | WILMINGTON, NORTH CAROLINA | 28405



CONTACT

Matt Henry | 980.701.0034
mhenry@providencegroup.com

Thurman Brooks | 704.644.4585
tbrooks@providencegroup.com

Darrell Palasciano | 704.644.4587
dpalasciano@providencegroup.com



CLICK FOR VIDEO



300 West Summit Ave | Suite 250 | Charlotte, North Carolina 28203
www.PROVIDENCEGROUP.com

AVAILABLE
FOR LEASE



JUNIOR ANCHOR BOX / SHOP SPACE - WILMINGTON, NC

5000 MARKET STREET | WILMINGTON, NC | 28405

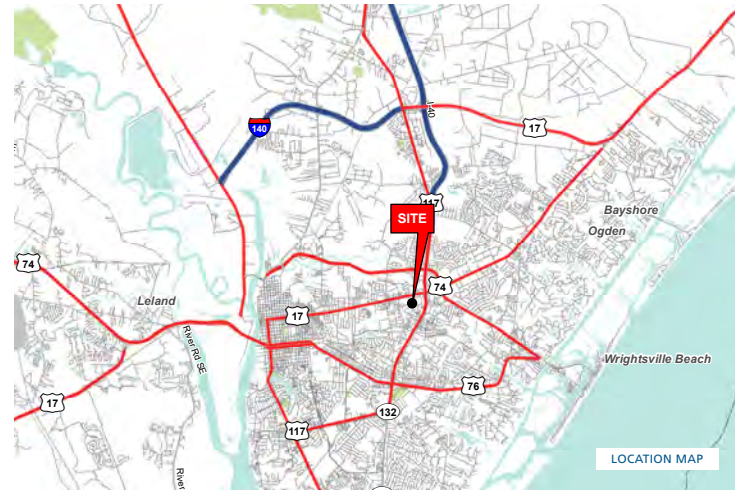

PROPERTY / LEASING INFORMATION

Shopping Center GLA: 91,637 SF
Available Space: 1,931 - 38,549 SF
Lease Rate: Please Call
Zoning: RB (Regional Business)
TICAM: \$3.54 / SF

PROPERTY HIGHLIGHTS

- Junior Anchor Opportunity on dynamic Wilmington retail corridor - Market Street
- Signalized Intersection at Lullwater Drive
- Wilmington ranked in top 10 in nation for economic growth (2023)
- Adjacent to Miller-Motte Technical college
- Fully built-out, conditioned classrooms/office space
- Space can be V-boxed for open use
- Close proximity to Costco, Target, Wal-mart, Academy Sports

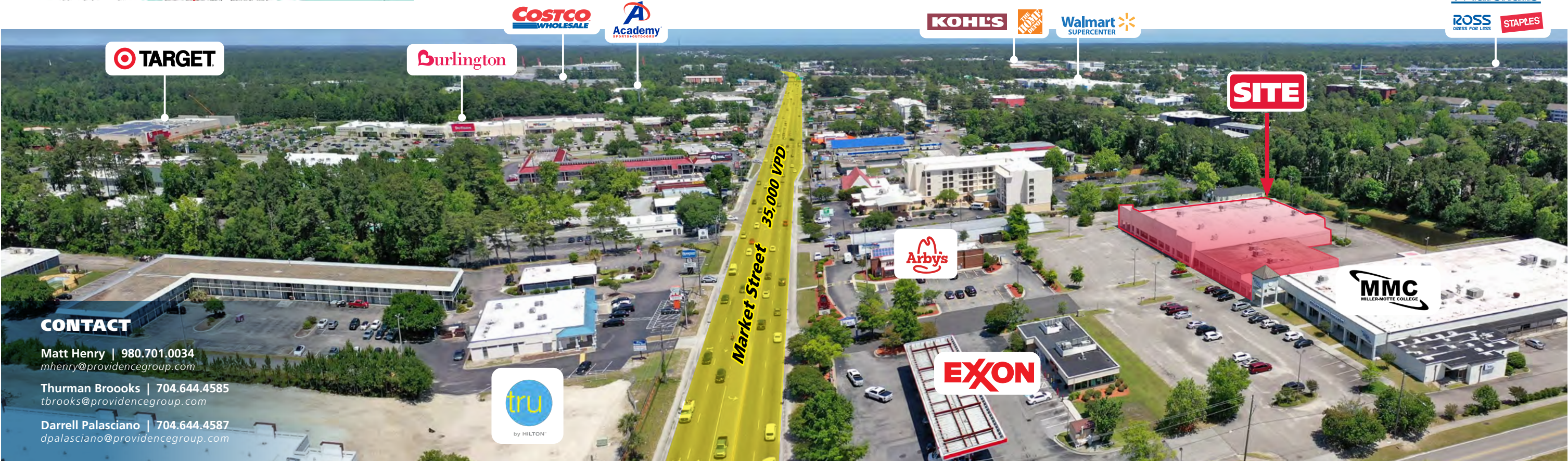

CONTACT
Matt Henry | 980.701.0034
mhenry@providencegroup.com
Thurman Brooks | 704.644.4585
tbrooks@providencegroup.com
Darrell Palasciano | 704.644.4587
dpalasciano@providencegroup.com

JUNIOR ANCHOR BOX / SHOP SPACE - WILMINGTON, NC

5000 MARKET STREET | WILMINGTON, NC | 28405



DEMOGRAPHICS (2022)	1 MILE	3 MILE	5 MILE
POPULATION	10,116	62,315	140,381
AVERAGE HH INCOME	\$45,364	\$70,596	\$84,500
MEDIAN HH INCOME	\$36,015	\$53,114	\$62,645
BUSINESS ESTABLISHMENTS	739	4,241	9,849
DAYTIME EMPLOYMENT	8,158	44,757	94,674



62,315
POPULATION*



27,752
ESTIMATED #
HOUSEHOLDS*



\$70,596
AVERAGE
HH INCOME*



4,241
TOTAL #
BUSINESSES*



43.4%
BACHELOR/
GRAD DEGREE*

* 3 MILE RADIUS

CONTACT

Matt Henry | 980.701.0034
mhenry@providencegroup.com

Thurman Brooks | 704.644.4585
tbrooks@providencegroup.com

Darrell Palasciano | 704.644.4587
dpalasciano@providencegroup.com

\$2,136
MONTHLY RETAIL
EXPENDITURE*



© 2023 The Providence Group. All rights reserved. The information above has been obtained by sources deemed reliable. While we do not doubt its accuracy, we have not verified it and make no guarantee, warranty, or representation of it. It is your responsibility to independently confirm its accuracy and completeness. You and your advisors should conduct a careful, independent investigation of the property to determine to your satisfaction the suitability of the property for your needs.

JUNIOR ANCHOR BOX / SHOP SPACE - WILMINGTON, NC

5000 MARKET STREET | WILMINGTON, NC | 28405

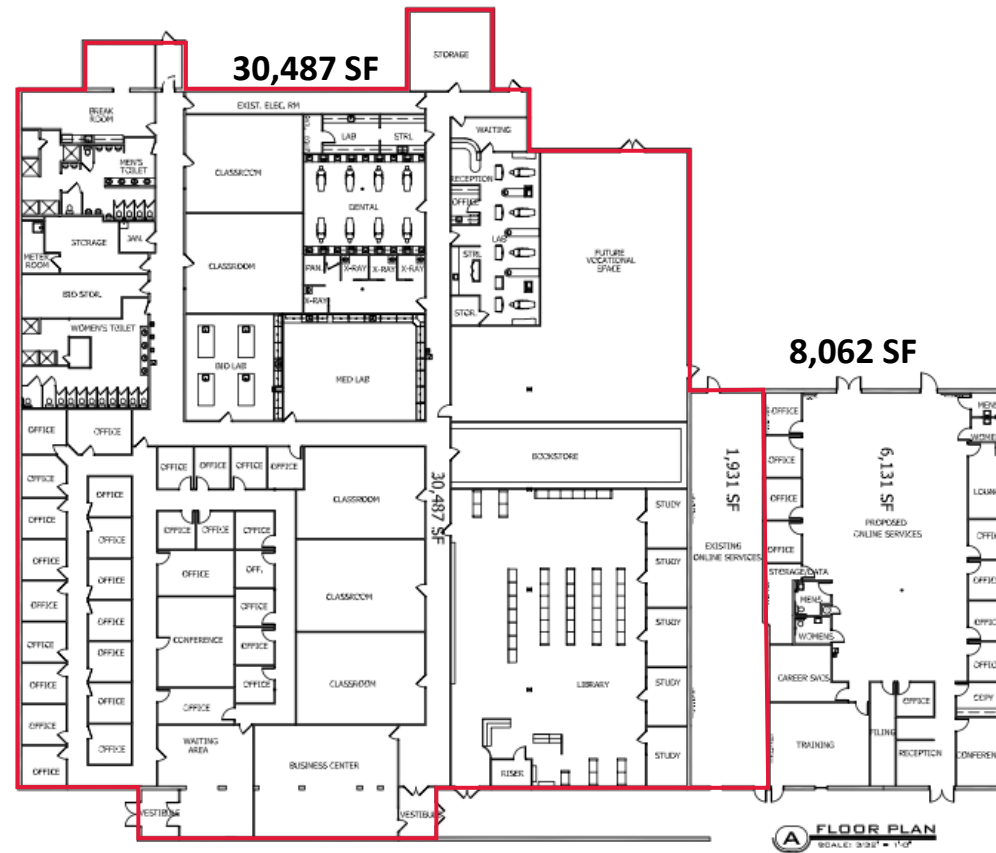

CONTACT

Matt Henry | 980.701.0034
mhenry@providencegroup.com

Thurman Brooks | 704.644.4585
tbrooks@providencegroup.com

Darrell Palasciano | 704.644.4587
dpalasciano@providencegroup.com

© 2023 The Providence Group. All rights reserved. The information above has been obtained by sources deemed reliable. While we do not doubt its accuracy, we have not verified it and make no guarantee, warranty, or representation of it. It is your responsibility to independently confirm its accuracy and completeness. You and your advisors should conduct a careful, independent investigation of the property to determine to your satisfaction the suitability of the property for your needs.





© 2023 The Providence Group. All rights reserved. The information above has been obtained by sources deemed reliable. While we do not doubt its accuracy, we have not verified it and make no guarantee, warranty, or representation of it. It is your responsibility to independently confirm its accuracy and completeness. You and your advisors should conduct a careful, independent investigation of the property to determine to your satisfaction the suitability of the property for your needs.

CLICK FOR VIDEO

CONTACT

Matt Henry | 980.701.0034
 mhenry@providencegroup.com

Darrell Palasciano | 704.644.4587
 dpalasciano@providencegroup.com