

# JADE APARTMENTS RETAIL

3150 W TWAIN AVE., LAS VEGAS, NV 89103

FOR LEASE



**LEE &  
ASSOCIATES**

COMMERCIAL REAL ESTATE SERVICES

8708 SPANISH RIDGE AVE | SUITE 115, LAS VEGAS, NV 89148

**JOANNA ZIRBES, CCIM**

Principal

License: S.0184741

[jzirbes@lee-associates.com](mailto:jzirbes@lee-associates.com)

(702) 490-0699

**BRENDAN LEAKE**

Principal

License: S.0178140

[bleake@lee-associates.com](mailto:bleake@lee-associates.com)

(702) 490-0699



# JADE APARTMENTS RETAIL

3150 W TWAIN AVE. | LAS VEGAS, NV 89103



**\$2.25 - \$3.00 NNN**

Lease rate



**±1,261 SF**  
space available

## PROPERTY HIGHLIGHTS

- Grease trap and tenant improvement allowance available
- Only retail space on first floor of apartment building with 287 units offering a built-in client base
- Located next door to Club Wyndham Desert Blue
- Visibility from I-15 freeway
- New LED billboard to be installed along I-15 with advertising opportunity available to retail tenant
- APN: 162-17-311-003



## DEMOGRAPHICS

	1-MILE	3-MILE	5-MILE
<b>2024 POPULATION</b>	9,115	151,602	400,756
<b>2024 AVERAGE HOUSEHOLD INCOME</b>	\$59,550	\$71,447	\$75,234
<b>2024 TOTAL HOUSEHOLDS</b>	4,398	69,158	165,856

# JADE APARTMENTS RETAIL

3150 TWAIN AVE. | LAS VEGAS, NV 89103

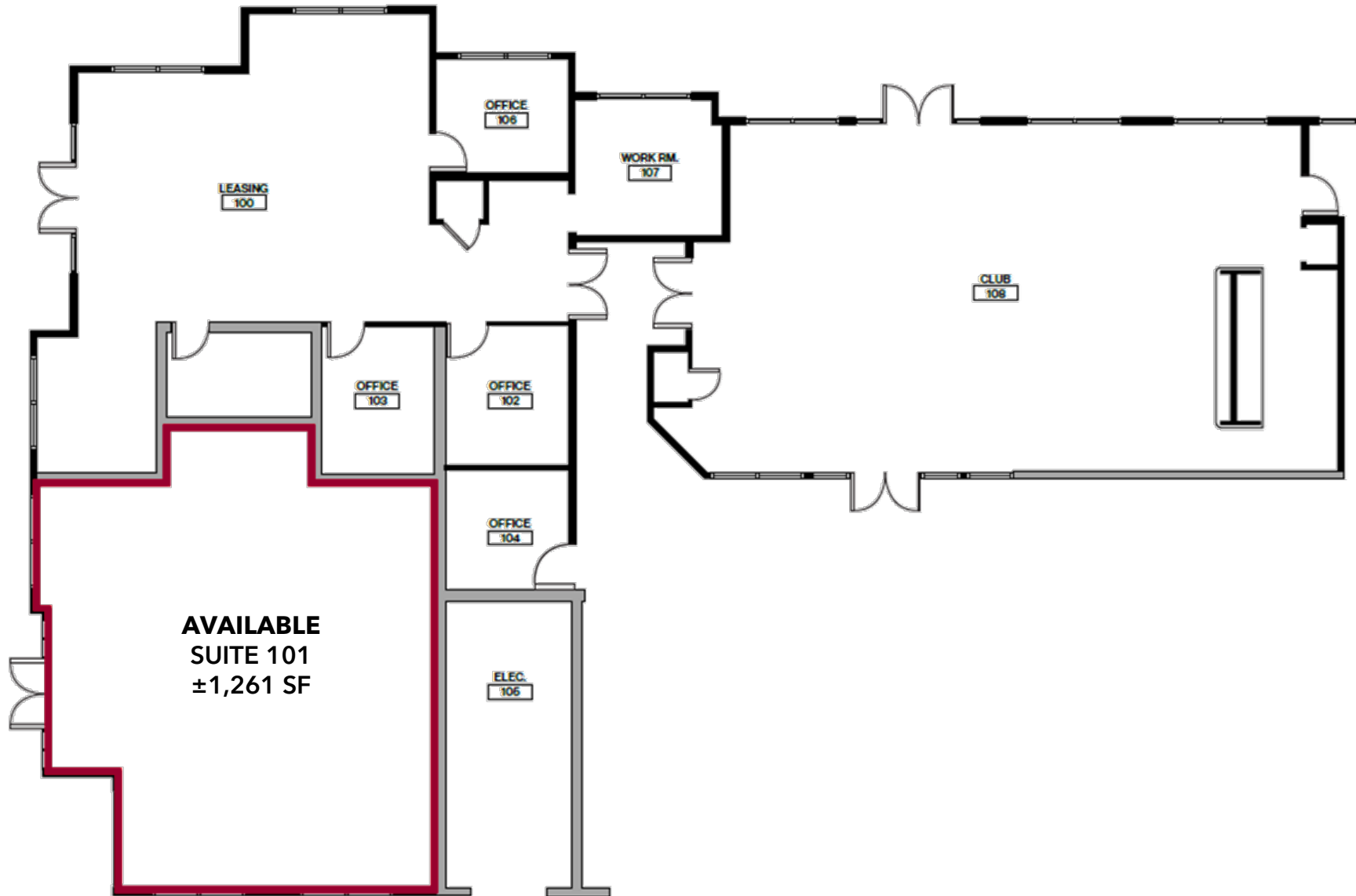





**LEE & ASSOCIATES**  
COMMERCIAL REAL ESTATE SERVICES

FOR MORE INFORMATION, PLEASE REACH OUT TO OUR TEAM.

**JOANNA ZIRBES, CCIM**

Principal  
License: S.0184741  
jzirbes@lee-associates.com  
(702) 490-0699

**BRENDAN LEAKE**

Principal  
License: S.0178140  
bleake@lee-associates.com  
(702) 490-0699

LEE & ASSOCIATES OF LAS VEGAS | BS.1000716 | 8708 SPANISH RIDGE AVE, SUITE 115, LAS VEGAS, NV 89148

All information furnished regarding property for sale, lease or financing is from sources deemed reliable, but no warranty or representation is made to the accuracy thereof and same is submitted to errors, omissions, change of price, rental or other conditions prior to sale, lease or financing or withdrawal without notice. No liability of any kind is to be imposed on the broker herein