

1532 OAKFIELD DRIVE

BRANDON, FLORIDA 33511

OFFICE SPACE FOR LEASE

Located in the Heart of Brandon Business Corridor

 **AVAILABLE JULY 1, 2026**

Move-in ready professional office space in Brandon



PROPERTY OVERVIEW

Take advantage of this exceptional opportunity to lease a well-appointed professional office building in the heart of Brandon's established medical and professional corridor.

Conveniently located on Oakfield Drive, just minutes from Brandon Regional Hospital, SR-60, and I-75, this property offers excellent accessibility for both clients and employees.

The existing floor plan features a highly functional layout suitable for a variety of professional, medical, counseling, therapy, wellness, or administrative office users.

Formerly occupied by a chiropractic practice, the space includes multiple private offices and treatment rooms, reception and waiting areas, administrative workspaces, restrooms, and ample storage.

NOW LEASING

3080 SF OFFICE SUITE

\$28.00 PSF (MG)

Modified Gross Rate includes Operating Expenses such as real estate taxes, building insurance and common area maintenance. Also includes water/sewer and trash service.







TOTAL MONTHLY RENT

\$7,186.67

IDEAL USES

-  MEDICAL
-  WELLNESS
-  PROFESSIONAL OFFICE
-  REAL ESTATE
-  INSURANCE
-  LEGAL SERVICES
-  COUNSELING
-  ACCOUNTING & FINANCIAL

BRANDON 33511 MARKET DEMOGRAPHICS

DEMOGRAPHICS	1 MILE	3 MILES	5 MILES
 Estimated Population	12,400	78,900	192,500
 Average Household Income	\$109,800	\$104,600	\$99,200
 Median Household Income	\$94,100	\$90,300	\$85,400
 Total Households	4,700	30,100	72,800
 Daytime Population	10,500	61,300	149,800
 Bachelor's Degree or Higher	35%	37%	36%
 Median Age	39.6	40.5	40.8

Source: Esri 2024 | Rings centered on Brandon, FL 33511

FOR MORE INFORMATION, CONTACT:

 **Carl Stickeler**
(813) 390-0951

 cstickeler@gmail.com

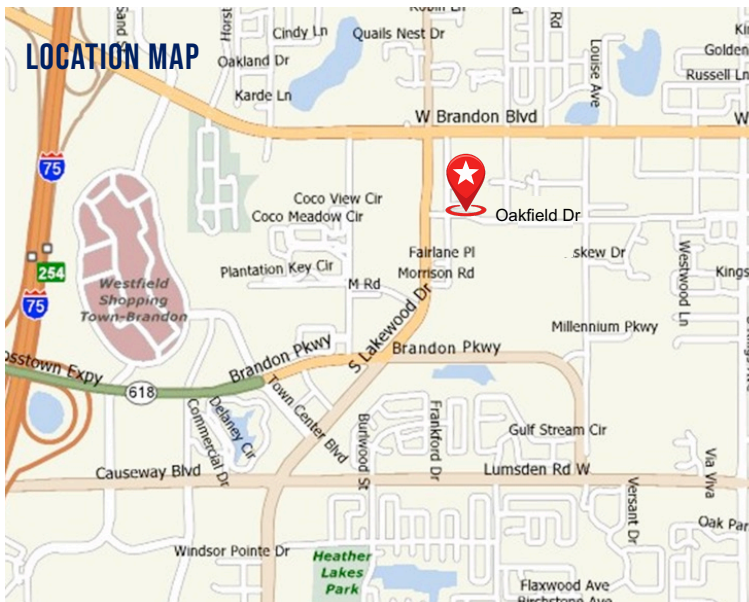

HILLSBOROUGH'S FINEST REAL ESTATE TEAM
Your Success is Our Goal!

TURNER COLE COMPANY
REAL ESTATE SERVICES



www.TurnerCole.com

1532 OAKFIELD DRIVE
— BRANDON, FLORIDA 33511 —

FLOOR PLAN 3,080 SF
(drawing not to scale)

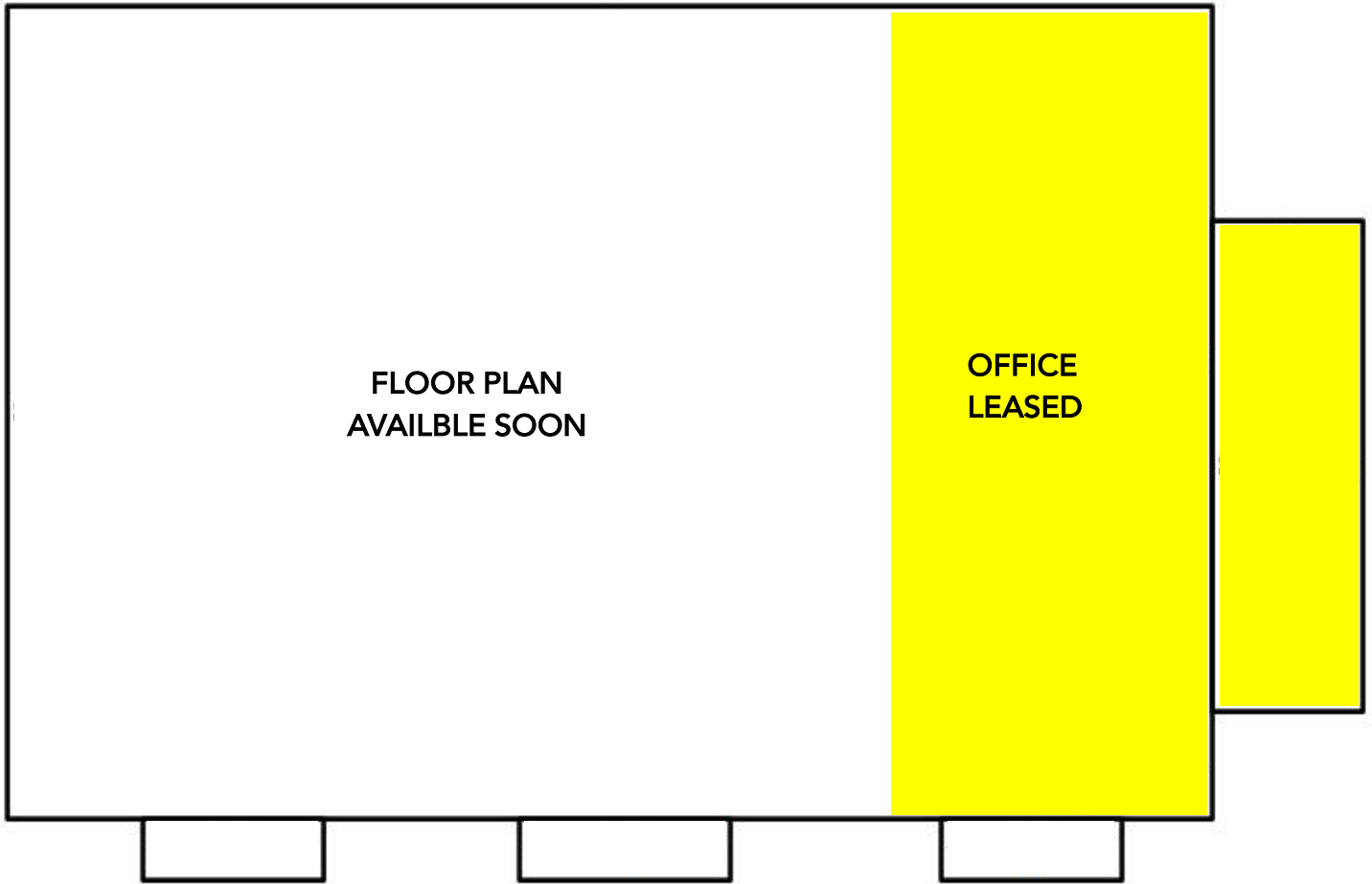

PROPERTY FEATURES

Well-maintained. Professionally Managed. Built for Your Business.



**4+ /1,000 SF
PARKING RATIO**

Ample, convenient parking for employees and visitors



**MODIFIED GROSS
RENTAL STRUCTURE**

Simplified leasing with many operating expenses included in the rent



**MEDICAL &
PROFESSIONAL
OFFICE SETTING**

Ideal for medical, professional and service-oriented businesses



**PRIME
BRANDON LOCATION**

Centrally located near Brandon Regional Hospital, shopping dining and major roadways



**EXCELLENT
ACCESSIBILITY**

Minutes for I-75 and the Selmon Expressway for easy regional access.



**LARGE SIGNAGE
OPPORTUNITY**

Large street pylon sign provides great visibility for your business.

NO WARRANTY OR REPRESENTATION, EXPRESSED OR IMPLIED, IS MADE AS TO THE ACCURACY OF THE INFORMATION CONTAINED HEREIN, AND SAME IS SUBMITTED SUBJECT TO ERRORS, OMISSIONS, CHANGE OF PRICE, RENTAL OR OTHER CONDITIONS, WITHDRAWAL WITHOUT NOTICE, AND TO ANY SPECIFIC LISTING CONDITIONS, IMPOSED BY OUR PRINCIPALS.